

B.M. 125.35 'R' in Pitche E. Co. Poplar N.L. 16th
 B.M. 133.23 S.E. Cor. Strip House # 2004 E. 16th

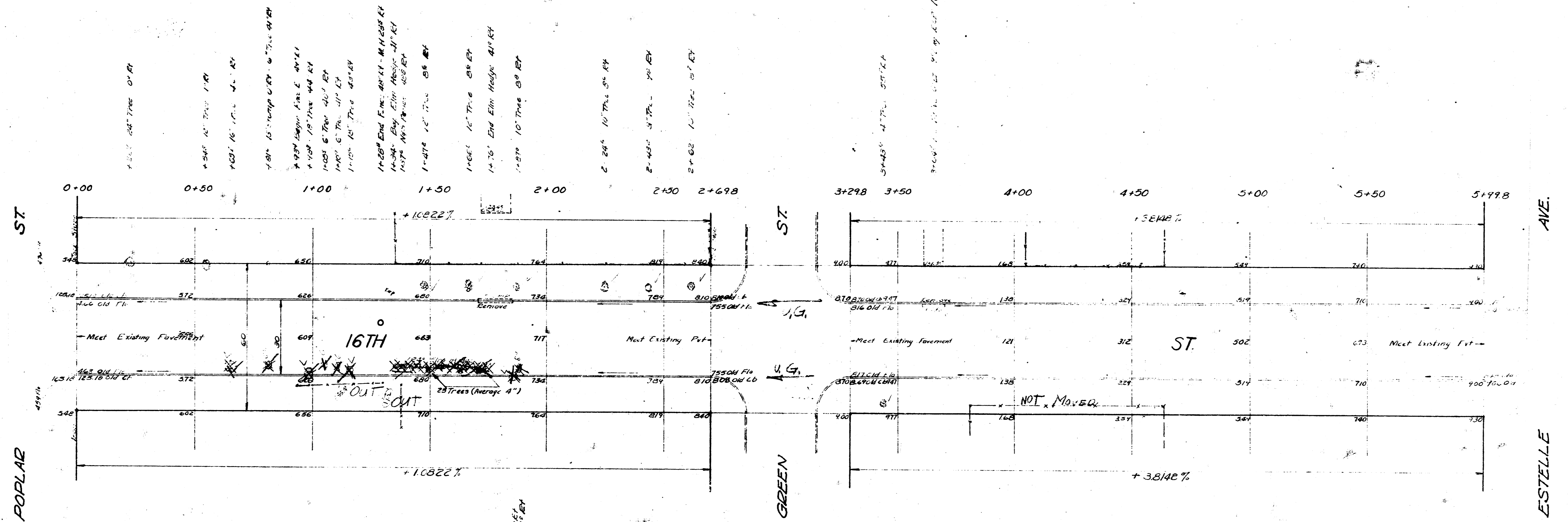

POPLAR ST.

GREEN ST.

ESTELLE AVE.

Engr. to count trees removed & Report Same on form to office



16TH ST.
 E.L. Poplar St. to W.L. Estelle Ave.
 30' Conc. & Co.
 CITY OF WICHITA, KAN.
 B.E. SMITH
 Dec. 1, 1932
 CITY ENGINEER
 Proj. No. CIP-53

BM 125.35 'R' in Ritchie E. Co. Poplar N.L. 16th
 E.M. 133.83. S.E. Cor. Strip House # 2604 E. 16th

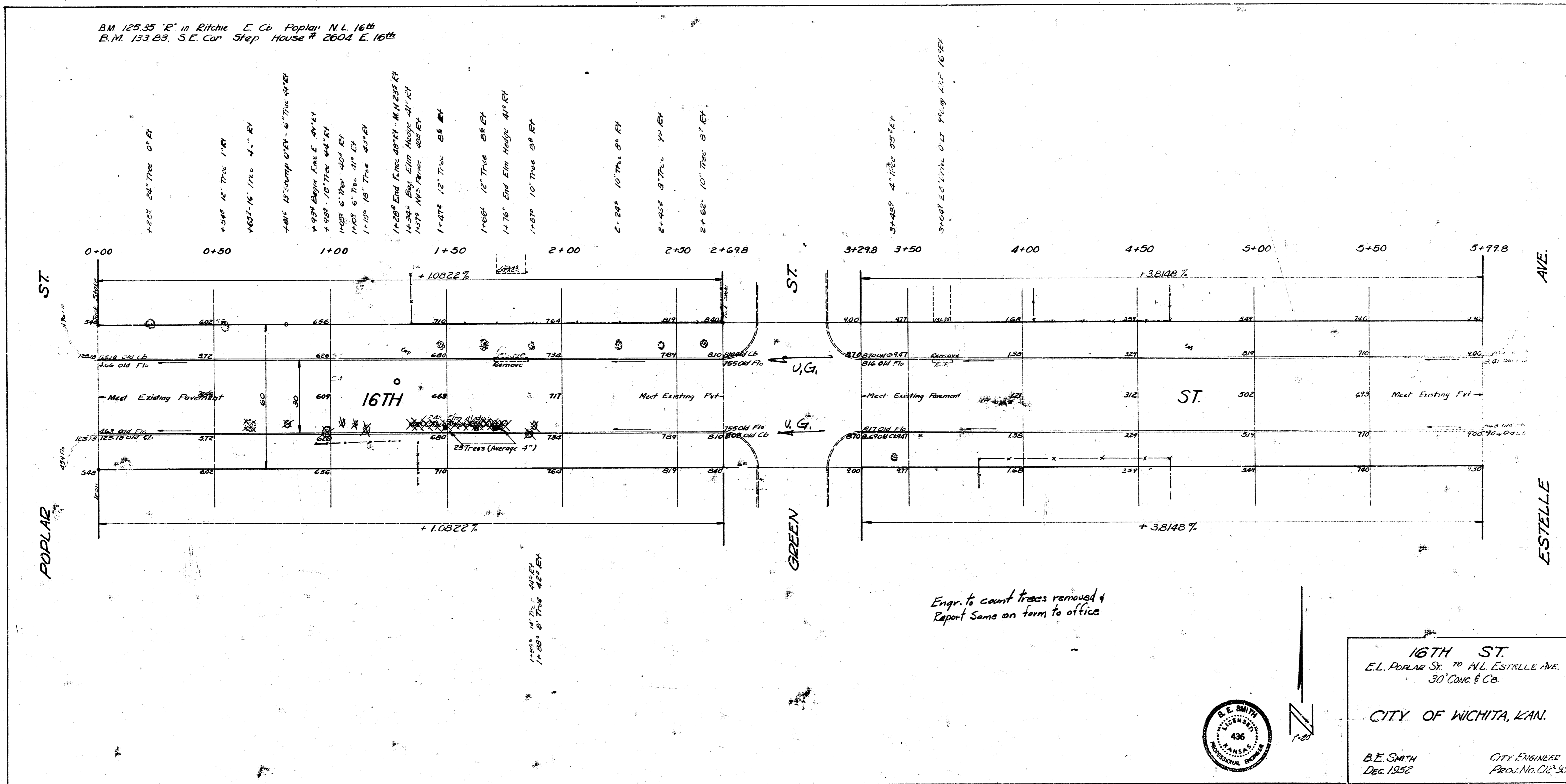

Engr. to count trees removed & Report Same on form to office



16TH ST.
 E.L. POPLAR ST TO W.L. ESTELLE AVE.
 30' CONC. & CO.
 CITY OF WICHITA, KAN.
 B.E. SMITH CITY ENGINEER
 Dec. 1952 PROJ. No. 02-53