

# STREET IMPROVEMENTS

16TH STREET NO.

FROM TYLER ROAD TO 315 FT. EAST OF TYLER ROAD

PROJ. NO. 472-82170

INDEX NO. 761635

CITY OF WICHITA, KANSAS

M. E. LINDEBAK - CITY ENGINEER

## GENERAL NOTES:

- UTILITY SERVICE LINES, POLES, VALVE BOXES, METERS, AND ETCETERA ARE TO BE ADJUSTED AS NECESSARY BY OTHERS. CONSTRUCTION UNLESS THE PLANS SPECIFICALLY CALL FOR THE ADJUSTMENT BY THE CONTRACTOR OR UNLESS THE PLANS SPECIFICALLY IDENTIFY A UTILITY TO BE ADJUSTED BY ITS OWNER DURING CONSTRUCTION. EXISTING UTILITIES AND THEIR LOCATION, AS SHOWN ON THE PLANS, REPRESENT THE BEST INFORMATION OBTAINABLE FOR DESIGN. THE CONTRACTOR WILL BE REQUIRED TO WORK AROUND EXISTING UTILITIES WITHIN THE RIGHT-OF-WAY WHICH DO NOT CONFLICT WITH PROPOSED CONSTRUCTION.
- A SAW CUT OF AT LEAST ONE-HALF THE DEPTH OF EXISTING SURFACE COURSES OR ONE-FOURTH THE DEPTH OF THE EXISTING TOTAL PAVEMENT THICKNESS SHALL BE PROVIDED AT LOCATION, WHERE PROPOSED CONSTRUCTION ABUTS AN EXISTING SURFACE COURSE OR PAVEMENT FOR WHICH PARTIAL REMOVAL OF THAT SURFACE OR PAVEMENT IS REQUIRED. SAWS JOINT TO FACILITATE REMOVAL WITHIN THREE (3) FEET OF EXISTING JOINTS WILL NOT BE PERMITTED AND FOR SUCH INSTANCES THE LIMITS OF REMOVAL SHALL EXTEND TO THE EXISTING JOINT. SUCH SAW CUTS WILL NOT BE PAID FOR DIRECTLY AND THIS COST SHALL BE CONSIDERED AS SUBSIDIARY TO THE REMOVAL OF THE SURFACE OR PAVEMENT.
- RUBBLE FROM THE REMOVAL OF MISCELLANEOUS STRUCTURES AND EXCAVATION WHICH IS TO BE WASTED SHALL BE DISPOSED ON SITES TO BE PROVIDED BY THE CONTRACTOR. THESE SITES SHALL BE APPROVED BY THE ENGINEER AS TO SUITABILITY, APPEARANCE AND SITE LOCATION. LOCATIONS THAT, IN THE OPINION OF THE ENGINEER, WILL LEAVE AN UNSIGHTLY APPEARANCE WILL NOT BE APPROVED.  
  
ALL DISPOSAL SITES MUST BE APPROVED BY THE KANSAS DEPARTMENT OF HEALTH AND ENVIRONMENT. MATERIAL EITHER STOCKPILED OR DISPOSED OF IN A FLOOD PLAIN WOULD REQUIRE A KANSAS STATE BOARD OF AGRICULTURE PERMIT. ANY MATERIAL DUMPED IN WATERS OF THE UNITED STATES OR WETLANDS IS SUBJECT TO U.S. CORPS OF ENGINEERS PERMITTING REGULATIONS. ANY MATERIAL BURIED OR STOCKPILED BEYOND APPROVED CONSTRUCTION LIMITS WOULD REQUIRE ADDITIONAL ARCHAEOLOGICAL INVESTIGATIONS UNLESS BURIED IN A PREVIOUSLY APPROVED BORROW LOCATION.
- LIMITS OF EARTHWORK SHALL MATCH EXISTING GROUND ELEVATIONS AT THE RIGHT-OF-WAY LINE UNLESS OTHERWISE NOTED ON THE PLANS WITH A NEW FINISHED GRADE ELEVATION. WHEN A NEW FINISHED GRADE ELEVATION IS SHOWN, THE EARTHWORK SHALL EXTEND ONE FOOT BEYOND THE RIGHT-OF-WAY LINE AND THEN SLOPED UP OR DOWN USING PERMISSIBLE SLOPES TO MATCH THE EXISTING GROUND SURFACE.
- CONTRACTOR SHALL GIVE PROPERTY OWNERS ABUTTING THIS PROJECT, WHOSE YARDS WILL BE LOWER THAN THE NEW FINISHED GRADE ELEVATIONS AT THE RIGHT-OF-WAY LINE, AN OPPORTUNITY TO UTILIZE EXCESS EXCAVATED MATERIAL FROM THE PROJECT TO REGRADE THEIR YARDS TO DRAIN TO THE NEW PAVEMENT. CONTRACTOR WILL BE REQUIRED TO DUMP AND SPREAD THE EXCESS MATERIAL AS REQUIRED BY THE SPECIFICATIONS WHEN REQUESTED BY THE PROPERTY OWNER. THE CONTRACTOR SHALL ASCERTAIN THAT A DIRT ORDER FORM HAS BEEN PROPERLY EXECUTED BY THE PROPERTY OWNER BEFORE ANY SUCH EXCESS MATERIAL IS DELIVERED TO SUCH PROPERTIES.
- THE CONTRACTOR SHALL BE RESPONSIBLE FOR PRESERVING PROPERTY IRONS. THE CONTRACTOR WILL BE REQUIRED TO RE-ESTABLISH ANY PROPERTY IRONS WHICH ARE DAMAGED OR DESTROYED BY HIS CONSTRUCTION OPERATIONS. SUCH IRONS SHALL BE RE-ESTABLISHED BY A LICENSED LAND SURVEYOR OR A LICENSED PROFESSIONAL ENGINEER IN ACCORDANCE WITH STATE LAWS.
- THE CONTRACTOR SHALL ADJUST WATER VALVE BOXES AND FIRE HYDRANTS AS DIRECTED BY THE ENGINEER AT THE PRICE BID FOR SAID ADJUSTMENTS. THE WATER DEPARTMENT SHALL FIELD LOCATE WATER VALVES ONE TIME DURING CONSTRUCTION WHEN REQUESTED BY THE CONTRACTOR. IT SHALL BE THE CONTRACTOR'S RESPONSIBILITY TO PRESERVE SUCH FIELD LOCATIONS DURING THE CONSTRUCTION PROCESS. WATER VALVES, WATER VALVE BOXES OR FIRE HYDRANTS DAMAGED DURING CONSTRUCTION SHALL BE REPAIRED BY THE CONTRACTOR AT HIS OWN EXPENSE.
- THE CONTRACTOR SHALL GIVE ALL PROPERTY OWNERS AND/OR TENANTS OF DEVELOPED PROPERTY ABUTTING THE PROJECT LIMITS A MINIMUM OF TEN (10) DAYS ADVANCE NOTICE PRIOR TO START OF CONSTRUCTION.
- THE CONTRACTOR MUST EXAMINE THE CONSTRUCTION SITE PRIOR TO BIDDING AND BE SATISFIED AS TO THE WORK SHOWN FOR COMPLETION. AFTER BIDS HAVE BEEN RECEIVED, THE CONTRACTOR SHALL NOT ASSERT THAT THERE WAS A MISUNDERSTANDING OF THE QUANTITIES OF WORK OR OF THE NATURE OF THE WORK TO BE COMPLETED.
- ALL CONSTRUCTION AND MATERIALS, UNLESS OTHERWISE NOTED, TO COMPLY WITH CITY OF WICHITA SPECIFICATIONS AND STANDARDS.

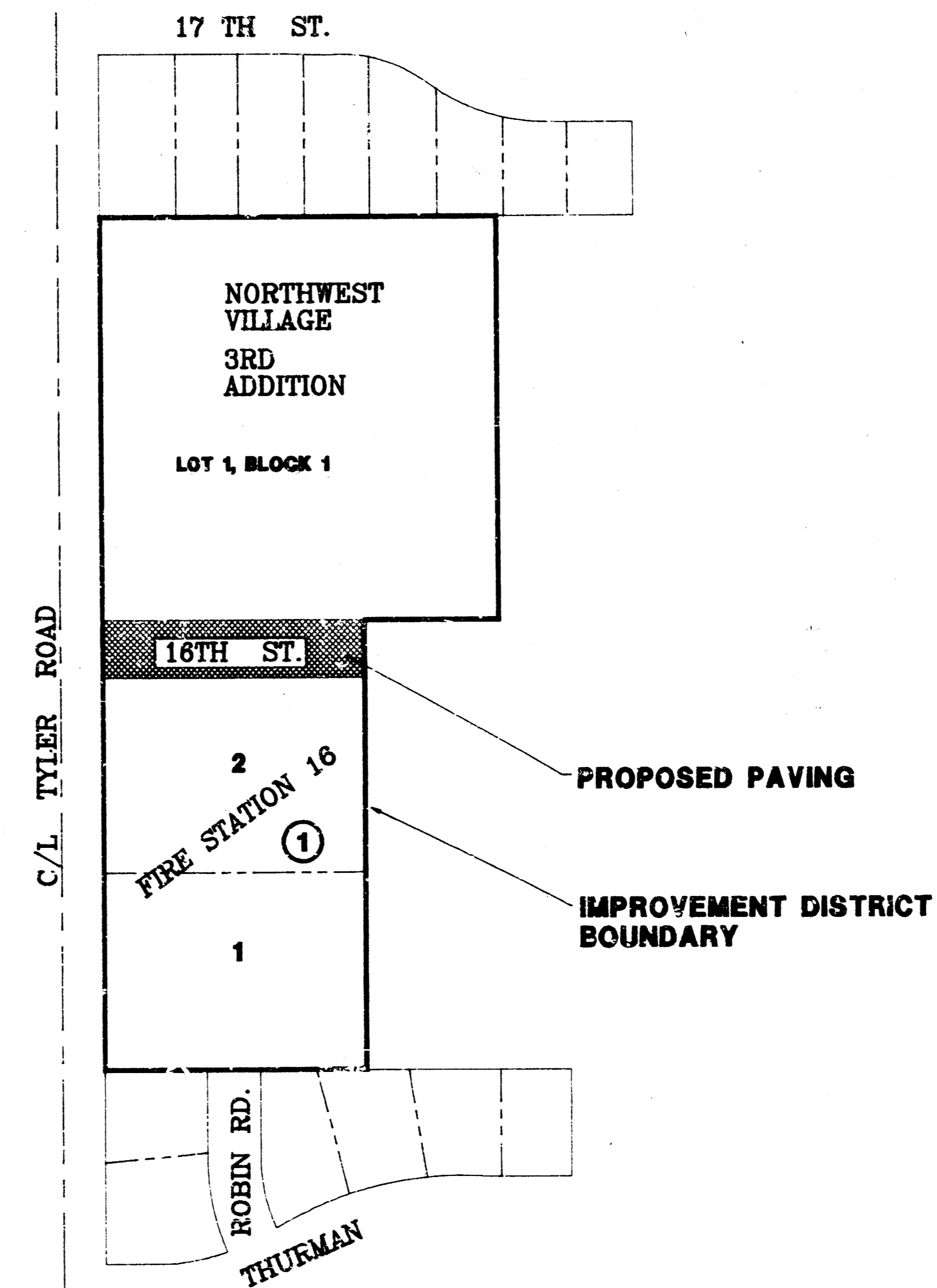

## INDEX OF SHEETS

SHEET 1	-	TITLE SHEET
SHEET 2	-	DETAIL
SHEET 3	-	PAVING PLAN
SHEET 4	-	EARTHWORK SECTIONS

*SWS  
Booked  
12-6-93  
MCG*

# TYPICAL 35' PAVEMENT DETAILS

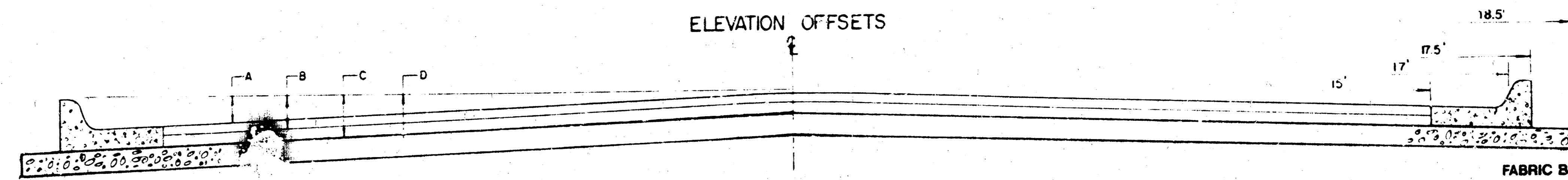
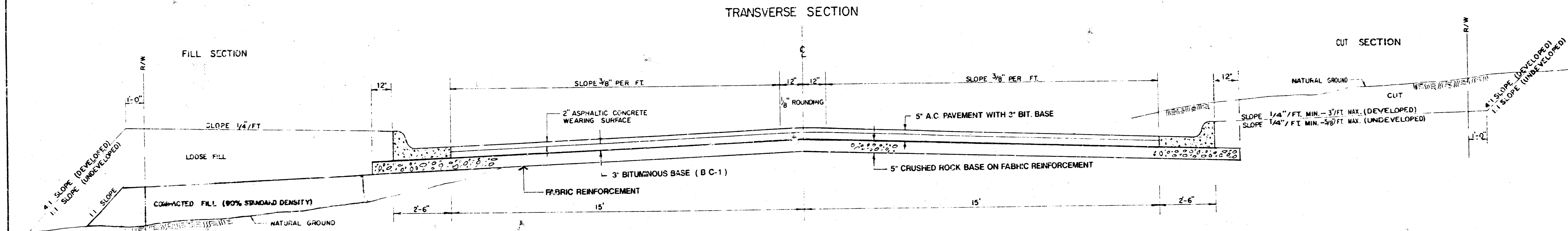

	DISTANCE FROM CENTERLINE (LT. & RT.)											
	0'	2'	4'	6'	8.5'	10'	12'	14'	15'	17'	17.5'	
A. TOP OF CURBS TO TOP OF SURFACE LIFT	0.04	0.08	0.14	0.21	0.29	0.33	0.39	0.46	0.49			
B. TOP OF CURBS TO TOP OF BASE LIFT	0.21	0.25	0.31	0.37	0.45	0.50	0.56	0.62	0.65			
C. TOP OF CURBS TO TOP OF ROCK BASE LIFT	0.46	0.50	0.56	0.63	0.71	0.75	0.81	0.88	0.91	0.98	1.00	
D. TOP OF CURBS TO TOP OF SUBGRADE												

FABRIC BASE REINFORCEMENT SHALL BE B X 1 100 BY TENSAR CORPORATION OR LBO201 BY TENAX CORPORATION OR APPROVED EQUAL. FABRIC BASE REINFORCEMENT SHALL BE INSTALLED IN ACCORDANCE WITH MANUFACTURER'S RECOMMENDATIONS. CRUSHED ROCK SHALL BE UNIFORMLY GRADED FROM 1- 1/2" MAXIMUM SIZE TO NOT MORE THAN 10% PASSING A NO. 200 SIEVE. ROCK QUALITY SHALL BE THE SAME AS SPECIFIED FOR COARSE AGGREGATE FOR CONCRETE MIXES.

### TRANSVERSE CONSTRUCTION JOINTS

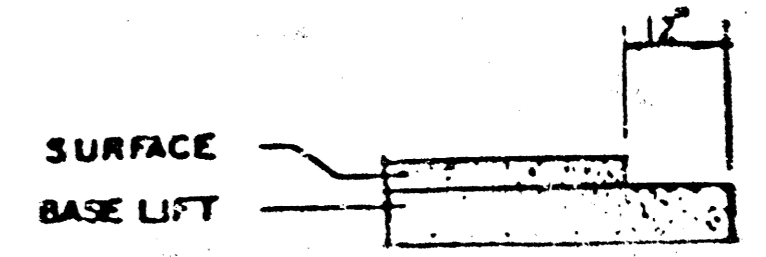

TRANSVERSE CONSTRUCTION JOINTS SHALL BE CONSTRUCTED IN FLEXIBLE BASE PAVEMENTS AT LOCATIONS WHERE PAVEMENT JOINTS EXISTING FLEXIBLE BASE PAVEMENT AS SHOWN BY THE DETAILS. ALL COSTS ASSOCIATED WITH THE CONSTRUCTION OF THE TRANSVERSE JOINT SHALL BE INCLUDED IN THE BID PRICE FOR SQUARE YARDS 5" ASPHALTIC CONCRETE PAVEMENT (3" BITUMINOUS BASE)

### GENERAL NOTES

- ROCK BASE IS TO BE COMPACTED AND SMOOTHED WITH A STEEL FACED ROLLER PRIOR TO PLACEMENT OF ASPHALT. TACK COAT WILL NOT BE APPLIED TO ROCK BASE.
- A TACK COAT OF EMULSIFIED ASPHALT (SC-1H OR CSS-1H) SHALL BE APPLIED AT AN APPROXIMATE RATE OF 0.05 GALLONS PER SQUARE YARD BETWEEN EACH LIFT OF ASPHALT MATERIAL.
- BITUMINOUS BASE AND ASPHALTIC CONCRETE WEARING SURFACE SHALL BE PLACED WITH A LAYDOWN MACHINE HAVING AUTOMATIC CONTROLS FOR LINE AND GRADE.
- CONSTRUCTION JOINTS IN EACH LIFT SHALL BE STAGGERED A MINIMUM DISTANCE OF ONE (1) FOOT FROM JOINTS IN PRECEDING LIFTS AND PLACED SO THAT A JOINT WILL BE CONSTRUCTED ON THE CENTERLINE OF THE TOP LIFT.

### COMBINED CURB & GUTTER

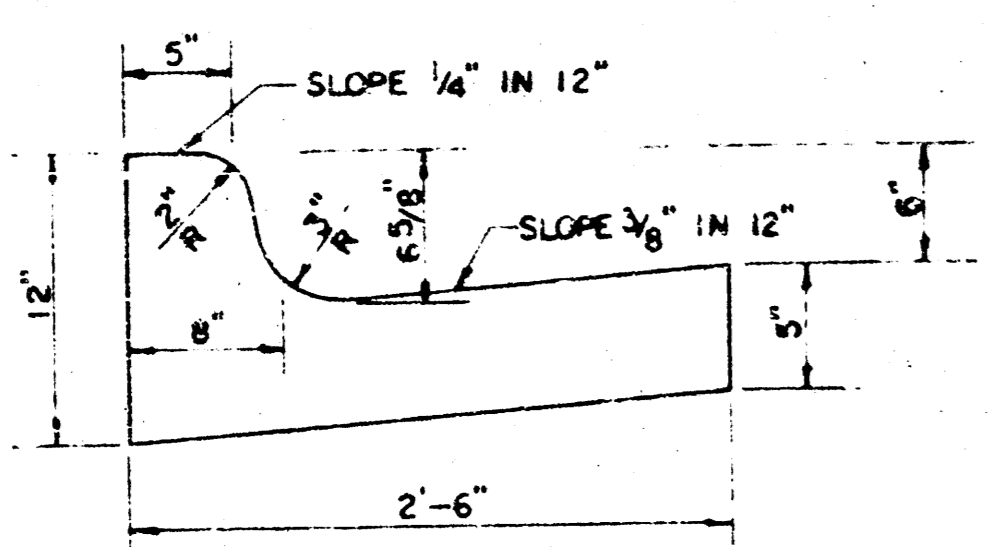

### ROLL TYPE COMBINED CURB & GUTTER

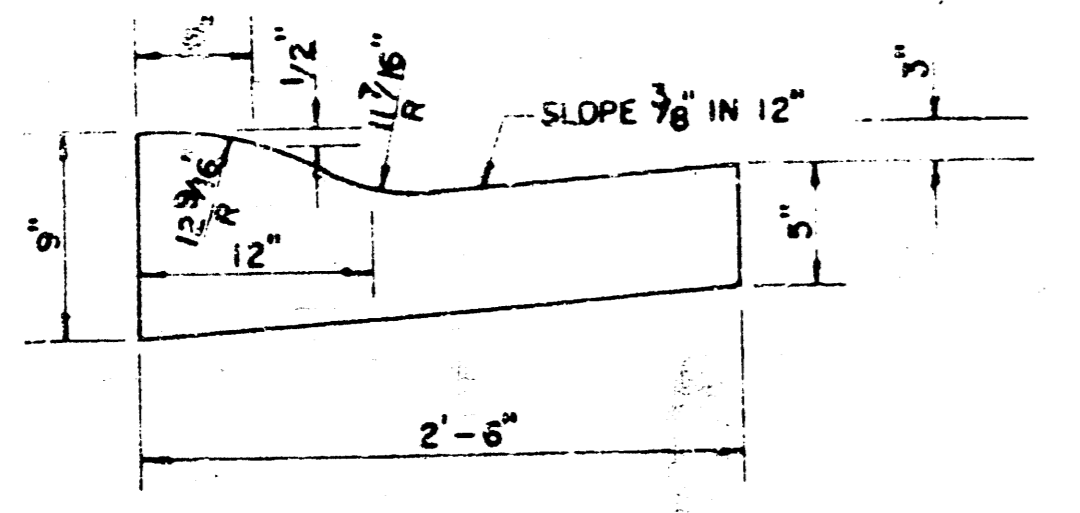

REVISED 1-3-93 JKB

5" RESIDENTIAL ASPHALTIC CONCRETE PAVEMENT WITH CRUSHED ROCK BASE ON FABRIC REINFORCEMENT

PROJECT NO.	SHEET NO.	TOTAL SHEETS
472-76-245-82170-000-001	3	4

SCALE: 1"=20'

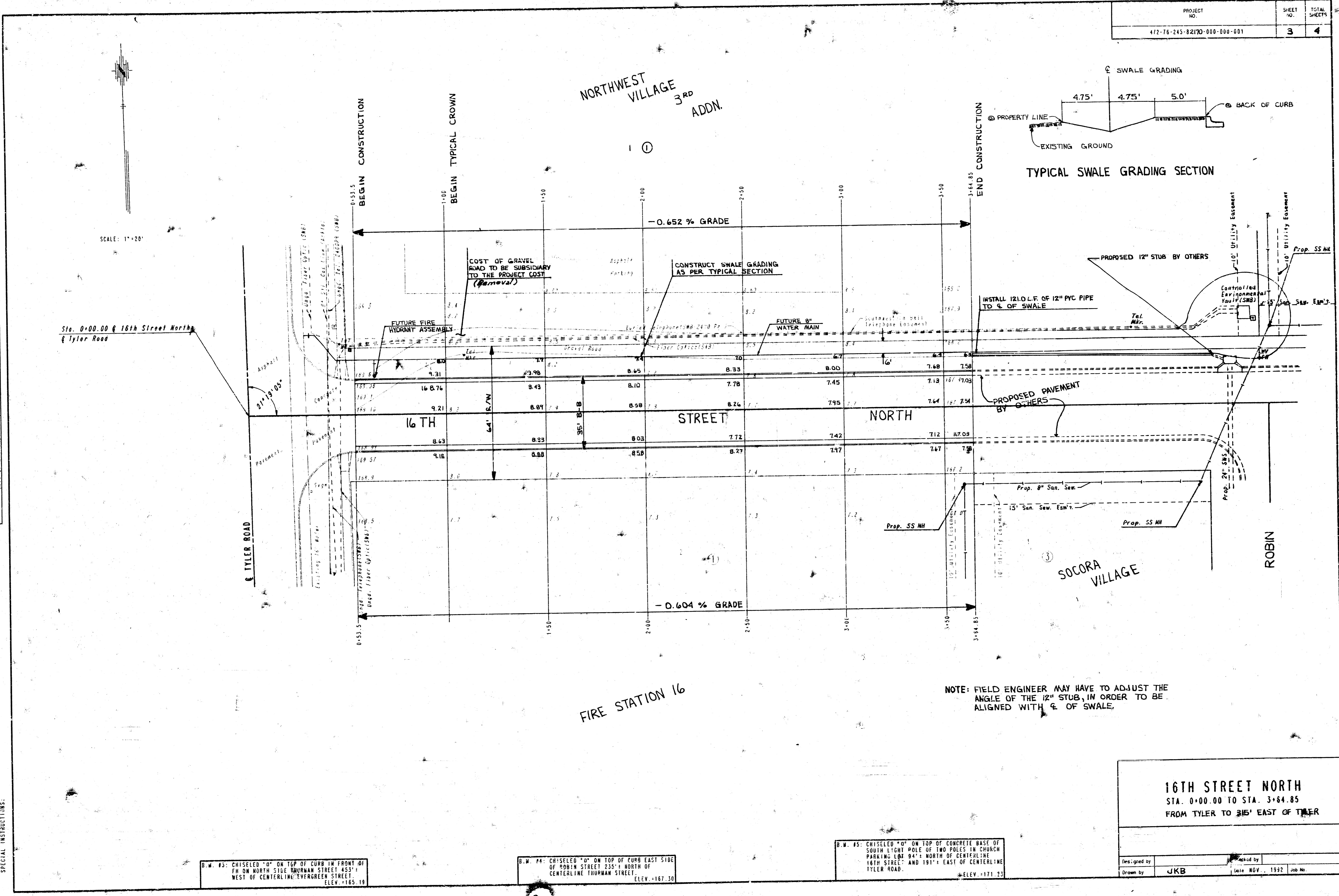

TYPICAL SWALE GRADING SECTION

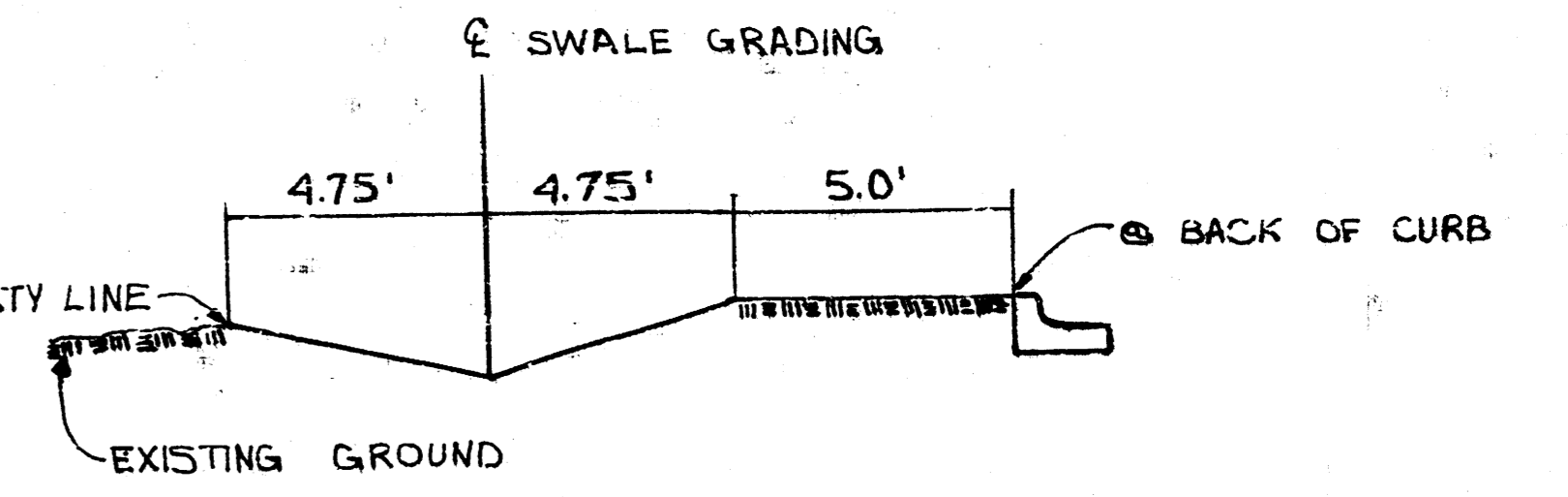

PLAN	SURVEYED	BY	DATE
NOTE BOOK	PLOTTED		
ALIGNMENT	CHECKED		
BY	DATE		

DRAWING NAME: 35-82334-16TH STREET  
 CENTER COORDINATES:  
 ROTATION ANGLE ON:  
 SPECIAL INSTRUCTIONS:

B.M. #3: CHISELED "O" ON TOP OF CURB IN FRONT OF  
 FH ON NORTH SIDE BURMAN STREET 453' ±  
 WEST OF CENTERLINE EVERGREEN STREET.  
 ELEV. = 165.19

B.M. #4: CHISELED "O" ON TOP OF CURB EAST SIDE  
 OF ROBIN STREET 235' ± NORTH OF  
 CENTERLINE THURMAN STREET.  
 ELEV. = 167.50

B.M. #5: CHISELED "O" ON TOP OF CONCRETE BASE OF  
 SOUTH LIGHT POLE OF TWO POLES IN CHURCH  
 PARKING LOT 94' NORTH OF CENTERLINE  
 16TH STREET AND 197' EAST OF CENTERLINE  
 TYLER ROAD.  
 ELEV. = 171.23

NOTE: FIELD ENGINEER MAY HAVE TO ADJUST THE  
 ANGLE OF THE 12" STUB, IN ORDER TO BE  
 ALIGNED WITH C OF SWALE.

**16TH STREET NORTH**  
 STA. 0+00.00 TO STA. 3+64.85  
 FROM TYLER TO 315' EAST OF TYLER

Designed by	Checked by
Drawn by	Date
JKB	NOV. 1992

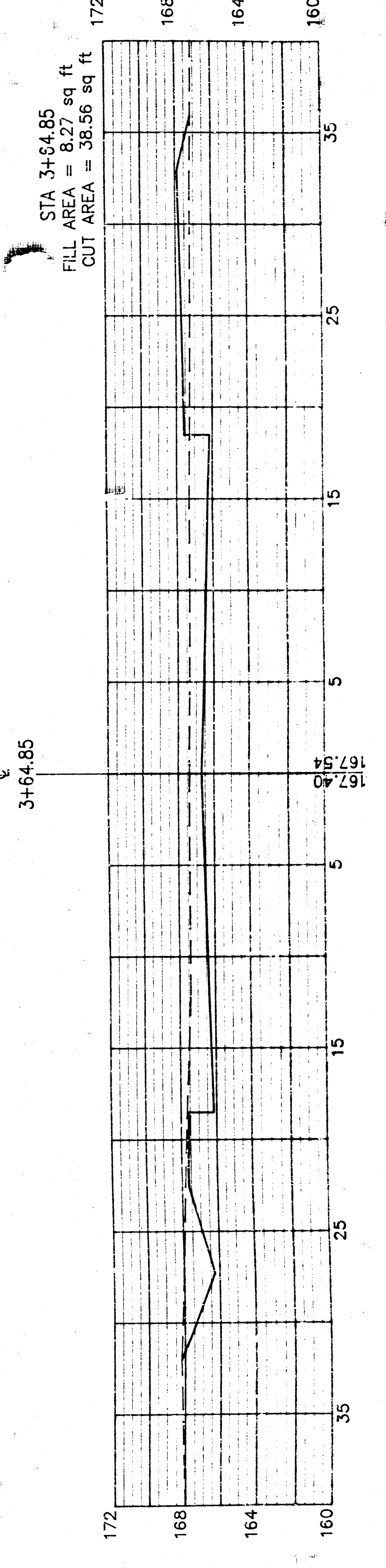
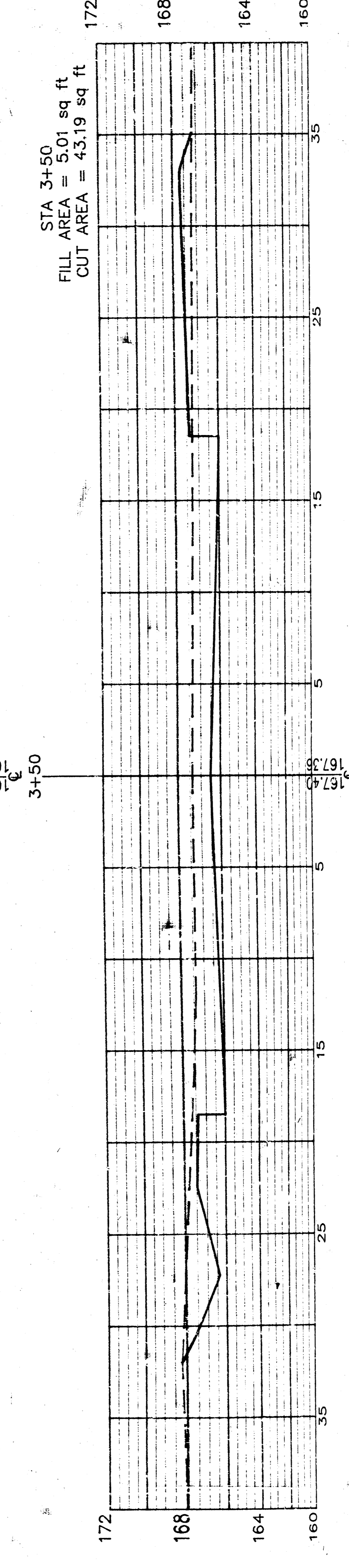
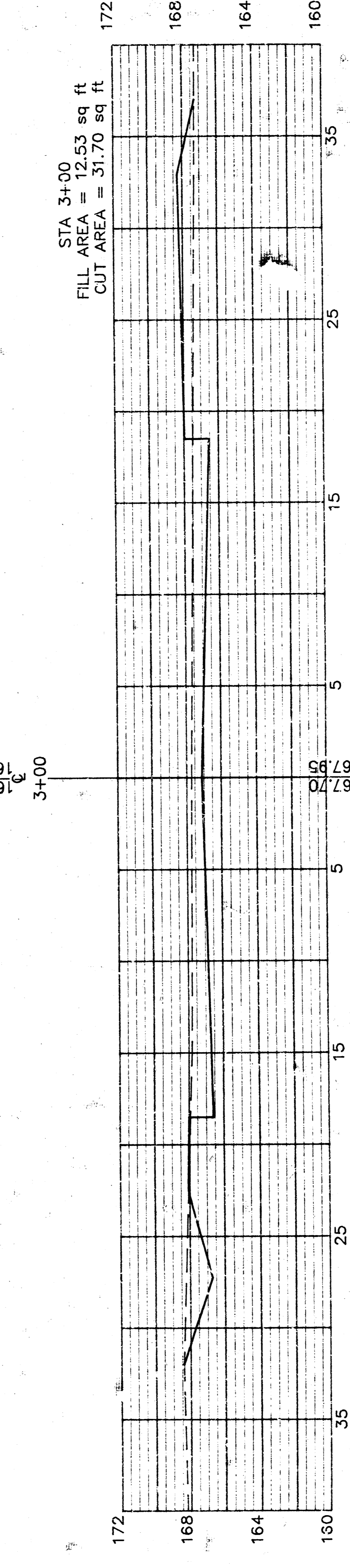
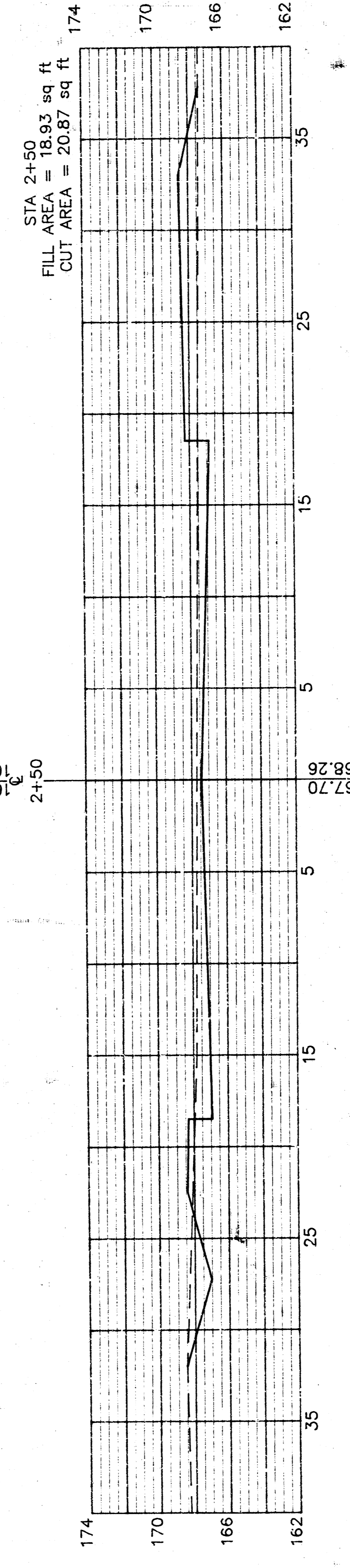
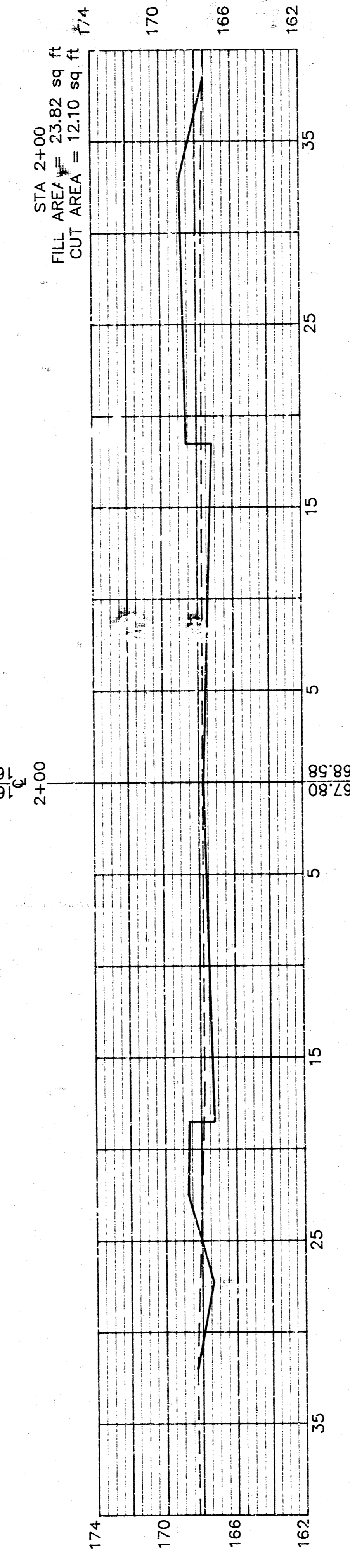
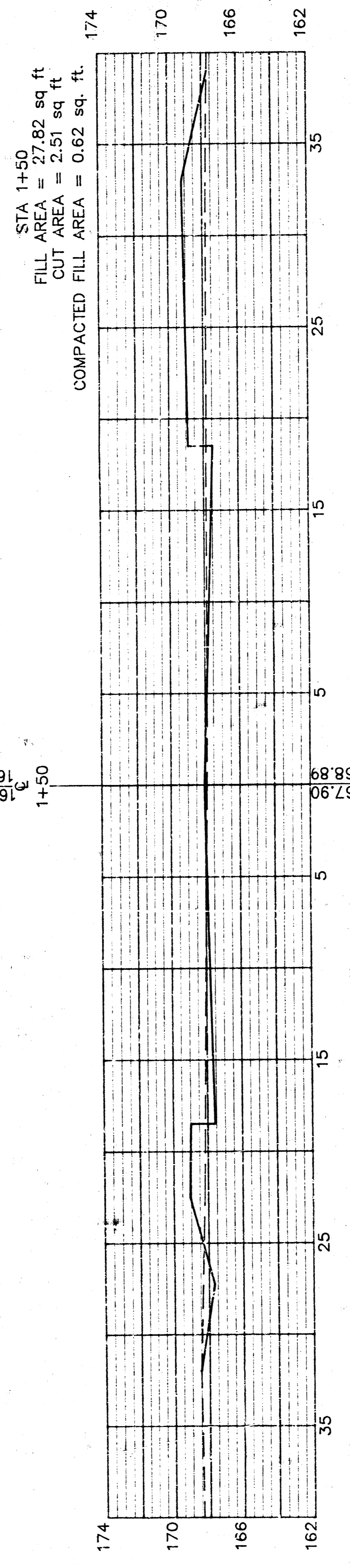
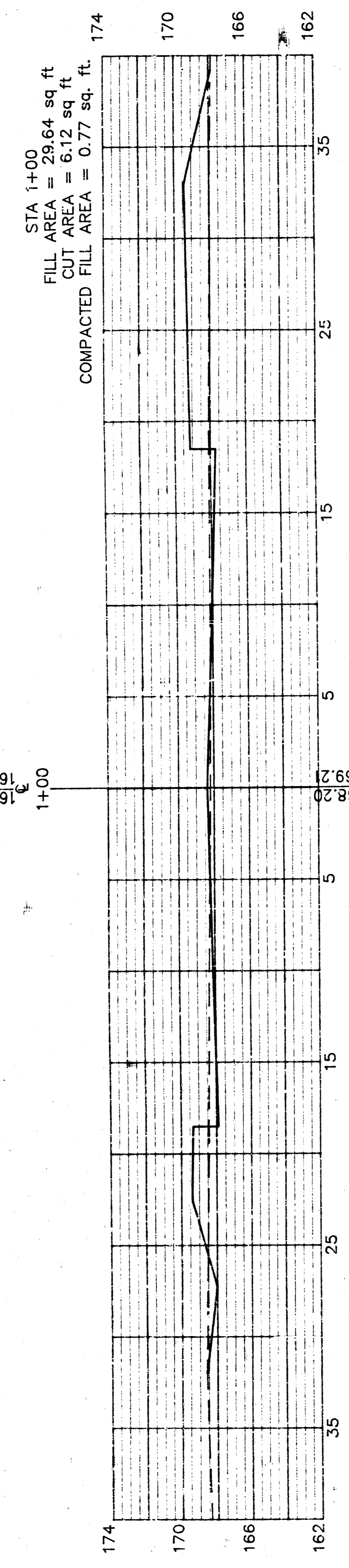
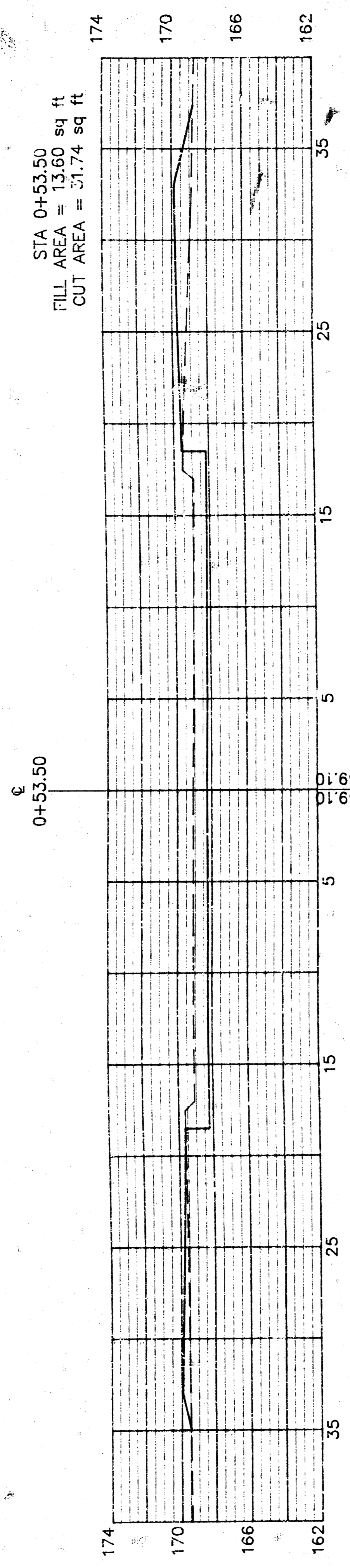

STATION	AREAS in SQ FT		VOLUMES in CU. YDS.		COMPACTED FILL	
	CUT	FILL	CUT	FILL	SQ FT	CU. YDS.
0+53.50	31.74	13.60			0.00	0.66
1+00	6.12	29.64	32.61	37.23	0.77	1.29
1+50	2.51	27.82	7.99	53.20	0.62	0.76
2+00	12.10	23.82	13.52	47.81	0.00	
2+50	20.87	18.93	30.53	39.58		
3+00	31.70	12.53	48.68	29.13		
3+50	43.19	5.01	69.34	16.25		
3+64.85	38.56	8.27	22.48	3.65		
			225.15	226.85		2.89

16TH STREET  
472-82170  
INDEX NO. 761635  
SHEET 4 OF 4

AT-1-141