

BM 130.80 NW COR. PORCH NO. #3517 SE COR. 17TH HIGH
 BM 130.86 SE COR. PORCH NO. #1809 NW COR. GOW 17TH
 BM 125.46 STANDARD B.M. SE COR. SHERIDAN 17TH
 STATIONING ON NORTH PROP. LINE

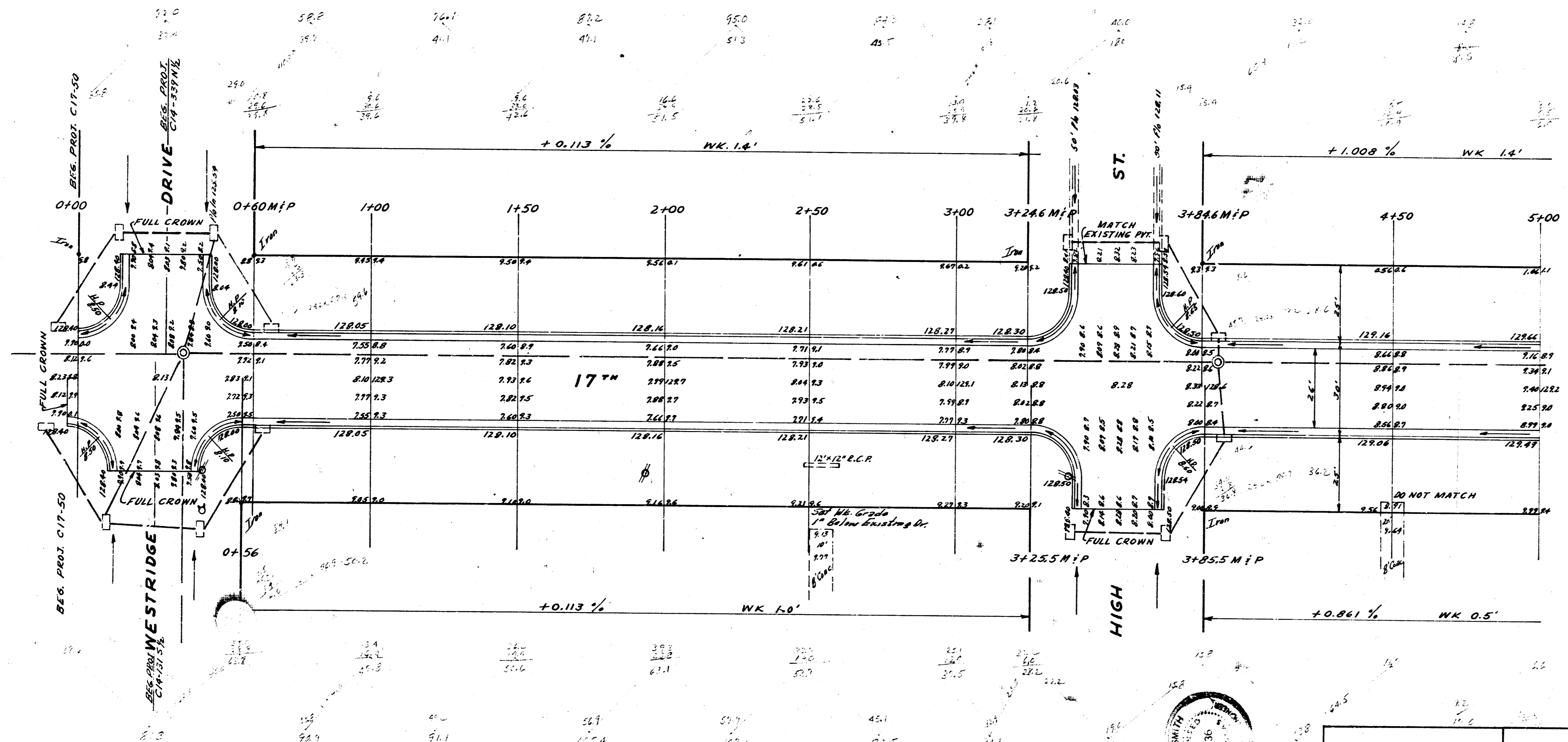

CHECKED BY: JAMES B. CHAMBERLAIN
 DRAWN BY: JAMES B. CHAMBERLAIN
 DATE: 7/1/57

STATION	PROP. 17 TH ST.	PROP. WESTRIDGE	PROP. SHERIDAN	PROP. GOW
0+00	226.1	226.1	226.1	226.1
1+00	226.2	226.2	226.2	226.2
2+00	226.3	226.3	226.3	226.3
3+00	226.4	226.4	226.4	226.4
4+00	226.5	226.5	226.5	226.5
5+00	226.6	226.6	226.6	226.6

INTERSECTION
 17TH & SHERIDAN
 Proj. No. C17-49
W 1/2 INTERSECTION
 17TH & WESTRIDGE
 Proj. No. C17-50

17TH
 N 1/2 WL. SUNSET HTS. - TO - E SHERIDAN
 13-2-15 AC. Proj. No. C14-339
 S 1/2 E WESTRIDGE - TO - E GOW
 13-2-15 AC. Proj. No. C14-131
 S 1/2 E GOW - TO - WL. SHERIDAN
 13-2-15 AC. Proj. No. C17-24
CITY OF WICHITA, KAN.
 July 1957 BE SMITH CITY ENGINEER

