

BM 132.23 NW cor conc porch Ho SE cor 18th & Westridge.

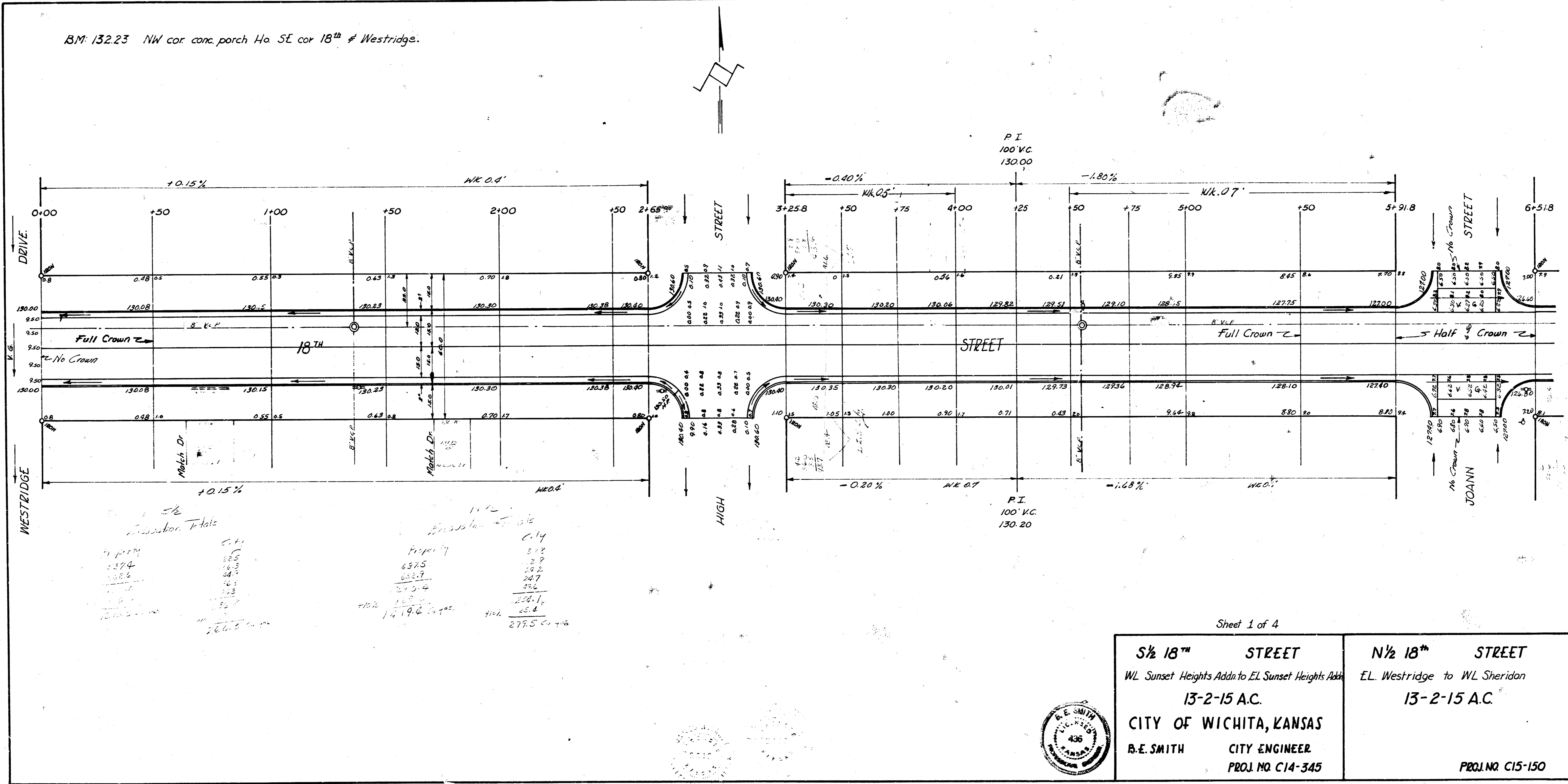

CH. MILLS (BY CH. 101)
 CH. 101
 CH. 101
 CH. 101

Substation Totals		Property	
Station	Area	Station	Area
132.23	0.11	132.23	5.12
132.4	0.25	132.4	2.9
132.6	0.38	132.6	2.2
132.8	0.51	132.8	2.7
133.0	0.64	133.0	3.2
133.2	0.77	133.2	3.7
133.4	0.90	133.4	4.2
133.6	1.03	133.6	4.7
133.8	1.16	133.8	5.2
134.0	1.29	134.0	5.7
134.2	1.42	134.2	6.2
134.4	1.55	134.4	6.7
134.6	1.68	134.6	7.2
134.8	1.81	134.8	7.7
135.0	1.94	135.0	8.2
135.2	2.07	135.2	8.7
135.4	2.20	135.4	9.2
135.6	2.33	135.6	9.7
135.8	2.46	135.8	10.2
136.0	2.59	136.0	10.7
136.2	2.72	136.2	11.2
136.4	2.85	136.4	11.7
136.6	2.98	136.6	12.2
136.8	3.11	136.8	12.7
137.0	3.24	137.0	13.2
137.2	3.37	137.2	13.7
137.4	3.50	137.4	14.2
137.6	3.63	137.6	14.7
137.8	3.76	137.8	15.2
138.0	3.89	138.0	15.7
138.2	4.02	138.2	16.2
138.4	4.15	138.4	16.7
138.6	4.28	138.6	17.2
138.8	4.41	138.8	17.7
139.0	4.54	139.0	18.2
139.2	4.67	139.2	18.7
139.4	4.80	139.4	19.2
139.6	4.93	139.6	19.7
139.8	5.06	139.8	20.2
140.0	5.19	140.0	20.7
140.2	5.32	140.2	21.2
140.4	5.45	140.4	21.7
140.6	5.58	140.6	22.2
140.8	5.71	140.8	22.7
141.0	5.84	141.0	23.2
141.2	5.97	141.2	23.7
141.4	6.10	141.4	24.2
141.6	6.23	141.6	24.7
141.8	6.36	141.8	25.2
142.0	6.49	142.0	25.7
142.2	6.62	142.2	26.2
142.4	6.75	142.4	26.7
142.6	6.88	142.6	27.2
142.8	7.01	142.8	27.7
143.0	7.14	143.0	28.2
143.2	7.27	143.2	28.7
143.4	7.40	143.4	29.2
143.6	7.53	143.6	29.7
143.8	7.66	143.8	30.2
144.0	7.79	144.0	30.7
144.2	7.92	144.2	31.2
144.4	8.05	144.4	31.7
144.6	8.18	144.6	32.2
144.8	8.31	144.8	32.7
145.0	8.44	145.0	33.2
145.2	8.57	145.2	33.7
145.4	8.70	145.4	34.2
145.6	8.83	145.6	34.7
145.8	8.96	145.8	35.2
146.0	9.09	146.0	35.7
146.2	9.22	146.2	36.2
146.4	9.35	146.4	36.7
146.6	9.48	146.6	37.2
146.8	9.61	146.8	37.7
147.0	9.74	147.0	38.2
147.2	9.87	147.2	38.7
147.4	10.00	147.4	39.2
147.6	10.13	147.6	39.7
147.8	10.26	147.8	40.2
148.0	10.39	148.0	40.7
148.2	10.52	148.2	41.2
148.4	10.65	148.4	41.7
148.6	10.78	148.6	42.2
148.8	10.91	148.8	42.7
149.0	11.04	149.0	43.2
149.2	11.17	149.2	43.7
149.4	11.30	149.4	44.2
149.6	11.43	149.6	44.7
149.8	11.56	149.8	45.2
150.0	11.69	150.0	45.7

Sheet 1 of 4

S 1/2 18TH STREET WL Sunset Heights Addn to EL Sunset Heights Addn 13-2-15 A.C. CITY OF WICHITA, KANSAS B.E. SMITH CITY ENGINEER PROJ. NO. C14-345	N 1/2 18TH STREET EL Westridge to WL Sheridan 13-2-15 A.C. PROJ. NO. C15-150
-------------------------------------------------------------------------------------------------------------------------------------------------------------------------------------	---------------------------------------------------------------------------------------------------------



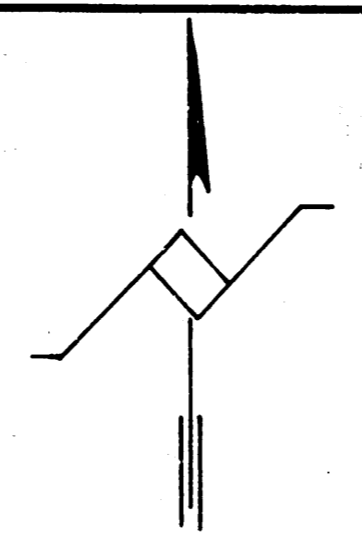

BM: 125.146 Standard SE cor Sheridan # 17th
BM: 127.20 NW cor lower step Host 1860 Sheridan - SE cor Sheridan # 18th

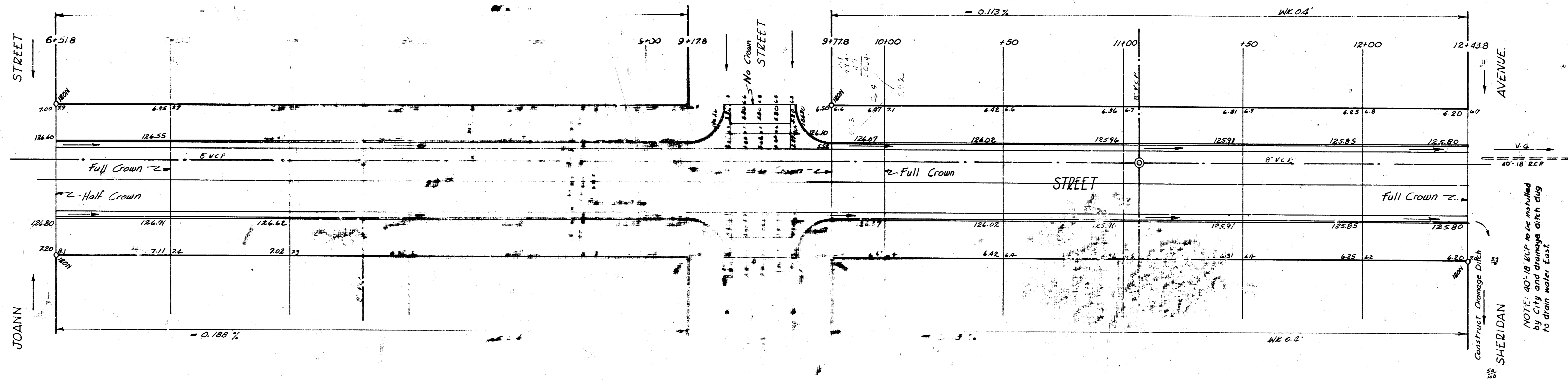

Sheet 2 of 4
N 1/2 18th St - Proj. No. C14-345
S 1/2 18th St - Proj. No. C15-150
EL Westridge to W. Sheridan.