

NOTE: REPLACE
6TR&B. W.S. BURNS
WITH 10'R.

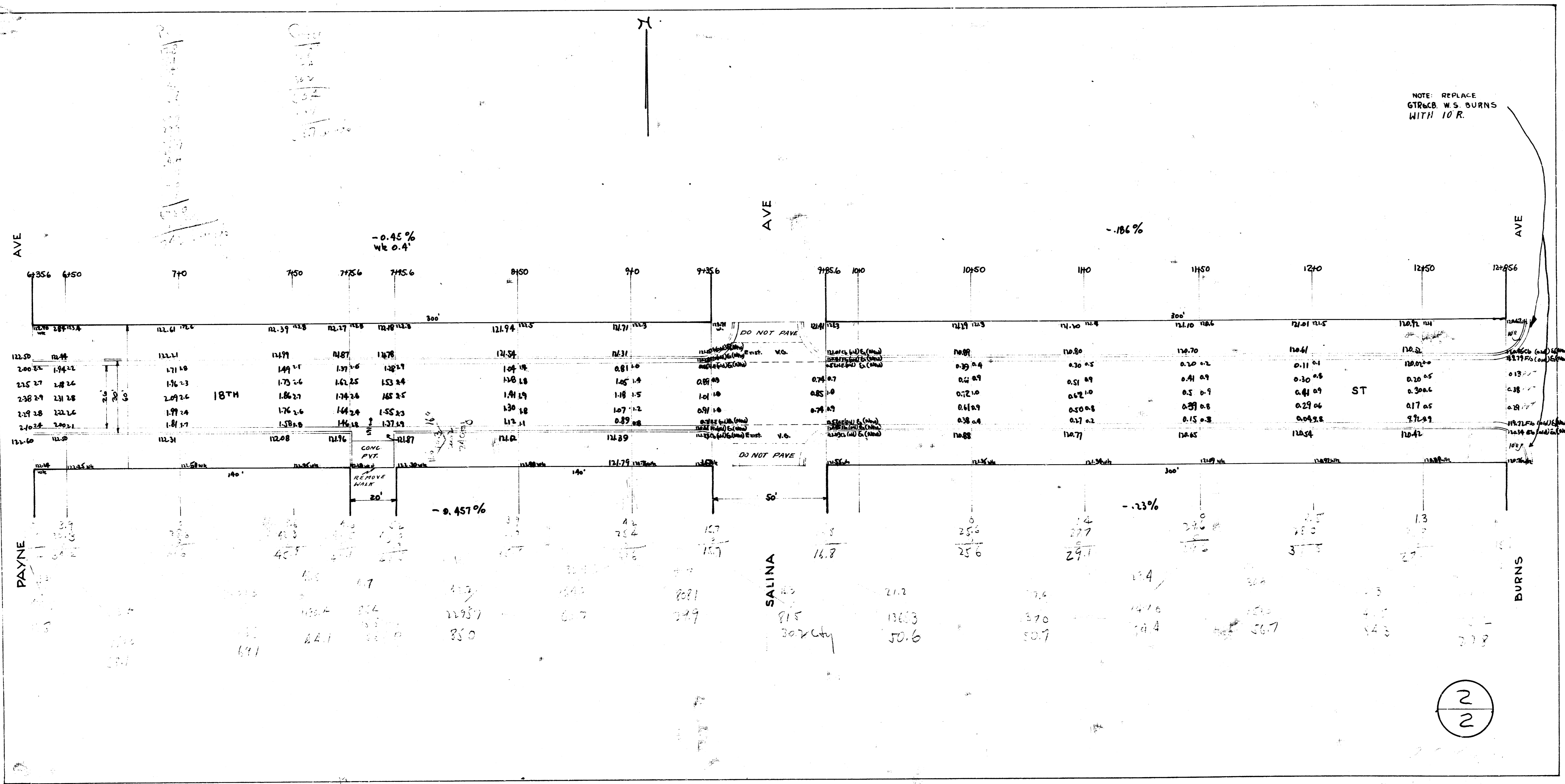

2
2

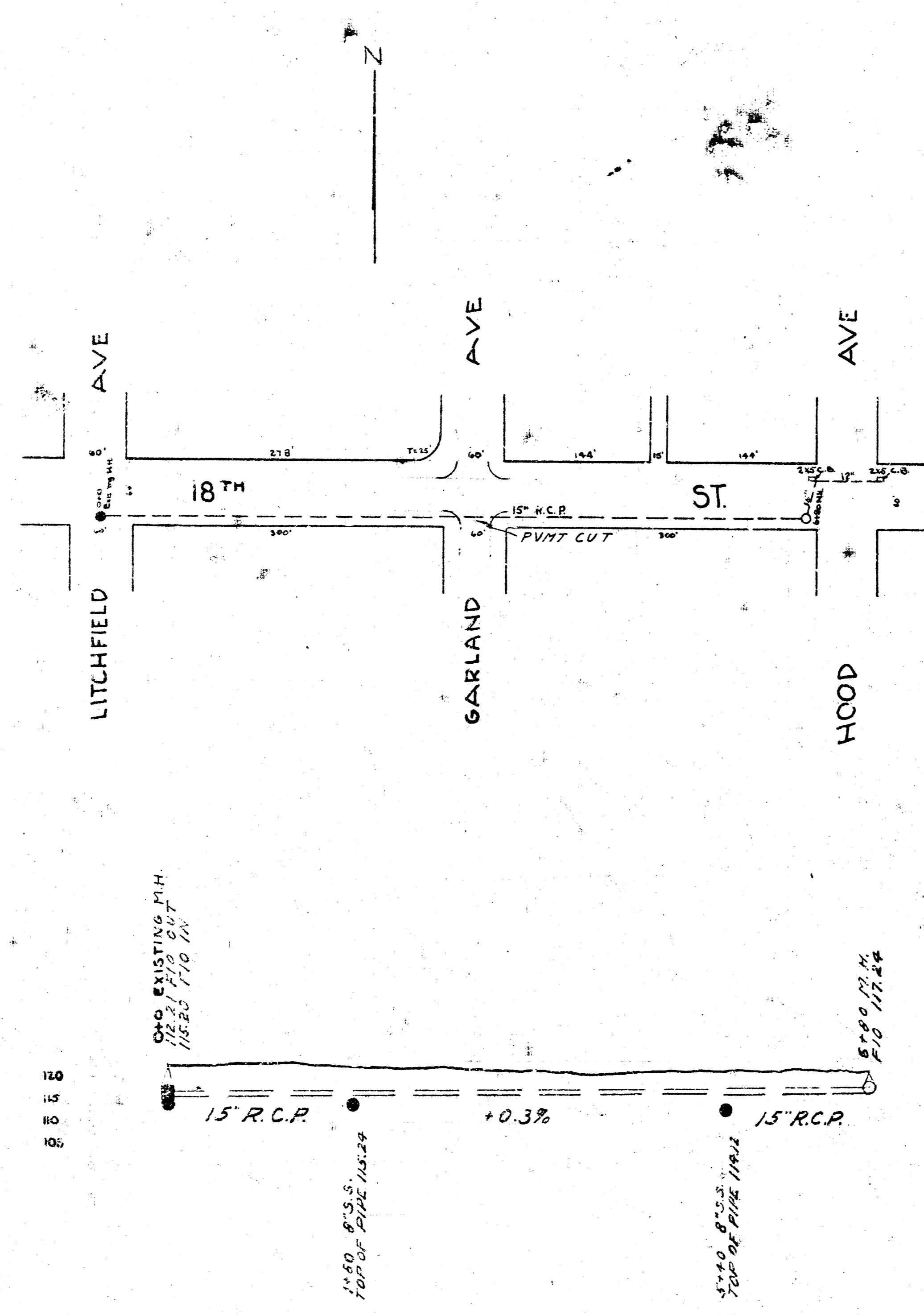

Department of Service
 CITY OF WICHITA, KANS.
 Engineering Division
 L.K. WHITE-CITY ENGINEER
 S.W. Sewer - Incidental Drainage to Paving
 18TH ST. E.L. GARLAND TO W.L. BURNS AVE.
 Scale 1" = 60'
 June 1947

310