

B.M. 130.52 6" in Globe on walk
S. side of No. 2002 N. Grove.

B.M. 132.13 4" in 1949 S. curb
of 19th St. W.L. Poplar.

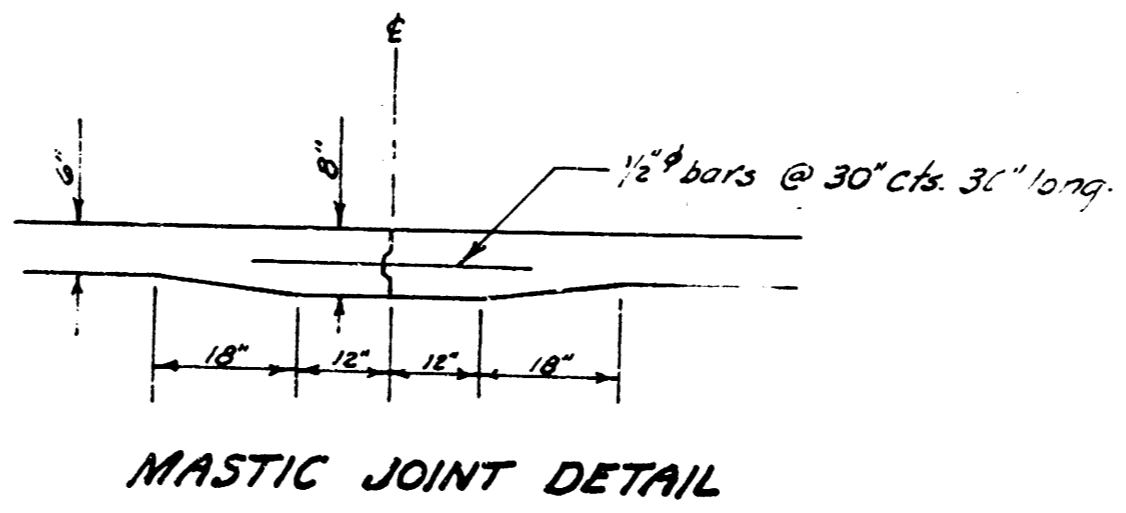

19th STREET
E.L. GROVE TO W.L. VOLUTSIA
6" Conc., Integral Curb
CITY OF WICHITA, KANSAS
B.E. SMITH, CITY ENGINEER
MAY 1961, Proj. No. C11-3

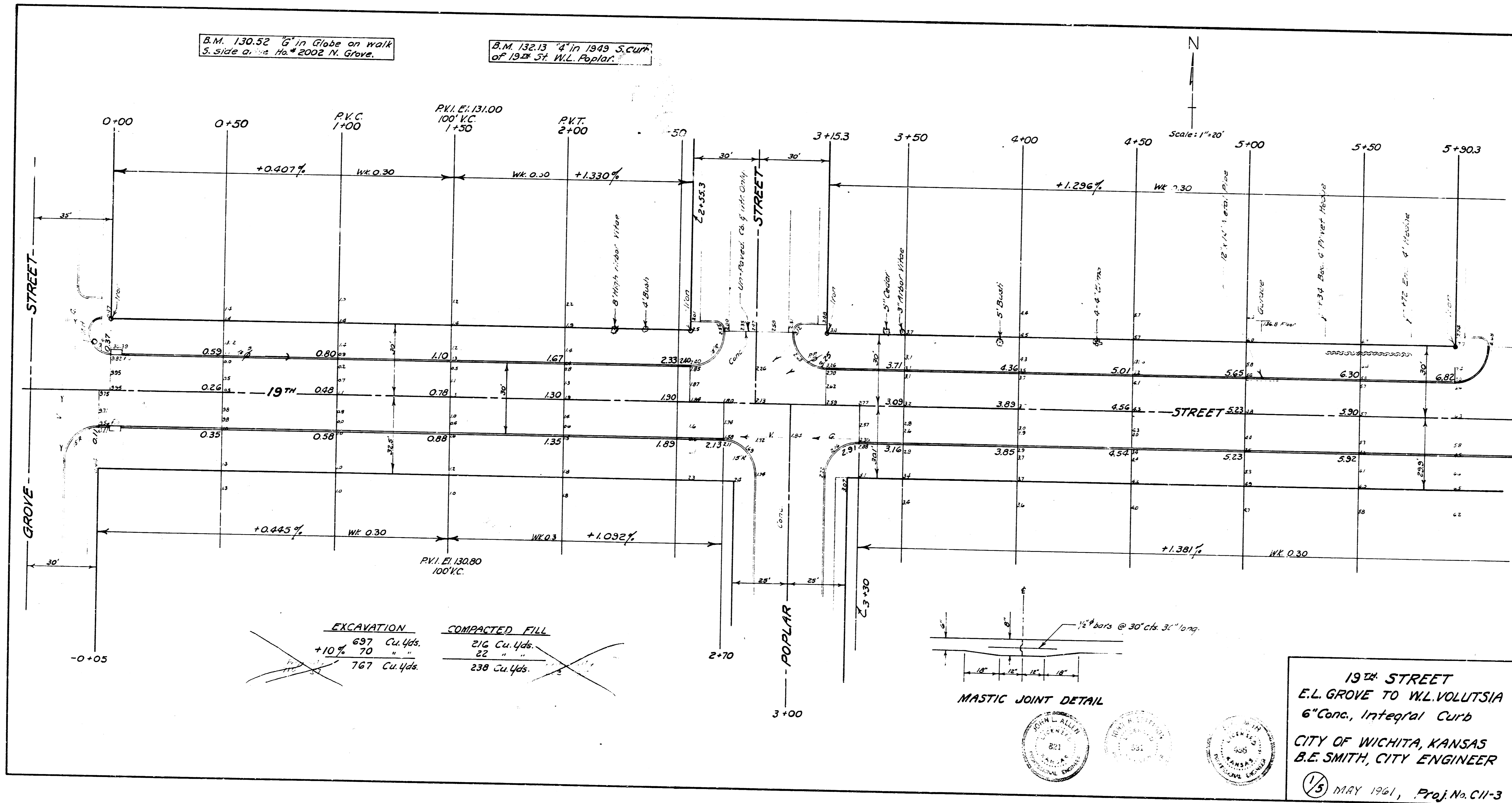

B.M. 137.30 "O" in Dondlinger N. end of walk S.L. 13th at Green.

B.M. 150.04 "G" in Globe on walk 4th N. of N.L. 19th at E.S. of Estelle.

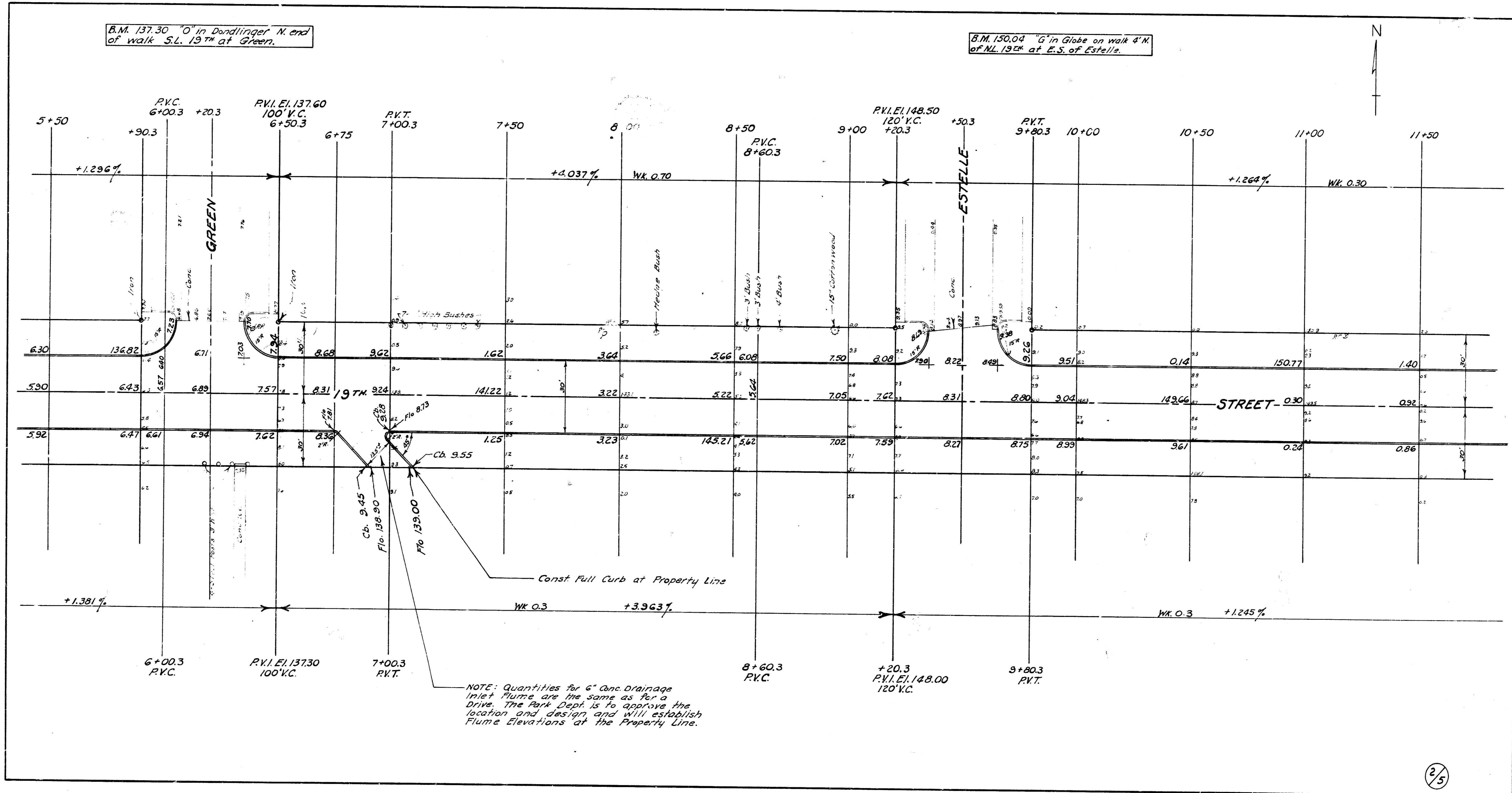

NOTE: Quantities for 6" Conc Drainage Inlet Fume are the same as for a Drive. The Park Dept. is to approve the location and design and will establish Fume Elevations at the Property Line.

