

SCALE = 1" = 20 FT.

BM 21776 2" IN BITUMIN ASPHALT OVER PARADES HL. RIDGEWOOD
 BM 21841 3" DIA 5" SH. BRD. PIPES 15' W. 35' N. OF N. BEAUMONT.
 BASE LINE - 60' N. OF North Curve Line Chaining Book

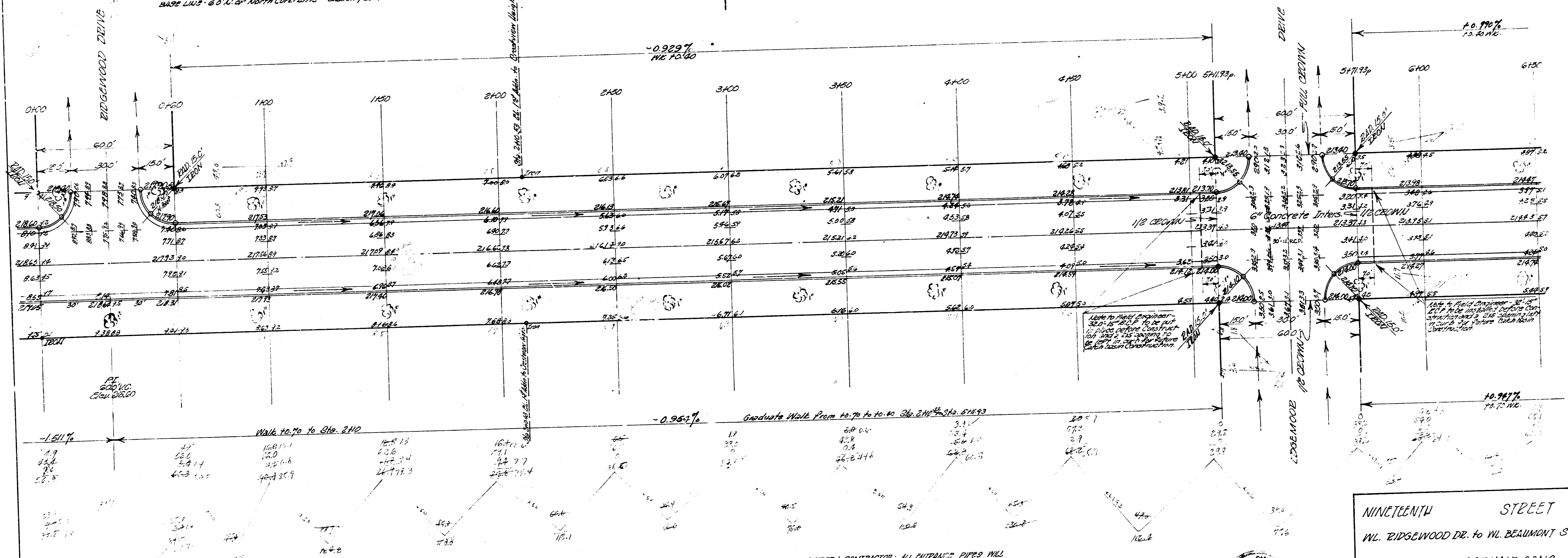

NOTE TO FIELD ENGINEER & CONTRACTOR: ALL DIMENSIONS SHOWN WILL BE DISPOSED OF IN ACCORDANCE WITH CITY AND STATE CODES.

EXCAVATION TOTALS

PROP.	CITY
108' 0"	218' 0"
108' 0"	218' 0"
388' 0"	744' 0"
TOTALS	
FILL	CITY
0	0
0	0

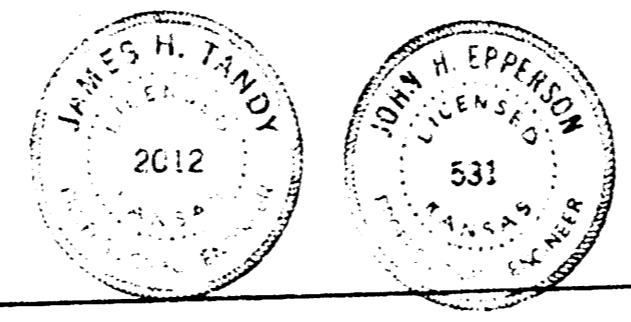

NINETEENTH STREET
 W. RIDGEWOOD DR. to W. BEAUMONT ST.
 26-2-30 ASPHALT CONC.
 CITY OF WICHITA, KANSAS
 B.E. SMITH CITY ENGINEER
 Date: JULY 1958 PROJ. NO. C18-31

Sheet 1-2

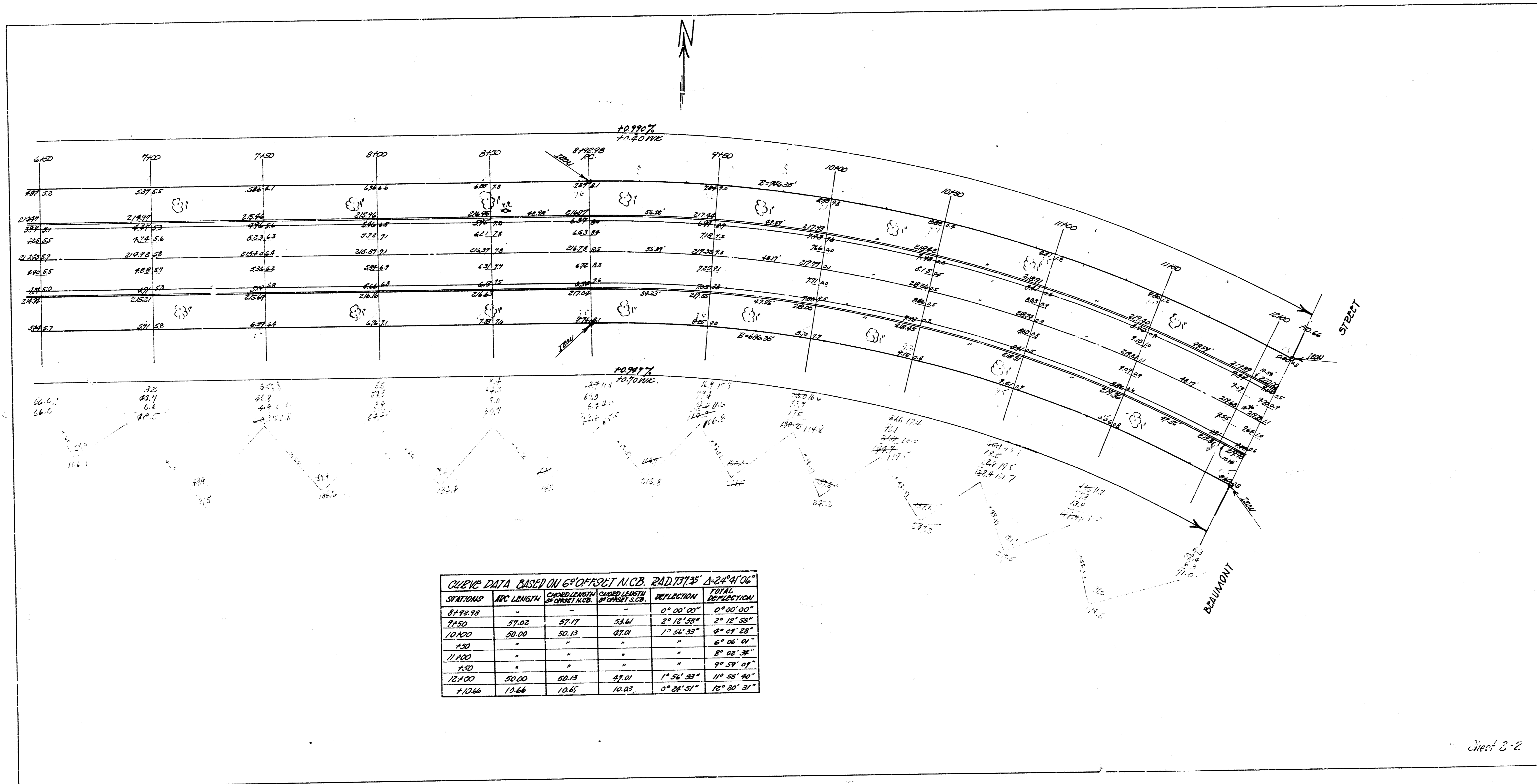

CHURCH DATA BASED ON 6° OFFSET A/C.B. RAD. 131.35' Δ=24°41'06"

STATIONS	AFC LENGTH	CHURCH LENGTH	CHURCH WIDTH	REFLECTION	TOTAL DEVIATION
8+95.78	-	-	-	0° 00' 00"	0° 00' 00"
9+80	57.02	57.17	53.61	2° 12' 55"	2° 12' 55"
10+00	50.00	50.13	47.01	1° 54' 33"	4° 07' 28"
1+20	"	"	"	"	6° 02' 01"
11+00	"	"	"	"	8° 59' 01"
1+50	50.00	50.13	47.01	1° 54' 33"	10° 53' 40"
12+00	12.66	12.65	10.03	0° 28' 51"	18° 22' 31"