

BM 122.40 "K" in Kensler. N end W. Co. S.W. Cor. Salina to 19th
 B.M. 124.40 5th Bench 2nd Power Pole W. of Salina 55 20th
 B.M. 122.65 "O" in Globe. N end E. Co. E. Side Burns 55 20th

P.P. Exc.
 120.0
 104.3
 124.1
 125.2
 125.7
 96.0
 95.4
 116.6
 122.4
 97.7
 92.3
 24.3
 4
 13368
 +10%
 1470 Sample
 -0.1019%
 W.M. O.S.
 City Exec.
 146
 135
 51.1
 42.2
 160.4
 7.10%
 176.4 Sample

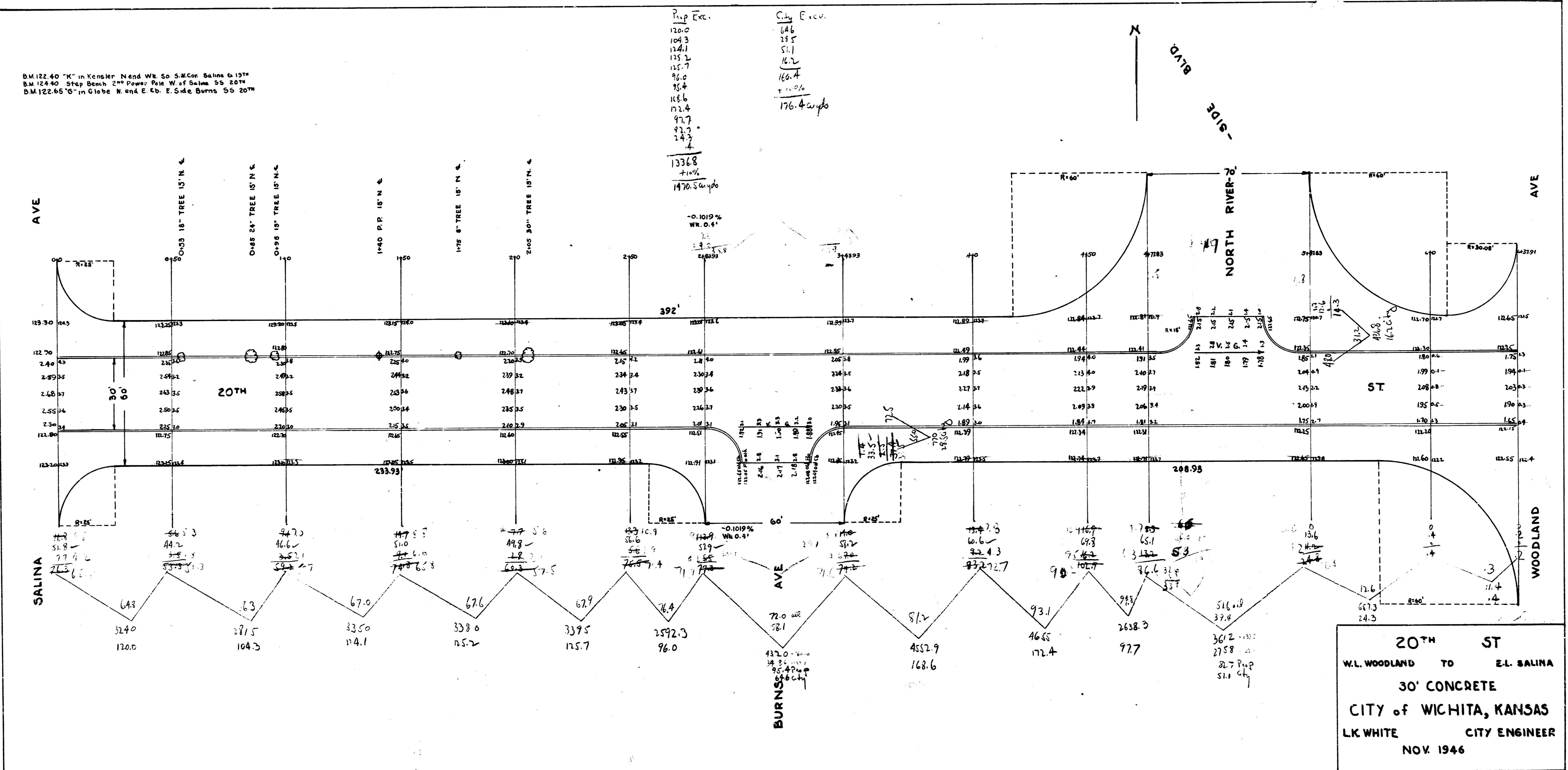

20TH ST
 W.L. WOODLAND TO E.L. SALINA
 30' CONCRETE
 CITY of WICHITA, KANSAS
 LK WHITE CITY ENGINEER
 NOV. 1946

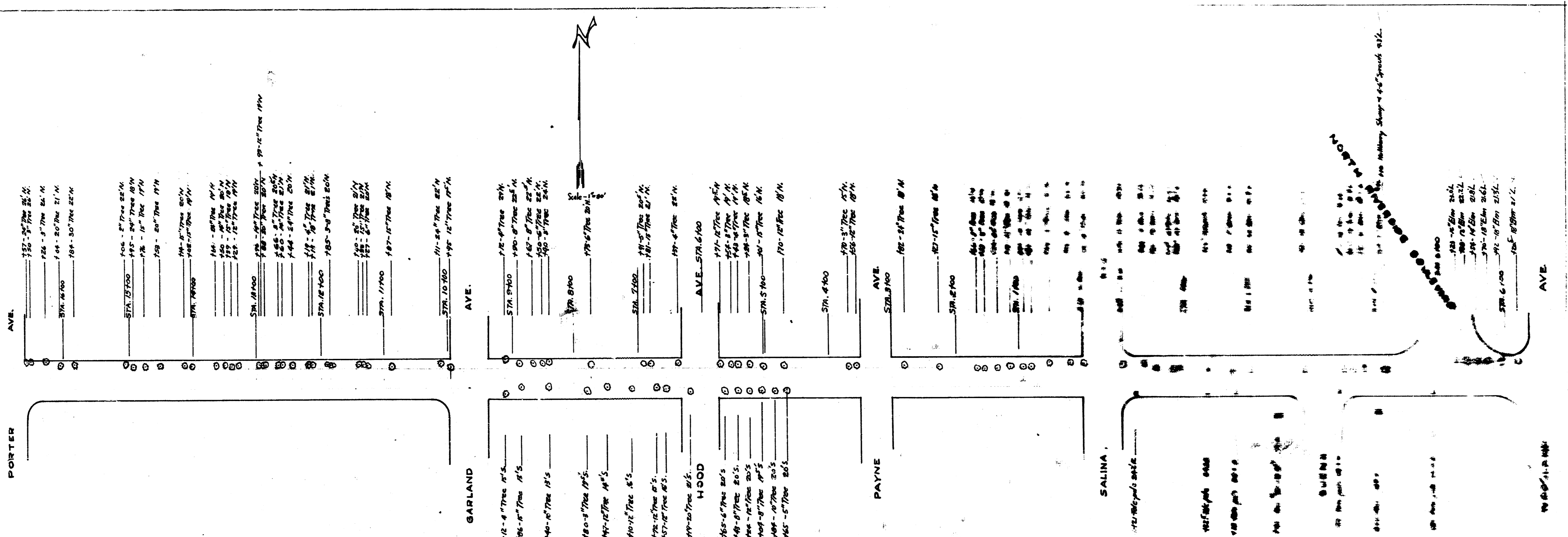

20th
 PORTER to
 CITY of WICHITA, KANSAS
 L.R. WHITE CITY ENGINEER
 JULY 1997

401 P