

21ST STREET

FROM W.L. WASHINGTON TO W.L. CLEVELAND

PROJECT NO. C13-21

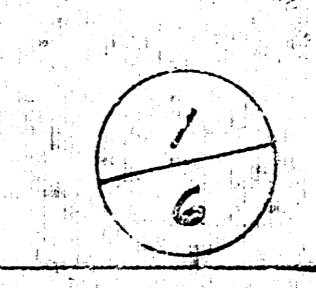

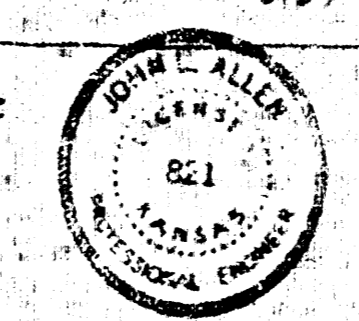
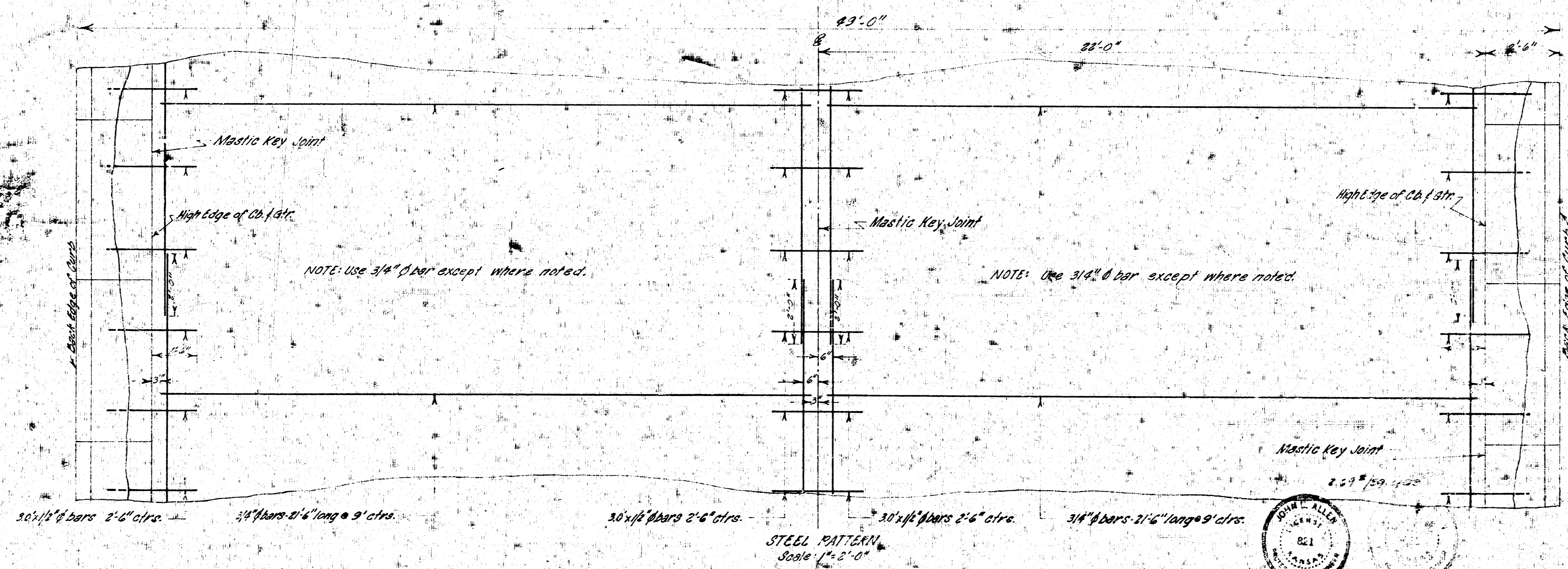
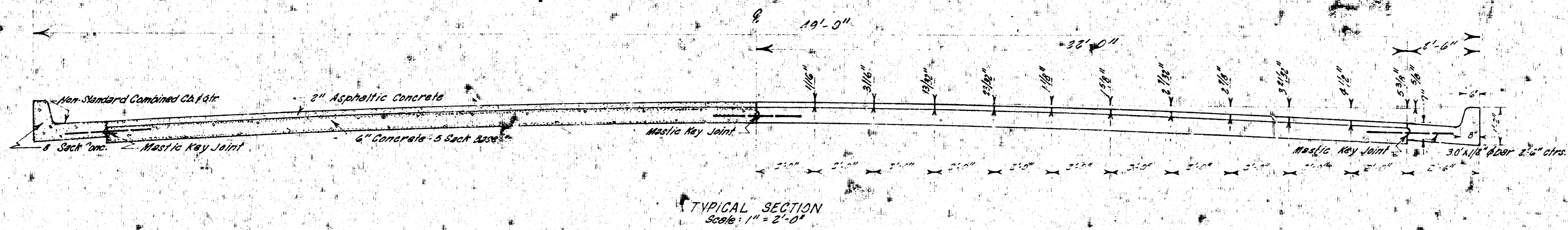
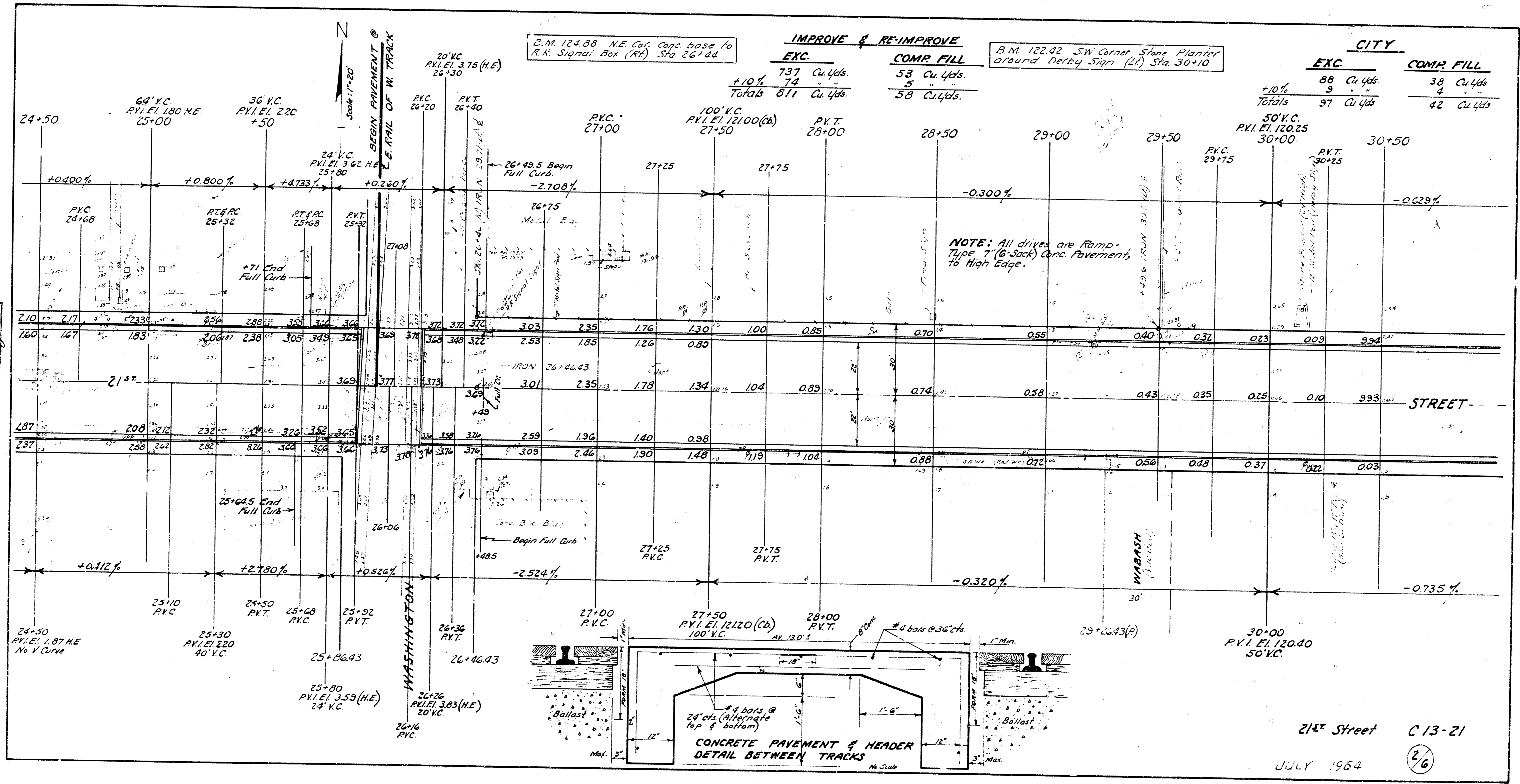

J.F.G. 89
J.L.A.
J.L.A.

B.M. 120.08 "X" cut on Conc. Footing to Foundation N.W. Cor. Bldg. (Rt) Sta 34+30

PROPERTY	
EXC.	COMP. FILL
1254 Cu Yds	51 Cu Yds
+10%	5
Totals 1379 Cu Yds.	56 Cu Yds.

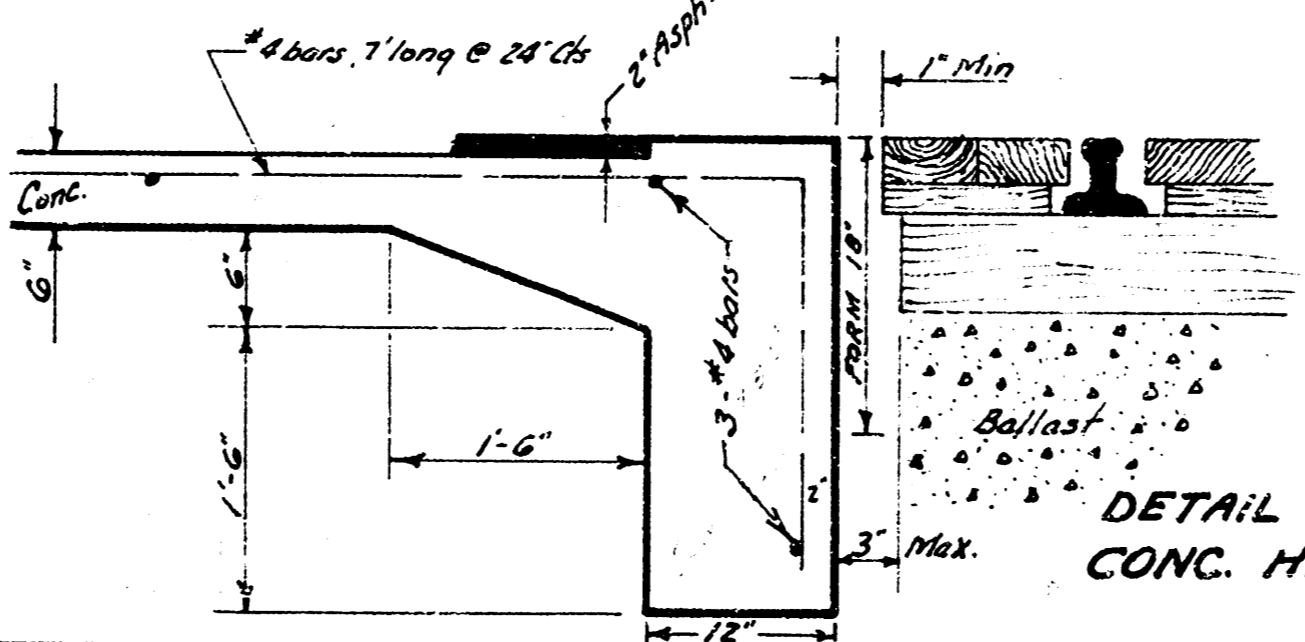
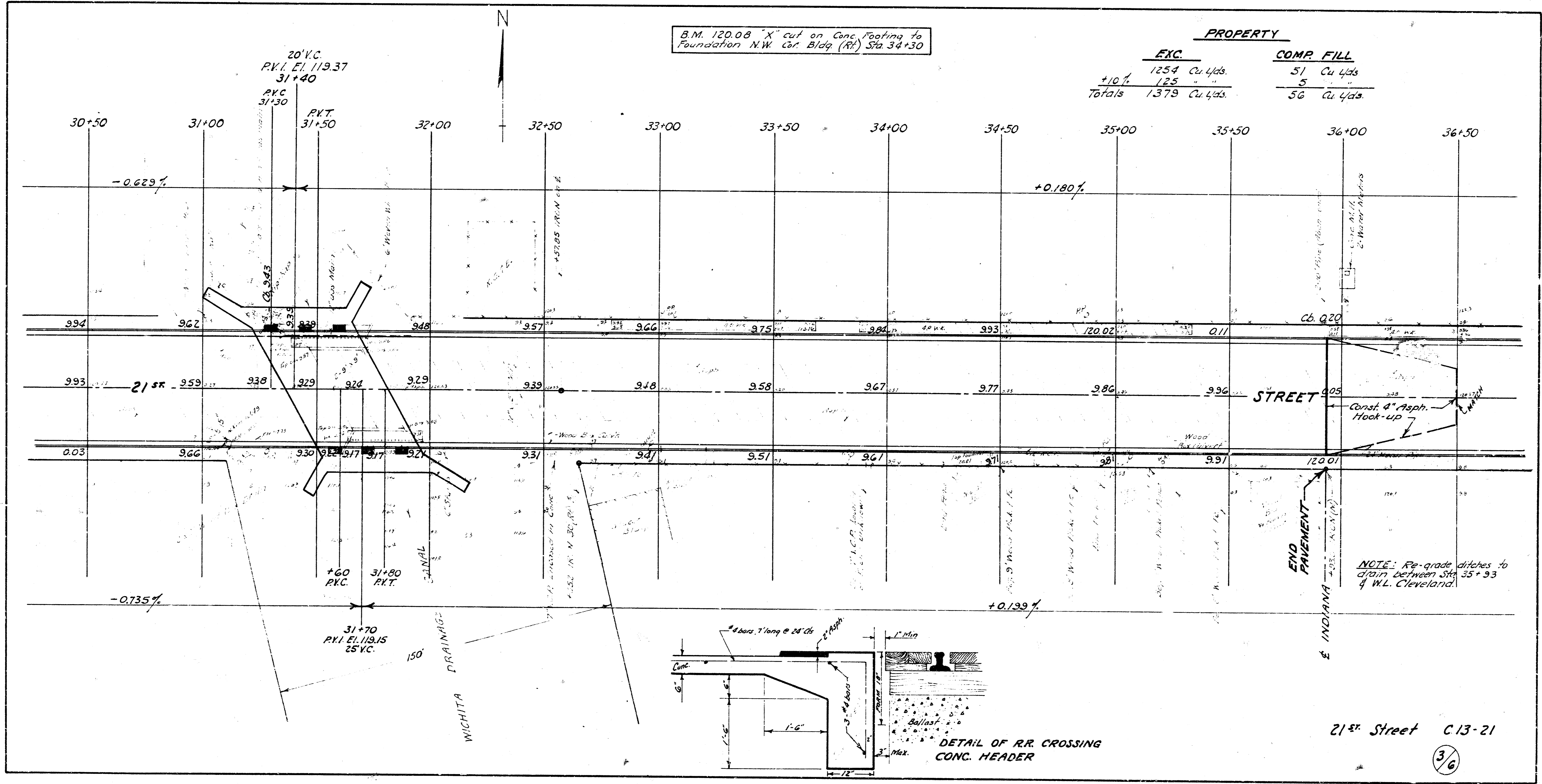

DETAIL OF R.R. CROSSING CONC. HEADER

21st Street C13-21

3/6

NOTE: Re-grade ditches to 270m between Sta 35+33 & WL. Cleveland

END PAVEMENT

Const. 4" Asph. Hook-up

WOOD BRIDGE

PROPERTY