

E.M. 126.88 Sk. cont. cont. porch, House # 2502 N. Somerset
 Stationing on N. E.

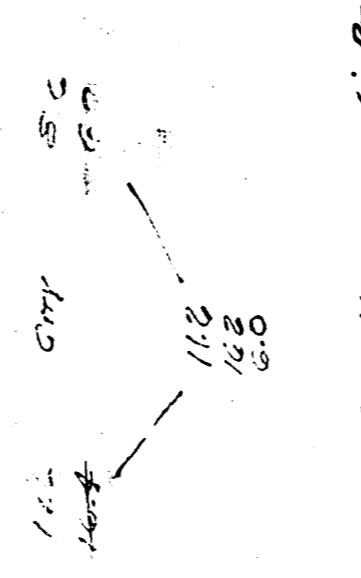

3x22.5 Fire Hydrant 6' dia.

4x55 M.H. 6' dia.

Checked
 Exec. C. B. Smith
 Drawn by
 B. E. Smith

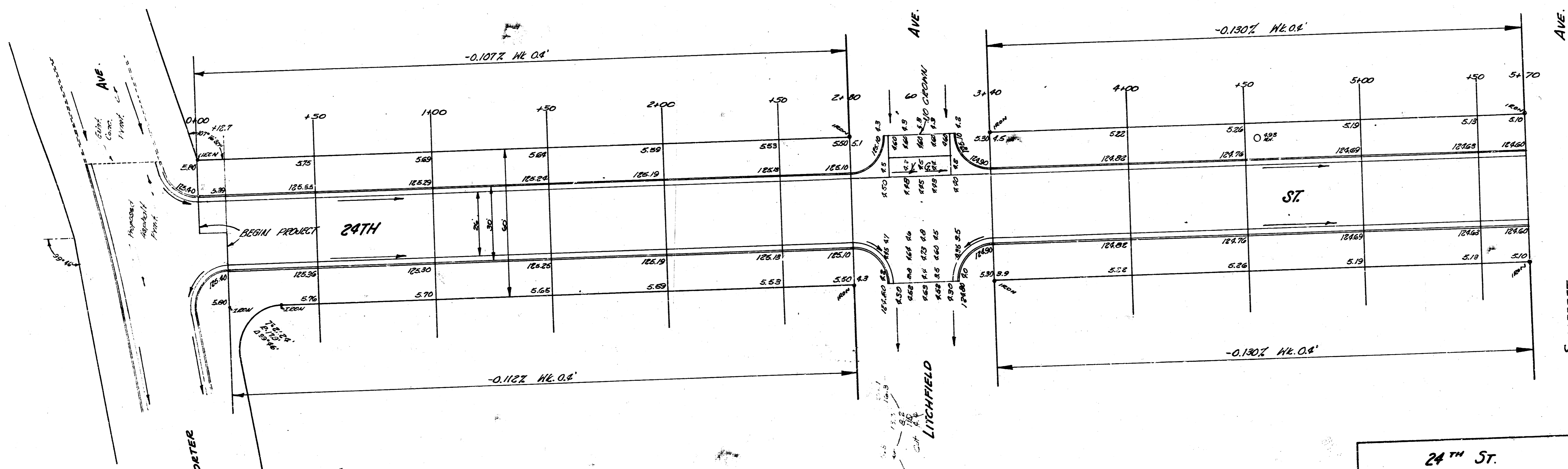

Station	Grade	Exc.	Quantity	Cut
126.88	5.75	1.00	1.00	1.00
126.89	5.80	1.00	1.00	1.00
126.90	5.85	1.00	1.00	1.00
126.91	5.90	1.00	1.00	1.00
126.92	5.95	1.00	1.00	1.00
126.93	6.00	1.00	1.00	1.00
126.94	6.05	1.00	1.00	1.00
126.95	6.10	1.00	1.00	1.00
126.96	6.15	1.00	1.00	1.00
126.97	6.20	1.00	1.00	1.00
126.98	6.25	1.00	1.00	1.00
126.99	6.30	1.00	1.00	1.00
127.00	6.35	1.00	1.00	1.00
127.01	6.40	1.00	1.00	1.00
127.02	6.45	1.00	1.00	1.00
127.03	6.50	1.00	1.00	1.00
127.04	6.55	1.00	1.00	1.00
127.05	6.60	1.00	1.00	1.00
127.06	6.65	1.00	1.00	1.00
127.07	6.70	1.00	1.00	1.00
127.08	6.75	1.00	1.00	1.00
127.09	6.80	1.00	1.00	1.00
127.10	6.85	1.00	1.00	1.00
127.11	6.90	1.00	1.00	1.00
127.12	6.95	1.00	1.00	1.00
127.13	7.00	1.00	1.00	1.00
127.14	7.05	1.00	1.00	1.00
127.15	7.10	1.00	1.00	1.00
127.16	7.15	1.00	1.00	1.00
127.17	7.20	1.00	1.00	1.00
127.18	7.25	1.00	1.00	1.00
127.19	7.30	1.00	1.00	1.00
127.20	7.35	1.00	1.00	1.00
127.21	7.40	1.00	1.00	1.00
127.22	7.45	1.00	1.00	1.00
127.23	7.50	1.00	1.00	1.00
127.24	7.55	1.00	1.00	1.00
127.25	7.60	1.00	1.00	1.00
127.26	7.65	1.00	1.00	1.00
127.27	7.70	1.00	1.00	1.00
127.28	7.75	1.00	1.00	1.00
127.29	7.80	1.00	1.00	1.00
127.30	7.85	1.00	1.00	1.00
127.31	7.90	1.00	1.00	1.00
127.32	7.95	1.00	1.00	1.00
127.33	8.00	1.00	1.00	1.00
127.34	8.05	1.00	1.00	1.00
127.35	8.10	1.00	1.00	1.00
127.36	8.15	1.00	1.00	1.00
127.37	8.20	1.00	1.00	1.00
127.38	8.25	1.00	1.00	1.00
127.39	8.30	1.00	1.00	1.00
127.40	8.35	1.00	1.00	1.00
127.41	8.40	1.00	1.00	1.00
127.42	8.45	1.00	1.00	1.00
127.43	8.50	1.00	1.00	1.00
127.44	8.55	1.00	1.00	1.00
127.45	8.60	1.00	1.00	1.00
127.46	8.65	1.00	1.00	1.00
127.47	8.70	1.00	1.00	1.00
127.48	8.75	1.00	1.00	1.00
127.49	8.80	1.00	1.00	1.00
127.50	8.85	1.00	1.00	1.00
127.51	8.90	1.00	1.00	1.00
127.52	8.95	1.00	1.00	1.00
127.53	9.00	1.00	1.00	1.00
127.54	9.05	1.00	1.00	1.00
127.55	9.10	1.00	1.00	1.00
127.56	9.15	1.00	1.00	1.00
127.57	9.20	1.00	1.00	1.00
127.58	9.25	1.00	1.00	1.00
127.59	9.30	1.00	1.00	1.00
127.60	9.35	1.00	1.00	1.00
127.61	9.40	1.00	1.00	1.00
127.62	9.45	1.00	1.00	1.00
127.63	9.50	1.00	1.00	1.00
127.64	9.55	1.00	1.00	1.00
127.65	9.60	1.00	1.00	1.00
127.66	9.65	1.00	1.00	1.00
127.67	9.70	1.00	1.00	1.00
127.68	9.75	1.00	1.00	1.00
127.69	9.80	1.00	1.00	1.00
127.70	9.85	1.00	1.00	1.00
127.71	9.90	1.00	1.00	1.00
127.72	9.95	1.00	1.00	1.00
127.73	10.00	1.00	1.00	1.00
127.74	10.05	1.00	1.00	1.00
127.75	10.10	1.00	1.00	1.00
127.76	10.15	1.00	1.00	1.00
127.77	10.20	1.00	1.00	1.00
127.78	10.25	1.00	1.00	1.00
127.79	10.30	1.00	1.00	1.00
127.80	10.35	1.00	1.00	1.00
127.81	10.40	1.00	1.00	1.00
127.82	10.45	1.00	1.00	1.00
127.83	10.50	1.00	1.00	1.00
127.84	10.55	1.00	1.00	1.00
127.85	10.60	1.00	1.00	1.00
127.86	10.65	1.00	1.00	1.00
127.87	10.70	1.00	1.00	1.00
127.88	10.75	1.00	1.00	1.00
127.89	10.80	1.00	1.00	1.00
127.90	10.85	1.00	1.00	1.00
127.91	10.90	1.00	1.00	1.00
127.92	10.95	1.00	1.00	1.00
127.93	11.00	1.00	1.00	1.00
127.94	11.05	1.00	1.00	1.00
127.95	11.10	1.00	1.00	1.00
127.96	11.15	1.00	1.00	1.00
127.97	11.20	1.00	1.00	1.00
127.98	11.25	1.00	1.00	1.00
127.99	11.30	1.00	1.00	1.00
128.00	11.35	1.00	1.00	1.00
128.01	11.40	1.00	1.00	1.00
128.02	11.45	1.00	1.00	1.00
128.03	11.50	1.00	1.00	1.00
128.04	11.55	1.00	1.00	1.00
128.05	11.60	1.00	1.00	1.00
128.06	11.65	1.00	1.00	1.00
128.07	11.70	1.00	1.00	1.00
128.08	11.75	1.00	1.00	1.00
128.09	11.80	1.00	1.00	1.00
128.10	11.85	1.00	1.00	1.00
128.11	11.90	1.00	1.00	1.00
128.12	11.95	1.00	1.00	1.00
128.13	12.00	1.00	1.00	1.00
128.14	12.05	1.00	1.00	1.00
128.15	12.10	1.00	1.00	1.00
128.16	12.15	1.00	1.00	1.00
128.17	12.20	1.00	1.00	1.00
128.18	12.25	1.00	1.00	1.00
128.19	12.30	1.00	1.00	1.00
128.20	12.35	1.00	1.00	1.00
128.21	12.40	1.00	1.00	1.00
128.22	12.45	1.00	1.00	1.00
128.23	12.50	1.00	1.00	1.00
128.24	12.55	1.00	1.00	1.00
128.25	12.60	1.00	1.00	1.00
128.26	12.65	1.00	1.00	1.00
128.27	12.70	1.00	1.00	1.00
128.28	12.75	1.00	1.00	1.00
128.29	12.80	1.00	1.00	1.00
128.30	12.85	1.00	1.00	1.00
128.31	12.90	1.00	1.00	1.00
128.32	12.95	1.00	1.00	1.00
128.33	13.00	1.00	1.00	1.00
128.34	13.05	1.00	1.00	1.00
128.35	13.10	1.00	1.00	1.00
128.36	13.15	1.00	1.00	1.00
128.37	13.20	1.00	1.00	1.00
128.38	13.25	1.00	1.00	1.00
128.39	13.30	1.00	1.00	1.00
128.40	13.35	1.00	1.00	1.00
128.41	13.40	1.00	1.00	1.00
128.42	13.45	1.00	1.00	1.00
128.43	13.50	1.00	1.00	1.00
128.44	13.55	1.00	1.00	1.00
128.45	13.60	1.00	1.00	1.00
128.46	13.65	1.00	1.00	1.00
128.47	13.70	1.00	1.00	1.00
128.48	13.75	1.00	1.00	1.00
128.49	13.80	1.00	1.00	1.00
128.50	13.85	1.00	1.00	1.00
128.51	13.90	1.00	1.00	1.00
128.52	13.95	1.00	1.00	1.00
128.53	14.00	1.00	1.00	1.00
128.54	14.05	1.00	1.00	1.00
128.55	14.10	1.00	1.00	1.00
128.56	14.15	1.00	1.00	1.00
128.57	14.20	1.00	1.00	1.00
128.58	14.25	1.00	1.00	1.00
128.59	14.30	1.00	1.00	1.00
128.60	14.35	1.00	1.00	1.00
128.61	14.40	1.00	1.00	1.00
128.62	14.45	1.00	1.00	1.00
128.63	14.50	1.00	1.00	1.00
128.64	14.55	1.00	1.00	1.00
128.65	14.60	1.00	1.00	1.00
128.66	14.65	1.00	1.00	1.00
128.67	14.70	1.00	1.00	1.00
128.68	14.75	1.00	1.00	1.00
128.69	14.80	1.00	1.00	1.00
128.70	14.85	1.00	1.00	1.00
128.71	14.90	1.00	1.00	1.00
128.72	14.95	1.00	1.00	1.00
128.73	15.00	1.00	1.00	1.00
128.74	15.05	1.00	1.00	1.00
128.75	15.10	1.00	1.00	1.00
128.76	15.15	1.00	1.00	1.00
128.77	15.20	1.00	1.00	1.00
128.78	15.25	1.00	1.00	1.00
128.79	15.30	1.00	1.00	1.00
128.80	15.35	1.00	1.00	1.00
128.81	15.40	1.00	1.00	1.00
128.82	15.45	1.00	1.00	1.00
128.83	15.50	1.00	1.00	

