

NOTE TO FIELD ENGINEER:
 RE-X-SECTION PROJECT BEFORE BEGINNING CONSTRUCTION.
 AFTER CONSTRUCTION, RE-X-SECTION NORTH MEDIAL STRIP.

B.M. #60 SPIKE N.W.S. PR @ MERIDIAN & 25TH ST. ELEV. 129.72

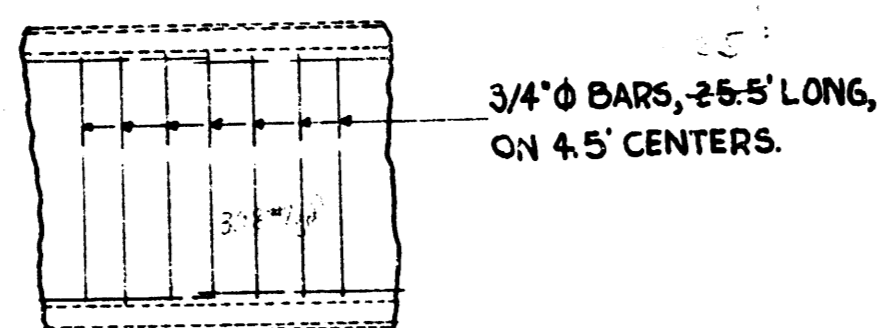

DR.

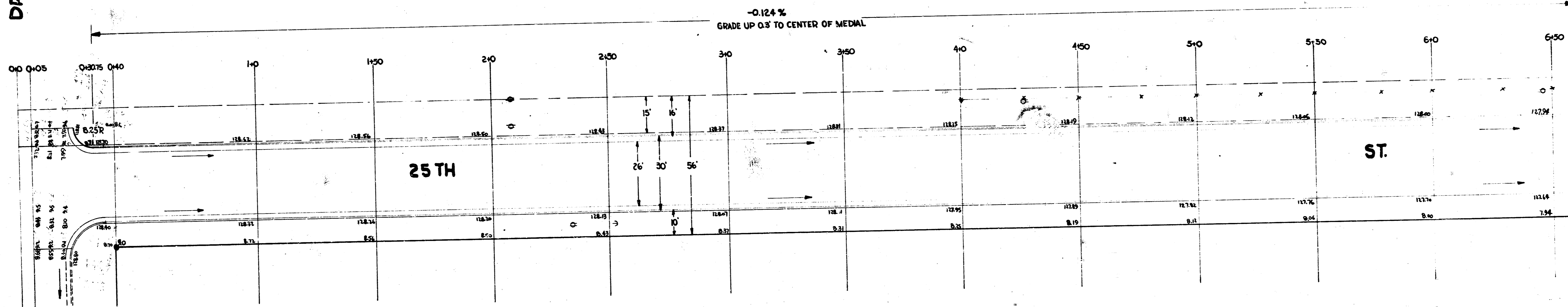

BULLINGER

-0.124%
WK 0.5'

1/5



1/2 25TH ST.
 W.L. RIVERLAWN HTS. ADDN. TO W.L. HALSTEAD
13-2-17 A.C. PROJ. NO. C14-209
WIDEN 13' A.C. 6" BASE NO. C14-210
CITY OF WICHITA, KANSAS
 B.E. SMITH CITY ENGINEER
 APRIL 1955

T.P. TOP IRON SW COR RICHMOND & 25TH ELEV. 126.63

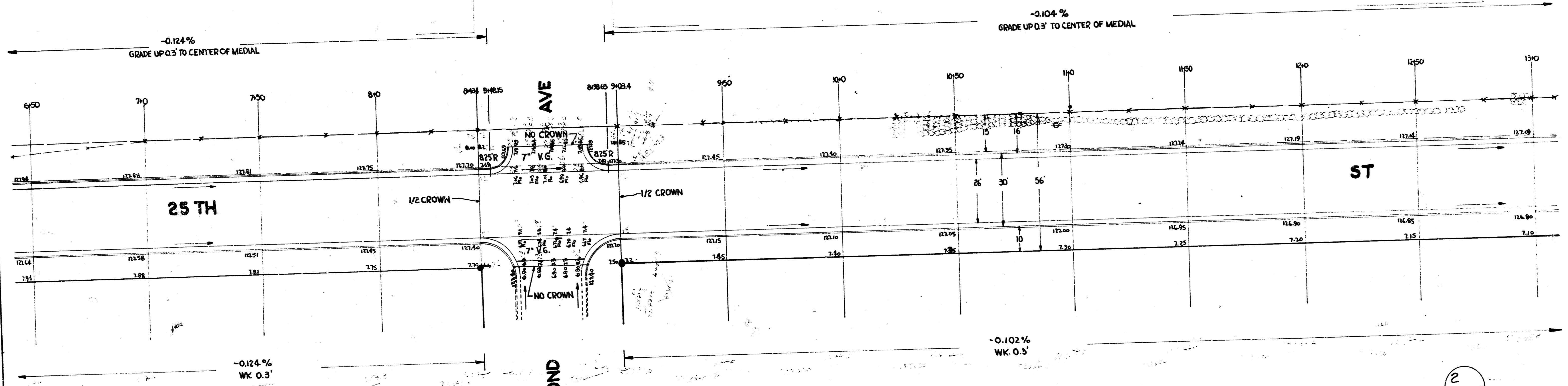

2
5

S/2 25TH ST.
PROJ. NOS. C14-209 & 210

B.M. NWCOR CONC PORCH, HO ON N.E. COR 25TH & HALSTEAD ELEV. 126.99

