

B.M. 130.295 'T' in Troy fire hydrant S.W. 28<sup>th</sup> & Market.

B.M. 128.20 'M' in Mueller, fire hydrant S.W. 28<sup>th</sup> & Market.

NOTE: X-Sections are attached to Plans for Project C12-5

Young B. #2007  
 J.E.H.  
 1/2"

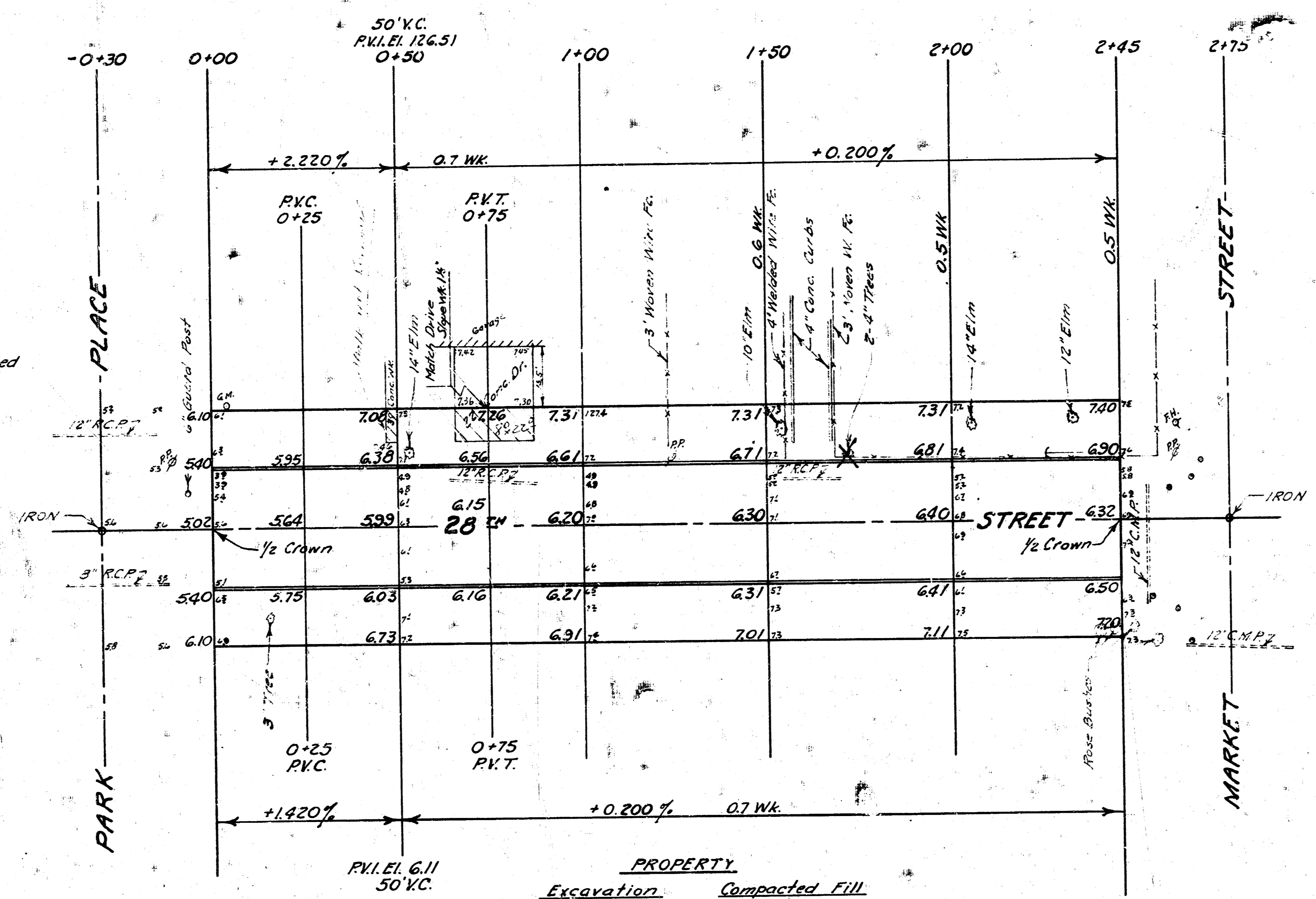

PROPERTY		
	Excavation	Compacted Fill
Cu. Yds.	339	23
+10%	34	2
Totals	373	25

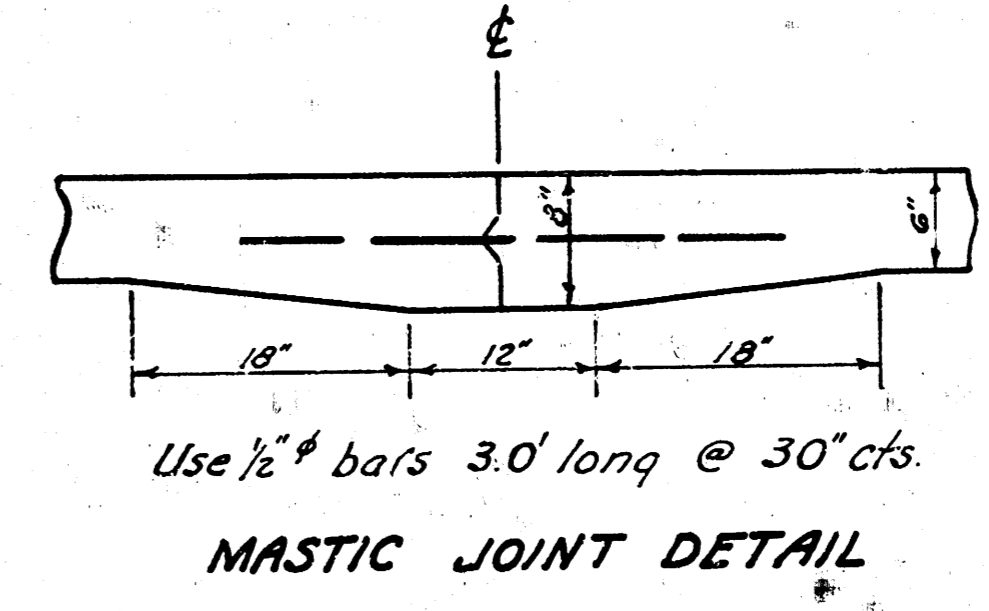
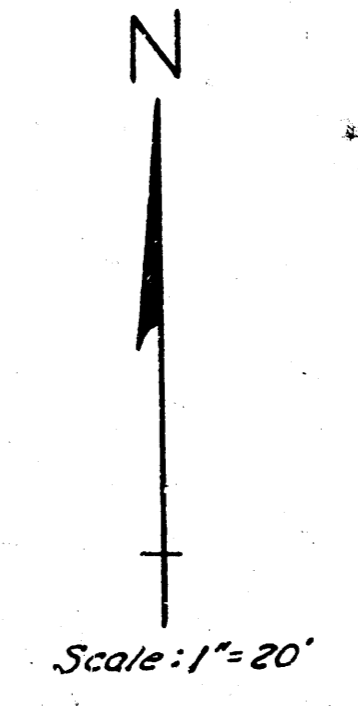

28<sup>th</sup> STREET N.  
 E.L. PARK PLACE to W.L. MARKET  
 30' Conc. & Int. Curb  
 B.E. SMITH CITY ENGINEER  
 CITY OF WICHITA, KANSAS  
 MAY 1962, Project No. C12-6

