

HIGHWAY US 54  
KELLOGG STREET WICHITA KS  
Layout Showing Present Topography at  
Sight of Proposed Viaduct over Railroad Yards  
Emporia St. to Washington St.  
Office of City Engineer  
Wichita Kansas April 1949

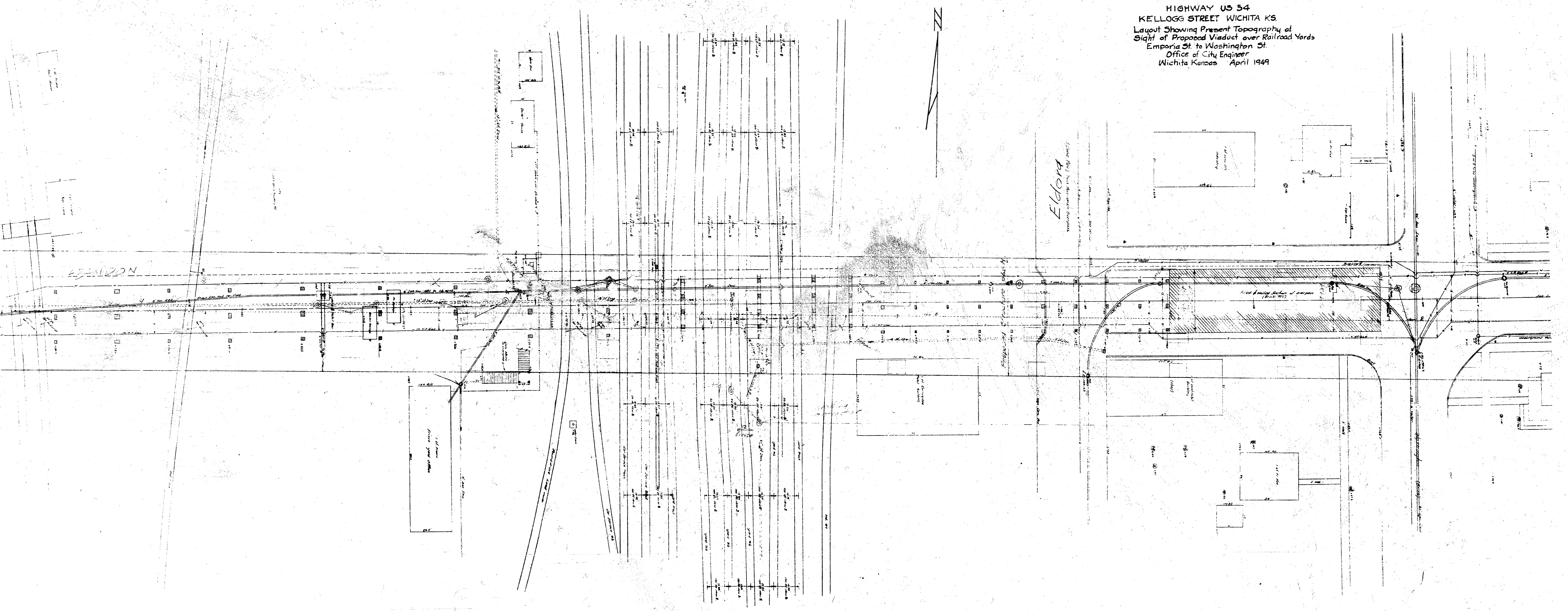

*Eldon*  
Wichita, Kansas, Mo. (City)

NORTH