

STA ON S R
 BM 95.67 STANDARD NE COR GLENN A 31st St So

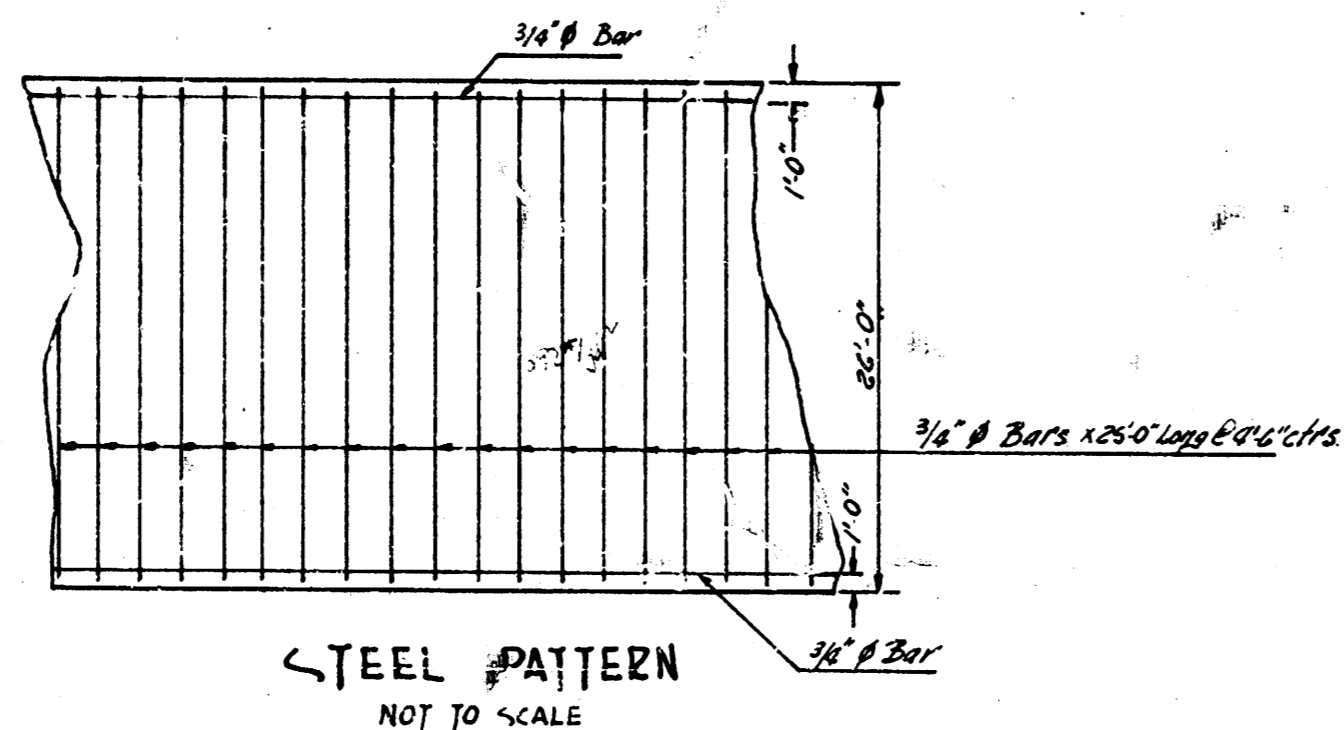

NOTE:
 INTERSECTION TO BE BUILT IN
 CONNECTION WITH WILLWOOD AVE.
 Proj. No. C13-278

GLENN AVE
 1/2\"/>

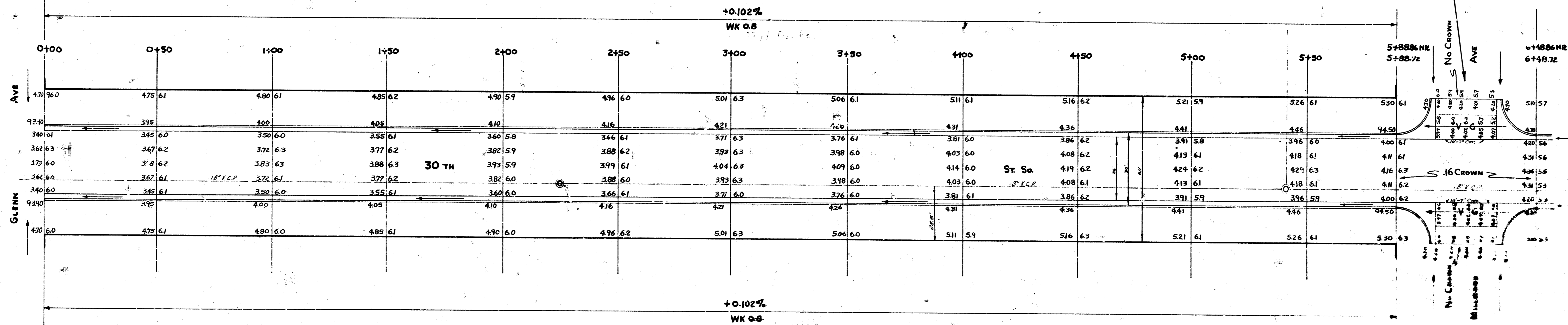

1/2

30TH ST So.
 E.L. GLENN TO W.L. ELIZABETH
 26-2-30 AC.
 CITY OF WICHITA, KANSAS
 B.E. SMITH CITY ENGINEER
 JULY 1955 Proj. No. C13-281



NOTE:
INTERSECTION TO BE BUILT IN CONNECTION
WITH FERN AVE., PROJ. No. C13-276

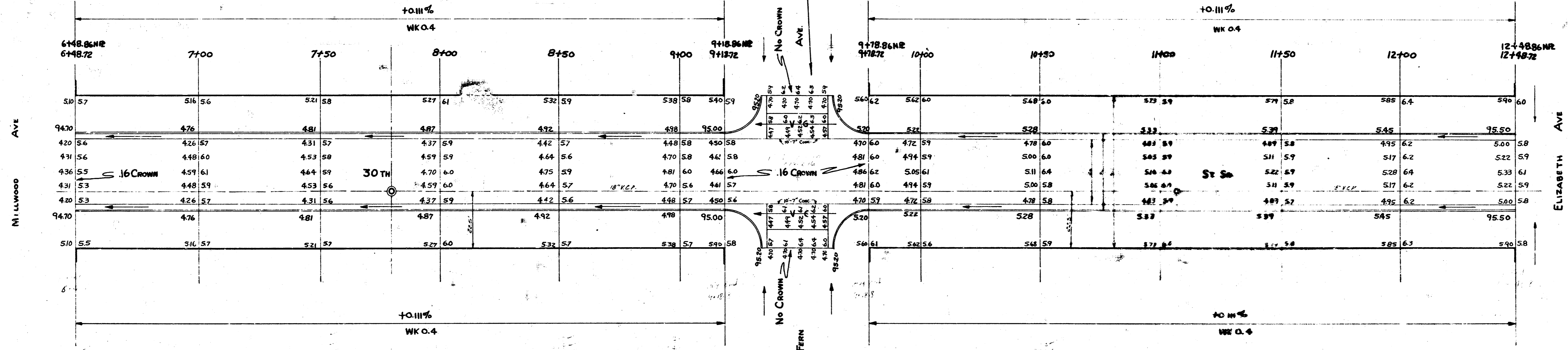

30 TH St Se
PROJ. No. C13-281

2/2