

B.M. 86.04 S.W. COR. CONC. PAVEN. 4th NE. COR. ST. CLAIR & 35TH ST. SO.

Sta. On N. E.

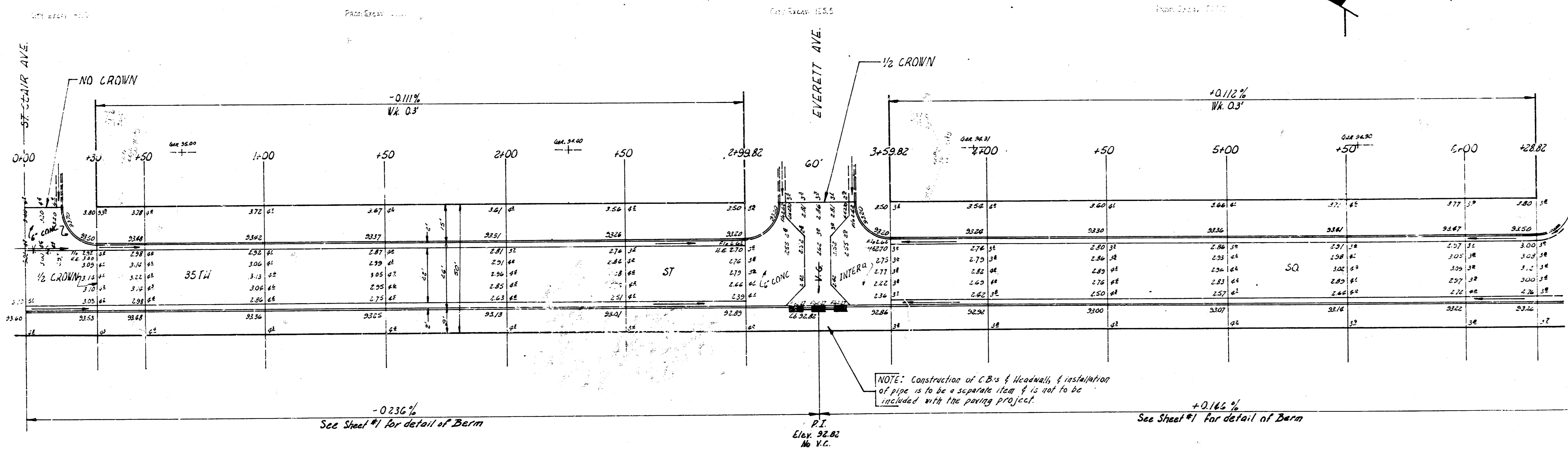

-0.236%
See Sheet #1 for detail of Berm

+0.112%
See Sheet #1 for detail of Berm

P.I.
Elev. 32.82
No V.C.

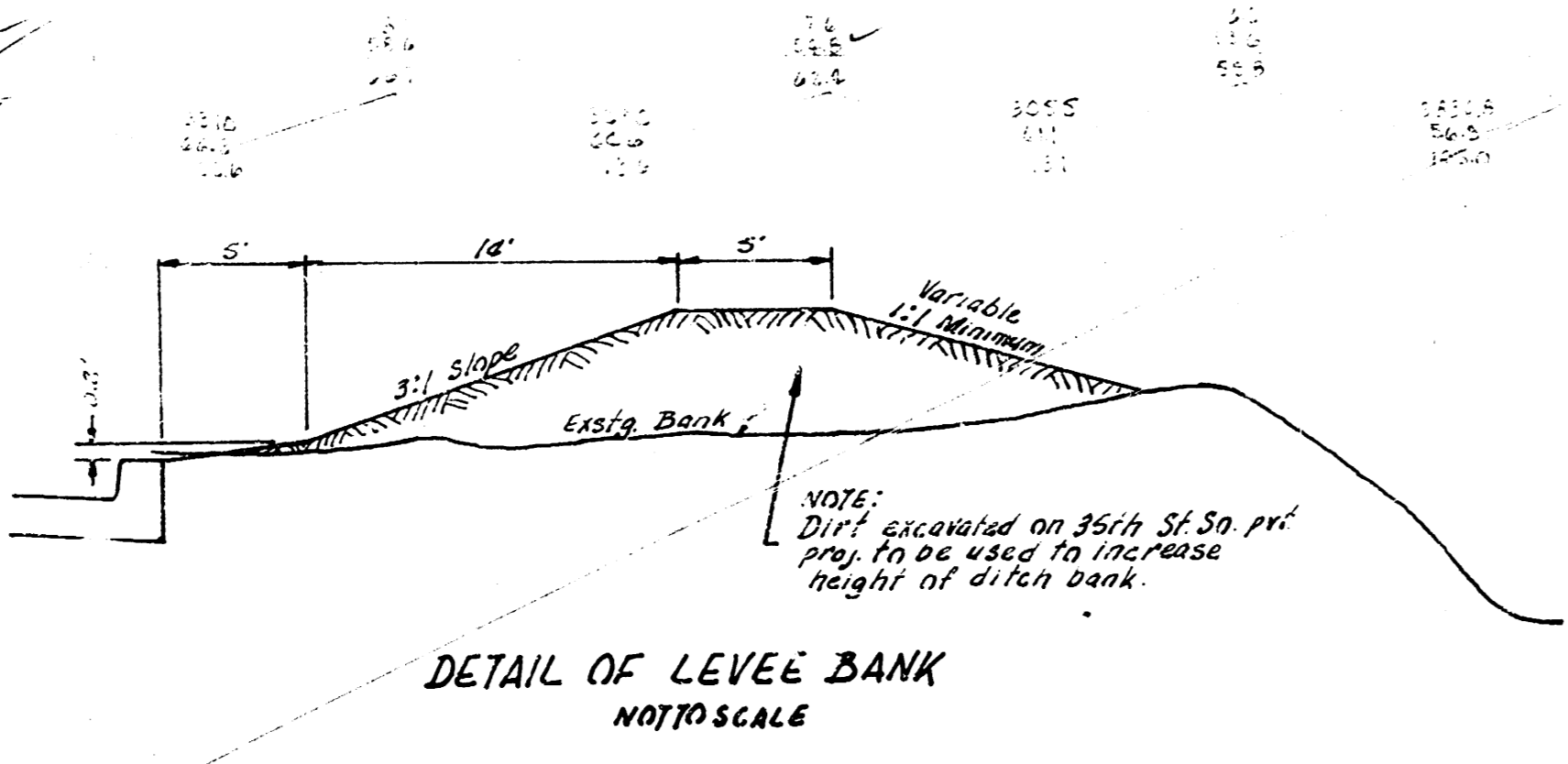

35TH ST. CO.
W.L. WESTBROOK 2ND ADD. - E.L. GLENN
22'-2"-36" A.C.
CITY OF WICHITA, KANS.
B.E. SMITH CITY ENGINEER
MARCH 1936 PROJ. NO. C15-82

1/5

