

B.M. 137.99 A.E. Cor. Conc. Step.  
House # 3907 ST CLAIR

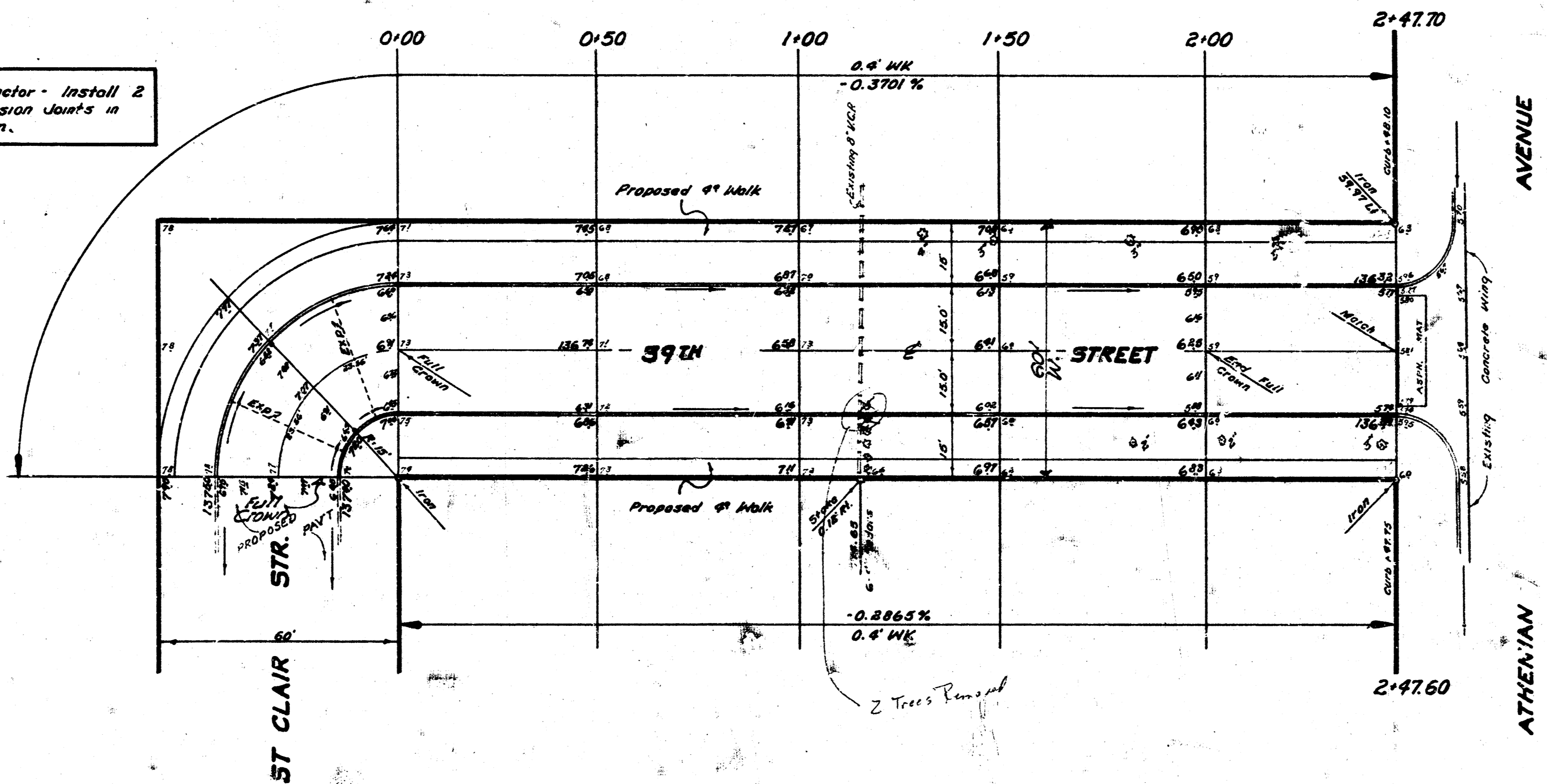

NOTE To Contractor - Install 2  
Pre-Cast Expansion Joints in  
Radius as Shown.



Survey Young  
Blair  
Blair  
Blair

\*SIDEWALK\*  
NOTE: To Field Engineer and Contractor  
Grade Parking and Clear Right of Way for  
Proposed Sidewalk. Compact backfill in  
Sidewalk Area. SIDEWALK by OTHERS.

NOTE Field Engineer and Contractor. Install  
Mosic Joint and Dowels at All Driveways.

	EXCAVATION	COMP. FILL
Property	232.7 Cu Yds 110% 25.3	19.7 Cu Yds 110% 2.0
Total	258.0 Cu Yds	21.7 Cu Yds
City	29.4 Cu Yds 110% 2.9	0.0
Total	32.3 Cu Yds	

39TH STREET  
W.L. ST. CLAIR to W.L. ATHENIAN  
30' CONG. CURB  
B.E. SMITH CITY ENGINEER  
CITY OF WICHITA, KANSAS  
DATE JUNE 1967 PROJ. No. C16-77

