

**42nd STREET SOUTH**  
**E·L·ELIZABETH AVE· TO W·L·SENECA AVE·**  
**472-76-245-80883-000-000-001**

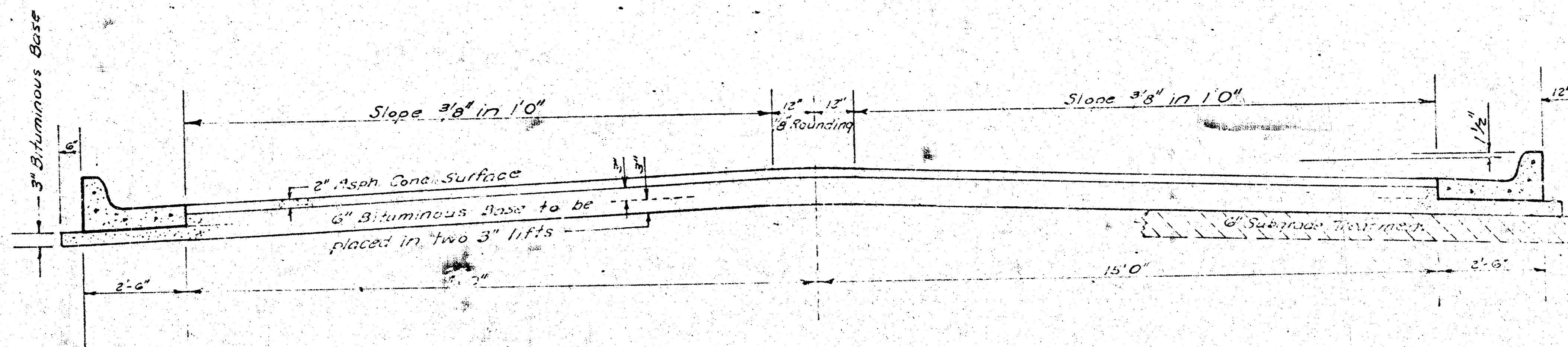

**TYPICAL SECTION**

**35' ASPHALTIC CONCRETE PAVEMENT WITH BITUMINOUS BASE**

A TACK COAT OF EMULSIFIED ASPHALT (SS-1H) SHALL BE APPLIED AT AN APPROXIMATE RATE 0.05 GALLONS PER SQ YD BETWEEN LIFTS OF ASPHALTIC MATERIALS WHEN ORDERED BY THE ENGINEER. TACK COAT WILL NOT BE PAID FOR DIRECTLY AND SHALL BE CONSIDERED AS SUBSIDIARY TO PRICE BID FOR ASPHALTIC PAVEMENT. BITUMINOUS BASE AND ASPHALTIC CONCRETE WEARING SURFACE SHALL BE PLACED WITH A LAYDOWN MACHINE HAVING AUTOMATIC CONTROLS FOR CROWN AND GRADE. CONSTRUCTION JOINTS IN EACH LIFT SHALL BE STAGGERED A MINIMUM DISTANCE OF 1' WITH JOINTS IN PRECEDING LIFTS AND PLACED SUCH THAT A JOINT WILL BE CONSTRUCTED ON THE CENTERLINE IN THE TOP LIFT.

*The A.C. Pavement between the curb curb & gutter shall be paid as Sq.Yds. 8" A.C. Pavement (6" Bituminous Base).  
 The Bituminous Base under the curb curb & gutter shall be paid as Sq.Yds. 3" Bituminous Base.*

**CONTINUED CURB & GUTTER**

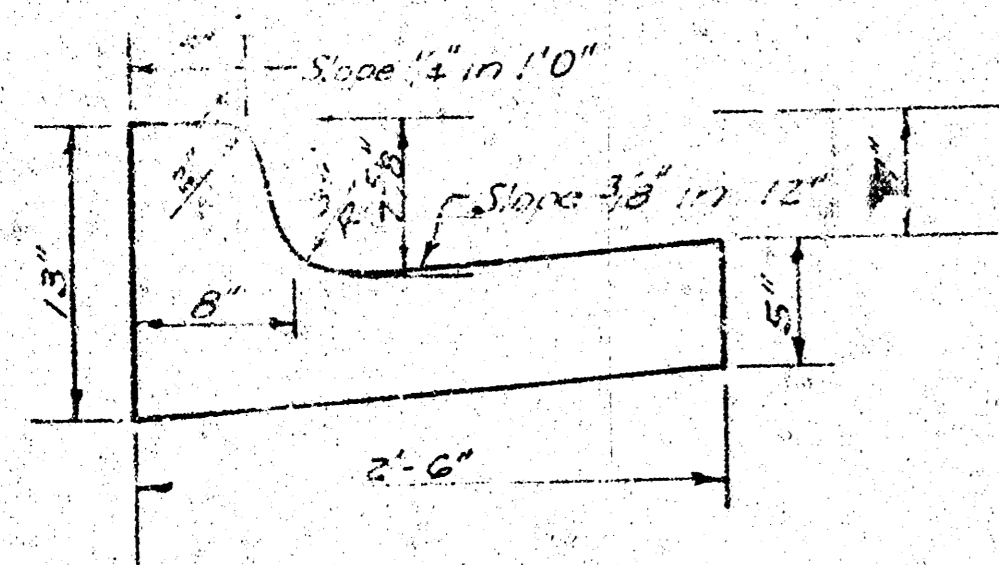

**ROLL TYPE CURB & GUTTER**

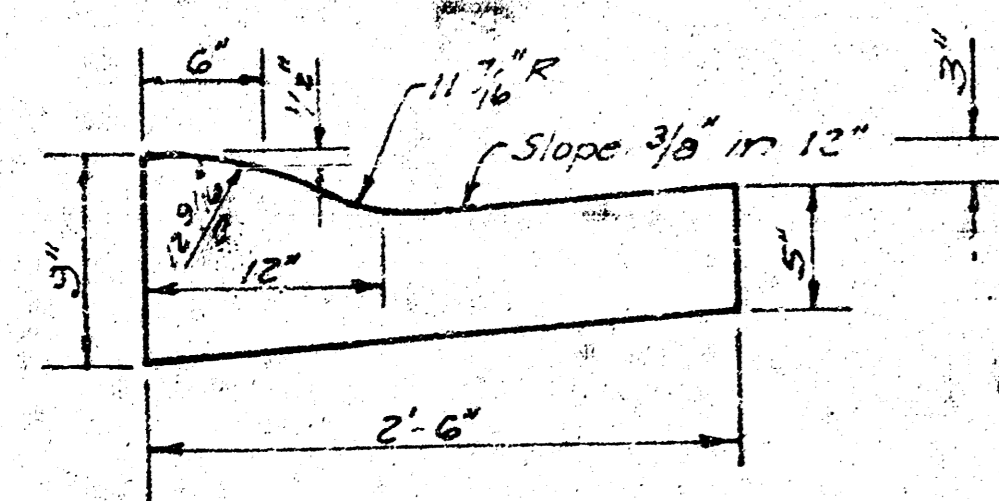

**DETAIL OF TRANSVERSE CONSTRUCTION JOINTS**

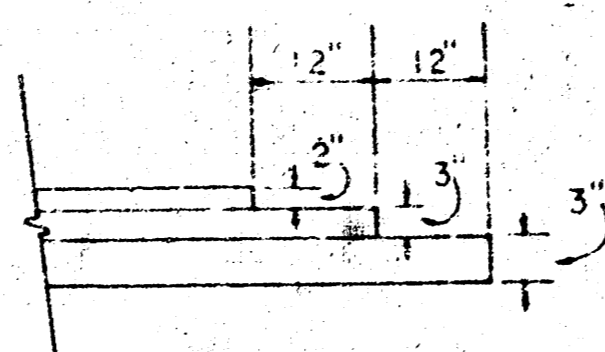

TRANSVERSE CONSTRUCTION JOINTS SHALL BE CONSTRUCTED IN FLEXIBLE BASE PAVEMENTS AT LOCATIONS WHERE PAVEMENT TEMPORARILY ENDS TO FACILITATE FUTURE PAVEMENT CONSTRUCTION AS SHOWN BY DETAIL. THE COST OF CONSTRUCTING THE TRANSVERSE CONSTRUCTION JOINTS SHALL NOT BE MEASURED OR PAID FOR DIRECTLY BUT SHALL BE INCLUDED IN THE BID PRICE FOR SQUARE YARDS OF ASPHALTIC CONCRETE PAVEMENT.



**CITY OF WICHITA KANSAS**

DEPARTMENT of PUBLIC WORKS - Engineering  
 Division.

R. W. BRUGGEMAN CITY ENGINEER

DATE \_\_\_\_\_ Proj No. \_\_\_\_\_

1/3

**B**

No More Than 4 - 20' Drives Or Their Equivalent To Be Constructed.

B-M = 89-29 R-R Spk. W-Face Of P-P. at S-W. Cor. Of 42nd ST. S. & Seneca.  
 B-M = 88-008 Seneca & 43rd ST. S., City STD. 48' E. & 42-50' S. Of C. Both.

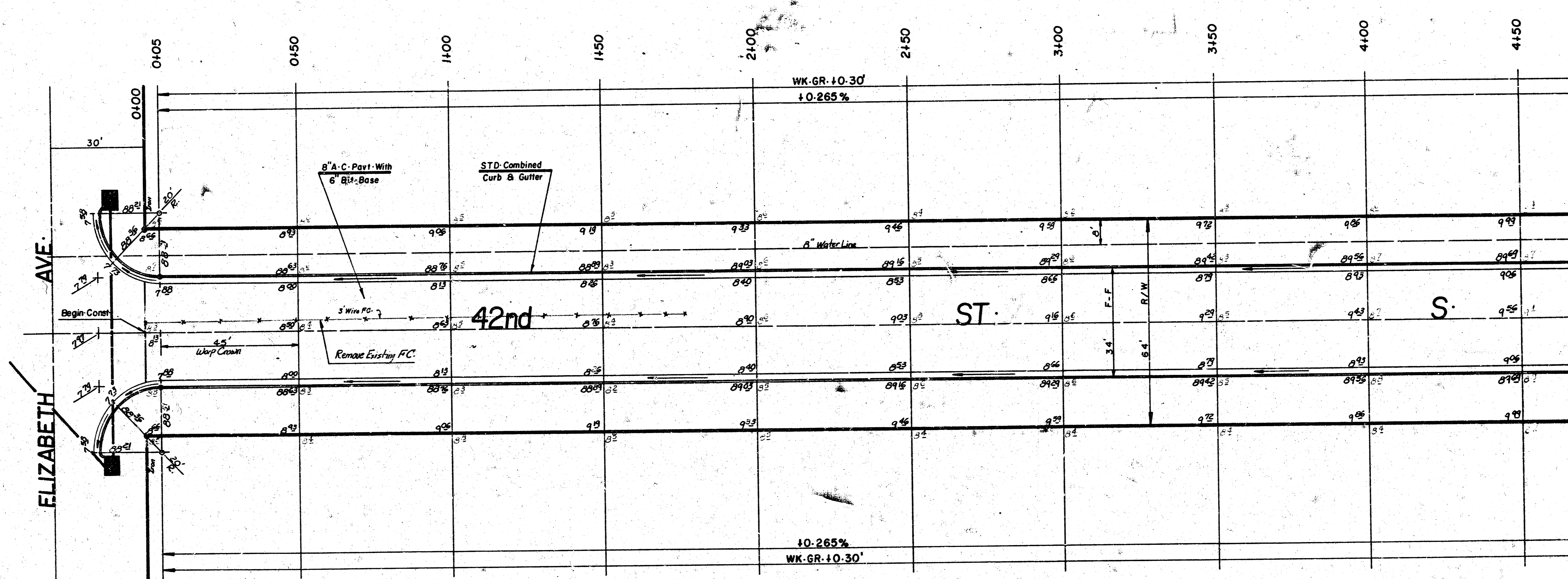

Survey B. Sullivan, B.S. 8/1/82, 2/79  
 City Engineer  
 Checked

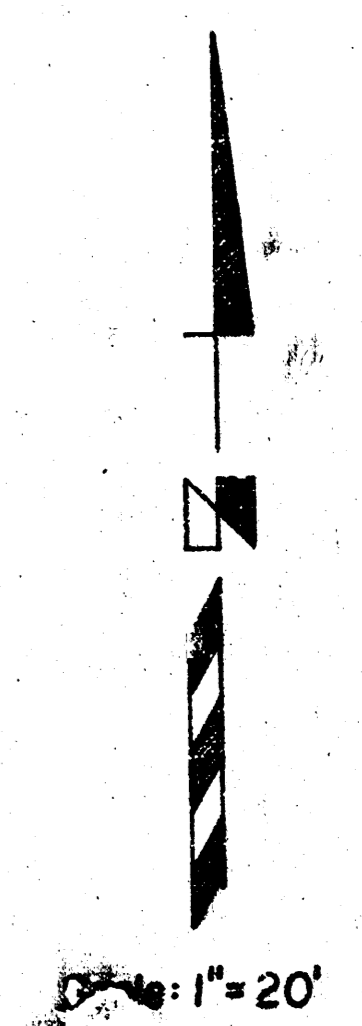

	PROP.	CITY
Excavation	865-60 c.y.	80-65 c.y.
+10%	86-56 c.y.	8-07 c.y.
<b>TOTAL</b>	<b>952-16 c.y.</b>	<b>88-72 c.y.</b>
Comp. Fill	36-48 c.y.	0
+10%	3-6 c.y.	0
<b>TOTAL</b>	<b>40-13 c.y.</b>	<b>0</b>
Manipulation	3653-42 s.y.	232-80 s.y.

*Note:*  
 Field Engineer Shall Take Ties To All Lines Which Are  
 Destroyed During Construction, Shall Be Replaced.

**CAUTION**  
 UNDERGROUND  
 UTILITIES

Please check with R. S. & E. or  
 Southwestern Bell  
 Telephone Co. for Location

SUB-GRADE  
 TYPE OF SUB-GRADE TREATMENT SHALL BE DE-  
 TERMINED BY THE FIELD ENGINEER. SUB-GRADE  
 TREATMENT MAY CONSIST OF LIME TREATMENT,  
 CEMENT TREATMENT, SUB-GRADE MODIFICA-  
 TION, OR ANY COMBINATION OF THESE.

**42nd ST. S.**  
**E-L ELIZABETH AVE. TO W-L SENECA**  
 (35' B-B 8" A-C Pavt. 6" Bit-Base-Comb-Cb-Gr)

**City of Wichita, KS**

R. W. BRUGGEMAN      City Engineer  
 PROJ. NO. 472-76-245-80883-000-000-001 <sup>2/3</sup>

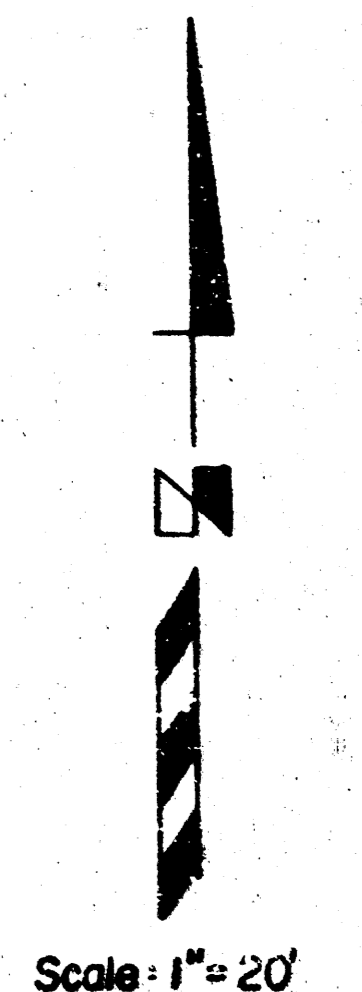
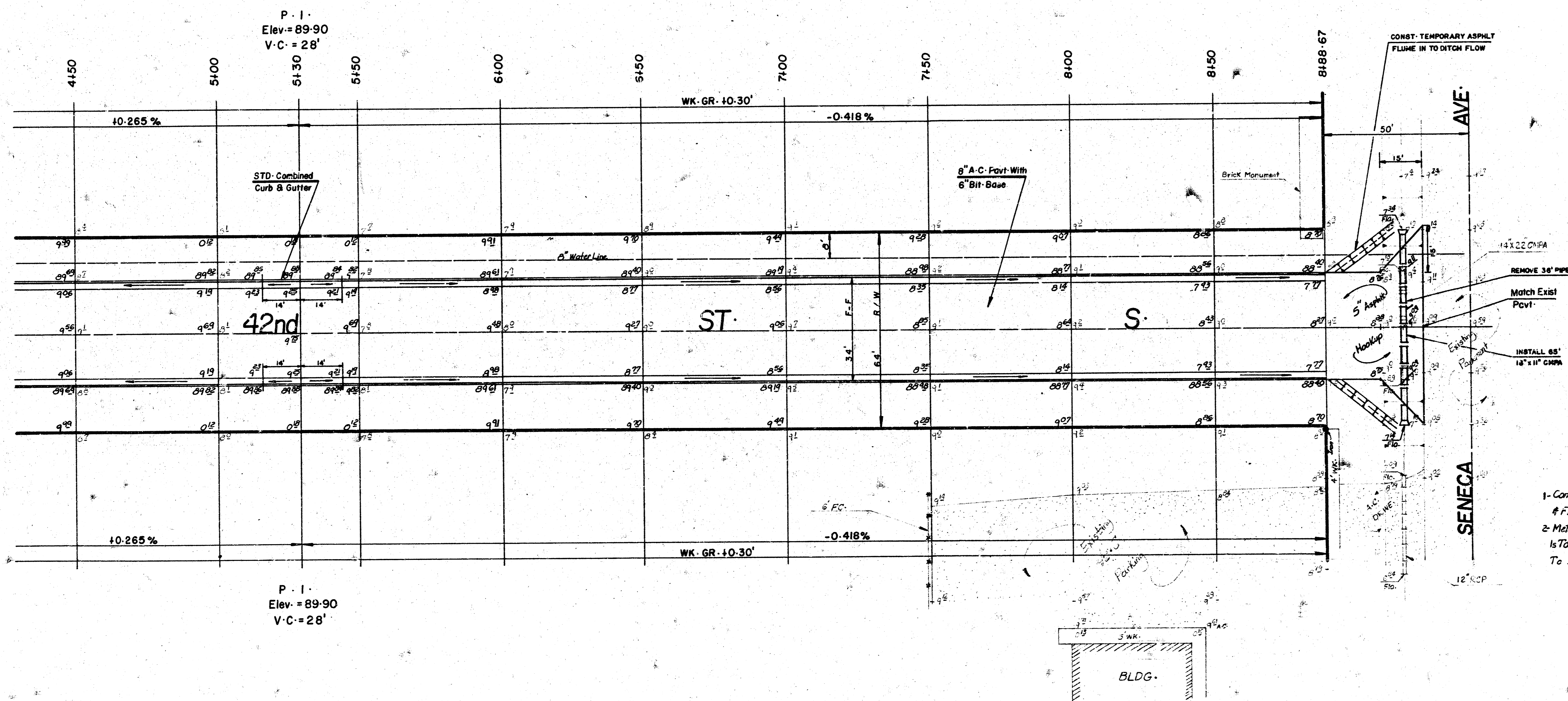

Note:  
 1- Contractor To Regrade Ditch, Regrade  
 & Flumes To Be Incidental To L.F. Pipe.  
 2- Method Of Compaction At Asphalt Hookup  
 Is To Be Approved By The Field Engineer Due  
 To Shallow Culvert Pipe.

42nd ST - S