

RATIONAL FORMULA DATA:

$T_c = 15$ MIN.
 $I_2 = 3.8$
 $i_{100} = 7.36$
 $c = 0.5$ RESIDENTIAL
 $c = 0.8$ COMMERCIAL

MIN. LOW OPENING ELEV. = 167.5

- NOTES:**
- BENCHMARKS: STD DISC 80D NAIL IN PP 67.50' CL 1ST AND 45' E CL 119TH S. N1/4 CORNER SECTION ELEV. 172.08
 - 80D NAIL IN PP 90E AND 50S 80D NAIL IN PP 40' W AND 40' N W 1/4 CORNER SECTION 6-27-1W ELEV. 175.05
 - 80D NAIL IN PP 40' W AND 40' N W 1/4 CORNER SECTION 6-27-1W ELEV. 175.05
 - PHOTOGRAMMETRY BY: WESTERN AIR MAPS, INC SURVEY DATE: APRIL 14, 1983 AERIAL PHOTOGRAPHY DATE: APRIL 11, 1983
 - RESERVE A IS RESERVED FOR LANDSCAPING, ENTRY MONUMENTS, LIGHTING, IRRIGATION AND UTILITIES. RESERVE B AND C ARE RESERVED FOR ENTRY MONUMENTS, FENCING, IRRIGATION, LANDSCAPING, RECREATIONAL IMPROVEMENTS, LIGHTING AND UTILITIES CONFINED BY EASEMENTS.

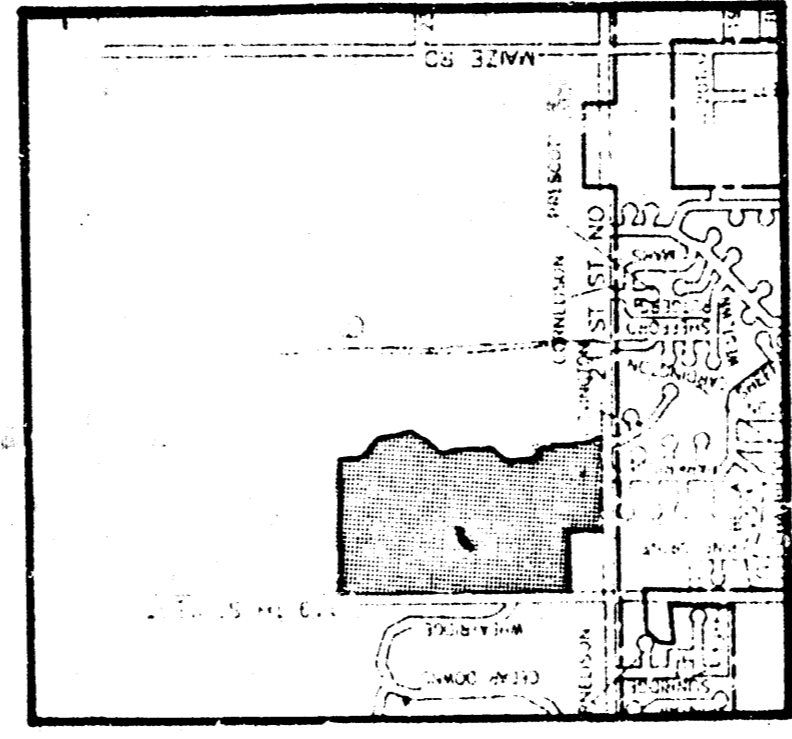

NO SCALE
 LOCATION: SECTION 6-1725-R1W SEDGEWICK COUNTY, KS

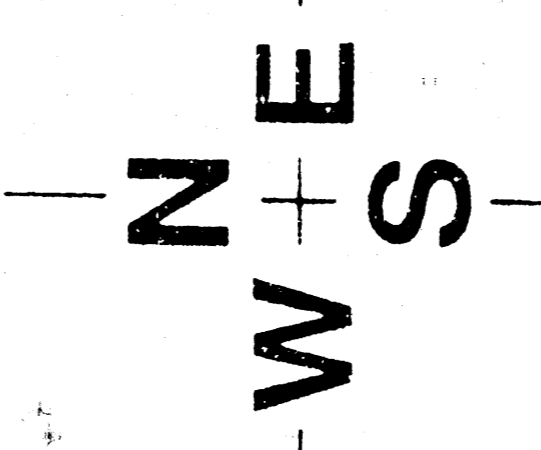

SCALE: 1" = 100'

PROVIDE 9.4 AC FT STORAGE IN PONDS BETWEEN 164.0 AND 166.0

$Q_{100} = 96.0$ cfs W/STORAGE
 $HW = 166.1$
 $RCBC$ CAPACITY = 200 cfs

PRELIMINARY PLAT AND DRAINAGE PLAN
ABERDEAN 1ST ADDITION

OWNER: JAY RUSSELL CONSTRUCTION, 455 N. MAIZE RD., WICHITA, KS 67212

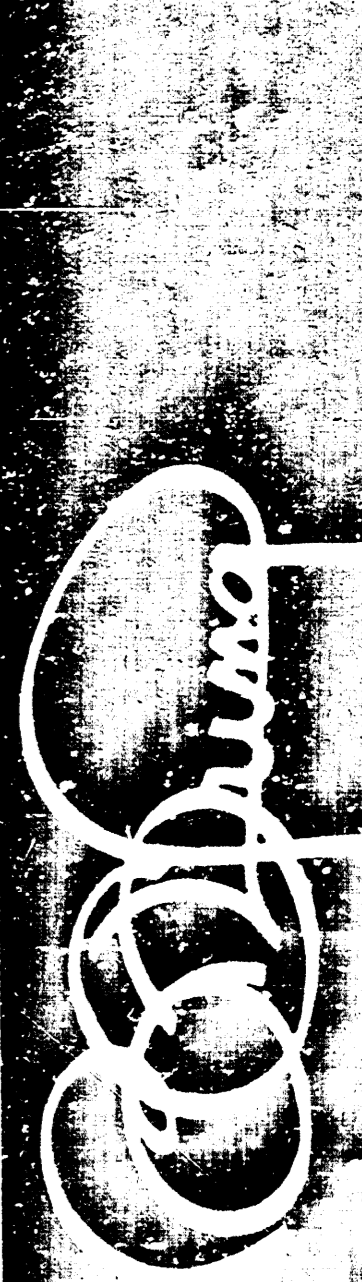

YUNG DESIGN GROUP
 BRANSON OFFICE: 1701 W. HIGHWAY 76, SUITE 7 • BRANSON, MO 65616
 PH: 417.239.8233 • FAX: 417.235.8686
 WICHITA OFFICE: 1427 E. 28TH STREET NORTH • WICHITA, KS 67202
 PH: 316.863.3607 • FAX: 316.863.9292

DATE DATE: 12-16-93

REV.

SHEET TITLE

PROJECT PROJECT NO.

SHEET OF

