

# DRAINAGE PLAN OF CARCO ADDITION TO WICHITA, SEDGWICK COUNTY, KANSAS

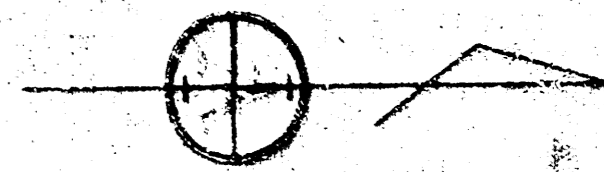

SCALE 1"=30'  
W.O.# 26891-1

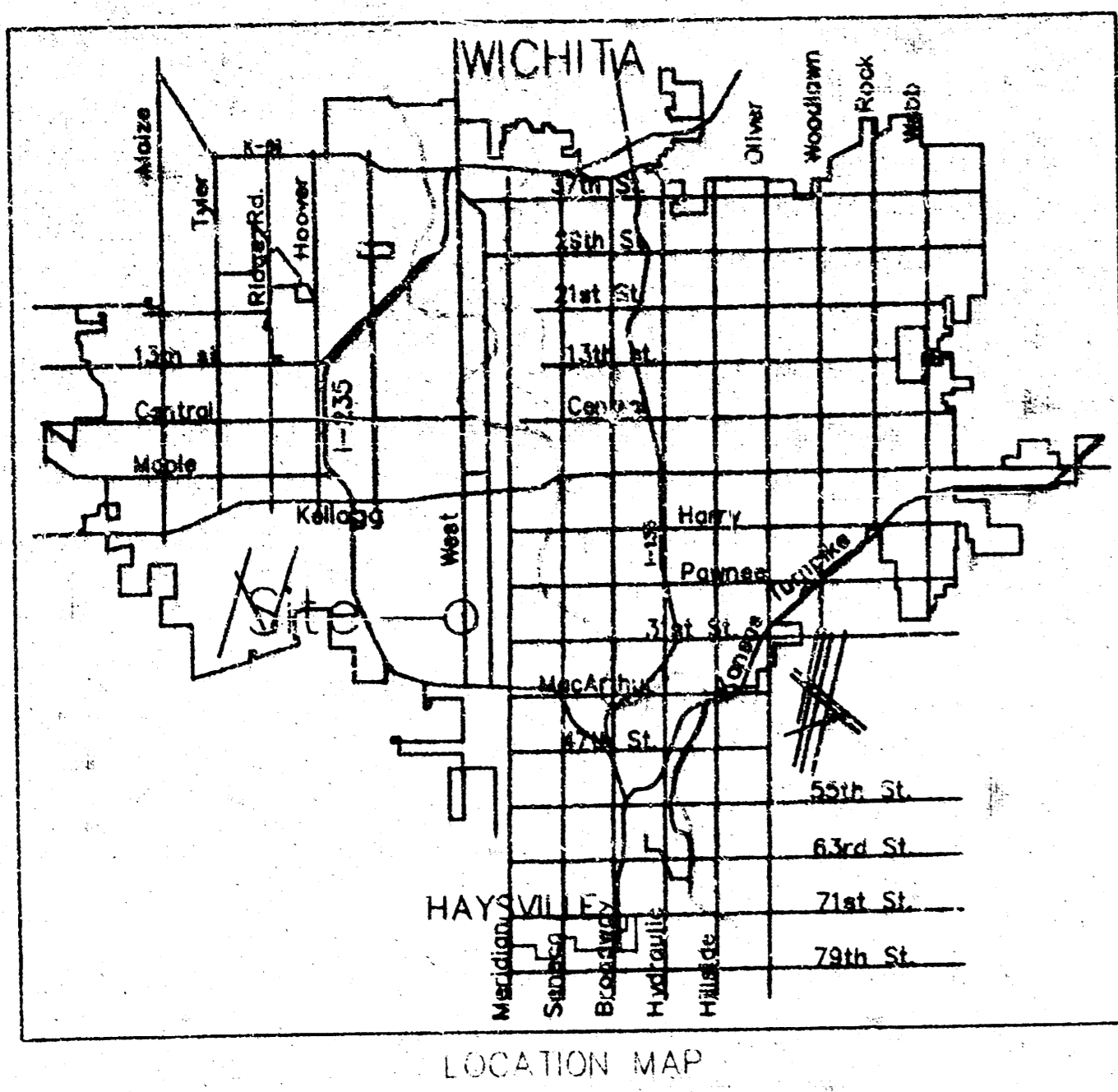

LOCATION MAP

## LEGEND

- - set 5/8" rebar @ "Armstrong" cap
- - iron in thimble
- - found iron rod w/ Baughman cap
- - found chiseled in concrete
- - found chiseled in concrete
- M - measured distance
- P - plat distance
- cm - calculated from measured distance
- - - property line
- - - center line
- - - easement line
- - - setback line
- - - underground utility
- - wooden fence
- - chainlink fence
- - cable TV riser
- - telephone riser
- - fire hydrant
- - elec. transformer
- - air conditioner
- - power pole
- - manhole
- - light pole
- - gas meter
- - gas valve
- - water meter
- - water valve
- - coniferous tree
- - deciduous tree
- Proposed Drainage Flow Direction
- Existing Spot Elevation
- Proposed Spot Elevation

**DRAINAGE DATA**  
Area=0.23 acres  
SCS Soil Type B  
Canadian Loam  
C = 0.54  
Tc = 15 min.  
i 5=4.62"/hr.  
Q 5=0.57 cfs

Adjacent Land Owner:  
Cornelius Sanders II &  
Deon J. Sanders  
2801 S. West St.  
Wichita, KS 67217

## FLOOD ZONE MAP

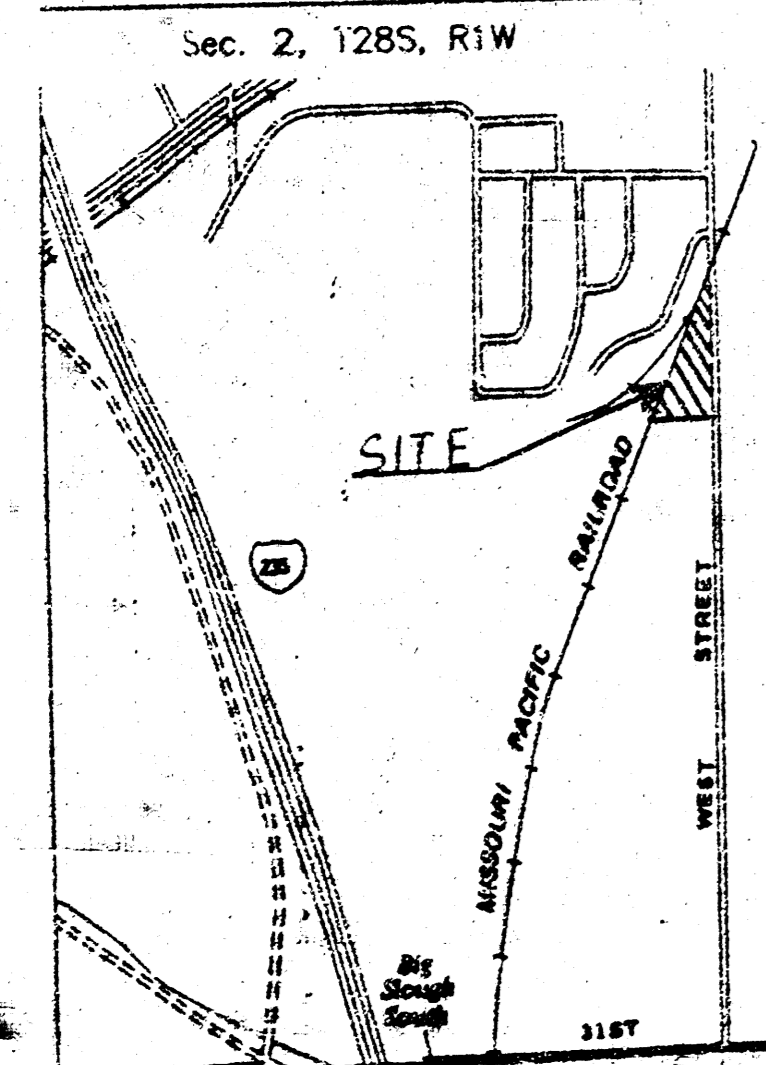

SCALE: 1" = 1,000'

**FLOOD ZONE:**  
Subject property is in an area protected from the one percent annual chance (100 year) flood by levee, dike, or other structures subject to possible failure or over-topping during larger floods, as shown of Federal Emergency Management Agency (FEMA) Flood Insurance Rate Map (FIRM) for Sedgwick County, Kansas, Community Panel Number 200328 0025, effective May 15, 1986.

**DRAINAGE DATA**  
Area=0.41 acres  
SCS Soil Type B  
Canadian loam  
C = 0.90  
Tc = 15 min.  
i 5=4.62"/hr.  
Q 100=1.71 cfs

**DRAINAGE DATA**  
Area=0.19 acres  
SCS Soil Type B  
Canadian loam  
C = 0.54  
Tc = 15 min.  
i 5=4.62"/hr.  
Q 5=0.47 cfs

**Legal Description:**  
That part of the South Half of the Northeast Quarter of Section 2, Township 28 South, Range 1 West, lying South and East of the Easterly Right-of-Way Line of the Missouri Pacific Railroad, subject to road easement on the East 30 feet thereof.

**Bench Mark #1:**  
C.O.W. disc @ West St. & Pawnee  
Elevation: 104.85(City Datum)

**Subject Property Owner:**  
Fred Wood  
2716 S. Oak  
Wichita, KS 67217

**Existing Zoning:**  
"LI"-Limited Industrial

**Subdivider:**  
Linda Richardson  
1502 Willow Lane  
Haysville, KS  
67060 (316)  
522-8835

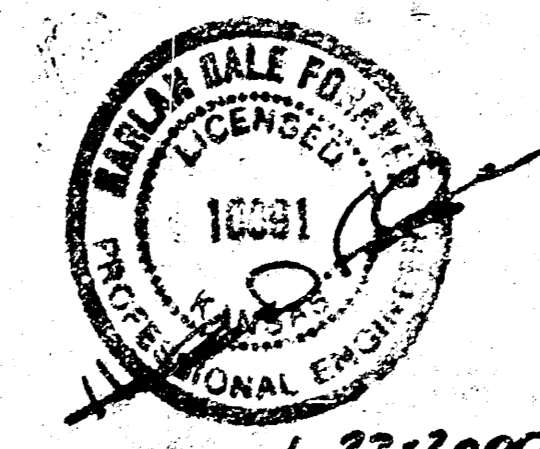

DRAINAGE PLAN PREPARED BY:  
**CERTIFIED ENGINEERING DESIGN**

<b>CEP</b>	438 NORTH OHIO WICHITA, KS 67214 (316)262-8808 Ph. (316)262-0080 Fax	SHEET 1
		TOTAL 1

6-22-2000