

D. E. EVANS ADDITION
(DRAINAGE)

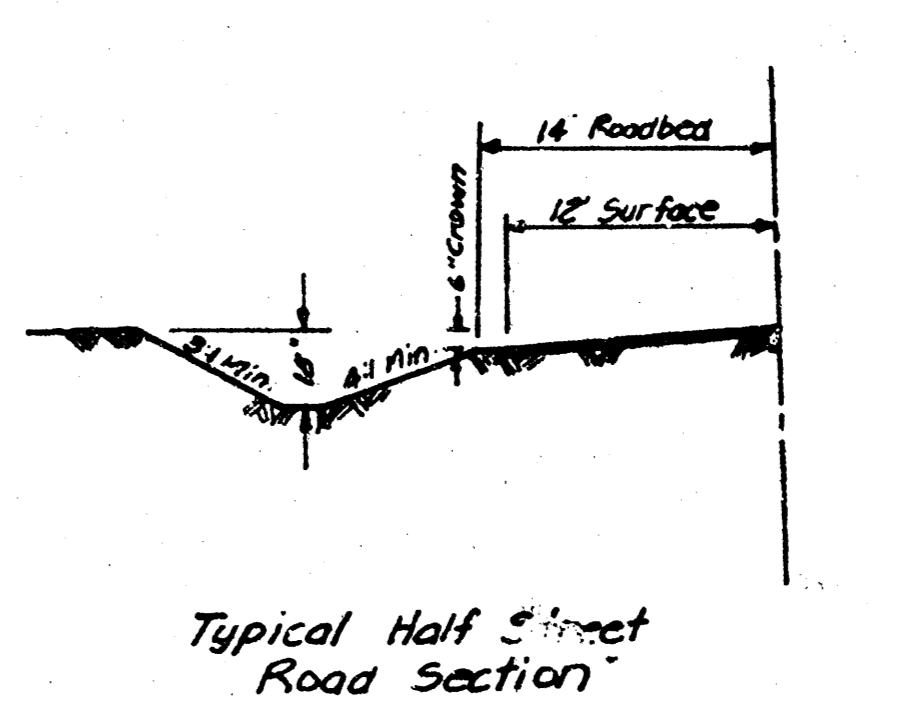
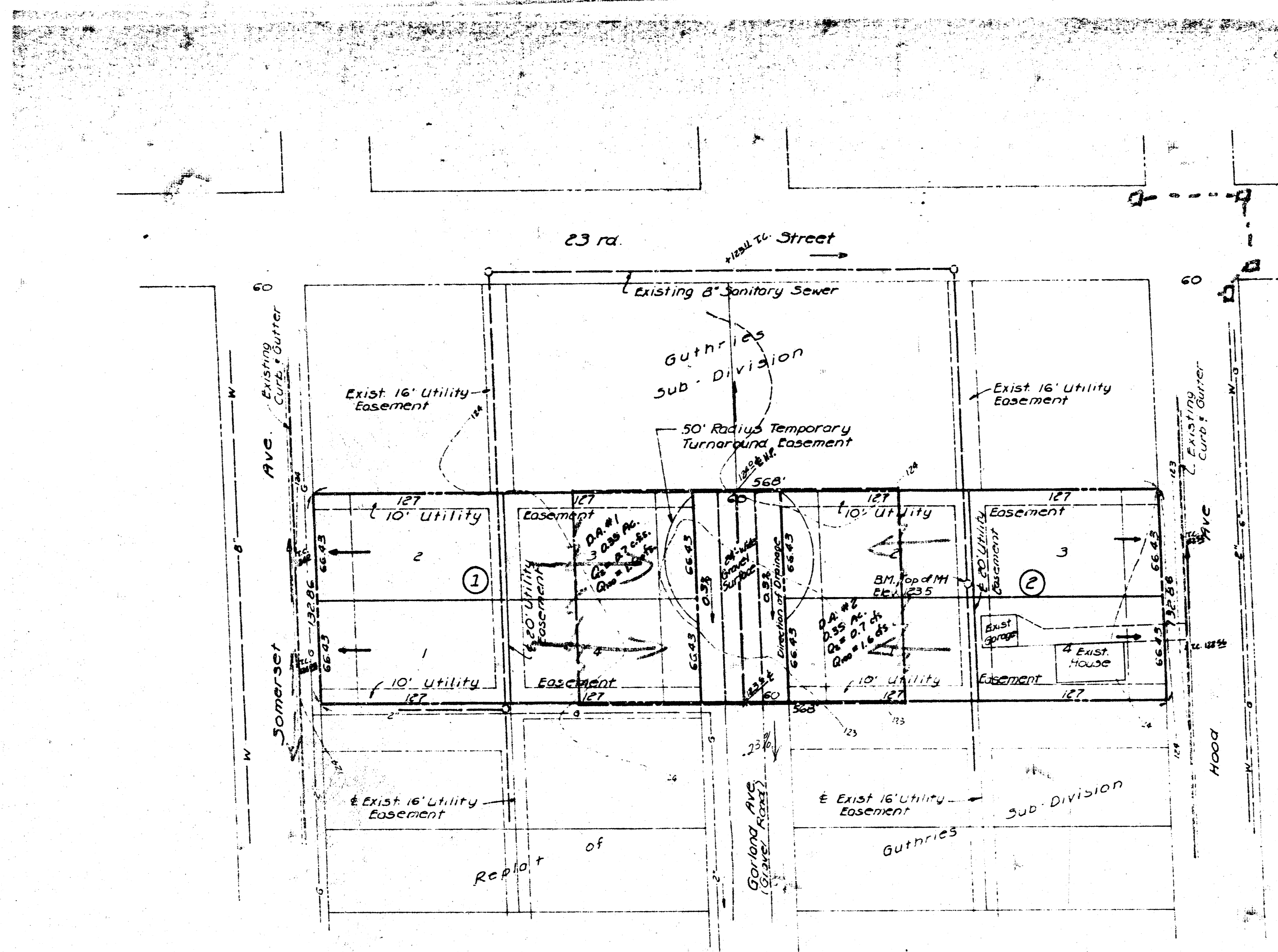

Note: Recommended Culvert Size for Drives are 12" @ 0.3%, Q=1.5 cfs.

Preliminary Drainage Concept

D. E. EVANS ADDITION

to

Wichita, Sedgwick County, Kansas

1983



Scale: 1"=50'

Prepared by Air Capital Land Surveyors
2160 W. 21st St. Wichita, Ks 67203

NOTES:

Owner/Subdivider: Donald E. Evans
2447 Cardinal Drive
Wichita, Ks. 67204

Date of Topographic Survey: 4-29-83

B.M.: Top of Manhole in Lot 21, Guthries Sub-Division, El. 1235, City Datum.

All Utilities Shown are Existing.

This is a Replat of Lots 21 & 22, Guthries Sub-Division

Exist Zoning is A-A, Adjacent Lots are A-A

Proposed Zoning is "A."

Existing House & Garage to Remain.