

**VICINITY MAP**

**HAWTHORNE ADDITION**

| MINIMUM PAD ELEVATIONS (LOWEST OPENINGS) |       |                        |                  | MINIMUM PAD ELEVATIONS (LOWEST OPENINGS) |       |                        |                  |
|--|-------|------------------------|------------------|--|-------|------------------------|------------------|
| LOT                                      | BLOCK | ELEVATION (CITY DATUM) | ELEVATION (USGS) | LOT                                      | BLOCK | ELEVATION (CITY DATUM) | ELEVATION (USGS) |
| 2  | 2     | 181.6                  | 1369.0           | 16                                       | 5     | 168.3                  | 1355.7           |
| 3  | 2     | 181.6                  | 1369.0           | 17                                       | 5     | 166.6                  | 1354.0           |
| 8  | 2     | 175.1                  | 1362.5           | 18                                       | 5     | 167.1                  | 1354.5           |
| 9  | 2     | 174.7                  | 1362.1           | 19                                       | 5     | 168.1                  | 1355.5           |
| 10                                       | 2     | 175.1                  | 1362.5           | 7  | 6     | 167.8                  | 1355.2           |
| 11                                       | 2     | 178.1                  | 1365.5           | 8  | 6     | 170.3                  | 1357.7           |
| 12                                       | 2     | 178.6                  | 1366.0           | 9  | 6     | 170.3                  | 1357.7           |
| 14                                       | 2     | 180.1                  | 1367.5           | 10                                       | 6     | 170.3                  | 1357.7           |
| 15                                       | 2     | 180.1                  | 1367.5           | 11                                       | 6     | 170.3                  | 1357.7           |
| 16                                       | 2     | 179.6                  | 1367.0           | 12                                       | 6     | 170.3                  | 1357.7           |
| 17                                       | 2     | 179.1                  | 1366.5           | 13                                       | 6     | 170.3                  | 1357.7           |
| 18                                       | 2     | 179.1                  | 1366.5           | 14                                       | 6     | 170.3                  | 1357.7           |
| 19                                       | 2     | 176.1                  | 1363.5           | 15                                       | 6     | 170.9                  | 1358.3           |
| 20                                       | 2     | 176.1                  | 1363.5           | 16                                       | 6     | 170.9                  | 1358.3           |
| 21                                       | 2     | 175.6                  | 1363.0           | 17                                       | 6     | 170.3                  | 1357.7           |
| 22                                       | 2     | 173.6                  | 1361.0           | 18                                       | 6     | 170.3                  | 1357.7           |
| 7  | 3     | 178.6                  | 1366.0           | 19                                       | 6     | 170.3                  | 1357.7           |
| 13                                       | 3     | 178.6                  | 1366.0           | 20                                       | 6     | 170.3                  | 1357.7           |
| 14                                       | 3     | 178.1                  | 1365.5           | 21                                       | 6     | 170.3                  | 1357.7           |
| 26                                       | 3     | 178.1                  | 1365.5           | 22                                       | 6     | 170.3                  | 1357.7           |
| 27                                       | 3     | 178.1                  | 1365.5           | 23                                       | 6     | 170.3                  | 1357.7           |
| 28                                       | 3     | 178.1                  | 1365.5           | 24                                       | 6     | 169.7                  | 1357.1           |
| 29                                       | 3     | 178.1                  | 1365.5           | 25                                       | 6     | 169.7                  | 1357.1           |
| 30                                       | 3     | 178.1                  | 1365.5           | 26                                       | 6     | 169.7                  | 1357.1           |
| 31                                       | 3     | 178.6                  | 1366.0           | 27                                       | 6     | 169.7                  | 1357.1           |
| 32                                       | 3     | 178.6                  | 1366.0           | 28                                       | 6     | 174.1                  | 1361.5           |
| 33                                       | 3     | 178.6                  | 1366.0           | 30                                       | 6     | 174.1                  | 1361.5           |
| 1  | 4     | 180.9                  | 1368.3           | 31                                       | 6     | 174.1                  | 1361.5           |
| 13                                       | 5     | 173.1                  | 1360.5           | 32                                       | 6     | 176.1                  | 1363.5           |
| 14                                       | 5     | 171.9                  | 1359.3           | 44                                       | 6     | 176.1                  | 1363.5           |
| 15                                       | 5     | 170.5                  | 1357.9           | 45                                       | 6     | 175.1                  | 1362.5           |
|  |       |                        |                  | 46                                       | 6     | 174.1                  | 1361.5           |
|  |       |                        |                  | 47                                       | 6     | 174.1                  | 1361.5           |
|  |       |                        |                  | 48                                       | 6     | 174.1                  | 1361.5           |
|  |       |                        |                  | 49                                       | 6     | 174.1                  | 1361.5           |
|  |       |                        |                  | 51                                       | 6     | 174.1                  | 1361.5           |
|  |       |                        |                  | 52                                       | 6     | 169.7                  | 1357.1           |
|  |       |                        |                  | 56                                       | 6     | 169.7                  | 1357.1           |

**HAWTHORNE 2ND ADDITION**

| MINIMUM PAD ELEVATIONS (LOWEST OPENINGS) |       |                        |                  |
|--|-------|------------------------|------------------|
| LOT                                      | BLOCK | ELEVATION (CITY DATUM) | ELEVATION (USGS) |
| 1  | 1     | 173.6                  | 1361.0           |
| 6  | 1     | 173.6                  | 1361.0           |
| 7  | 1     | 173.6                  | 1361.0           |
| 9  | 1     | 173.6                  | 1361.0           |
| 10                                       | 1     | 173.6                  | 1361.0           |
| 11                                       | 1     | 174.1                  | 1361.5           |
| 22                                       | 1     | 174.7                  | 1362.1           |
| 23                                       | 1     | 175.9                  | 1363.3           |
| 35                                       | 1     | 180.9                  | 1368.3           |
| 8  | 2     | 177.6                  | 1365.0           |

**HAWTHORNE 4TH ADDITION**

| MINIMUM PAD ELEVATIONS (LOWEST OPENINGS) |       |                        |                  |
|--|-------|------------------------|------------------|
| LOT                                      | BLOCK | ELEVATION (CITY DATUM) | ELEVATION (USGS) |
| 1  | 1     | 171.3                  | 1358.7           |
| 2  | 1     | 171.2                  | 1358.6           |
| 3  | 1     | 171.2                  | 1358.6           |
| 4  | 1     | 171.2                  | 1358.6           |
| 5  | 1     | 171.2                  | 1358.6           |
| 6  | 1     | 171.2                  | 1358.6           |
| 7  | 1     | 171.2                  | 1358.6           |
| 8  | 1     | 171.2                  | 1358.6           |
| 9  | 1     | 167.7                  | 1355.0           |

**LEGEND**

- CONF. TREE & DIAMETER
- DECID. TREE & DIAMETER
- SIGN
- BUSH
- EDGE OF TREES
- FENCE
- SANITARY SEWER MANHOLE
- GAS METER
- POLE
- GATE
- WALL
- LIGHT POLE
- FIRE HYDRANT
- WATER VALVE
- WATER METER
- POWER POLE AND GUY ANCHOR
- TELEPHONE RIDER
- INLET
- STORM SEWER PIPE
- WATER LINE
- SANITARY SEWER LINE
- GAS LINE
- TELEPHONE LINE
- UNDERGROUND ELECTRIC LINE
- OVERHEAD TELEPHONE
- OVERHEAD ELECTRIC
- UNDERGROUND FIBER OPTIC CABLE
- HIGH PRESSURE GAS PIPELINE
- SECTION CORNER
- PROPERTY CORNER FOUND
- BENCHMARK
- WO - WALKOUT
- VO - VIEWOUT
- TVO - TERRACED WALKOUT
- TVO - TERRACED VIEWOUT
- SPOT ELEV.
- PROP. HOUSE ELEV.
- EXIST. PLOT PLAN HOUSE ELEV.

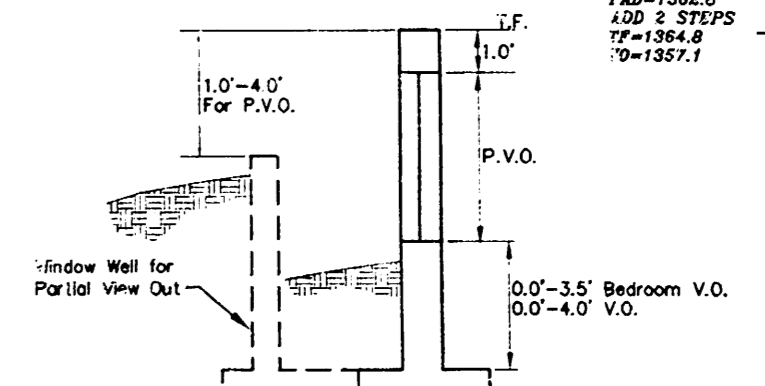
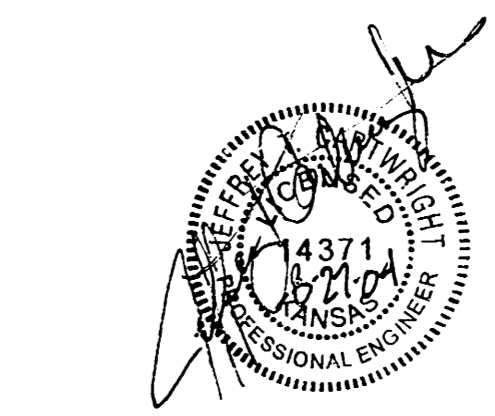

VIEW OUT & PARTIAL VIEW OUT DETAIL

**BENCHMARK**

BM#1 60' IN SOUTH LEG OF "H" POLE HIGH LINE STRUCTURE, 75' NORTH & 80' EAST OF C 127TH STREET & CENTERLINE BURLINGTON NORTHERN RAILROAD. ELEV. = 1365.37'

**LOT GRADING PLAN HAWTHORNE ADDITIONS**

**APPROVED DRAINAGE PLAN**

