

- NOTES:**
1. CITY OF WICHITA B.M. DISC. 44" S. AND 48" W. OF THE INTERSECTION OF ROCK ROAD AT 37TH STREET NORTH. ELEV. = 294.11
  2. A DRAINAGE CONCEPT WILL BE PREPARED BY MED-KANSAS ENGINEERING CONSULTANTS.
  3. TOPOGRAPHY IN THE AREA OF THE NEW WILLOWOOD BRIDGE IS CURRENTLY UNDER CONSTRUCTION AND WILL NEED TO BE FIELD VERIFIED. CONTOURS SHOWN ARE PROPOSED, NOT AS-BUILT.
- TOTAL SQ. FT. 934,840.88**  
**TOTAL ACRES 21.4**

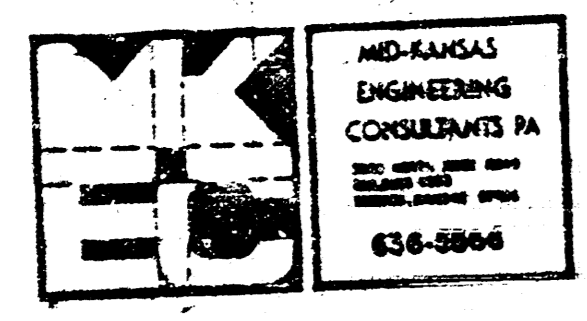

DRAINAGE & UTILITY PLAN

# KILLARNEY WEST RESIDENTIAL

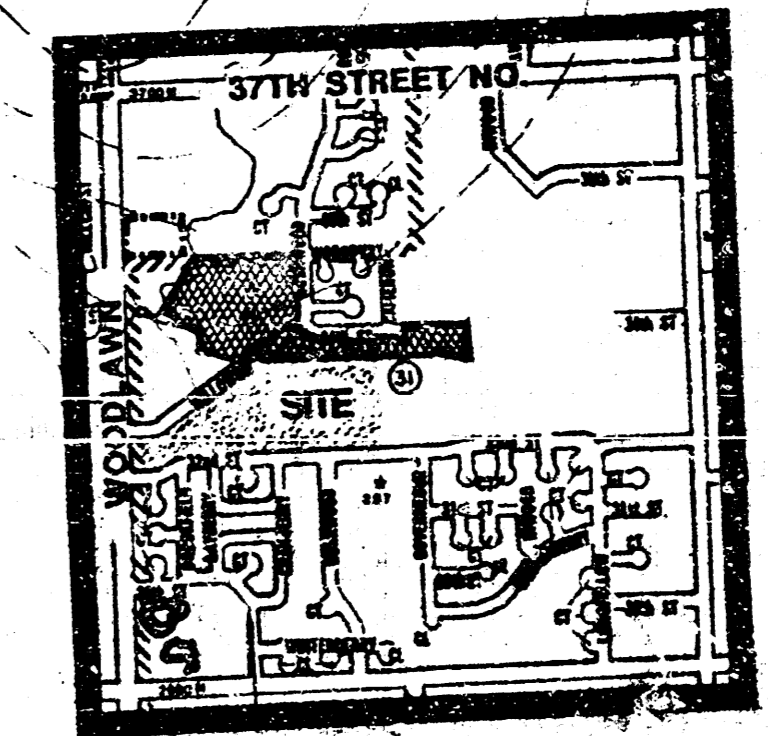

LOCATION MAP  
NO SCALE

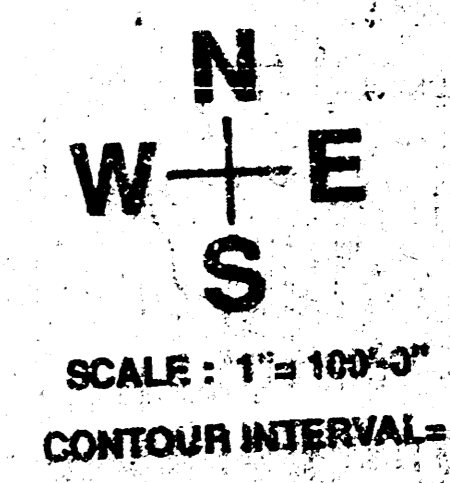

SCALE: 1" = 100'-0"  
CONTOUR INTERVAL = 1'