

L. N. LIES ADDITION  
(Drainage)

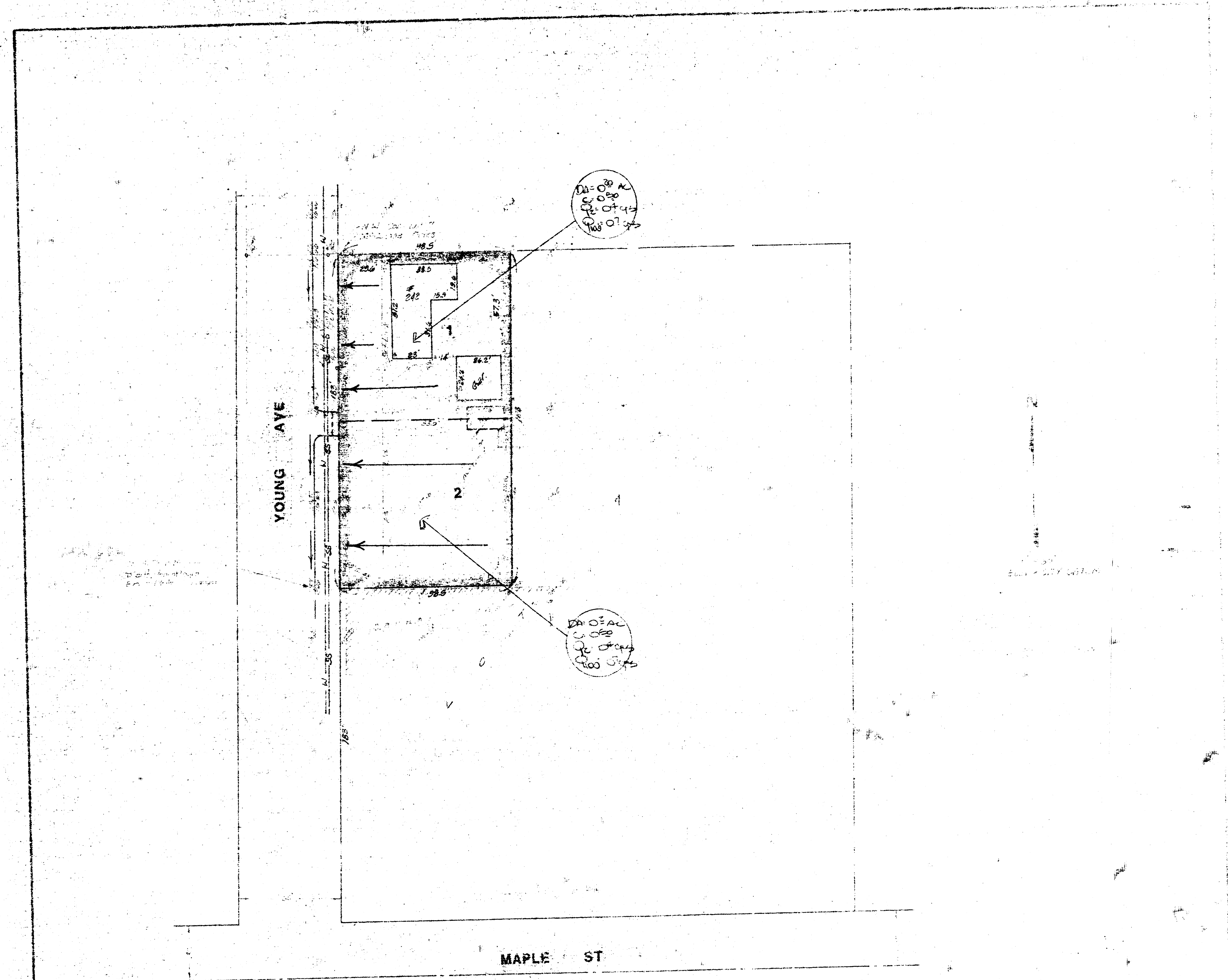

SKETCH PLAT  
**L. N. LIES ADDITION**

THE WEST 98.5 FEET OF THE N 1/2 OF LOT 7,  
MCCOMAS ACRES, SEDGWICK COUNTY, KANSAS.

LAWRENCE N. LIES

**DRAINAGE PLAN**

*Also*  
The two escrowed lots will drain west to  
Young Ave (paved) and south in the street  
as indicated

BAUGHMAN COMPANY, P.A.  
SURVEYORS & ENGINEERS  
214-261-1231 • 214-261-1235 • 14097A, F.W. ROAD