

\*NOTE:  
SEE SHEET 7 FOR EROSION CONTROL & SEEDING NOTES.

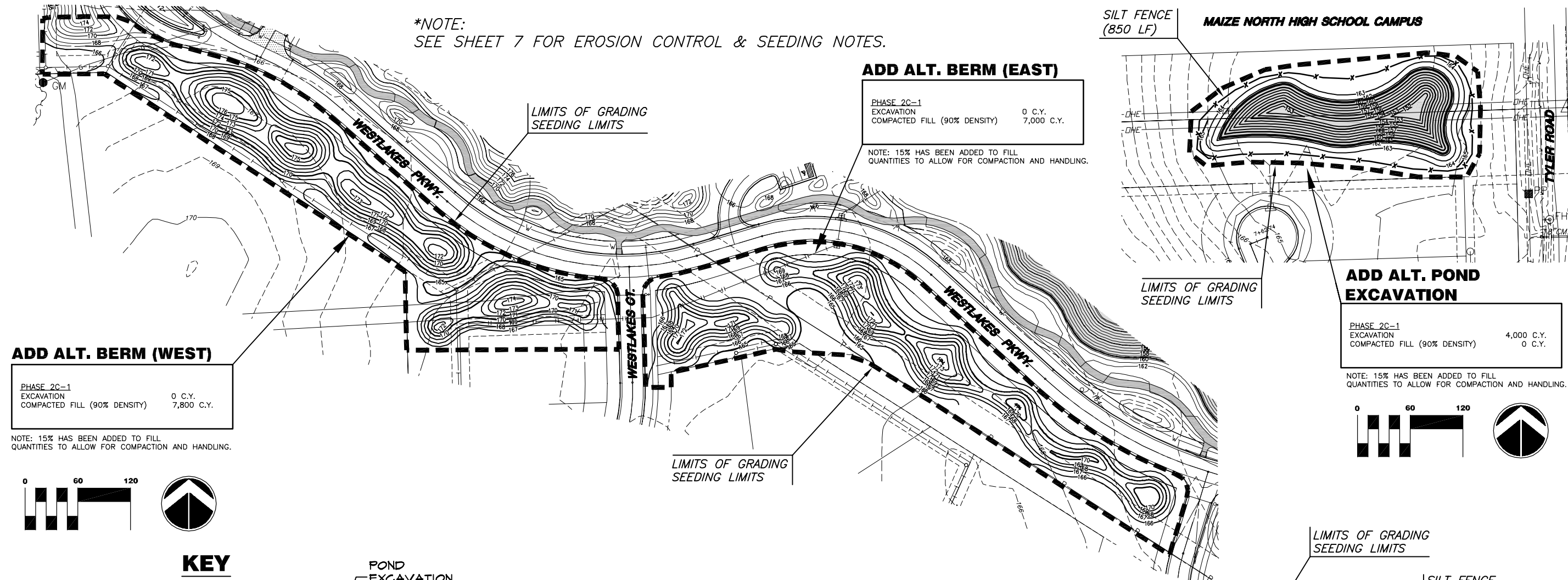

**ADD ALT. BERM (WEST)**  
PHASE 2C-1  
EXCAVATION  
COMPACTED FILL (90% DENSITY)    0 C.Y.  
7,800 C.Y.

NOTE: 15% HAS BEEN ADDED TO FILL QUANTITIES TO ALLOW FOR COMPACTION AND HANDLING.

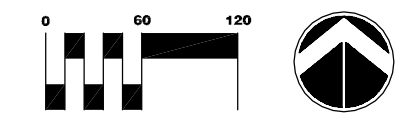

**KEY**

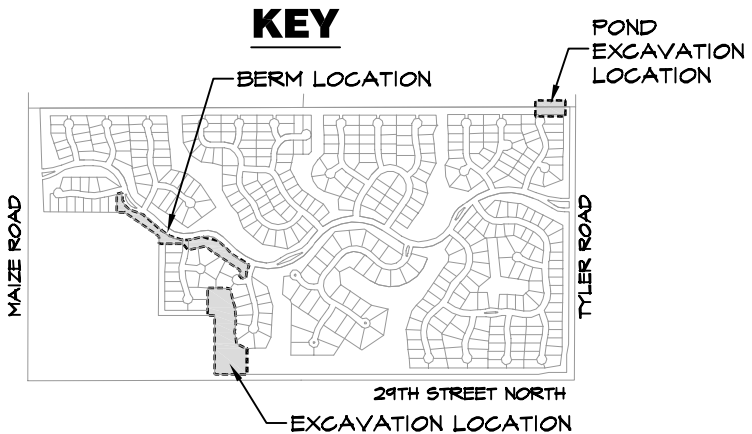

**LEGEND**

- W — WATER LINE
- SAN. SEWER LINE
- - - 1.355 - - - EXIST. CONTOURS
- - - 1.355 - - - PROP. CONTOURS
- - - - - LIMITS OF GRADING/ESTIMATED SEEDING LIMITS (OMIT POND AREA & STREETS)
- x x x x x SILT FENCE

\*NOTE:  
SEE SHEET 7 FOR EROSION CONTROL & SEEDING NOTES.

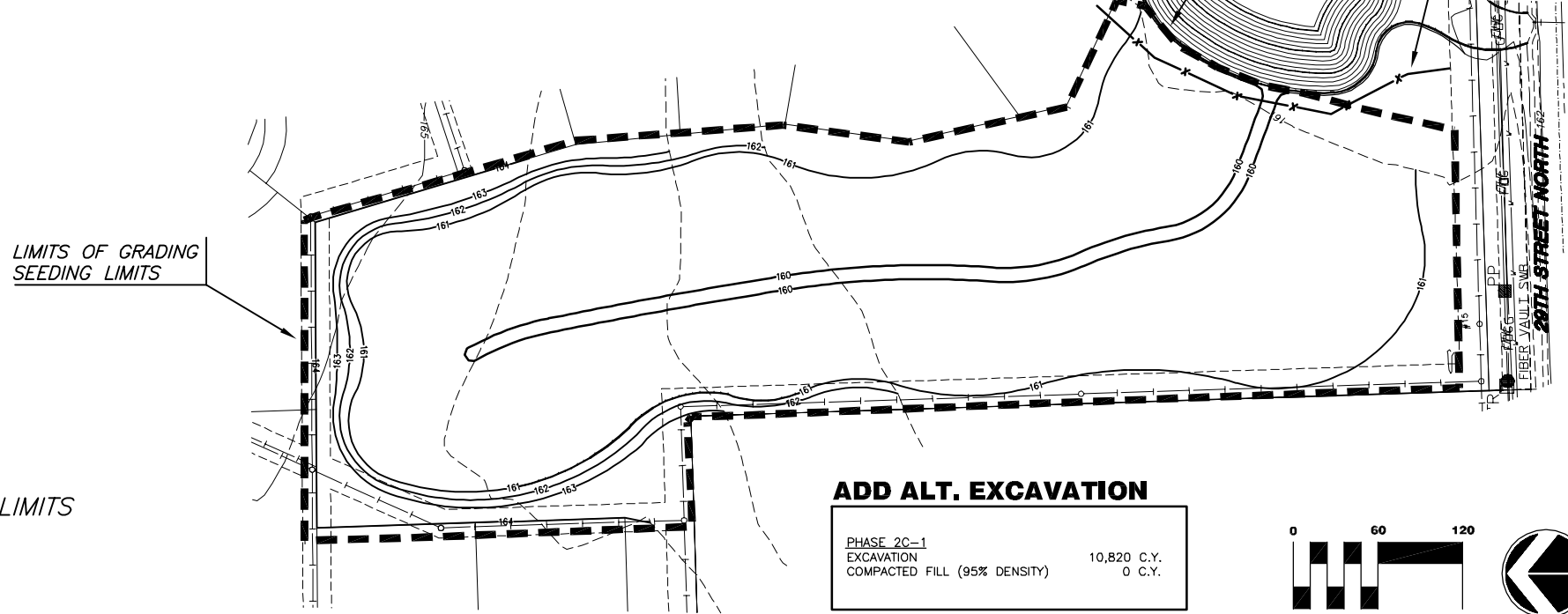

**ADD ALT. EXCAVATION**  
PHASE 2C-1  
EXCAVATION  
COMPACTED FILL (95% DENSITY)    10,820 C.Y.  
0 C.Y.

NOTE: 15% HAS BEEN ADDED TO FILL QUANTITIES TO ALLOW FOR COMPACTION AND HANDLING.

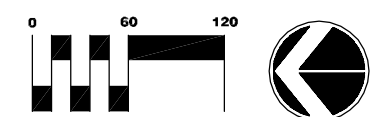

SILT FENCE (850 LF)    MAIZE NORTH HIGH SCHOOL CAMPUS

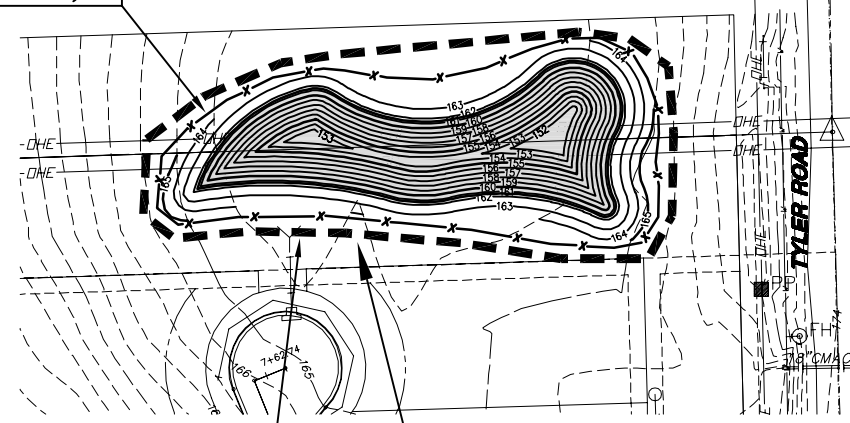

**ADD ALT. POND EXCAVATION**  
PHASE 2C-1  
EXCAVATION  
COMPACTED FILL (90% DENSITY)    4,000 C.Y.  
0 C.Y.

NOTE: 15% HAS BEEN ADDED TO FILL QUANTITIES TO ALLOW FOR COMPACTION AND HANDLING.

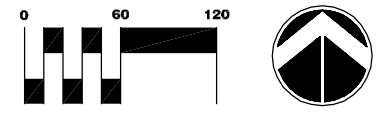

**GRADING PLANS FOR PHASE 2C-1**  
**FOX RIDGE ADDITION**  
 PROJECT NO 468-83997  
 SWD #263

ADD ALTERNATE #1  
SHEET TITLE  
99118  
PROJECT #

DBG  
DESIGN BY  
DBG  
DRAWN BY  
JAG  
CHECKED BY

ISSUED  
JUNE 21, 2006  
REVISED  
JUNE 27, 2006

SHEET NO.  
**6 of 12**