

STORM WATER DRAIN NO. 296 TO SERVE FONTANA AND FONTANA 2ND ADDITION-PHASE 1

OCA NO. 751425
CITY OF WICHITA PROJECT NO. 468-84196

CITY OF WICHITA, KANSAS
JAMES L. ARMOUR, P.E. - CITY ENGINEER

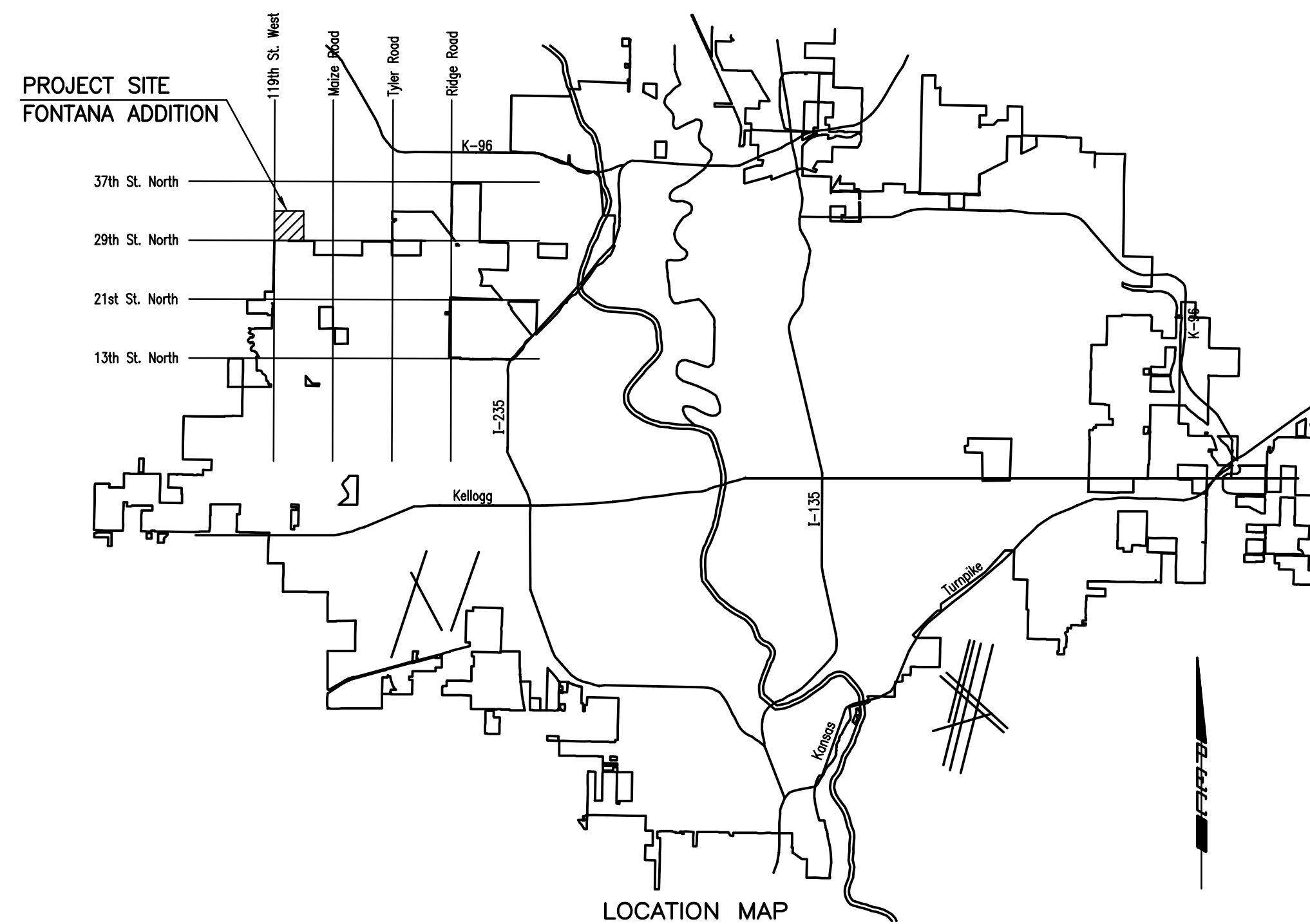

INDEX OF SHEETS

1. TITLE SHEET
2. KEY MAP & GENERAL NOTES
3. EROSION BLANKET PLAN - PONDS 1 & 2
4. EROSION BLANKET PLAN - POND 3
5. EROSION BLANKET PLAN - POND 4

AUGUST 2006

PLANS PREPARED BY
PROFESSIONAL ENGINEERING CONSULTANTS, P.A.
ENGINEERS
WICHITA, KANSAS