

Scaled 08-28-2006 7:24:46 AM by BEJ  
 Plot Scale 1:40 08-28-2006 7:28:48 AM by BEJ  
 J:\SERV\01\2004\04485\005\2006-08-25 to City DWP\03-Ponds 1&2

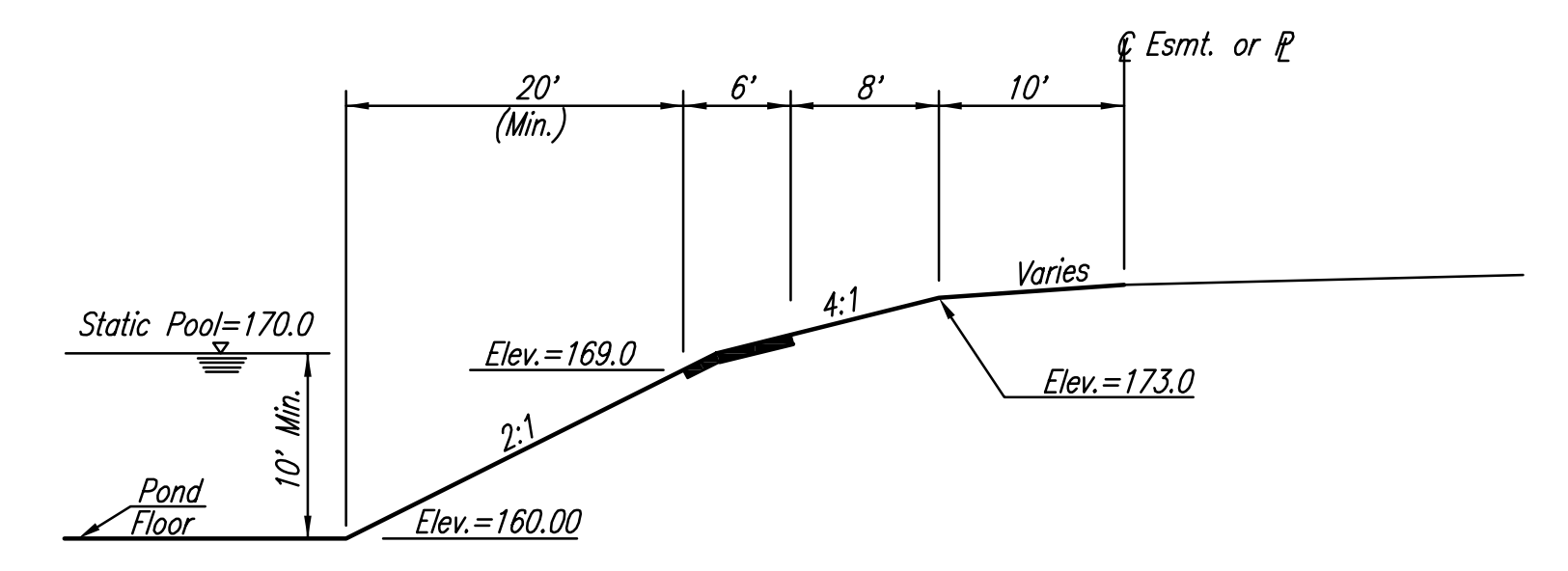

**SECTION A-A**

SCALE: 1"=40'

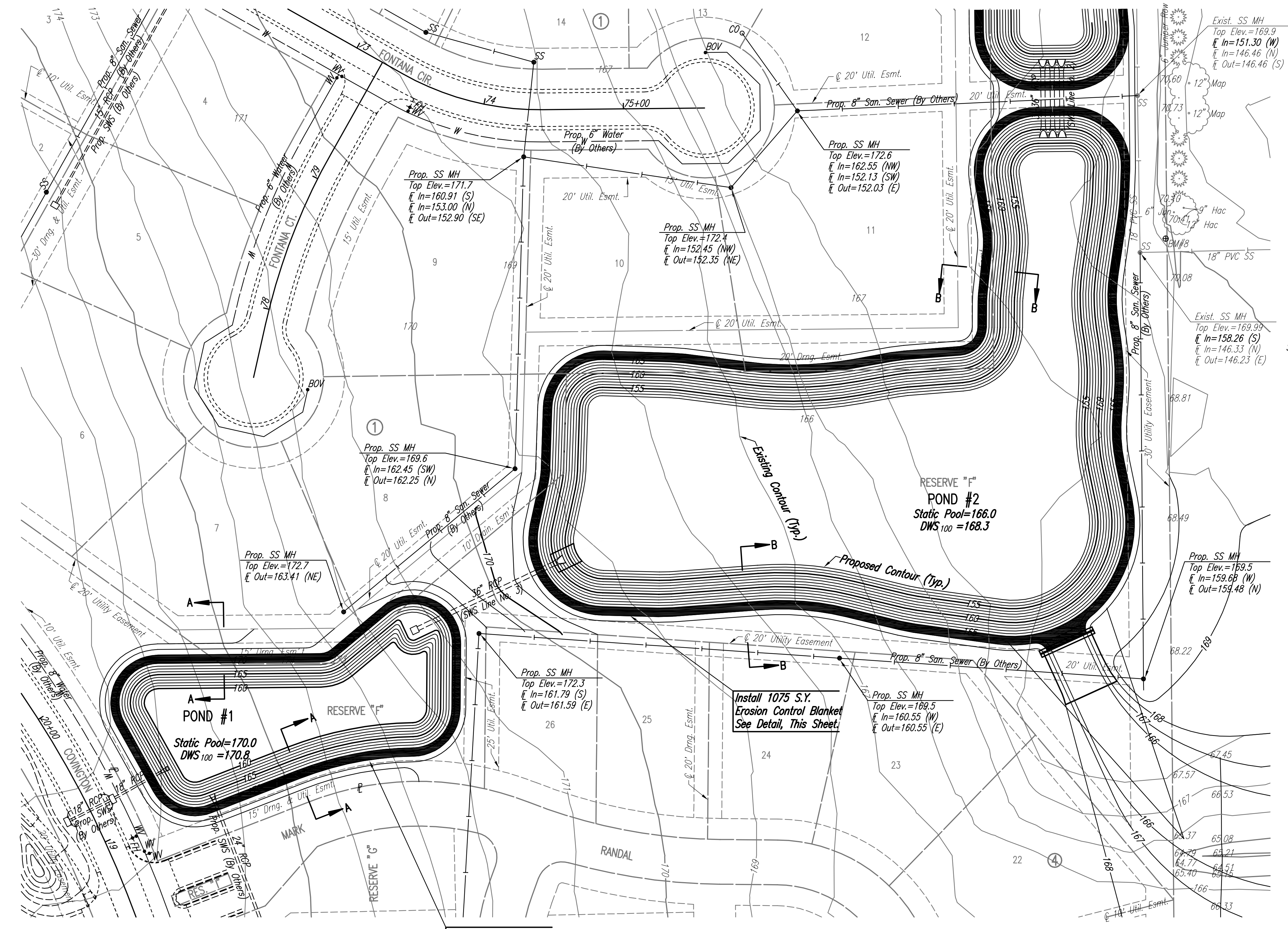
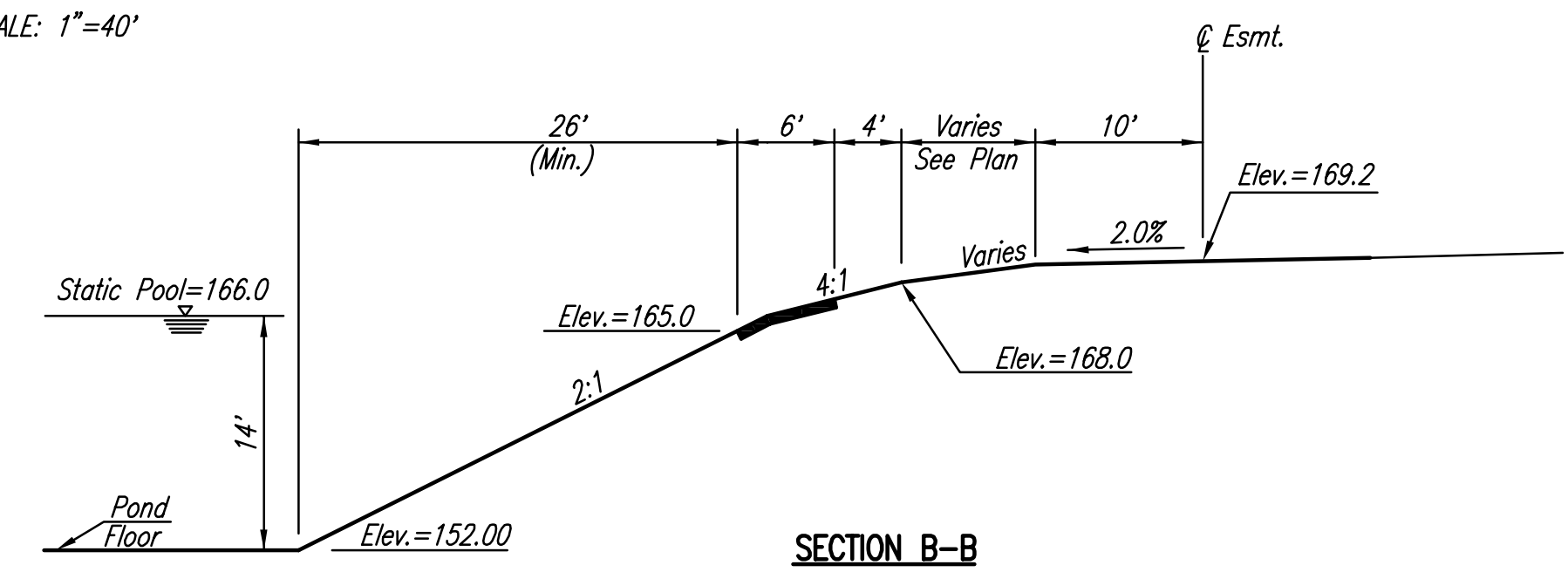

**SECTION B-B**

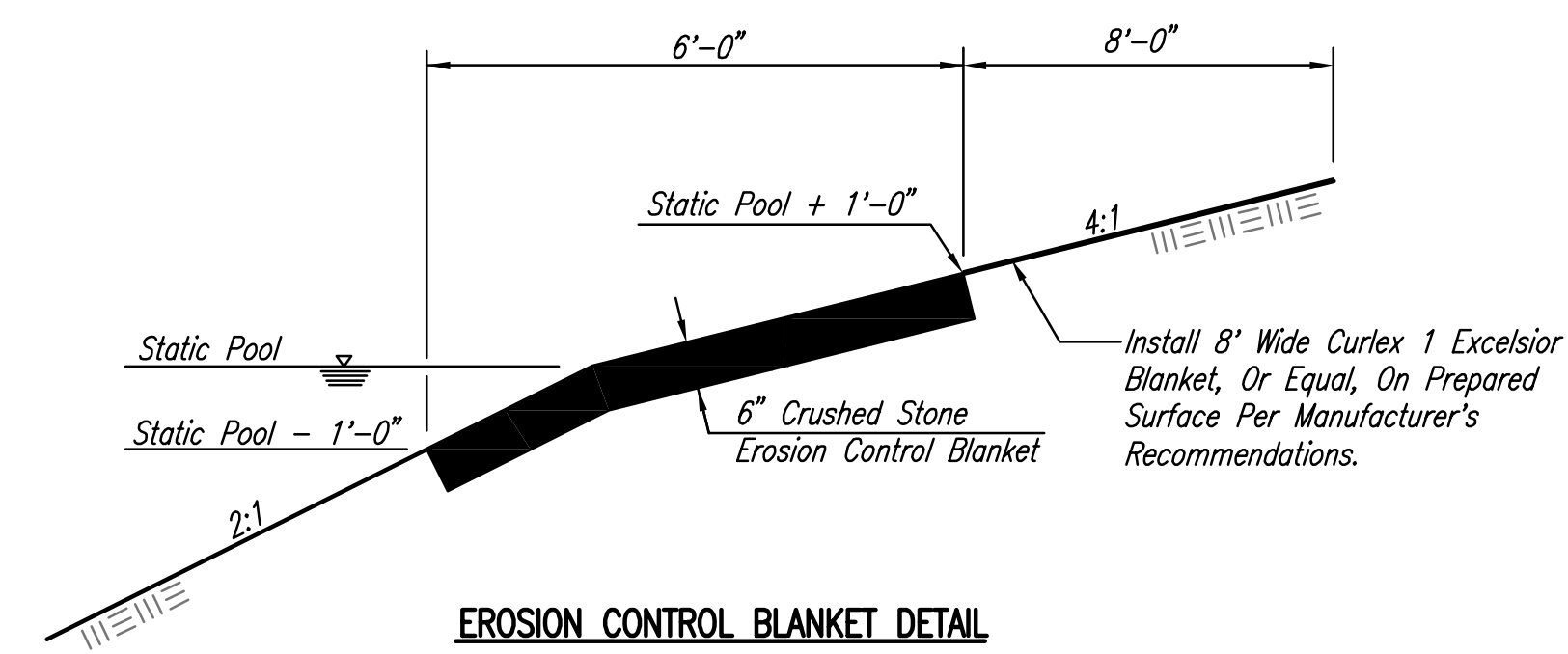

**EROSION CONTROL BLANKET DETAIL**

**NOTES**

CRUSHED STONE FOR THE EROSION CONTROL BLANKET SHALL BE COMMERCIALY AVAILABLE 5" X 9" CRUSHED STONE RIPRAP. MATERIALS SHALL MEET REQUIREMENTS FOR QUALITY AND DELETERIOUS SUBSTANCES AS SET FORTH IN SUBSECTION 1116.02 (d)(2) ROAD AND BRIDGE CONSTRUCTION, KANSAS DEPARTMENT OF TRANSPORTATION, 1990 EDITION.

PAYMENT FOR EROSION CONTROL BLANKET SHALL BE BID PER SQUARE YARD IN PLACE.

**Install 440 S.Y.  
Erosion Control Blanket  
See Detail, This Sheet.**

**Install 1075 S.Y.  
Erosion Control Blanket  
See Detail, This Sheet.**

No.	Revision	By	Date
FONTANA ADDITION & FONTANA 2ND ADDITION-PHASE 1 STORM WATER DRAIN NO. 296			
<b>EROSION BLANKET-PONDS 1 &amp; 2</b>			
JAMES L. ARMOUR, P.E.- CITY ENGINEER CITY OF WICHITA PROJECT NO. 468-84196			
<b>Professional Engineering Consultants, P.A.</b> 303 S. TOPEKA • WICHITA, KANSAS 67202 316-262-2691 • FAX 316-262-3003			
Designed by	BDB, BMM	Job No.	35-04485-005
Drawn by	BMM	Date	SEPTEMBER 2004

