

# STORM WATER DRAIN NO. 236

TO SERVE

## FONTANA AND FONTANA 2ND ADDITION-PHASE 1

OCA NO. 751411  
 CITY OF WICHITA PROJECT NO. 468-83883  
**CITY OF WICHITA, KANSAS**  
 JAMES L. ARMOUR, P.E. - CITY ENGINEER

**INDEX OF SHEETS**

1. TITLE SHEET
2. KEY MAP AND GENERAL NOTES
- 3-5. PLAT AND HORIZONTAL CONTROL
- 6-7. FOUR CORNER GRADING PLAN
- 8-9. SITE GRADING PLAN
10. TYPICAL 29' BK.-BK. PAVEMENT DETAILS (INFORMATION ONLY)
11. TYPICAL 35' BK.-BK. PAVEMENT DETAILS (INFORMATION ONLY)
12. GRADING PLAN-POND NO. 1 AND 2
13. GRADING PLAN-POND NO. 3
14. GRADING PLAN-POND NO. 4
15. PLAN/PROFILE-SWS LINE NO. 1
16. PLAN/PROFILE-SWS LINE NO. 2
17. PLAN/PROFILE-SWS LINE NO. 3
18. STD. TYPE 1A CURB INLET DETAILS (5' OPENING)
19. TYPE "C" INLET DETAILS
20. REINFORCED CONCRETE WEIR DETAILS
21. MANHOLE FRAME AND COVER DETAILS
22. MISCELLANEOUS DRAINAGE DETAILS
- 23-24. EROSION CONTROL PLANS
- 25-28. EROSION CONTROL DETAILS
- 29-64. CROSS SECTIONS-STREET (INFORMATION ONLY)
- 65-79. CROSS SECTIONS-PONDS (INFORMATION ONLY)

**EARTHWORK**

EXCAVATION 204,397 CU. YDS.

EXCAVATED MATERIAL FROM ON-SITE SHALL BE USED FOR MASS GRADING WITHIN THE IMPROVEMENT DISTRICT BOUNDARY UNTIL ALL ON SITE-MATERIAL HAS BEEN UTILIZED. NO BORROW MATERIAL IS REQUIRED FOR MASS GRADING.

SEE SHEETS NO. 8 AND 9 FOR SITE GRADING PLAN AND ADDITIONAL NOTES.

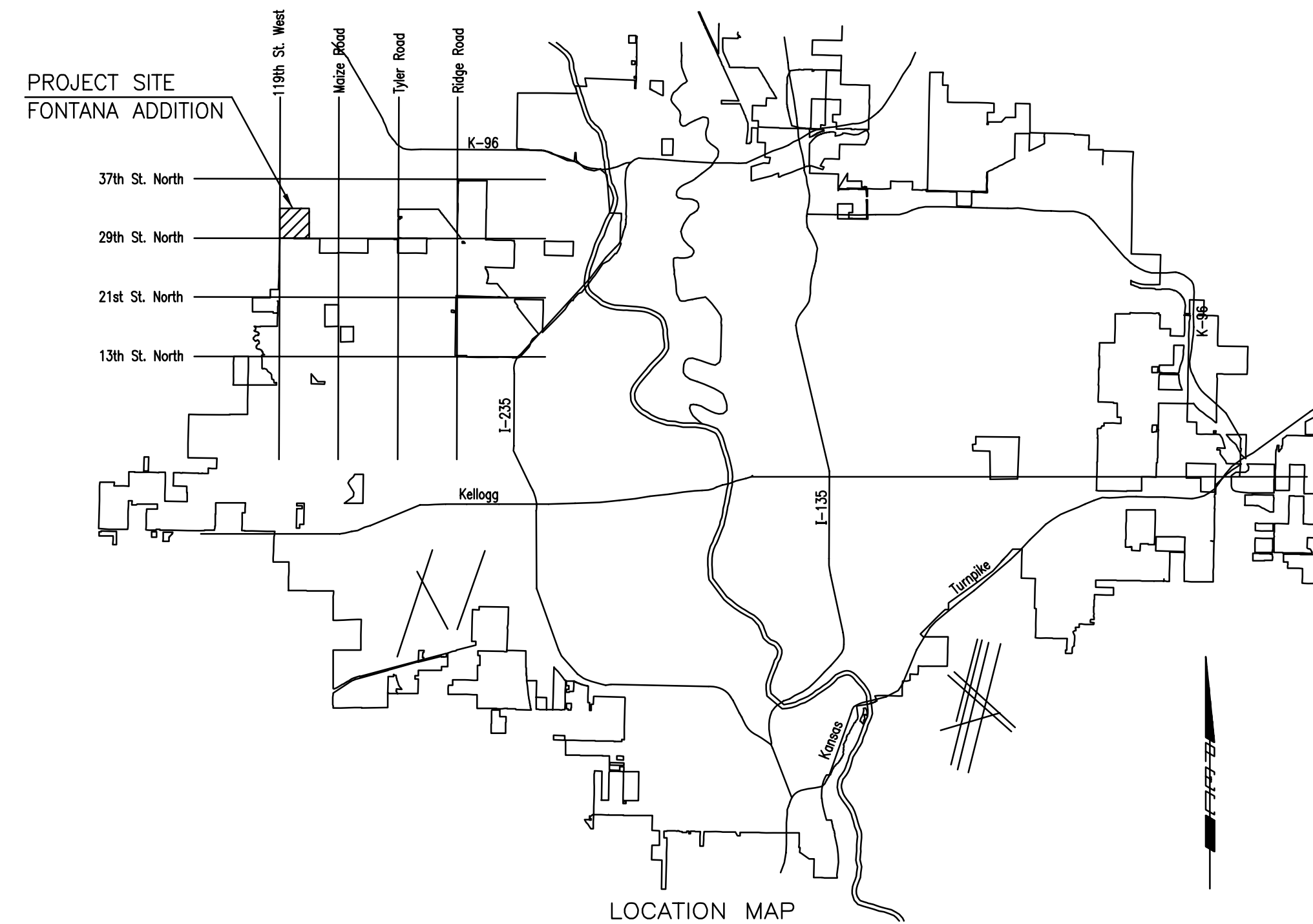

**DECEMBER 2005**

PLANS PREPARED BY  
**PROFESSIONAL ENGINEERING CONSULTANTS, P.A.**  
 ENGINEERS  
 WICHITA, KANSAS

**CONSTRUCTION SCHEDULE/SEQUENCE**

THE CONTRACTOR FOR EACH OF THE FOLLOWING FONTANA PROJECTS SHALL COORDINATE THEIR EFFORTS WITH OTHER CONTRACTORS PERFORMING WORK IN THIS AREA SUCH THAT ANY NECESSARY SIMULTANEOUS CONSTRUCTION CAN PROCEED CONCURRENTLY WITHOUT CAUSING UNDUE DELAYS SO THAT CONSTRUCTION CAN BE COMPLETED WITHIN THE TIME FRAMES AS NOTED.

**SANITARY SEWER (468-83877)**

THE CONTRACTOR SHALL SEQUENCE HIS WORK TO COMPLETE, INCLUDING TESTING AND ACCEPTANCE, THE FOLLOWING WORK: LINE 1 FROM BEGINNING TO MH 6, LINE 2 IN ITS ENTIRETY, LINE 3 IN ITS ENTIRETY, LINE 4 IN ITS ENTIRETY, LINE 7 FROM BEGINNING TO MH 30, LINE 15 IN ITS ENTIRETY, LINE 9 IN ITS ENTIRETY, LINE 11 IN ITS ENTIRETY, LINE 13 IN ITS ENTIRETY, LINE 14 IN ITS ENTIRETY, LINE 10 IN ITS ENTIRETY, COMPLETE ALL REMAINING WORK. ALL WORK ON THE PROJECT SHALL BE COMPLETED BY MAY 5, 2006.

**WATER DISTRIBUTION SYSTEM (448-89999)**

THE CONTRACTOR SHALL COMPLETE FONTANA - PHASE 1 AND FONTANA 2ND WATERLINE CONSTRUCTION BY JUNE 2, 2006. THE CONTRACTOR SHALL COORDINATE INSTALLATION OF WATERLINES WITH THE STORM WATER DRAIN AND PAVING CONTRACTOR SO THAT STORM SEWERS CROSSING BELOW PROPOSED WATERLINES WILL BE INSTALLED PRIOR TO WATERLINE CONSTRUCTION. THE CONTRACTOR SHALL COORDINATE HIS WORK EFFORTS WITH THE CONTRACTOR FOR THE WATER SUPPLY LINE (BY OTHERS) FOR CONNECTION TO THE SUPPLY LINE AND BLOWING OFF/TESTING OF THE PROPOSED WATERLINES.

**STREETS/DRAINAGE (472-84086)**

THE CONTRACTOR SHALL COMPLETE FONTANA - PHASE 1 AND FONTANA 2ND STREETS/DRAINAGE CONSTRUCTION BY JULY 14, 2006.

**STORM WATER DRAIN (468-83883)**

THE CONTRACTOR SHALL COMPLETE FONTANA - PHASE 1 AND FONTANA 2ND STORM WATER DRAIN CONSTRUCTION BY MARCH 11, 2006.