

PLAN	CHECKED	DATE
	CHECKED	

PROFILE	CHECKED	DATE
	CHECKED	

Saved: 12-14-2005 8:20:42 AM By: BLS
 Plot Scale: 1:20 12-14-2005 5:11:26 PM By: BLS
 J:\SENTOU\2004\04485\2005-12-14 to City\SWD 236\DWG\16-SWS LINE NO. 2

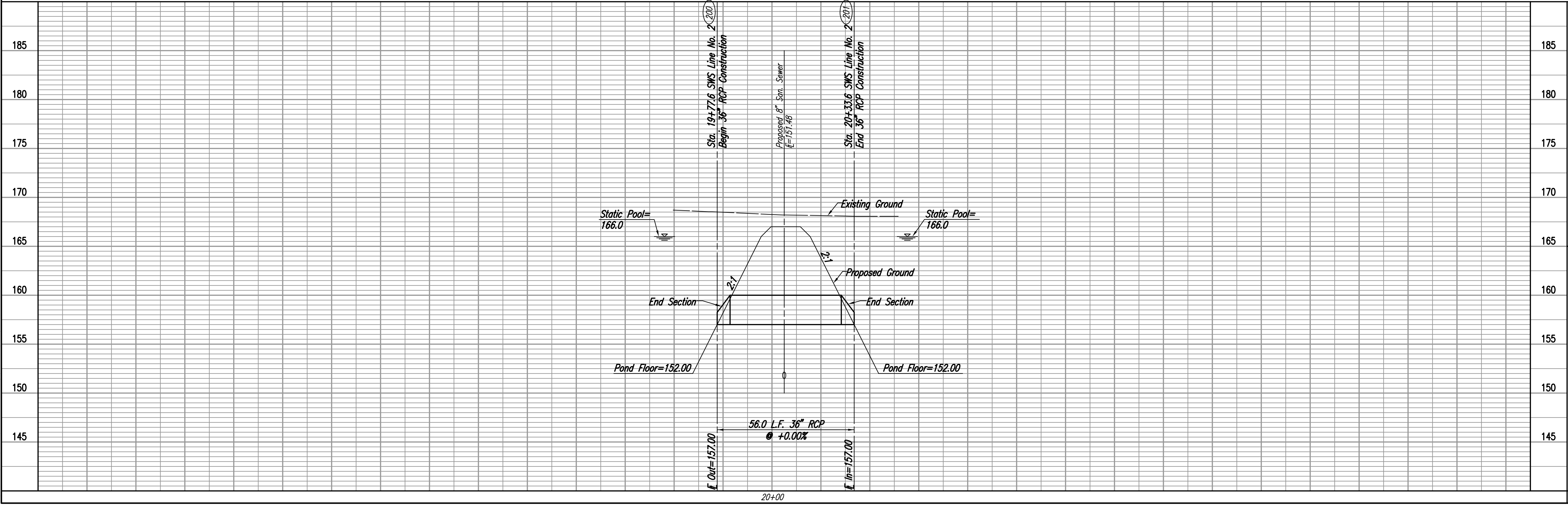

Sta. 19+77.6 SWS Line No. 2
 Begin 36" RCP Construction
 Install 3-56.0 L.F. 36" RCP (N)
 (Including 6 End Sections)

Sta. 20+33.6 SWS Line No. 2
 End 36" RCP Construction

POND #2
 Static Pool=166.0
 DWS₁₀₀ =168.3

POND #3
 Static Pool=166.0
 DWS₁₀₀ =168.5

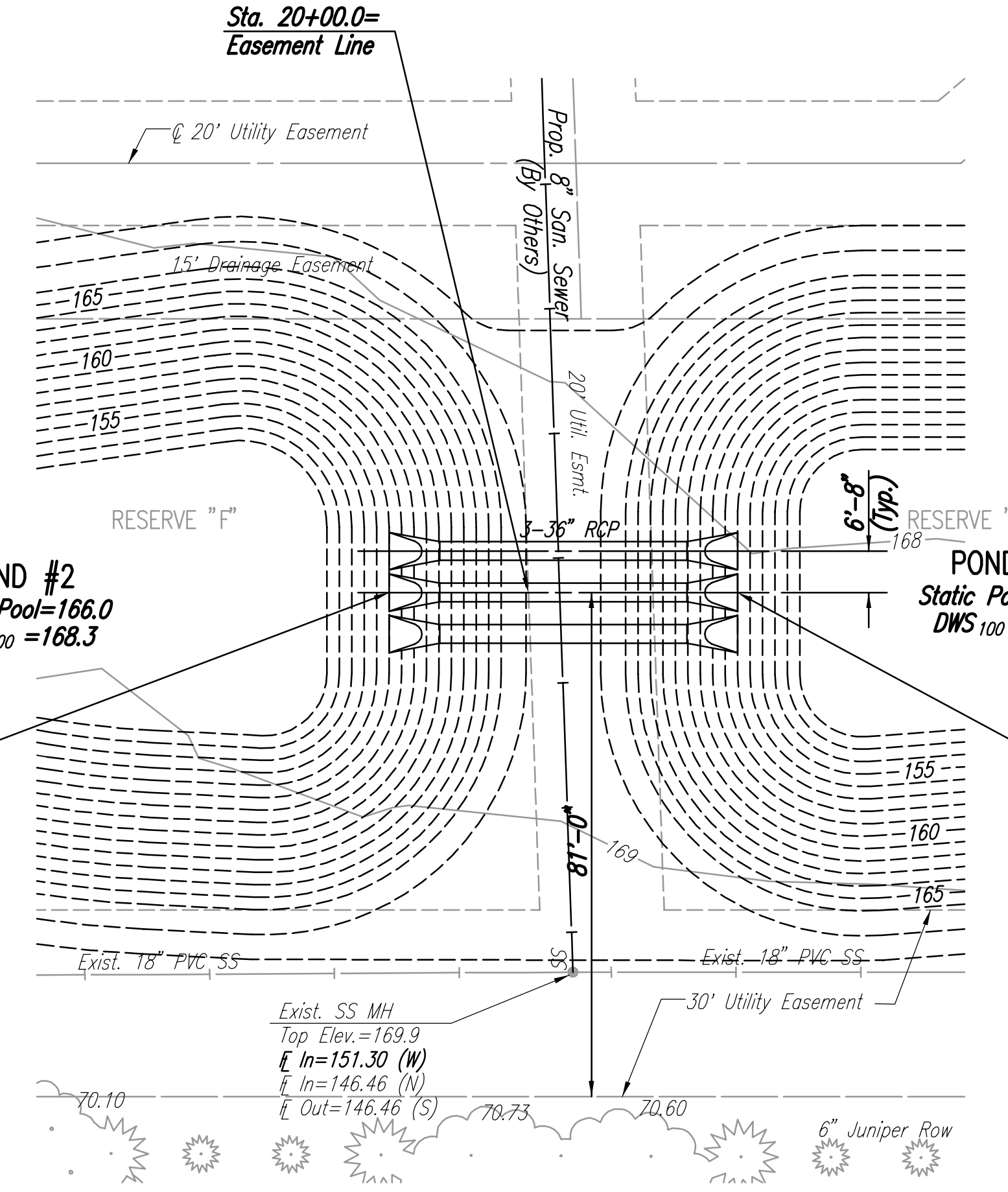

SCALE: 1"=20'

COORDINATE LIST		
POINT	NORTH	EAST
200	26,594.4245	17,265.7558
201	26,650.4216	17,265.1857

200 = COORDINATE POINT NO.
 SEE SHEET NO. 3 FOR PLAT COORDINATES

Professional Engineering Consultants, P.A.
 303 S. TORRENS, WICHITA, KANSAS 67202
 316-262-2291 • FAX 316-262-3063

Designed By: BLS, BDB
 Drawn By: BUS

Job No.: 35-04485-001
 Date: SEPTEMBER 2004

Fontana Addition-Phase 1
 Storm Water Drain No. 236

SWS LINE NO. 2

JAMES L. ARMOUR, P.E.-CITY ENGINEER
 CITY OF WICHITA PROJECT NO. 468-83883

Sheet 16 of 79