

@ Sta. 134+83.10, 31.00' Rt. =  
WL NO. 1 Sta. 34+76.26

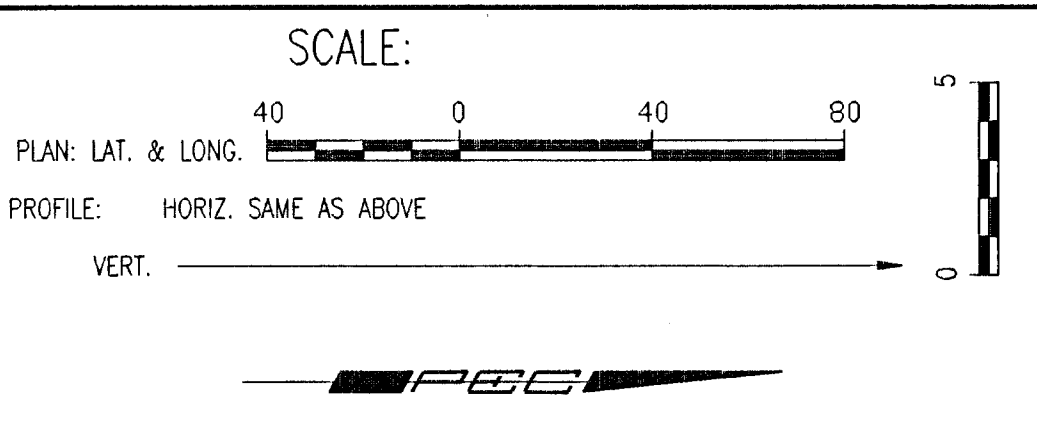

@ Sta. 139+82.46, 31.00' Rt. =  
WL NO. 1 Sta. 39+75.62  
1- 12" CI CL MJ 11 1/4" Bend

@ Sta. 140+81.28, 56.00' Rt. =  
WL NO. 1 Sta. 40+77.55  
1- 12" CI CL MJ 11 1/4" Bend

@ Sta. 142+60.00, 56.00' Rt. =  
WL NO. 1 Sta. 42+57.02  
1- 12" x 12" CI CL MJ Tee  
1- 12" Anchored MJ Gate Valve (E)  
Top Valve Box El. = Match Existing

@ Sta. 143+81.48 (ext.), 56.00' Rt. =  
WL NO. 1 Sta. 43+77.75 (Back) =  
WL NO. 1 Sta. 43+59.49 (Ahead)  
1- 12" x 12" CI CL MJ Tee  
1- 12" MJ Plug (E)

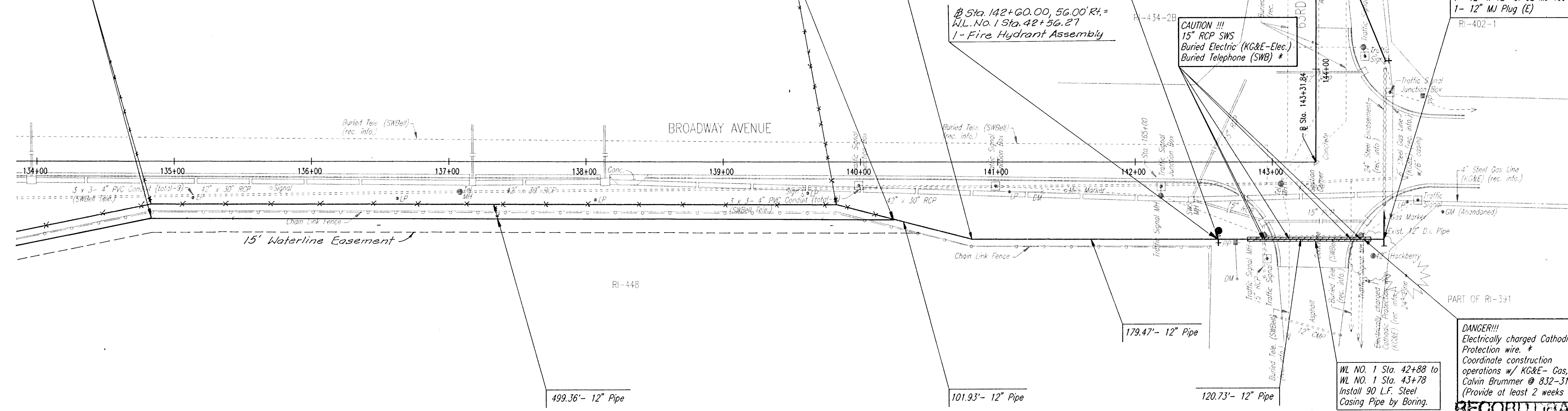

\* PRIOR TO BEGINNING CONSTRUCTION, THE CONTRACTOR SHALL EXCAVATE THE UTILITIES TO VERIFY THEIR HORIZONTAL AND VERTICAL LOCATIONS. THE UTILITY LOCATION SHALL BE REPORTED TO THE ENGINEER SO THAT ANY NECESSARY PLAN MODIFICATIONS CAN BE MADE. ANY ADDITIONAL LABOR OR MATERIALS NECESSARY TO COMPLETE THE CONNECTIONS SHALL BE CONSIDERED SUBSIDIARY TO THE PROJECT.

Unless noted otherwise, elevations shown are top of pipe

WATERLINE NO. 1

WL NO. 1 Sta. 42+88 to  
WL NO. 1 Sta. 43+78  
Install 90 L.F. Steel Casing Pipe by Boring.

**DANGER!!!**  
Electrically charged Cathodic Protection wire. \*  
Coordinate construction operations w/ K&E - Gas, Calvin Brummer @ 832-3119 (Provide at least 2 weeks notice)

**RECORD DRAWING**  
MDK PROJ. ENG. 1/19/97 DATE  
R.S. ENG. DATE

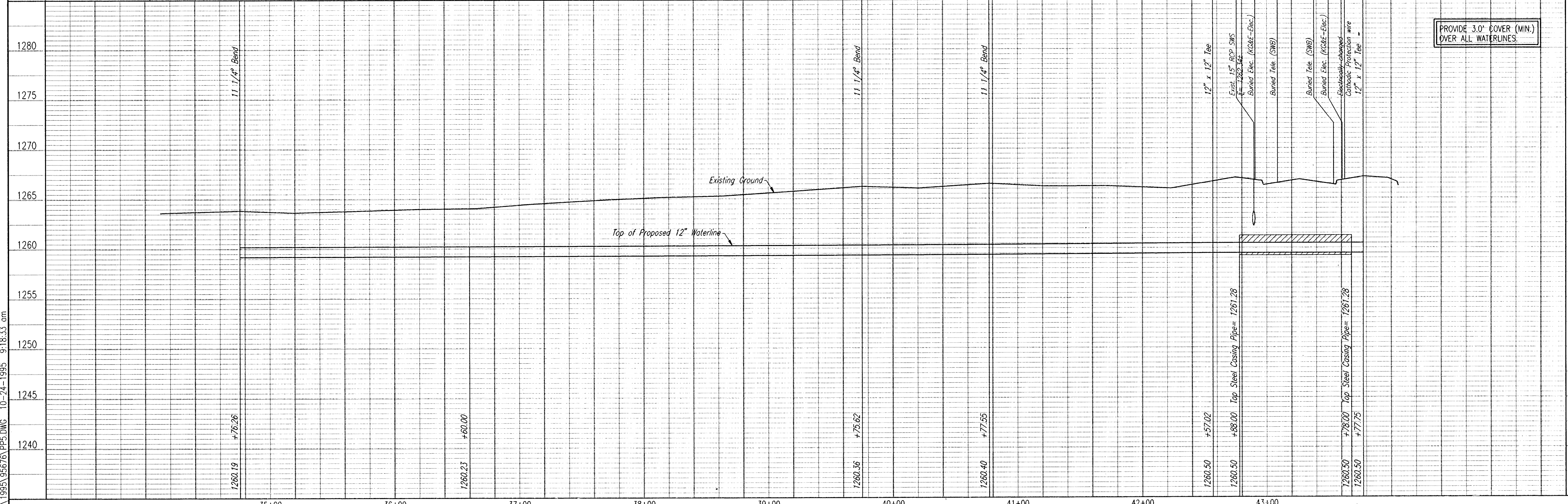
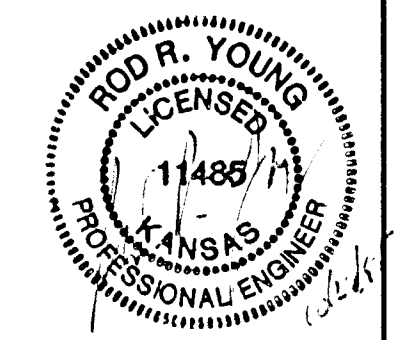

PROVIDE 3.0" COVER (MIN.) OVER ALL WATERLINES.

DSNR: REF. OPER. JLM SCALE: 1"=40.00  
C:\1995\95676\PP5.DWG 10-24-1995 9:18.33 am

CITY OF HAYSVILLE  
SEDGWICK COUNTY, KANSAS  
**WATERLINE NO. 1**  
HAYSVILLE EMERGENCY WATERLINE  
WATERLINE IMPROVEMENTS

PROFESSIONAL ENGINEERING CONSULTANTS, P.A.  
OWNERS: WICHITA, KANSAS  
Job No. 34-95676  
Date October 1995  
Designed By: MDS, MDK  
Drawn By: JLM