

NOTE: Temporary bracing to prevent overturning of exterior girder and to protect aesthetic elements is not shown in this schematic but is required.

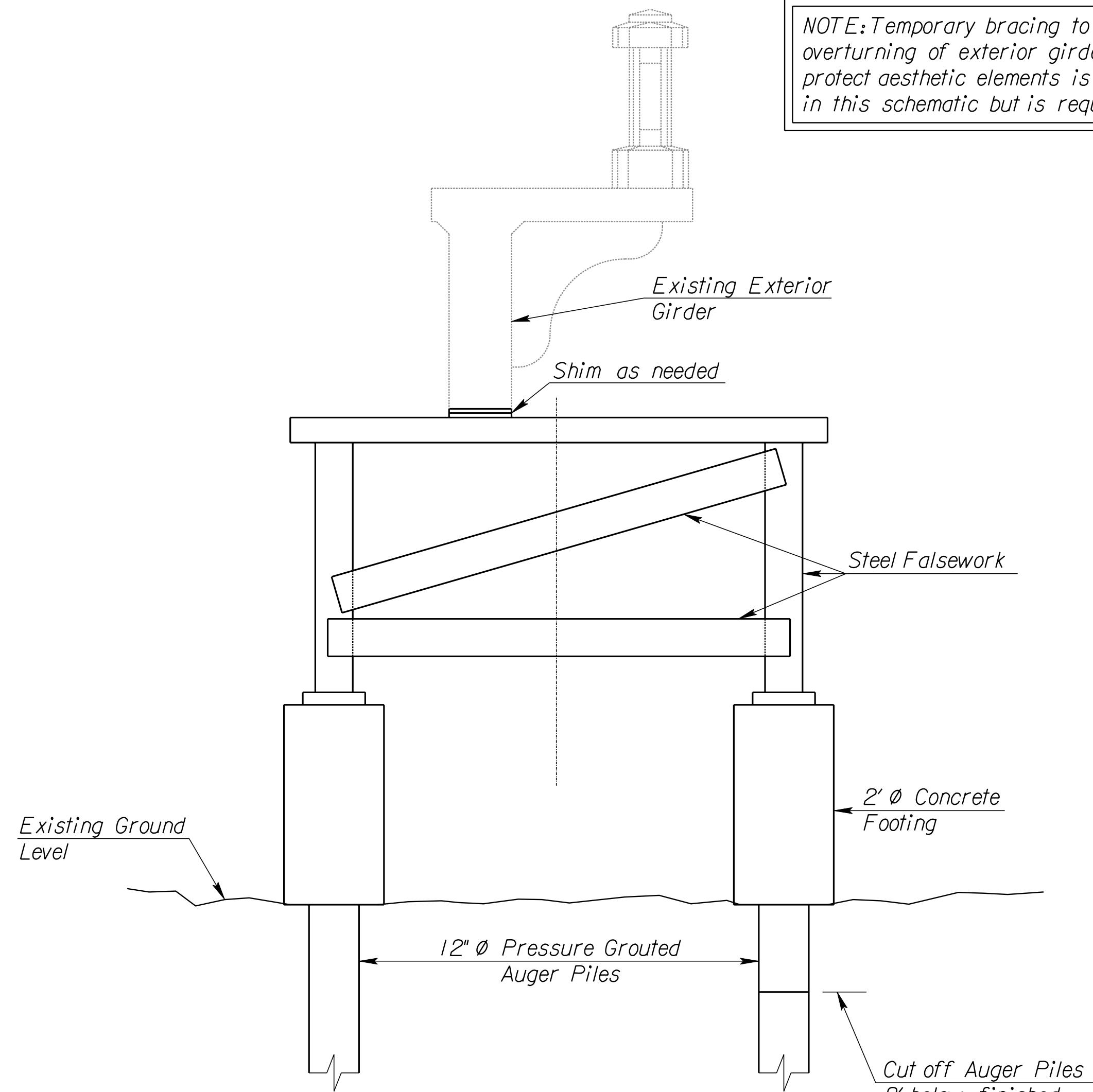

SCHMATIC FOR FALSEWORK (TYPICAL)
(Support for Exterior Girder near the Abutments)

This detail is a concept only. Actual falsework to be designed by a licensed Kansas Professional Engineer. Provide seven sets of shop drawings, including design calculations and details, three (3) weeks before work is scheduled to begin.

All falsework required for the temporary support of the exterior girder near the abutments is included in the bid item, "Temporary Shoring", Lump Sum.

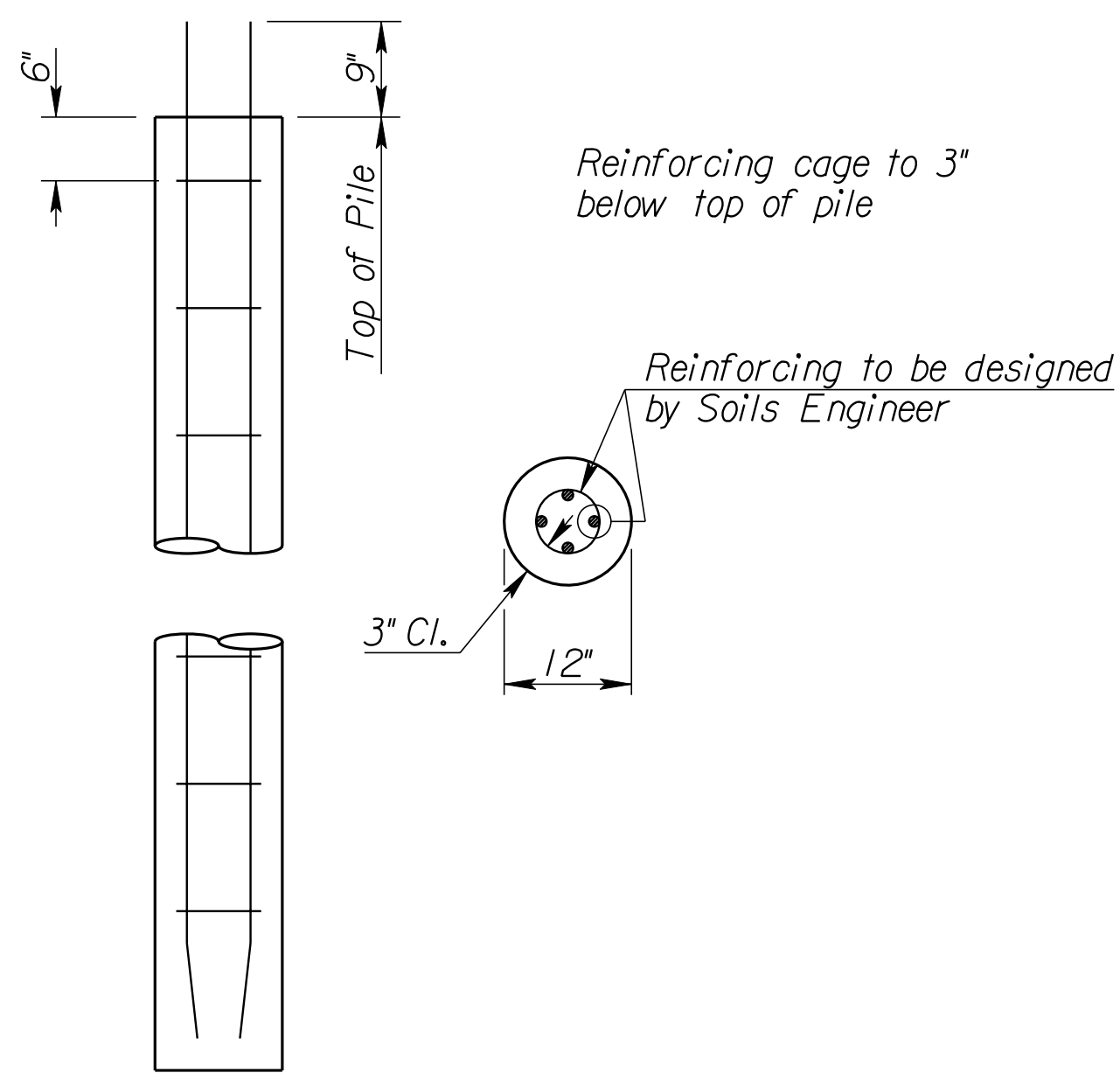

AUGER CAST PILE SECTION AND ELEVATION
(Optional)

1. The design capacity of each 12" dia. Auger cast pile is 50 ton. Installation of piles shall be verified by a licensed soils engineer.
2. The bottom elevation of auger cast piles shall be as determined by the soil Engineer.
3. It is anticipated that borings will encounter groundwater.

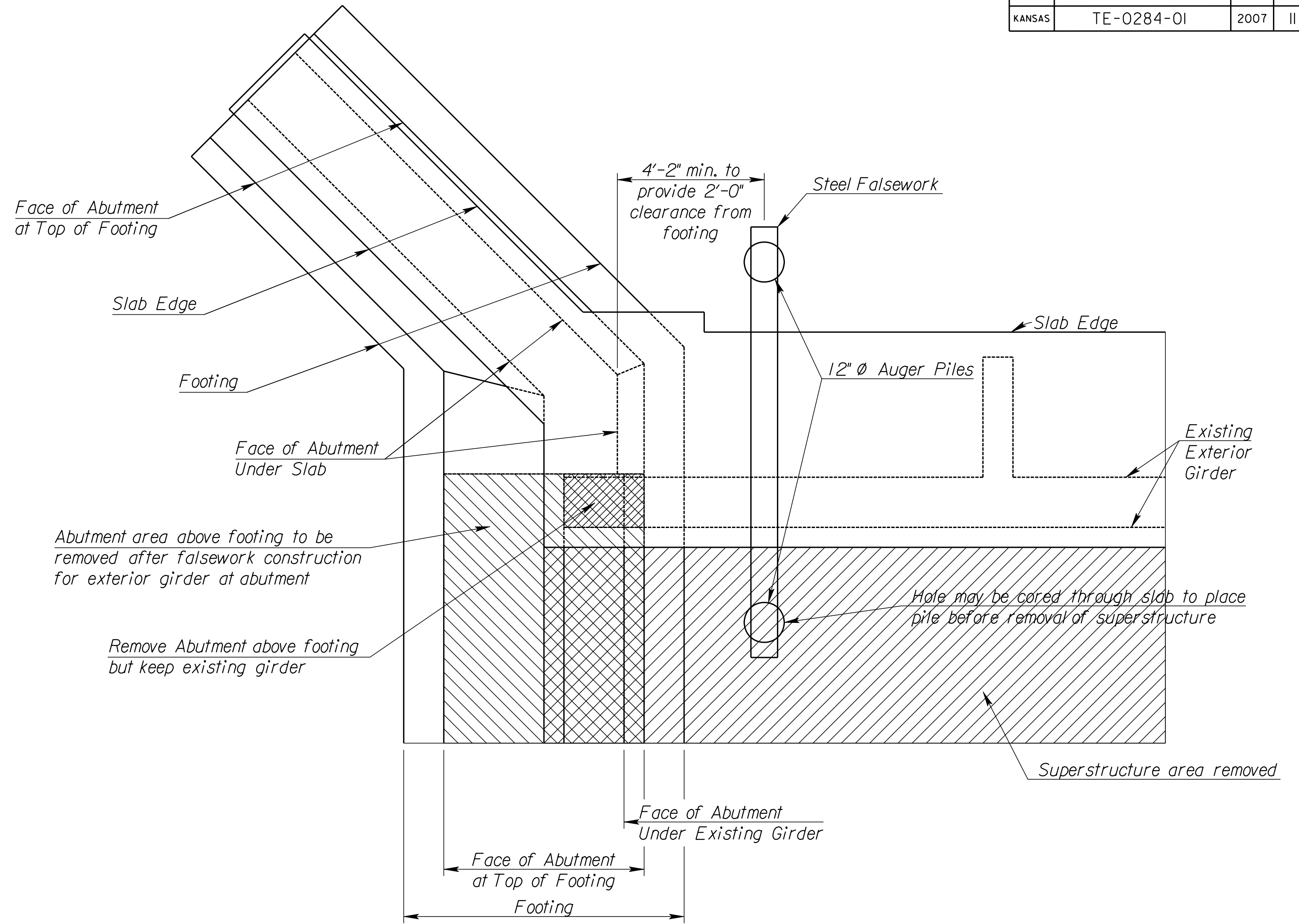

PLAN SHOWING LOCATION OF EXTERIOR GIRDER FALSEWORK AT ABUTMENT
(Required 4 Quadrants)
(Northwest corner shown; other corners similar)

Temporary Support of Existing Exterior Girder at Bents
At abutments, provide a temporary support for the end of the exterior girder. Temporary support must remain in place for the removal and reconstruction of the abutment wall beneath the existing girder. Temporary support shall incorporate bracing to prevent overturning of the exterior girder, existing slab, and handrail elements.

Submit Shop Drawings to the Engineer for approval prior to fabrication. This temporary support is included in the bid item "Temporary Shoring", Lump Sum.

K:\35750A\CADD\SHEETS\BRIDGE\13TH\STG02.dgn SURV. JG, CP | PLOT CADD | DES. AH | DR. GBI | TR. CKD. BS | APP. RG

CITY OF WICHITA JAMES ARMOUR, P.E., CITY ENGINEER 13TH STREET BRIDGE OVER LITTLE ARKANSAS RIVER EXTERIOR GIRDER TEMPORARY SUPPORT		
PB PARSONS BRINCKERHOFF <small>122. Wichita, Kansas</small>		
SCALE	DATE 10/9/2007	DWG NO. 35750A