

STATE	PROJECT NO.	YEAR	SHEET NO.	TOTAL SHEETS
KANSAS	TE-0284-01	2007	16	47

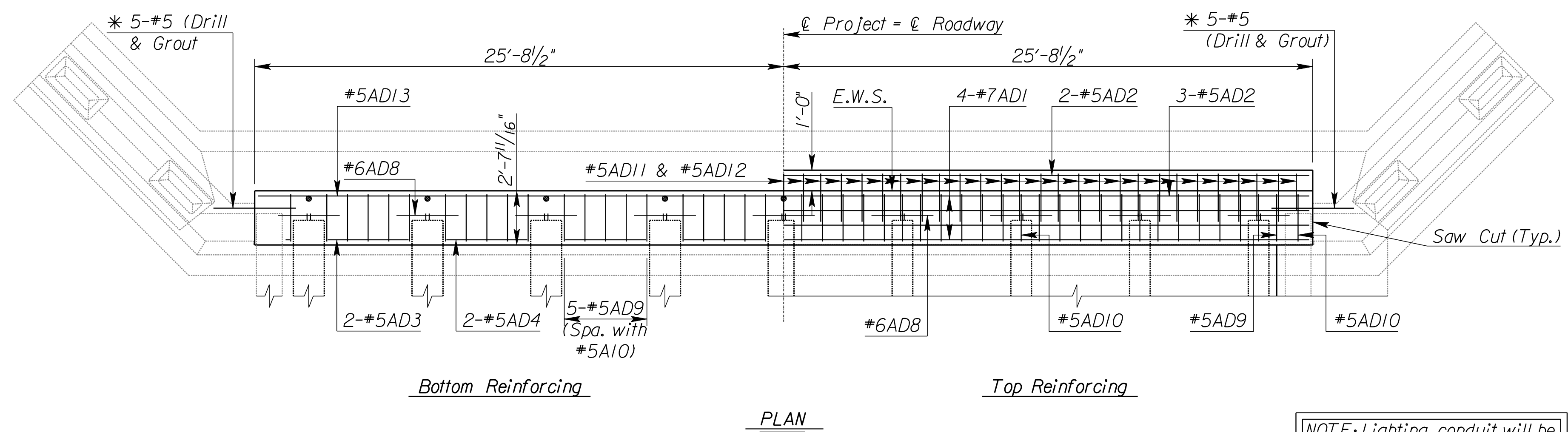

Bottom Reinforcing
PLAN
Top Reinforcing

NOTE: Lighting conduit will be carried through abutment and pier diaphragm.

* Keep existing transverse reinforcing projecting from abutment wings. Sandblast to remove corrosion.

Drill and grout to provide spacing as shown. All material, including steel, and work is paid for at the set price for the bid item, "Drilling and Grouting". Minimum embedment & projection for #5 is 1'-6". Use low impact drill to minimize damage to existing concrete.

"Drill & Grout" quantity includes 10-#5 in the abutment diaphragm of each abutment.

The intent of the design is to provide a constant width (2'-7 11/16") abutment diaphragm. The width of the top of the abutment wall will vary.

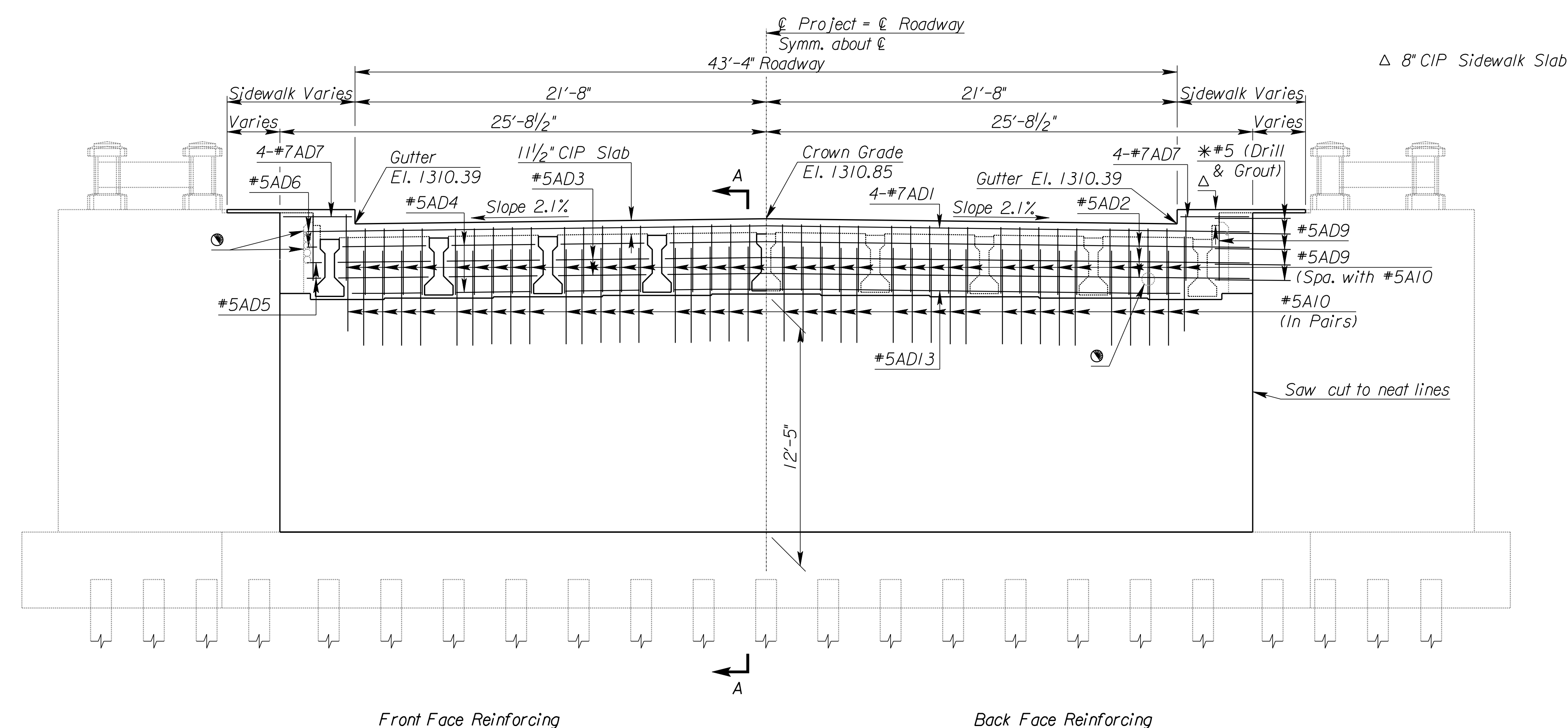

Front Face Reinforcing
ELEVATION
Back Face Reinforcing

(Looking West @ Abut. #1,
Looking East @ Abut. #2)

- For gas utility, provide 14" Ø PVC sleeve in diaphragm, centered 1' above beam seat. For lighting conduits, provide PVC sleeve with ID min. 1/2" greater than OD given on lighting shop drawings.
- For Telephone conduits, wrap conduits with teflon to allow movement of conduits in diaphragm.

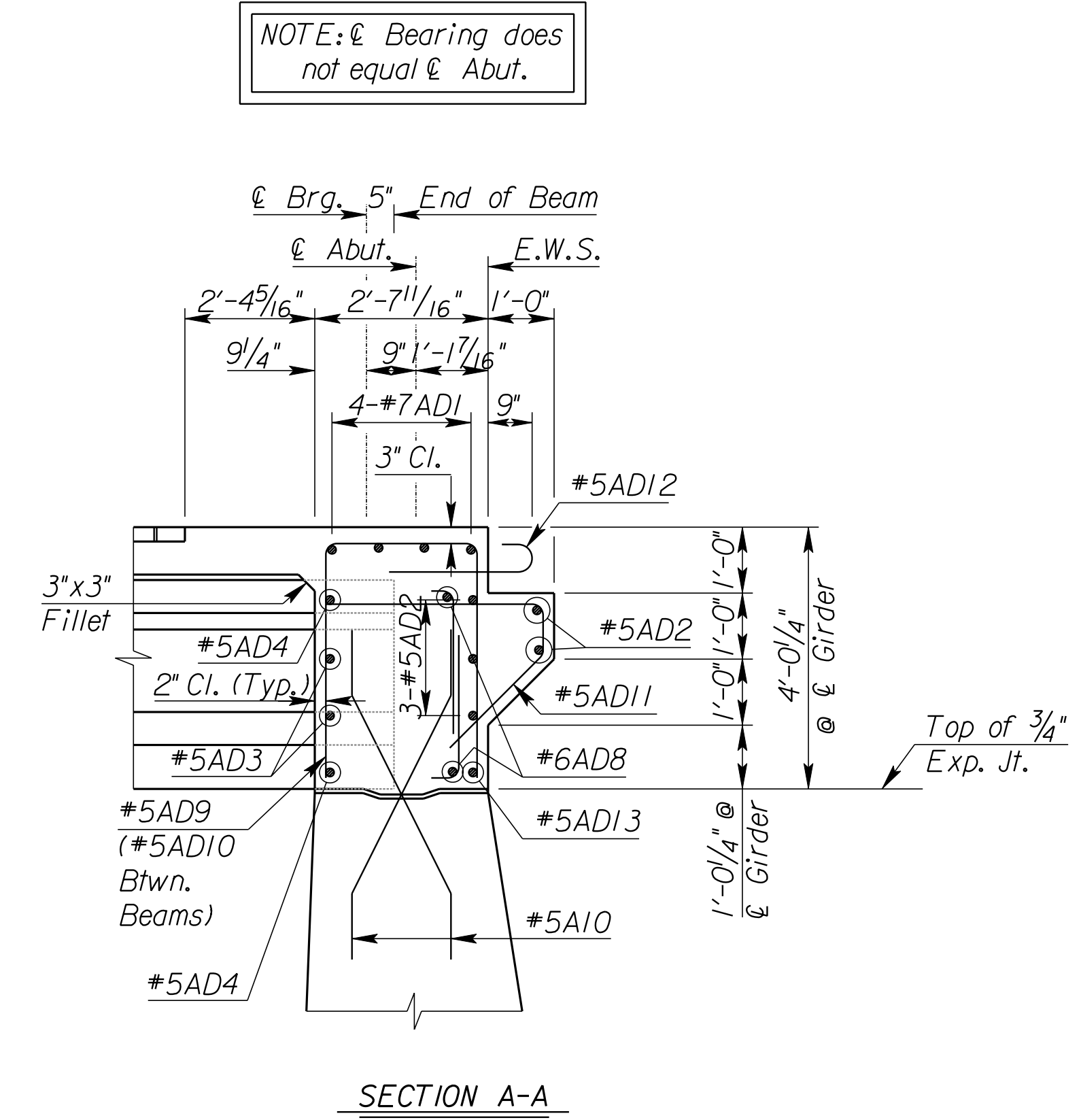

NOTE: CL Bearing does not equal CL Abut.

SECTION A-A

K:\35750A\CADD\SHEETS\BRIDGE\13THABUTDET03.dgn SURV. JG, CP PLOT CADD DES. AH DR. GBI TR. CKD. BS APP. RG

CITY OF WICHITA JAMES ARMOUR, P.E., CITY ENGINEER 13TH STREET BRIDGE OVER LITTLE ARKANSAS RIVER ABUTMENT DIAPHRAGM REINFORCING DETAILS		
PB PARSONS BRINCKERHOFF 122. Wichita, Kansas		
SCALE	DATE 10/9/2007	DWG NO. 35750A