

**SUPERSTRUCTURE
BILL OF REINFORCING STEEL
EPOXY COATED GRADE 60**

	Straight Bars				Bent Bars			
	Mark	Size	Number	Length	Mark	Size	Number	Length
Intermediate Diaphragms	MD2	#6	224	4'-3"	MD1	#4	616	4'-0"
	MD4	#6	196	3'-6"				
	MD5	#6	56	0'-6"				
	MD3	#5	112	4'-11"				
	MD6	#5	28	0'-10"				
Abutment Diaphragms	AD1	#7	8	51'-1"	AD9	#5	84	9'-3"
	AD7	#7	16	3'-9"	AD10	#5	22	5'-9"
					AD11	#5	106	6'-3"
	AD8	#6	36	3'-0"	AD12	#5	106	2'-10"
	AD2	#5	10	51'-1"				
	AD3	#5	32	4'-11"				
	AD4	#5	32	3'-11"				
	AD5	#5	8	0'-10"				
	AD6	#5	8	0'-4"				
	AD13	#5	2	43'-10"				
	Pier Diaphragms	PD9	#8	216	2'-6"	PD5	#5	240
					PD7	#5	48	5'-3"
PD2		#5	192	4'-11"	PD8	#5	48	2'-9"
PD3		#5	96	4'-5"				
PD4		#5	96	3'-11"				
PD6		#5	24	3'-6"				
Deck	S3	#6	90	20'-0"	T3	#5	496	4'-9"
	S5	#6	90	24'-0"	T4	#5	495	6'-7"
	S7	#6	90	28'-0"				
	S1	#5	104	13'-11"				
	S2	#5	104	37'-6"				
	S4	#5	104	37'-0"				
	S6	#5	104	45'-0"				
	T1	#5	496	44'-2"				
	T2	#5	495	44'-2"				
	SL1	#4	413	37'-5"				

**ABUTMENT WALL
BILL OF REINFORCING STEEL
LISTED FOR ONE (TWO REQUIRED)
NON-EPOXY COATED GRADE 60**

Straight Bars				Bent Bars			
Mark	Size	Number	Length	Mark	Size	Number	Length
A1	#8	52	12'-0"	A5	#5	52	5'-3"
A4	#7	4	51'-1"	A8	#5	26	⊗
A2	#6	52	11'-11"	A6	#3	150	⊗
A3	#6	24	51'-1"				

**PIER CAP #1, #2, #5 OR #6
BILL OF REINFORCING STEEL
LISTED FOR ONE (FOUR REQUIRED)
NON-EPOXY COATED GRADE 60**

Straight Bars				Bent Bars			
Mark	Size	Number	Length	Mark	Size	Number	Length
P1	#7	4	47'-8"	PDI	#6	80	3'-0"
P2	#5	5	47'-8"	P3	#4	48	3'-4"
				P4	#4	48	3'-7"

**PIER CAP #3 OR #4
BILL OF REINFORCING STEEL
LISTED FOR ONE (TWO REQUIRED)
NON-EPOXY COATED GRADE 60**

Straight Bars				Bent Bars			
Mark	Size	Number	Length	Mark	Size	Number	Length
P1	#7	5	47'-8"	PDI	#6	80	3'-0"
P2	#5	6	47'-8"	P5	#4	48	4'-8"
				P6	#4	48	5'-0"

⊗ See Bending Diagram on this sheet.

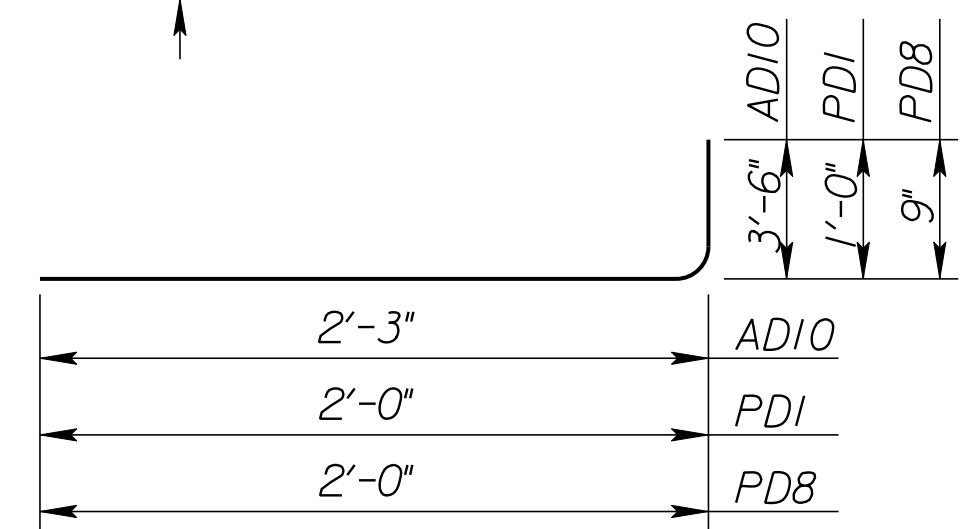
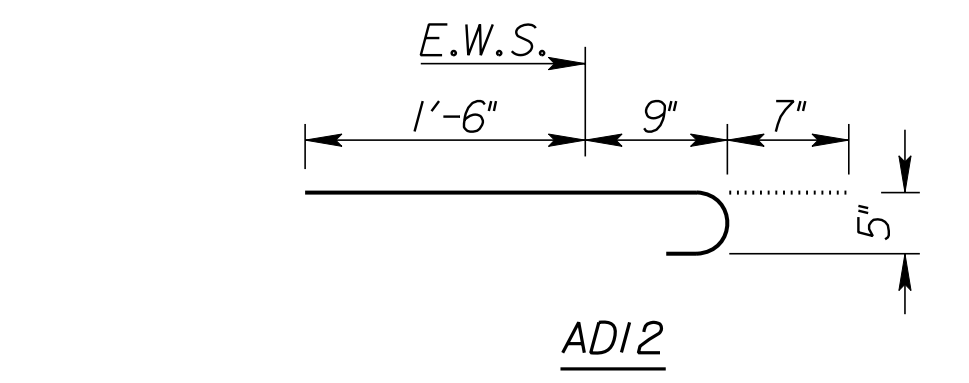
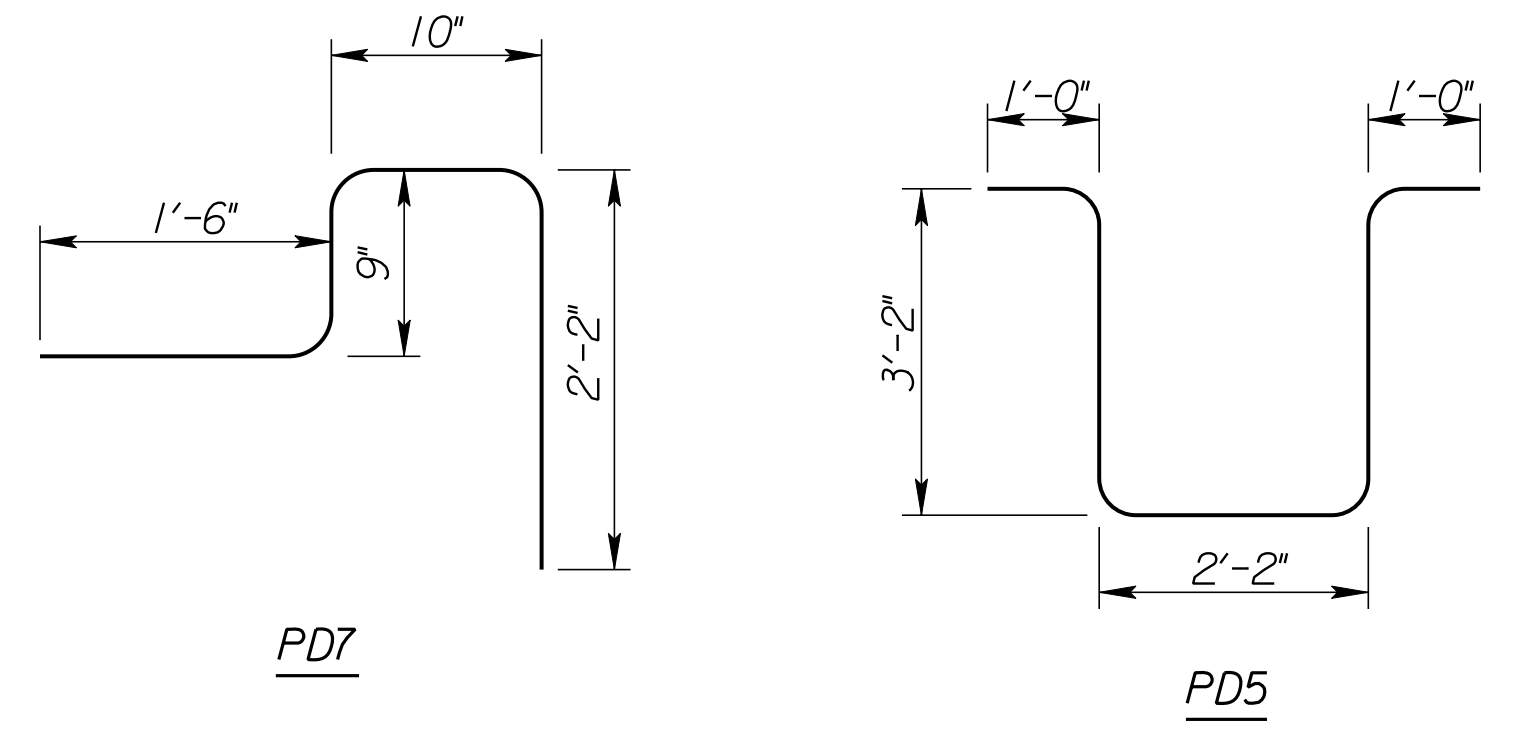
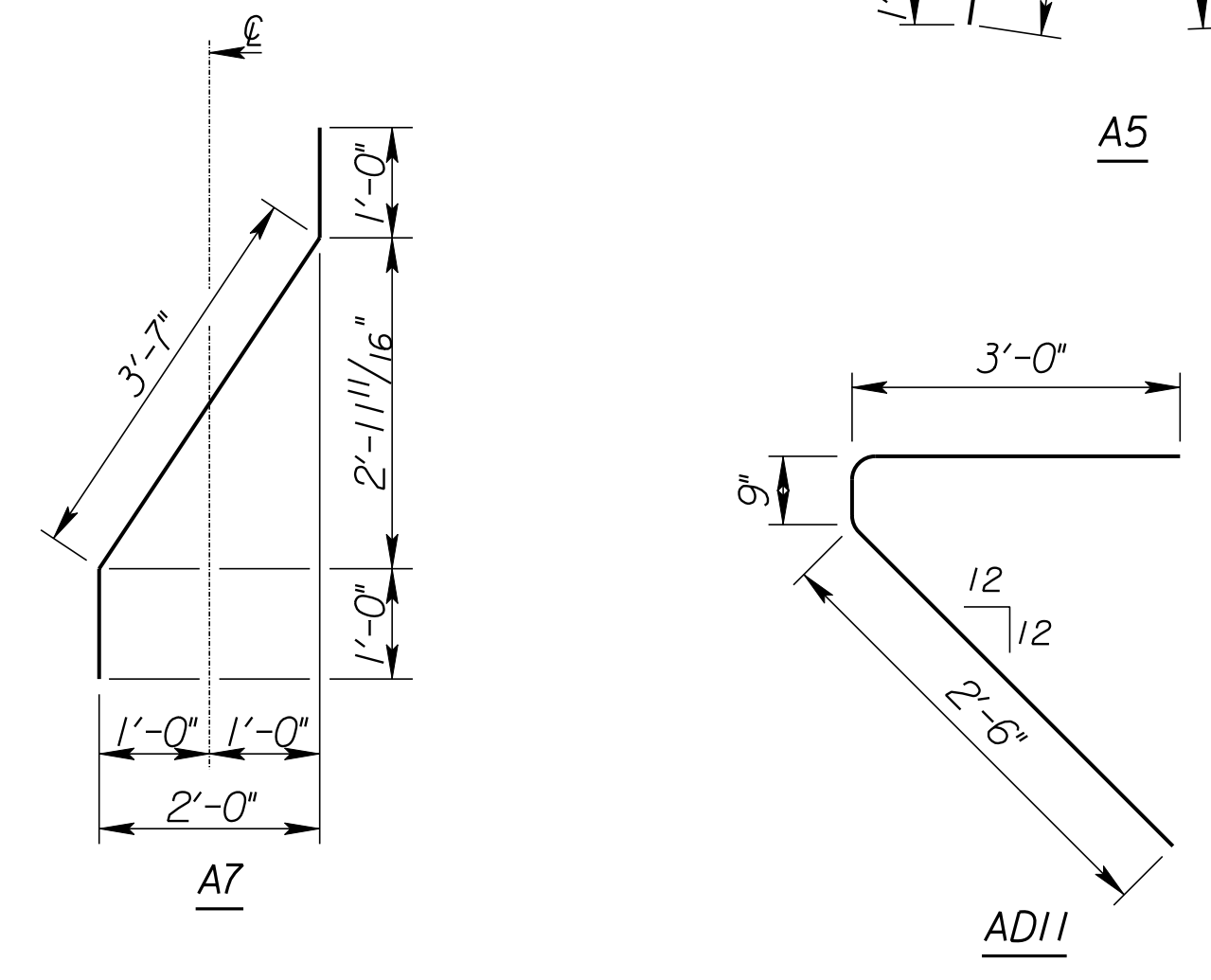
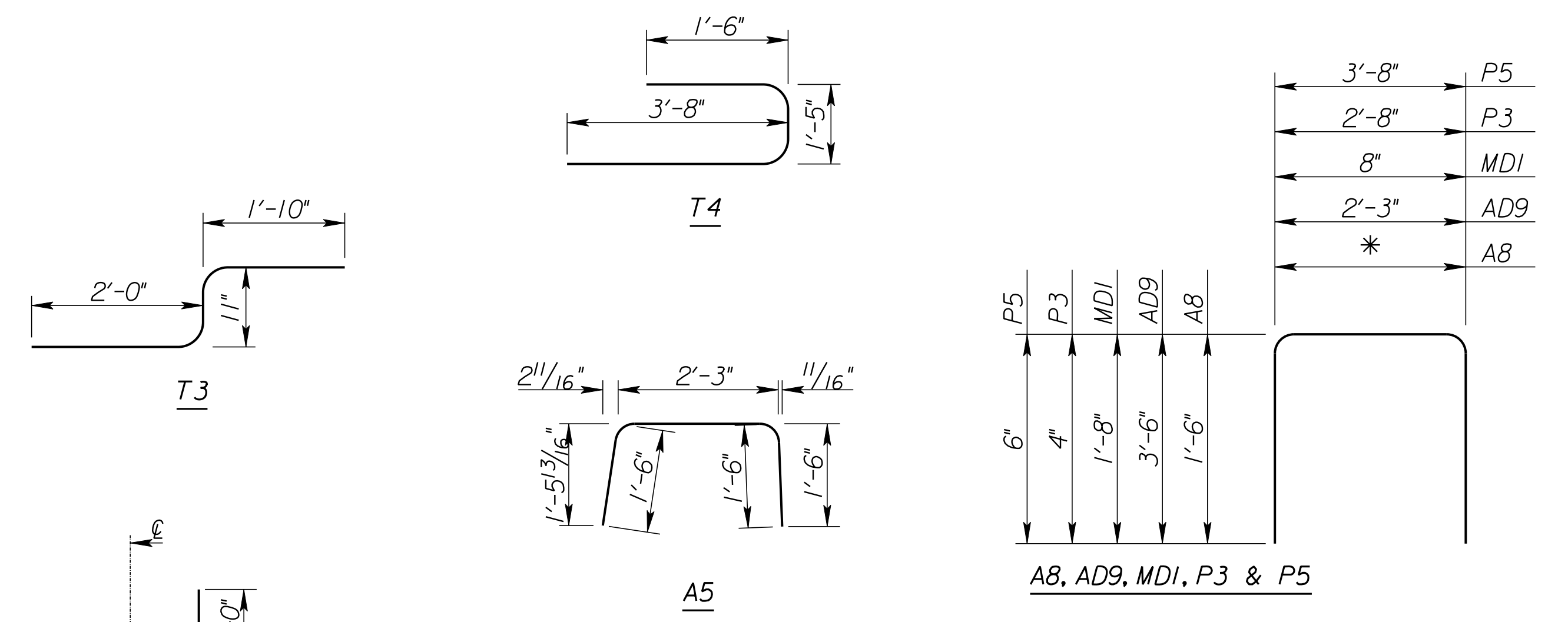

AD10, PDI & PDB

* Increase from 2'-4 1/2" to 4'-5 1/4" by 2 1/16" increments. Cut 4 each length.
** Increase from 2'-7" to 4'-5 1/2" by 4 1/2" increments. Cut 50 each length.

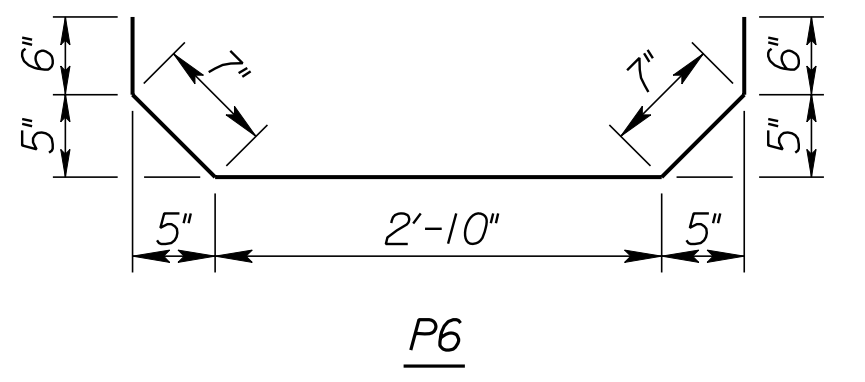
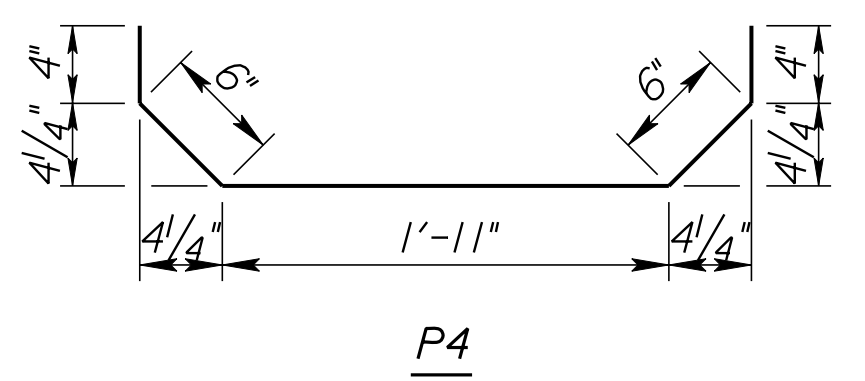
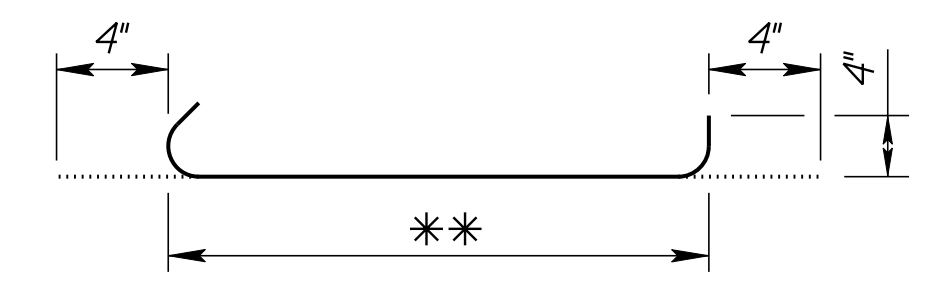

CITY OF WICHITA
JAMES ARMOUR, P.E., CITY ENGINEER
13TH STREET BRIDGE OVER
LITTLE ARKANSAS RIVER
**BAR LIST &
BENDING DIAGRAMS**

PB PARSONS
BRINCKERHOFF
122 S. Wichita, Kansas

K:\35750A\CADD\SHEETS\BRIDGE\13THBLBD.dgn SURV. JG, CP | PLOT CADD | DES. AH | DR. GBI | TR. BS | APP. RG