

STATE	PROJECT NO.	YEAR	SHEET NO.	TOTAL SHEETS
KANSAS	TE-0284-01	2007	40	47

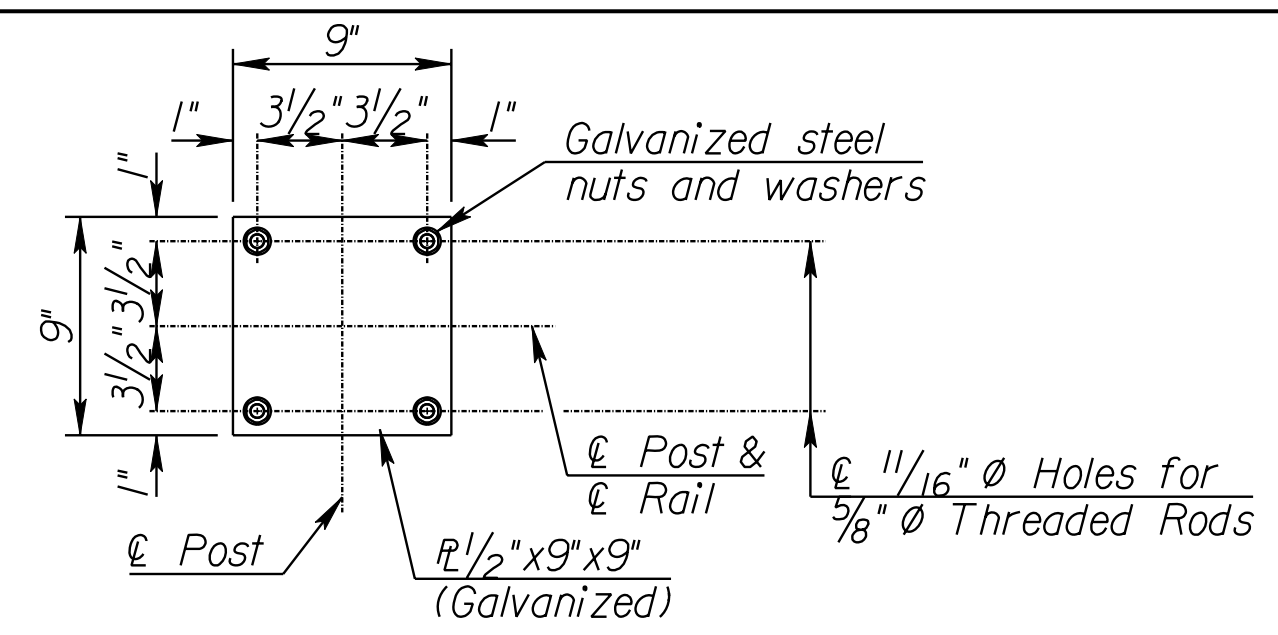

**BASE PLATE DETAIL**

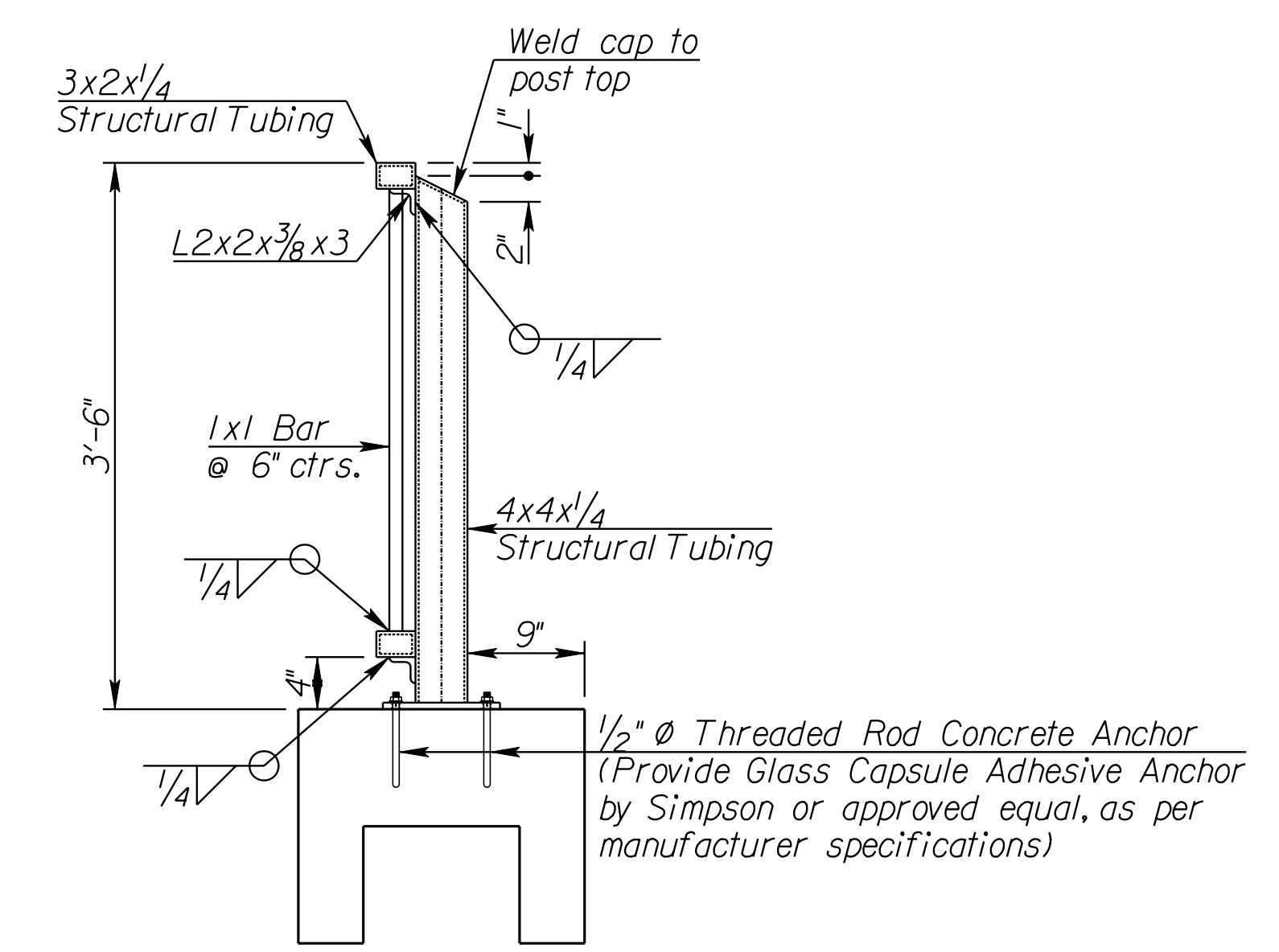

**TYPICAL SECTION**

See "Retaining Wall Details" sheet for Retaining Wall Cap details

**BRIDGE HANDRAIL NOTES:**  
 Top and bottom rails and end rail shall be 3x2x1/4 structural tubing. Vertical posts shall be 4x4x1/4 structural tubing. Tubing shall conform to ASTM A500, Grade B. Pickets and base plates shall conform to ASTM A709 (Grade 36).  
 All rails, posts, pickets and base plates shall be painted after fabrication to match the color of the steel handrail on the bridge.  
 Painting shall be done in accordance with the requirements of an Engineer approved specification. Handrails shall be protected from any damage to the painted surfaces.  
 Retaining Wall Handrail shall be constructed according to Section 709 of the Standard Specifications.  
 Rails shall be set parallel to the top of sidewalk or corral rail. All posts and pickets shall be set perpendicular to grade in the plane of the handrail. All posts shall be set vertical out of the plane of the handrail. Shims may be used between concrete and base plate of steel post. Shims shall be painted steel and 2 shims for every vertical post shall be supplied by the rail fabricator.  
 The Contractor shall submit shop drawings to the Engineer for approval prior to fabrication of the bridge handrail.  
 All material, labor, splices, shims, footings and installation shall be paid for under the bid item "Retaining Wall Handrail". The retaining wall handrail is to be bid on a linear feet basis measured from end to end of retaining wall handrail.  
 The threaded rod concrete anchors shall be galvanized and have a minimum embedment length of 6" into the concrete.

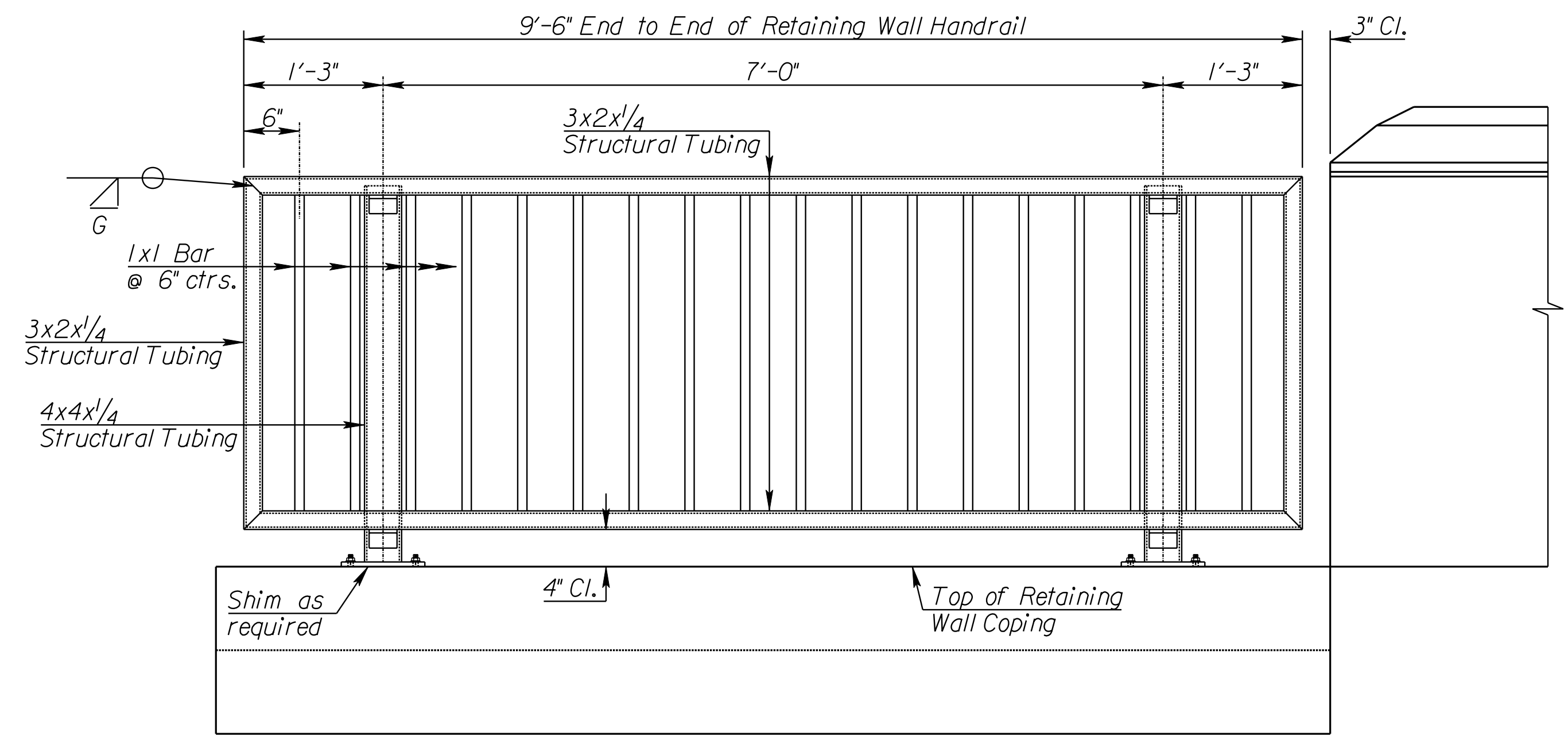

**ELEVATION OF HANDRAIL (TYP.)**  
Pedestrian Face

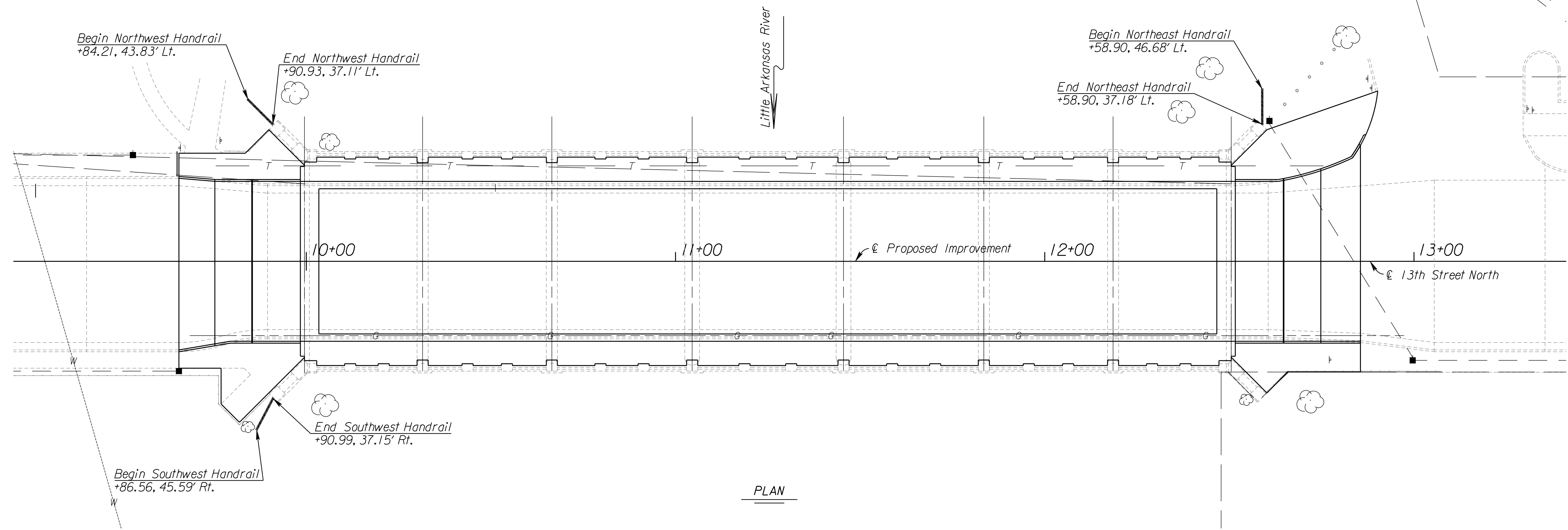

**PLAN**

See Sh. # 5 for Std. No. RD712.  
 See Sh. # 2 & # 3 for Std. No. RD713.

CITY OF WICHITA  
 JAMES ARMOUR, P.E., CITY ENGINEER  
 13TH STREET BRIDGE OVER  
 LITTLE ARKANSAS RIVER  
**HANDRAIL LAYOUT**



SCALE: \_\_\_\_\_ DATE: 10/9/2007 DWG NO.: 35750A

K:\35750A\CADD\SHEETS\GENERAL\13THFENCE.dgn  
 SURV. JG, CP | PLOT CADD | DES. AH | DR. GBI | TR. CKD. BS | APP. RG