

P.O.T. @ 1 STA. 0+39.98
 1. 1/2" REBAR CAPPED "PEC PA"
 2. "□" ON N.W. CORNER WEST HEADWALL OF RCP 55.8' NNW

P.O.T. @ 1 STA. 2+00.00 (Q EXISTING LEVEE)
 1. 1/2" REBAR CAPPED "PEC PA"
 2. "□" ON N.W. CORNER WEST HEADWALL OF RCP 107.71' S
 3. 60d NAIL IN NORTH FACE 18" COTTONWOOD 49.40' W

P.O.T. @ 1 STA. 7+53.61 (Q EXISTING LEVEE)
 1. FOUND 1/2" BAR
 2. NAIL AND SHINER IN TOP OF BRACED FENCE POST 49.14' W

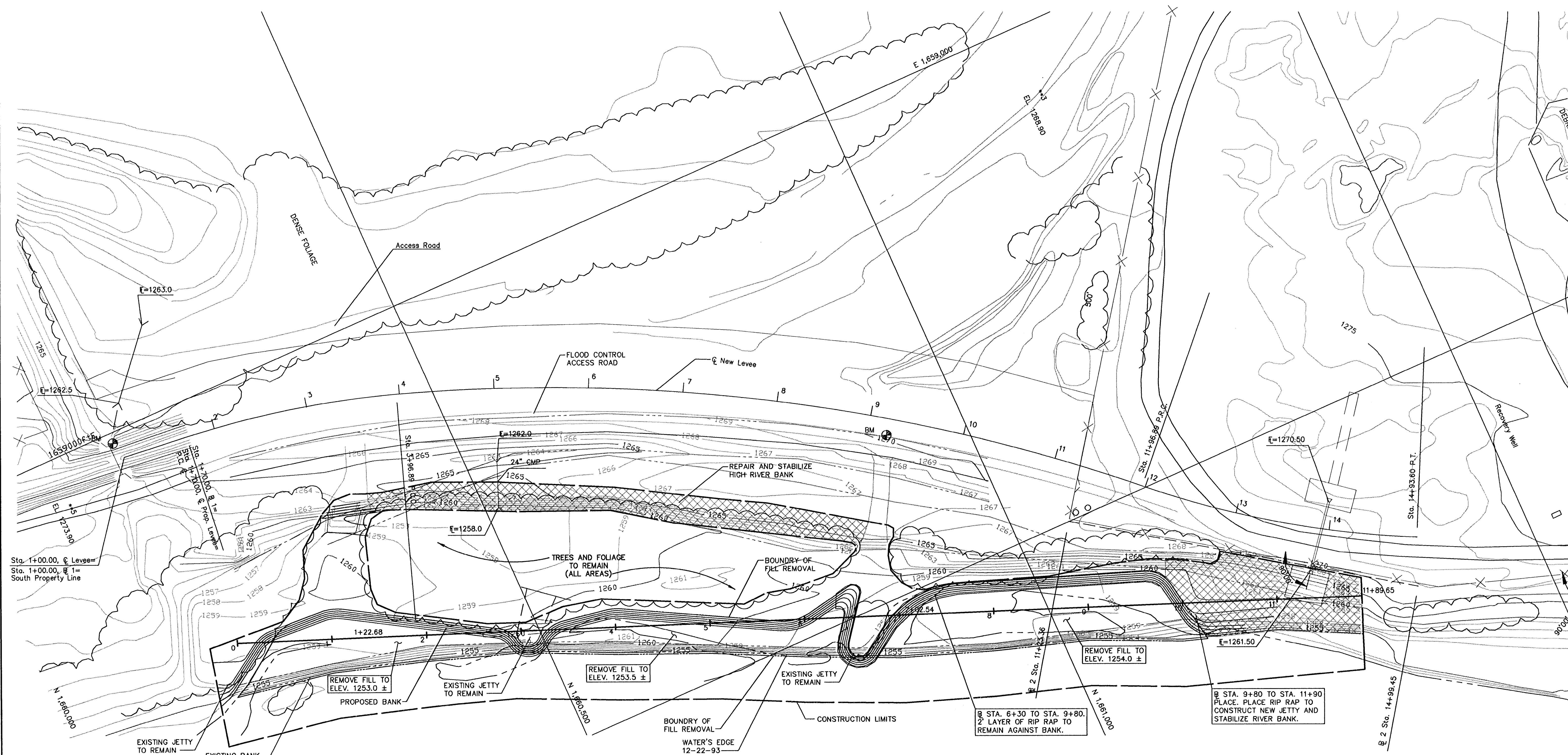

Sta. 1+00.00, C Levee=
 Sta. 1+00.00, B 1=
 South Property Line

N 1 680.000

B.M.: "□" ON N.W. CORNER WEST HEADWALL OF PIPE UNDER DIKE (STA. 0+93, 17.5' LT.) ELEV. 1268.27

B.M.: T-POST AT SOUTH SIDE GRAVEL ROAD (STA. 9+20, 17.4' RT.) ELEV. 1266.29

KEY

	PROPOSED CONTOURS
	EXISTING CONTOURS
	SITES FOR PLACEMENT OF REMOVED FILL
	LIMITS OF CONSTRUCTION
	LIMITS OF FILL REMOVAL

- NOTES:**
- FILL REMOVED FROM THE DESIGNATED AREA WILL BE PLACED IN CLEAR AREAS ABOVE THE ORDINARY HIGH WATER MARK, EXCEPT AS NEEDED TO BUILD THE NEW JETTY AT @ STATION 10+00 TO STATION 11+90.
 - THE OHWM IS AT ELEV. 1255 AT @ STA. 0+00 AND ELEV. 1257 AT STA. 11+90.

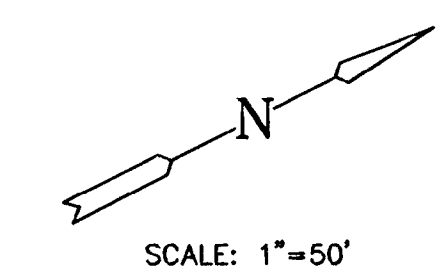

REVISED 2/23/94

	CITY OF WICHITA, KS.	Design DLM
	ARKANSAS RIVER BANK RESTORATION PLAN	Drawn by BDM
	SITE PLAN PROPOSED CONDITIONS	Checked by DLM
	MID-KANSAS ENGINEERING CONSULTANTS INC. 3500 NORTH ROCK ROAD BUILDING #800 WICHITA, KANSAS 67226 (316) 636-5566	Date 1/17/94 Job no. 94008SP
		Sheet 3 of 4