

PUB. ROAD DIV. NO.	STATE	PROJECT NO.	FISCAL YEAR	SHEET NO.	TOTAL SHEETS
5	KANSAS	35N-87I-35W-1(28)46	1970	9	229

GENERAL NOTE

ENCROACHMENTS SUCH AS FENCES, BUILDINGS, TELEPHONE, TELEGRAPH AND POWER LINES SHALL BE MOVED BY THE OWNER EXCEPT AS NOTED ON THE PLANS.

IN THE INTEREST OF PUBLIC SAFETY, ALL GAS, GASOLINE AND OIL LINES SHALL BE MOVED BEYOND THE LIMITS OF THE ROADBED BY THE OWNERS UNLESS SPECIAL PROVISION FOR THEIR RETENTION HAS BEEN MADE.

ALL WATER LINES LESS THAN THREE FEET BELOW THE SURFACE OF THE PROPOSED GRADE OR LINES NOT CONSTRUCTED OF LEAD, COPPER, CAST IRON OR WROUGHT IRON OR LINES NOT IN GOOD CONDITION SHALL BE LOWERED, REPLACED OR MOVED BEYOND THE LIMITS OF THE ROADBED BY THE OWNERS.

ALL OTHER UNDERGROUND UTILITIES SHALL BE PLACED IN GOOD CONDITION AND ADJUSTED TO FIT THE NEW CONSTRUCTION BY THE OWNERS.

ALL VALVES, METER BOXES, HYDRANTS, MANHOLES, ETC. SHALL BE MOVED OR ADJUSTED TO THE NEW CONSTRUCTION BY THE OWNERS UNLESS NOTED OTHERWISE ON THE PLANS.

AT PIT LOCATIONS ADJACENT TO THE RIGHT-OF-WAY, UTILITY POLES MAY BE SET AT THE PERMANENT LOCATIONS PRIOR TO CONSTRUCTION AS APPROVED BY THE ENGINEER, PROVIDED A MINIMUM VERTICAL CLEARANCE OF FOURTEEN FEET IS OBTAINED. THE CONTRACTOR WILL BE REQUIRED TO WORK AROUND THESE POLES TO COMPLETE THE WORK.

THE GEOLOGICAL INFORMATION SHOWN ON THESE PLANS IS FROM STUDIES MADE IN THE FIELD AND REPRESENTS THE BEST INFORMATION AVAILABLE TO THE KANSAS HIGHWAY COMMISSION.

CHANNELS SHALL BE CUT AT ALL CULVERTS (UNLESS OTHERWISE NOTED) TO FLOW LINE ELEVATION AND TO A WIDTH OF ONE FOOT OUTSIDE OF EACH OUTSIDE WALL AND WITH SLOPES 2 TO 1, PRIOR TO CONSTRUCTION OF THE CULVERT. QUANTITIES INCLUDED IN EXCAVATION TOTALS.

ALL TREES TO BE GRUBBED ARE MARKED THUS, SPARE ALL TREES NOT MARKED.

ALL ADDITIONAL RIGHT-OF-WAY SHALL BE FURNISHED BY THE STATE (UNLESS OTHERWISE NOTED).

ALL BORROW AREAS SHALL BE DRAINED AS DIRECTED BY THE ENGINEER. ALL BORROW TO BE OBTAINED FROM AREAS PROVIDED BY THE CONTRACTOR SHALL BE APPROVED BY THE ENGINEER BOTH AS TO SUITABILITY OF MATERIAL AND SITE LOCATION. LOCATIONS THAT IN THE OPINION OF THE ENGINEER WILL LEAVE AN UNSIGHTLY APPEARANCE ON THIS PROJECT WILL NOT BE APPROVED.

CONCRETE PAVEMENT REMOVAL IS INDICATED THUS:

WHERE SANITARY SEWER MANHOLES ARE TO BE ABANDONED, THE CONTRACTOR WILL REMOVE AND SALVAGE THE EXISTING RING AND COVER AND WILL FILL THE ABANDONED PIPE AND MANHOLE WITH SAND. THIS IS A SUBSIDIARY ITEM.

SITE GRADE ALL AREAS BETWEEN THE CONSTRUCTION LIMITS AND THE RIGHT-OF-WAY LINE AS DIRECTED BY THE ENGINEER.

THE CONTRACTOR WILL STOCKPILE SALVAGED MANHOLE RINGS AND COVERS ON THE PROJECT AT THE DIRECTION OF THE ENGINEER.

SCALE PLAN: Lat & Long.

PROFILE: Horiz. Same as above
Vert.

SEA LEVEL DATUM

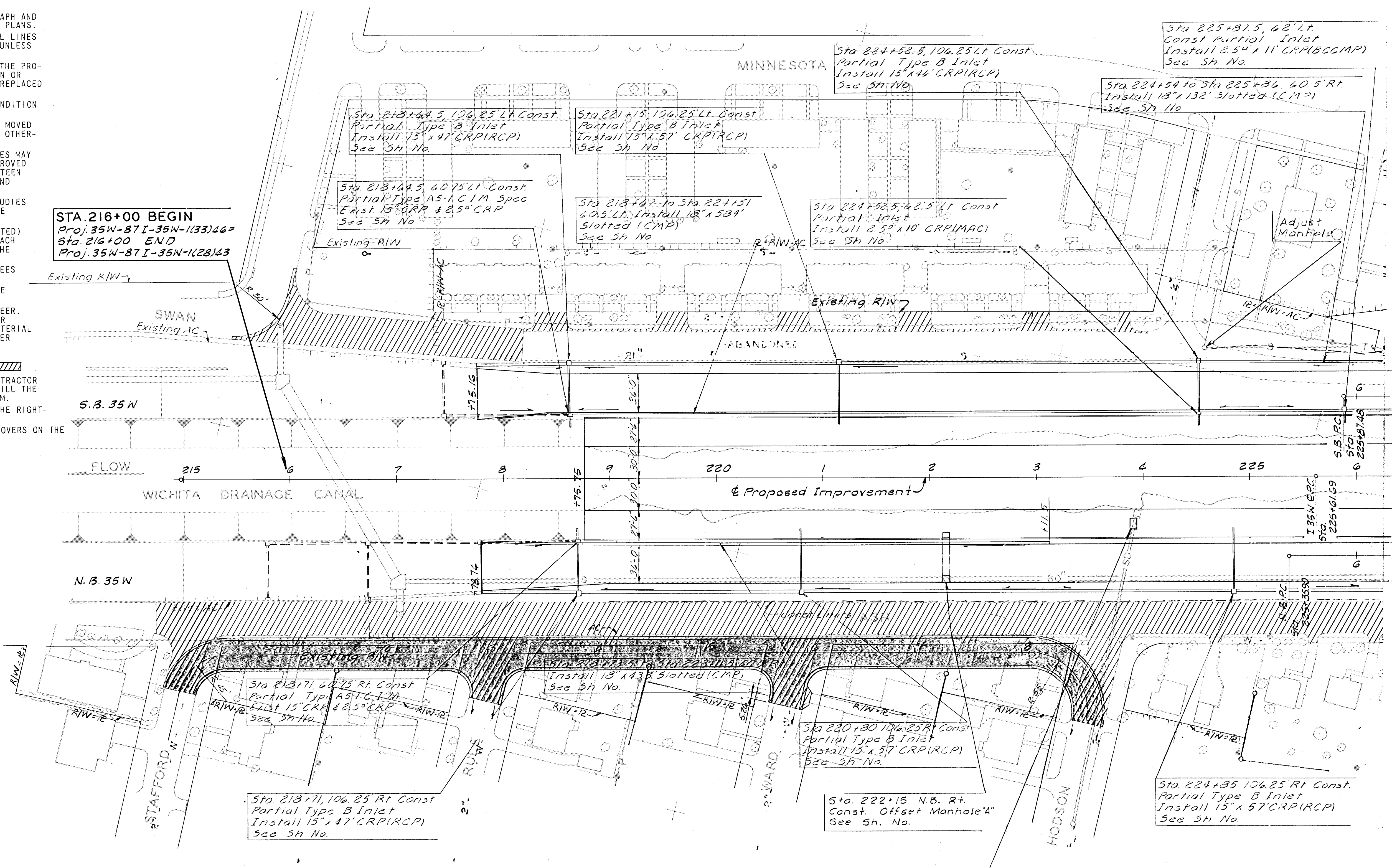

- 218+75
- 223+75
- 228+75
- 232+75
- 238+75
- 243+75
- 248+75

B.M. # 4" @ S.E. Cor. Minn. # Pawnee Elev. 1283.43

NO.	DATE	REVISIONS	BY	APPD
3				
2				
1				

STATE HIGHWAY COMMISSION OF KANSAS

I 35 W PLAN
STA 216+00 TO STA 226+00

WILSON & COMPANY
ENGINEERS & ARCHITECTS
SALINA, KANSAS

DESIGNED H.J.B. TRACED J.F.B. CHECKED G.A.S.