

PUB. ROAD DIV. NO.	STATE	PROJECT NO.	FISCAL YEAR	SHEET NO.	TOTAL SHEETS
5	KANSAS	35W-27 I-35W - (133)46	1970	35	229

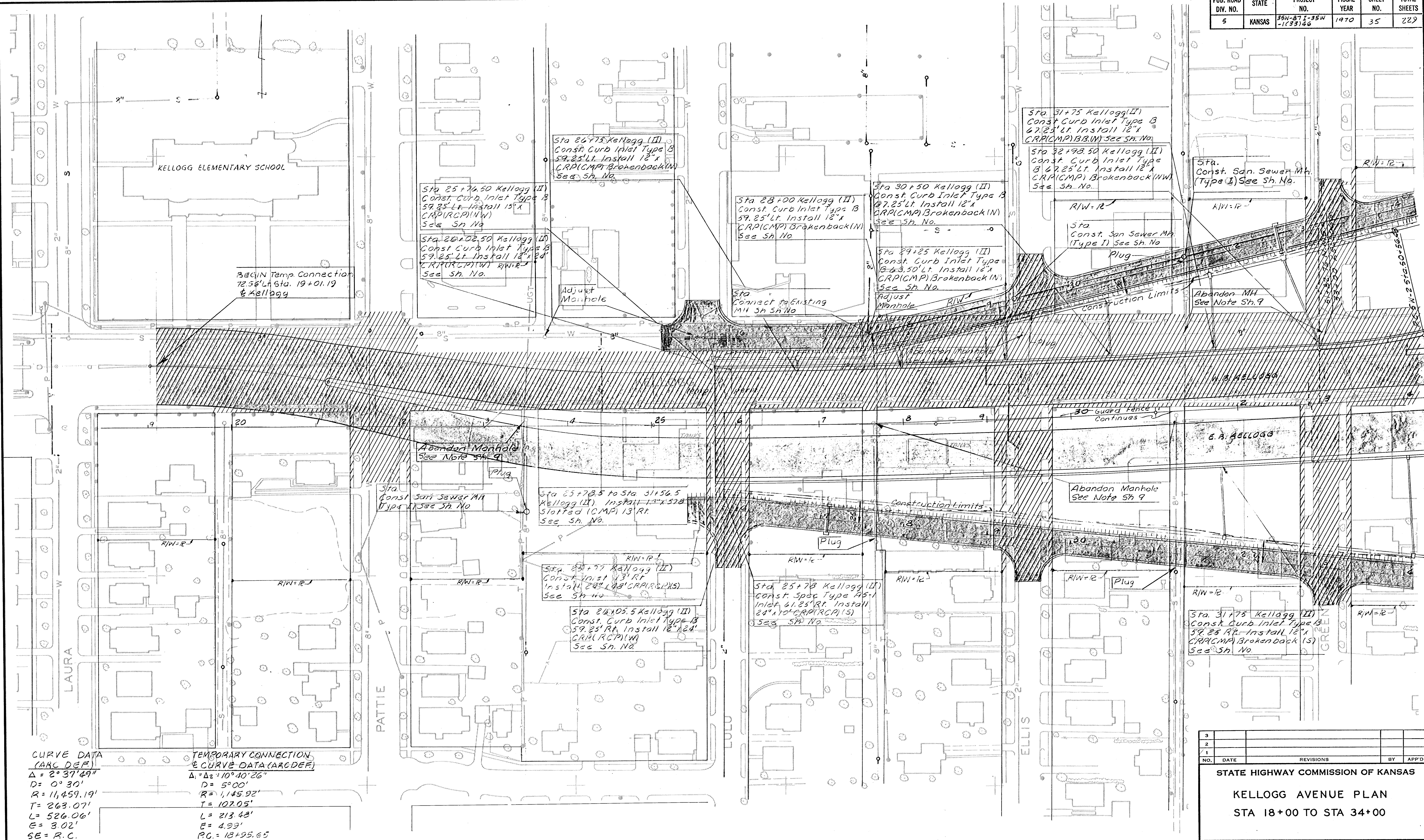

CURVE DATA (ARC DEF)	TEMPORARY CONNECTION & CURVE DATA (ARC DEF)
$\Delta = 2^{\circ}37'49''$	$\Delta_1 = \Delta_2 = 10^{\circ}40'26''$
$D = 0^{\circ}30'$	$D = 5^{\circ}00'$
$R = 11,459.19'$	$R = 1,145.92'$
$T = 263.07'$	$T = 102.05'$
$L = 526.06'$	$L = 213.43'$
$E = 3.02'$	$E = 4.93'$
$SE = R.C.$	$PC = 18+95.65$
$PC Sta = 25+75.00$	$PT = 21+09.13$
$P.I. Sta = BK 28+38.07$	$PC = 22+36.52$
$Ph. 28+37.99$	$PT = 25+00.00$
$PT Sta = 31+01.06$	

3 M[#] 60. Rim M.H. in Sidewalk @ S.W. Cor. Kellogg & Laura Elev. 1296.89

(I) (II) (III) Denotes Construction Phases.

3			
2			
1			
NO.	DATE	REVISIONS	BY APP'D
STATE HIGHWAY COMMISSION OF KANSAS			
KELLOGG AVENUE PLAN			
STA 18+00 TO STA 34+00			
WILSON & COMPANY ENGINEERS & ARCHITECTS SALINA, KANSAS			
DESIGNED G.A.S.	TRACED J.F.B.	CHECKED H.J.B.	