

CURVE DATA (ARC DEF.)
 $\Delta = 3^{\circ}08'12.3''$
 $D = 1^{\circ}00'$
 $R = 5729.58'$
 $T = 184.62'$
 $L = 369.11'$
 $E = 2.91'$
 $P.C. Sta. = 43+88.36$
 $P.I. Sta. = 44+57.98$
 $Ah. = 46+72.85$
 $P.T. Sta. = 47+57.47$

CURVE DATA (ARC DEF.)
 $\Delta = 4^{\circ}13'12''$
 $D = 1^{\circ}00'$
 $R = 5729.58'$
 $T = 211.10'$
 $L = 422.00'$
 $E = 3.89'$
 $P.C. Sta. = 53+54.40$
 $P.I. Sta. = 54+65.60$
 $Ah. = 55+65.30$
 $P.T. Sta. = 57+76.40$

PUB. ROAD DIV. NO.	STATE	PROJECT NO.	FISCAL YEAR	SHEET NO.	TOTAL SHEETS
5	KANSAS	35N-87E-35N-1(33)46	1970	44	229

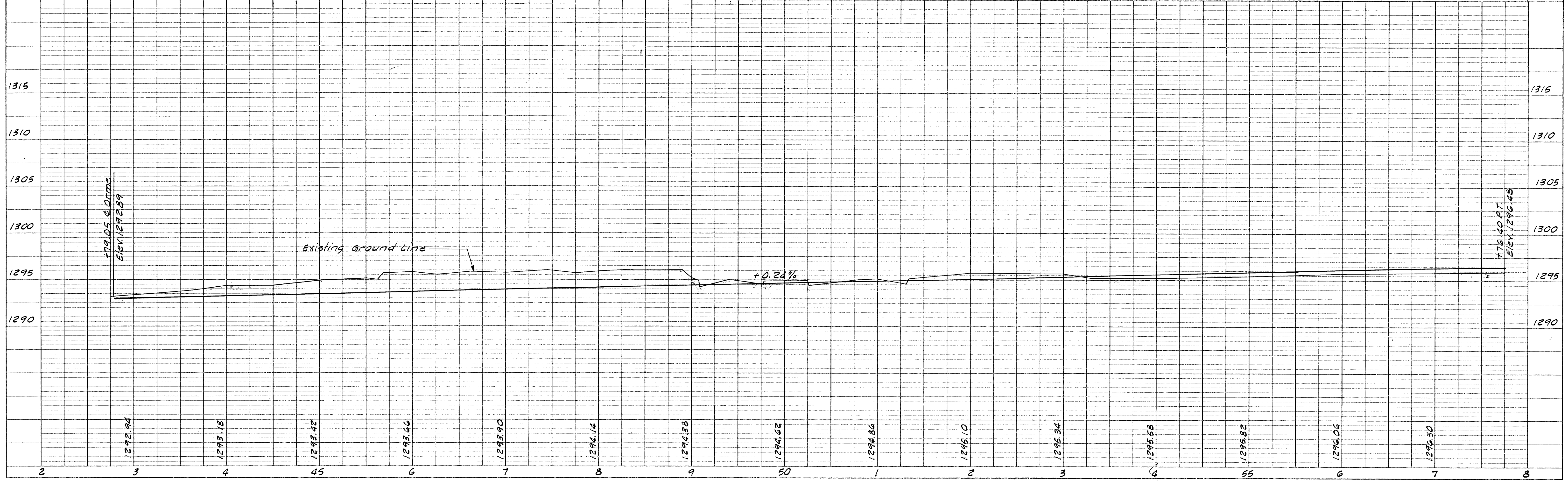
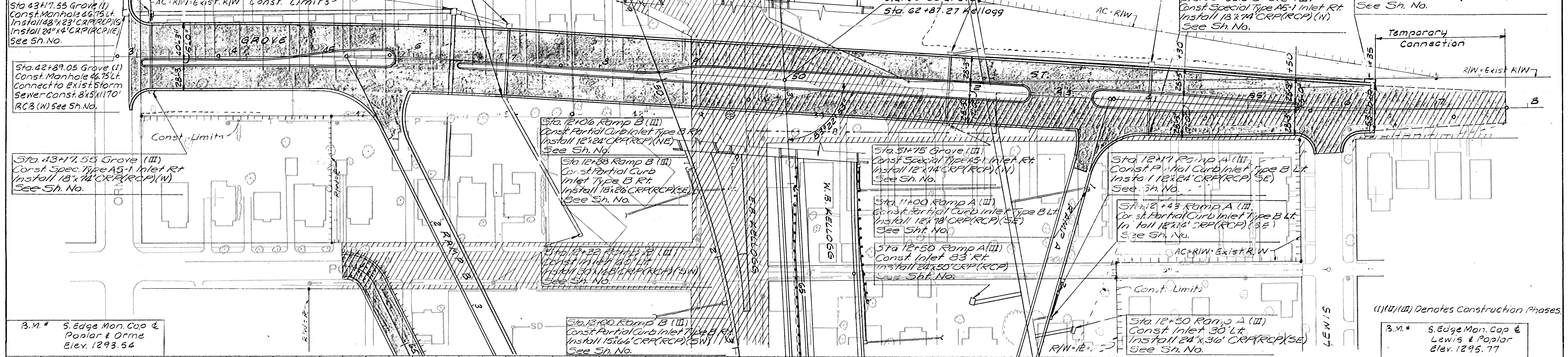

PLAN	DATE
BY	
DATE	
NO.	

PROFILE	DATE
BY	
DATE	
NO.	