

PUB. ROAD DIV. NO.	STATE	PROJECT NO.	FISCAL YEAR	SHEET NO.	TOTAL SHEETS
5	KANSAS	35 W-871-35W -F(33) 48	1970	71	229

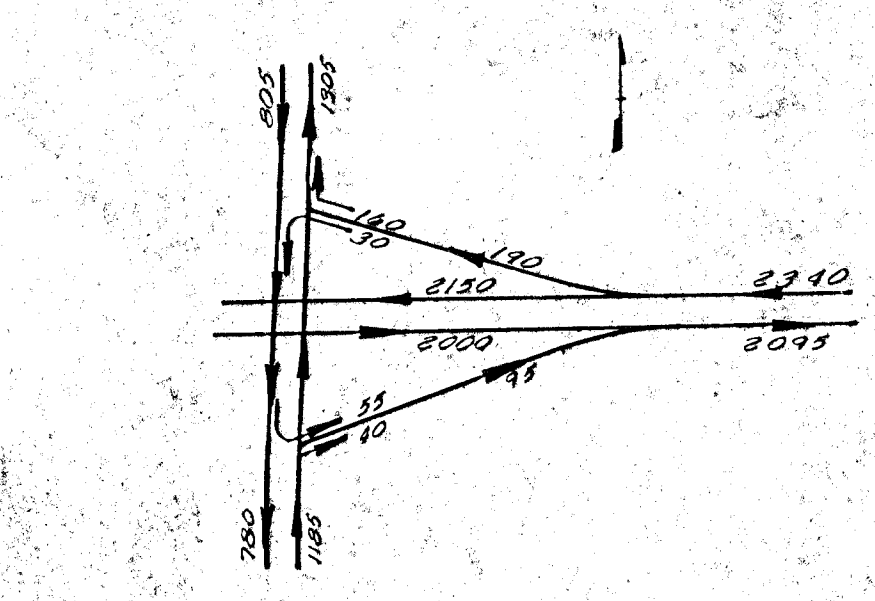

TRAFFIC FLOW DIAGRAM-1990 A.M. PEAK HOUR

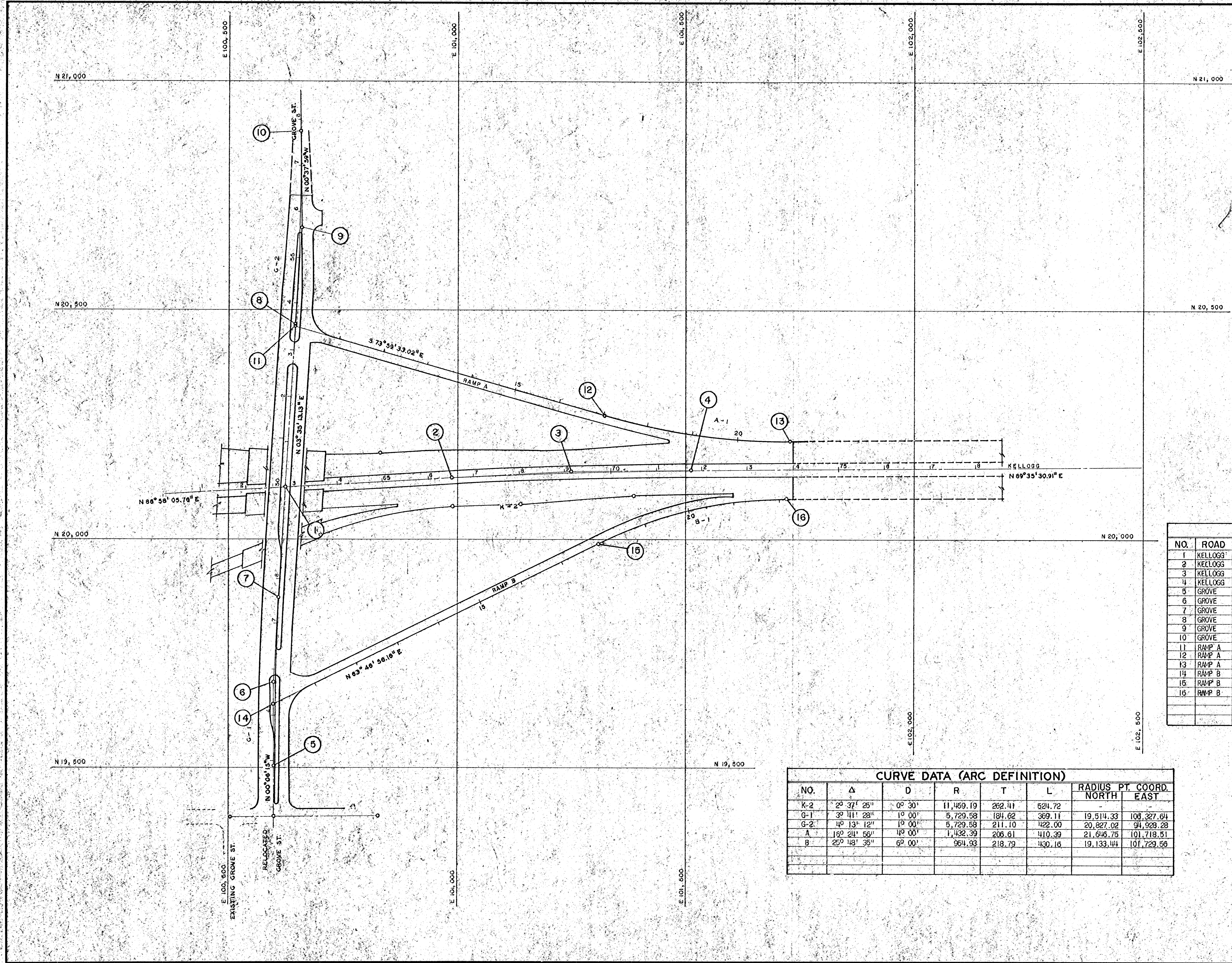
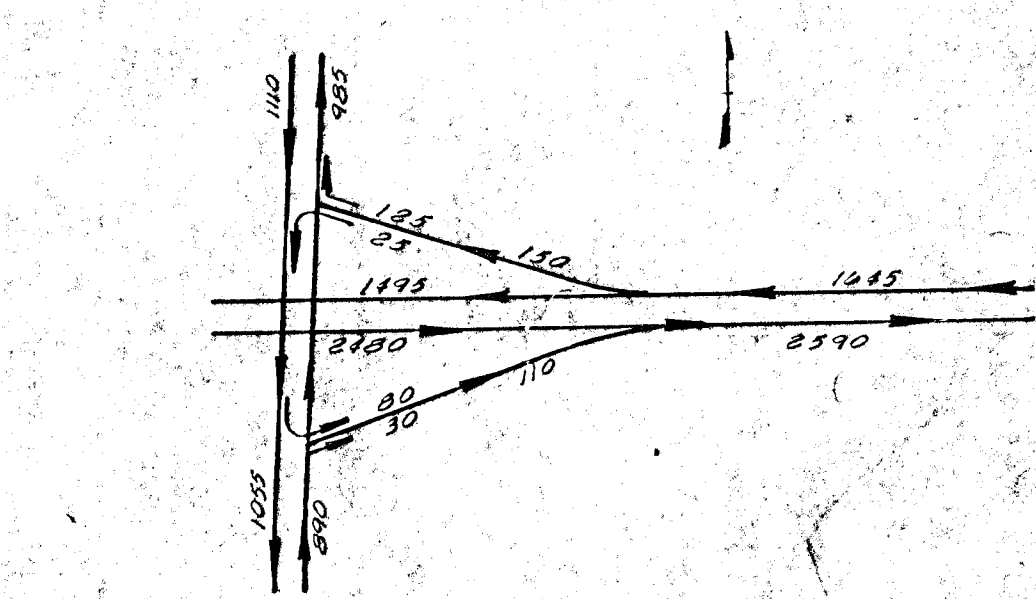

TRAFFIC FLOW DIAGRAM-1990 P.M. PEAK HOUR

NO.	ROAD	STA.	DESCRIPTION	COORDINATES	
				NORTH	EAST
1	KELLOGG	62+87.27	INTERSECTION & KELLOGG & STA. 50+00 GROVE	20,114.85	100,621.48
2	KELLOGG	66+51.28	P.C. K-2	20,131.10	100,587.96
3	KELLOGG	P.I.	STA. 60+13.69 (BK.)=STA. 60+13.59 (AH.)	20,117.98	101,250.00
4	KELLOGG	71+76.00	P.T. K-2	20,119.85	101,512.41
5	GROVE	143+88.36	P.C. G-1	19,503.92	100,536.07
6	GROVE	P.I.	STA. 145+72.98 (BK.)=STA. 145+72.85 (AH.)	19,688.64	100,597.74
7	GROVE	147+57.47	P.T. G-1	19,872.80	100,609.29
8	GROVE	53+54.40	P.C. G-2	20,168.56	100,646.63
9	GROVE	P.I.	STA. 55+66.50 (BK.)=STA. 55+66.30 (AH.)	20,679.24	100,669.81
10	GROVE	57+76.40	P.T. G-2	20,890.32	100,697.51
11	RAMP A	10+00	STA. 53+50.00 & GROVE	20,161.16	100,616.36
12	RAMP A	17+04.47	P.C.	20,269.90	101,323.51
13	RAMP A	21+14.86	P.T.=63' LT. STA. 73+92.77 KELLOGG	20,214.39	101,723.72
14	RAMP B	10+00	STA. 145+25 GROVE TANG. (AH.)	19,610.56	100,597.82
15	RAMP B	17+91.27	P.C.	19,990.13	101,307.69
16	RAMP B	22+21.43	P.T.=63' RT. STA. 73+86.91 KELLOGG	20,088.36	101,722.76

NO.	Δ	D	R	T	L	RADIUS PT. COORD.	
						NORTH	EAST
K-2	2° 37' 25"	0° 30'	11,459.19	282.41	524.72	19,514.33	100,327.64
G-1	3° 11' 28"	1° 00'	5,729.58	184.62	369.11	20,827.02	94,923.28
G-2	4° 13' 12"	1° 00'	5,729.58	211.10	422.00	21,616.75	101,718.51
A	18° 24' 59"	18° 00'	1,432.39	206.61	410.39	19,133.44	101,729.56
B	25° 48' 35"	6° 00'	964.93	218.79	430.16		

SCALE: 1" = 100'

NO.	DATE	REVISIONS	BY	APP'D

STATE HIGHWAY COMMISSION OF KANSAS
GROVE STREET INTERCHANGE
 GEOMETRIC COORDINATE LAYOUT

WILSON & COMPANY
 ENGINEERS & ARCHITECTS
 SALINA, KANSAS
 DESIGNED: C.A.R. TRACED: J.F.B. CHECKED: H.J.B.