

PUB. ROAD DIV. NO.	STATE	PROJECT NO.	FISCAL YEAR	SHEET NO.	TOTAL SHEETS
5	KANSAS	*		86	229

\* 35W-871-35W-1(33)46

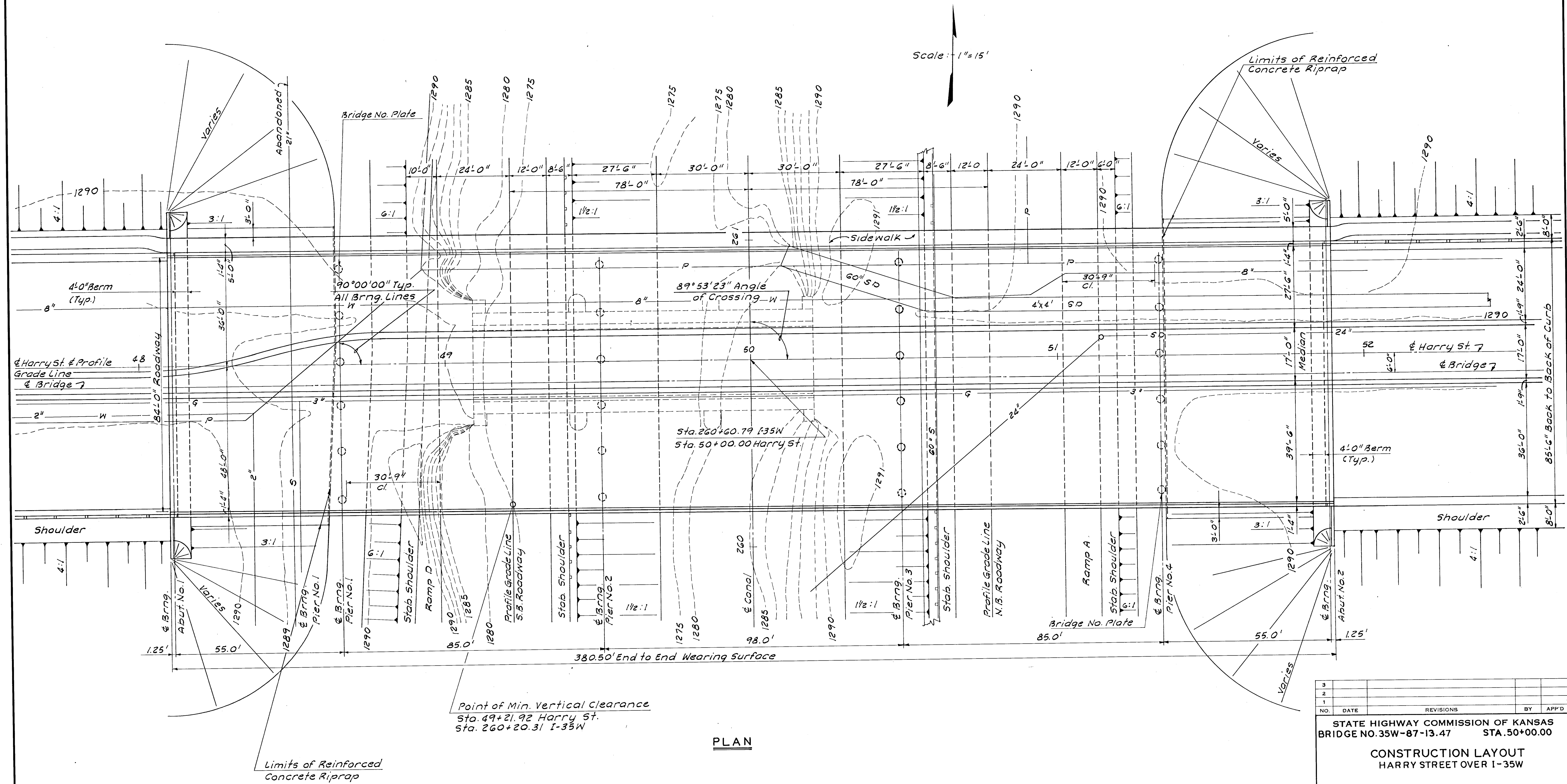

PLAN

Point of Min. Vertical Clearance  
Sta. 49+21.92 Harry St.  
Sta. 260+20.31 I-35W

Notes: Design Loading HS 20-44  
AASHTO Specs. 1969 Edition.

3				
2				
1				
NO.	DATE	REVISIONS	BY	APP'D
STATE HIGHWAY COMMISSION OF KANSAS BRIDGE NO. 35W-87-13.47 STA. 50+00.00				
CONSTRUCTION LAYOUT HARRY STREET OVER I-35W				
PROJ. NO. 35W-871-35W-1(33)46 SEDGWICK CO.				
WILSON & COMPANY ENGINEERS & ARCHITECTS SALINA, KANSAS				
DESIGNED	J. L. M.	TRACED	J. F. B.	CHECKED

REVISED

DEC 27 1971

64-100B