

PUB. ROAD DIV. NO.	STATE	PROJECT NO.	FISCAL YEAR	SHEET NO.	TOTAL SHEETS
5	KANSAS	*		91	229

\*35W-87I-35W-1(33)46

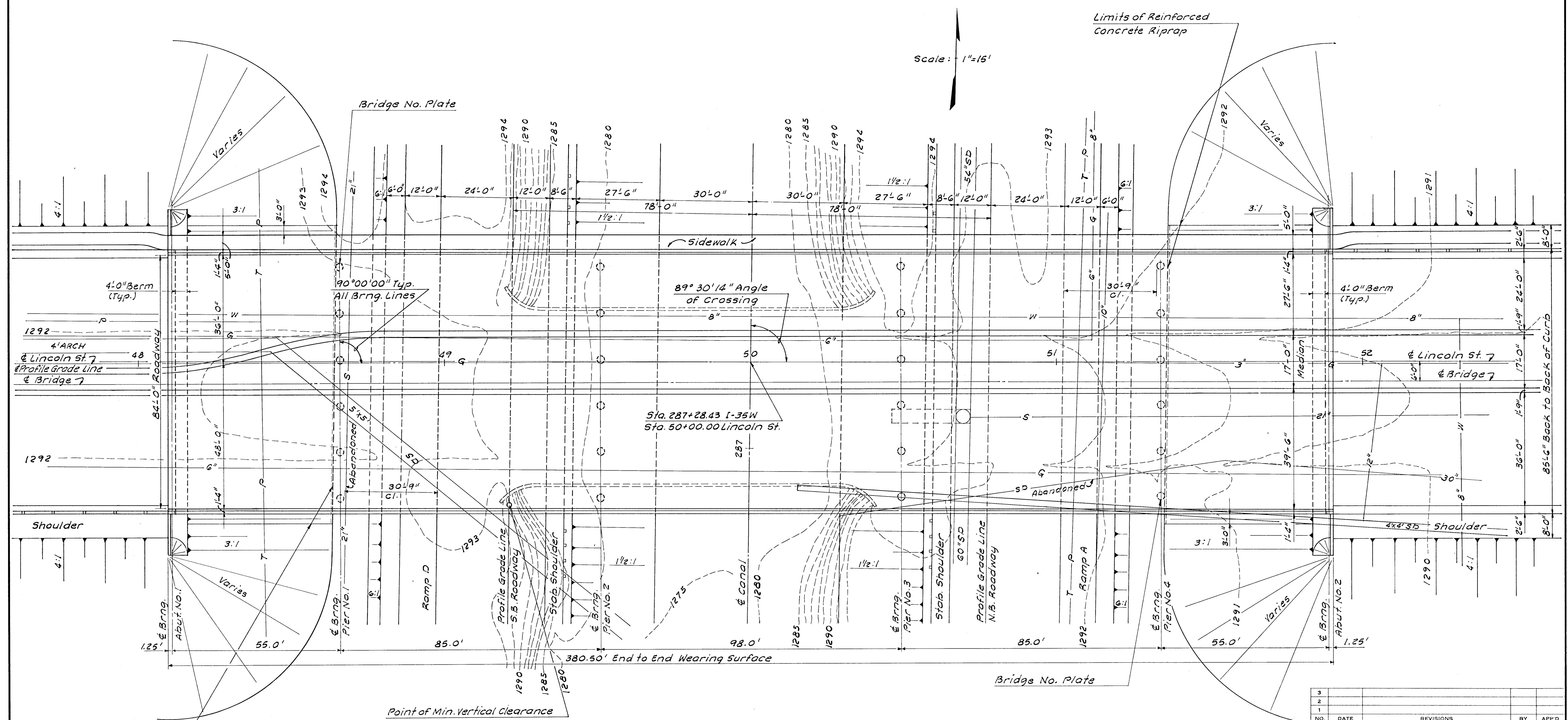

PLAN

3				
2				
1				
NO.	DATE	REVISIONS	BY	APP'D
STATE HIGHWAY COMMISSION OF KANSAS BRIDGE NO. 35W-87-13.97 STA. 50+00.00 <b>CONSTRUCTION LAYOUT</b> <b>LINCOLN STREET OVER I-35W</b> PROJ. NO. 35W-87I-35W-1(33)46 SEDGWICK CO. WILSON & COMPANY ENGINEERS & ARCHITECTS SALINA, KANSAS DESIGNED J.L.M. TRACED J.F.B. CHECKED				

Notes: Design Loading HS 20-44  
AASHTO Specs. 1969 Edition.

DEC 27 1971