

B.M. "a" S.W. Wingwall  
Kellogg Canal Bridge  
Elev. 1297.54

B.M. S Edge City Mon.  
S Side Kellogg @ Eria South  
Elev. 1296.35

PUB. ROAD DIV. NO.	STATE	PROJECT NO.	FISCAL YEAR	SHEET NO.	TOTAL SHEETS
5	KANSAS	*	1970	94	222

\*35W-87I35W-1(33)46

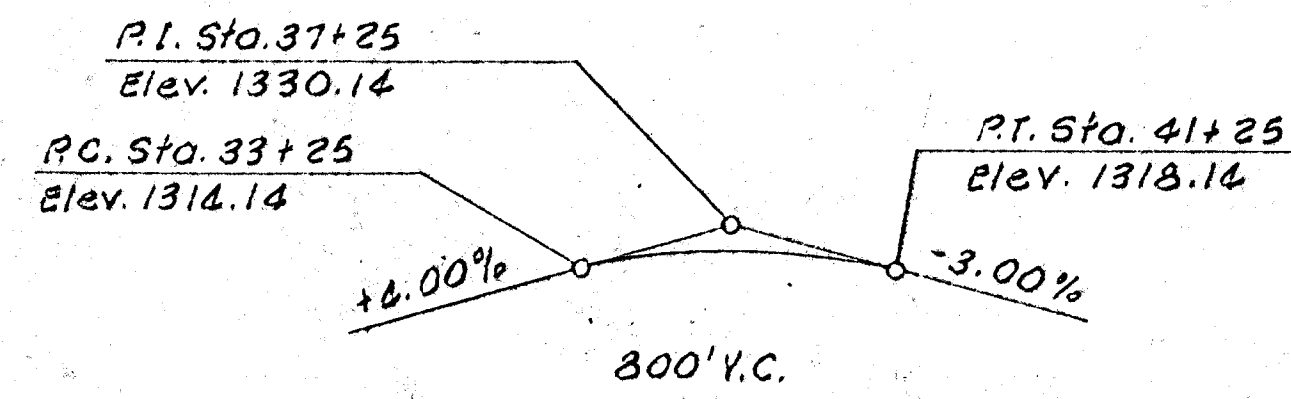
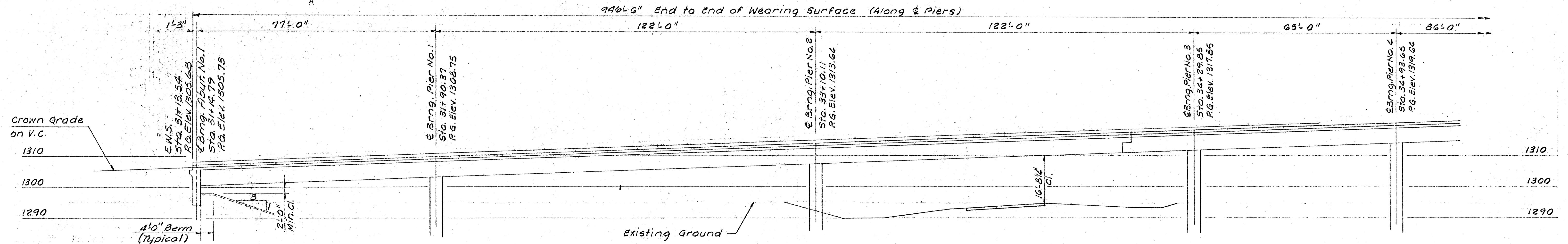

**ELEVATION**  
Shown Parallel to E Piers Ramp NE  
77'-122'-122'-65'-86'-113'-3898'-65'  
Continuous Reinforced Concrete Box  
Girder Spans, 30'-0" Roadway, Pile Bent  
Abutments, Pedestal Type Piers

**RAMP NE CURVE DATA (ARC)**  
 $\Delta = 134^{\circ}48'40''$   
 $Pc = 12^{\circ}$   
 $Lc = 1123.43$   
 $Rc = 477.46$

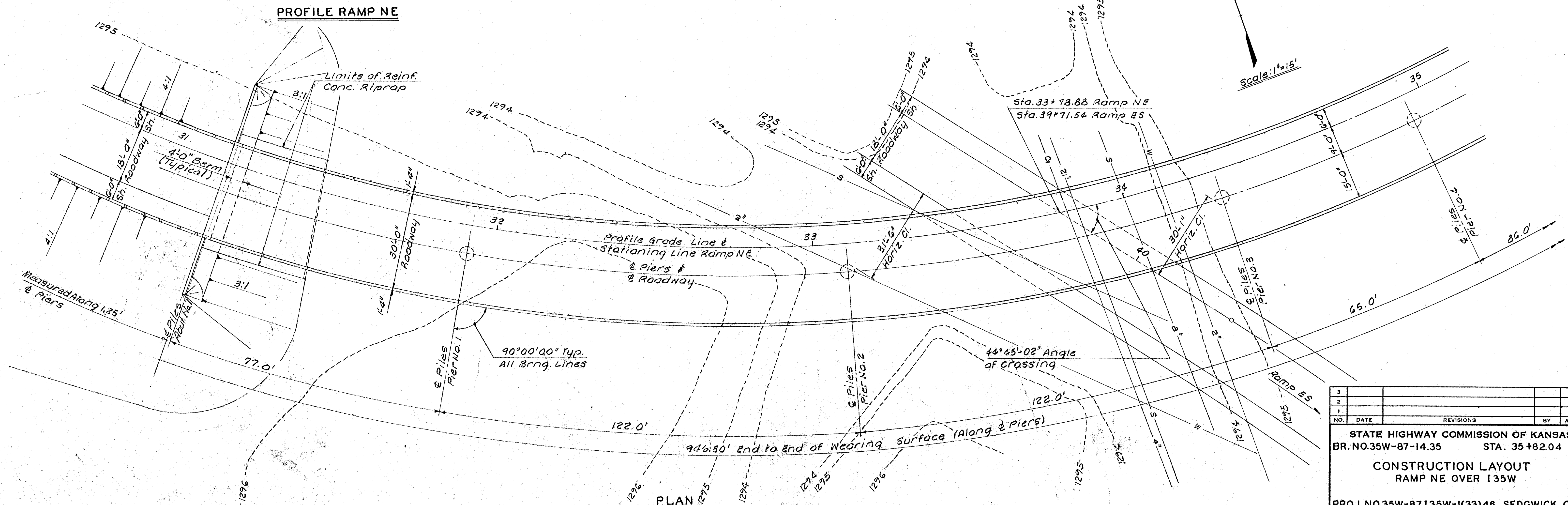
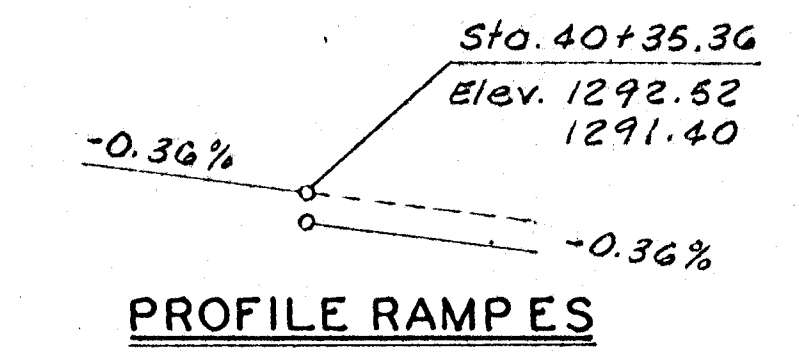

Scale: 1"=15'

NO.	DATE	REVISIONS	BY	APP'D
3				
2				
1				

STATE HIGHWAY COMMISSION OF KANSAS  
BR. NO. 35W-87-14.35 STA. 35+82.04  
**CONSTRUCTION LAYOUT**  
RAMP NE OVER I35W  
PROJ. NO. 35W-87I35W-1(33)46 SEDGWICK CO.  
WILSON & COMPANY  
ENGINEERS & ARCHITECTS  
SALINA, KANSAS  
DESIGNED L.C.C. TRACED J.F.B. CHECKED

Note: Design Loading HS-20-44  
AASHTO Specs. 1969 Edition  
and P.R.M. 20-4.