

B.M. "a" Cut E. End NE Ref.
at Morris Minnesota
Elev. 1292.51

B.M. "a" Cut N.W. Corner S.W. Wingwall
Kellogg Canal Bridge
Elev. 1297.54

PUB. ROAD DIV. NO.	STATE	PROJECT NO.	FISCAL YEAR	SHEET NO.	TOTAL SHEETS
5	KANSAS	*		98	229

* 35W-87135W-1(33)46

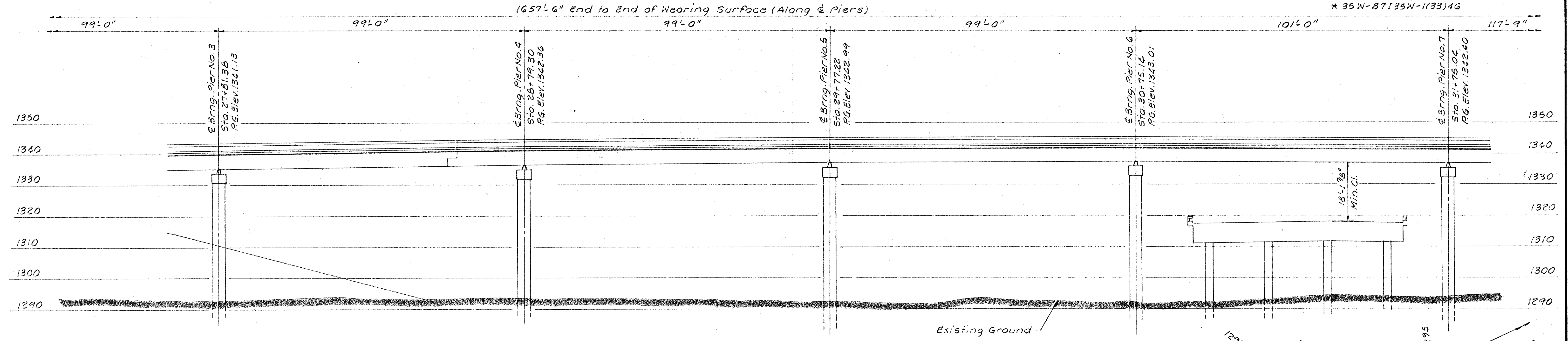

ELEVATION

Shown parallel to & Piers Ramp SW
50'-80'-4 @ 99'-101'-2 @ 117.75'
114'-5 @ 123.50-90' continuous
Plate Girder Spans, 30.0' Roadway,
Pile Bent Abutments, Pedestal Type
Piers.

Scale: 1"=15'

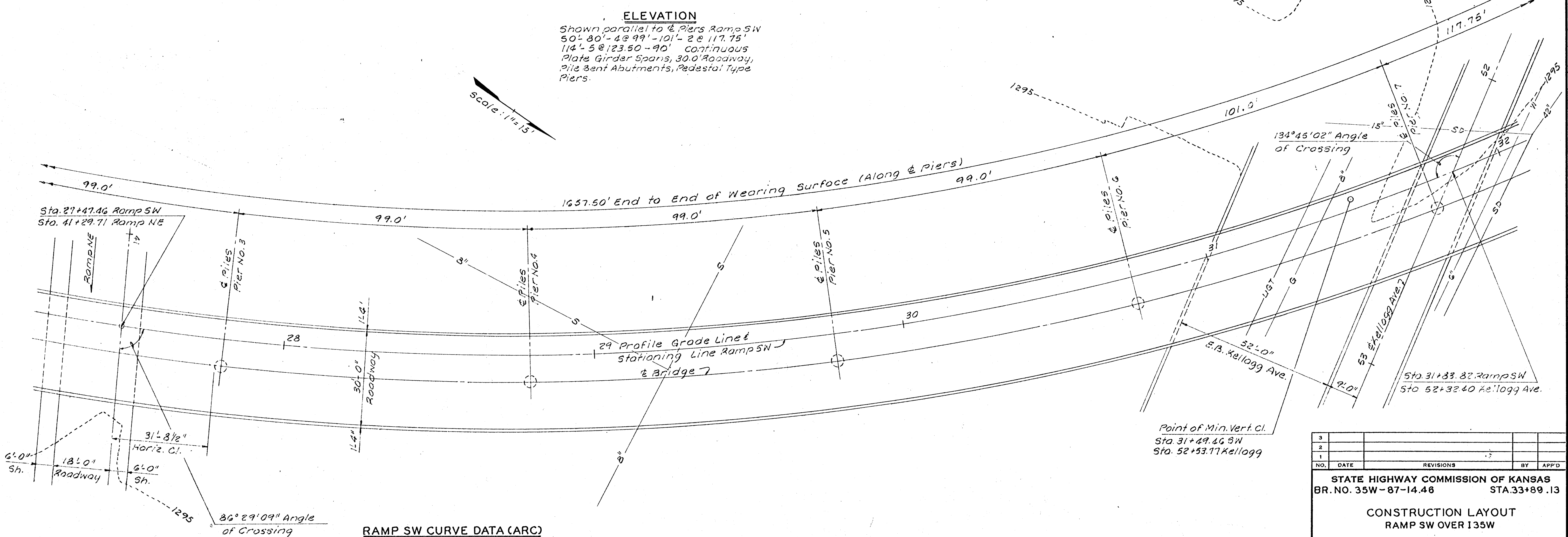

RAMP SW CURVE DATA (ARC)

$\Delta = 124^\circ 17' 47''$
 $Dc = 7^\circ 0' 0''$
 $Rc = 818.51'$
 $Lc = 1775.66'$

PLAN

Note: Design Loading HS 20-44
AASHTO Spec's 1969 Edition
& R.P.M. 20-4.

NO.	DATE	REVISIONS	BY	APP'D
3				
2				
1				

STATE HIGHWAY COMMISSION OF KANSAS
BR. NO. 35W-87-14.46 STA. 33+89.13

CONSTRUCTION LAYOUT
RAMP SW OVER 135W

PROJ. NO. 35W-87135W-1(33)46 SEDGWICK CO.

WILSON & COMPANY
ENGINEERS & ARCHITECTS
SALINA, KANSAS

DESIGNED L.C.C. TRACED J.A.B. CHECKED J.L.M.