

PUB. ROAD DIV. NO.	STATE	PROJECT NO.	FISCAL YEAR	SHEET NO.	TOTAL SHEETS
5	KANSAS	*		99	229

* 35W-87135W-1(33)46
 B.M. "a" Cut N.W. Corner S.W. Wingwall Kellogg Canal Bridge Elev. 1297.54

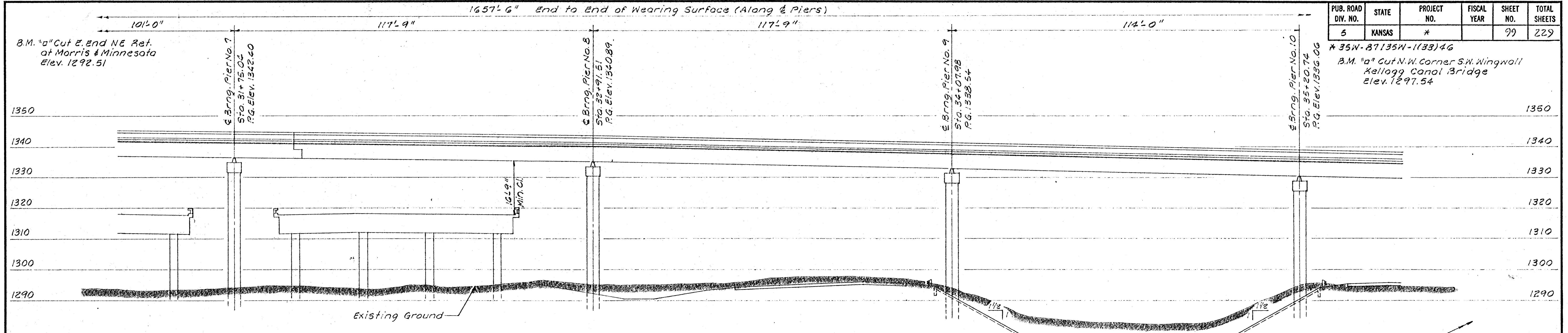

ELEVATION
 Shown parallel to & Piers Ramp SW
 50'-80'-4899'-101'-2@117.75'-
 114'-5@123.50'-90' continuous
 Plate Girder Spans, 30.0' Roadway,
 Pile Bent Abutments, Pedestal Type
 Piers.

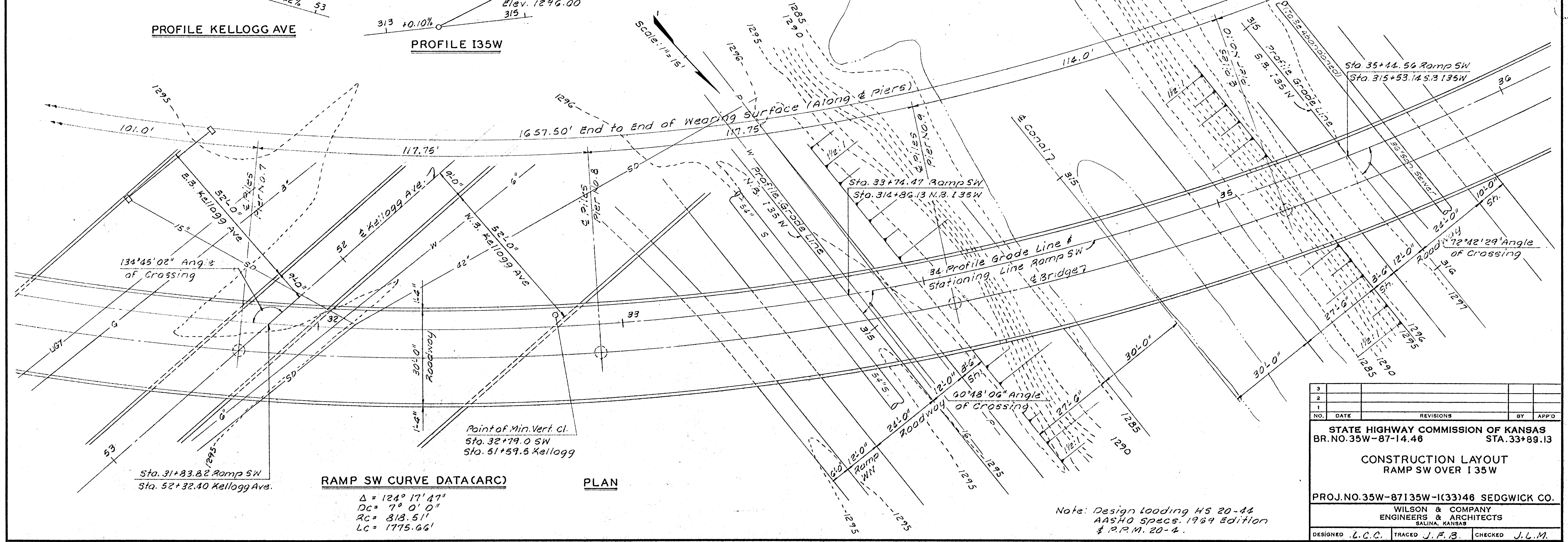
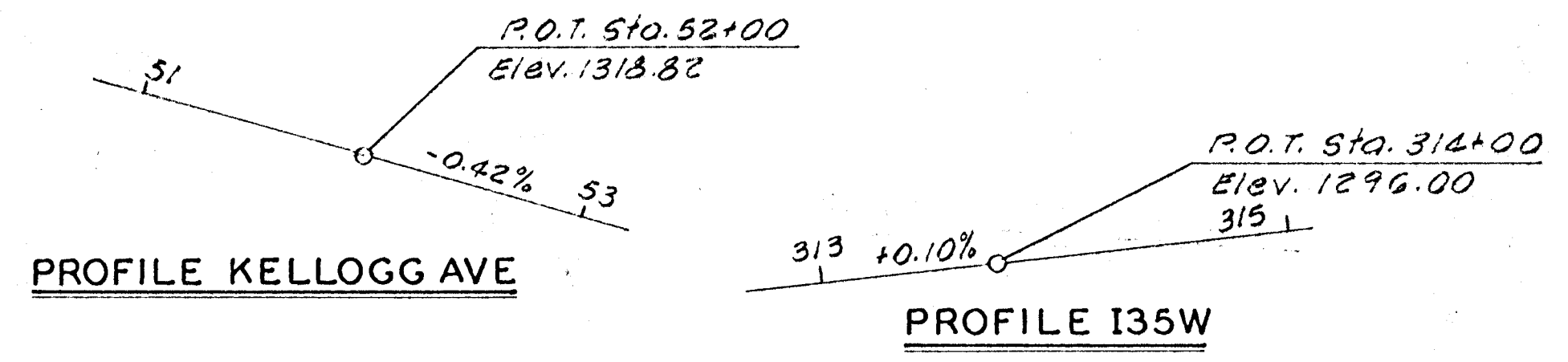

RAMP SW CURVE DATA (ARC)
 $\Delta = 124^\circ 17' 41''$
 $DC = 7^\circ 0' 0''$
 $RC = 818.51'$
 $LC = 1775.66'$

Note: Design Loading HS 20-44
 AASHTO Specs. 1969 Edition
 & P.R.M. 20-4.

NO.	DATE	REVISIONS	BY	APPD
3				
2				
1				

STATE HIGHWAY COMMISSION OF KANSAS
 BR. NO. 35W-87-14.46 STA. 33+89.13

CONSTRUCTION LAYOUT
 RAMP SW OVER I35W

PROJ. NO. 35W-87135W-1(33)46 SEDGWICK CO.

WILSON & COMPANY
 ENGINEERS & ARCHITECTS
 SALINA, KANSAS

DESIGNED L.C.C. TRACED J.F.B. CHECKED J.L.M.