

PUB. ROAD DIV. NO.	STATE	PROJECT NO.	FISCAL YEAR	SHEET NO.	TOTAL SHEETS
5	KANSAS	*	1970	102	229

* 35W-87135W-1(33)46

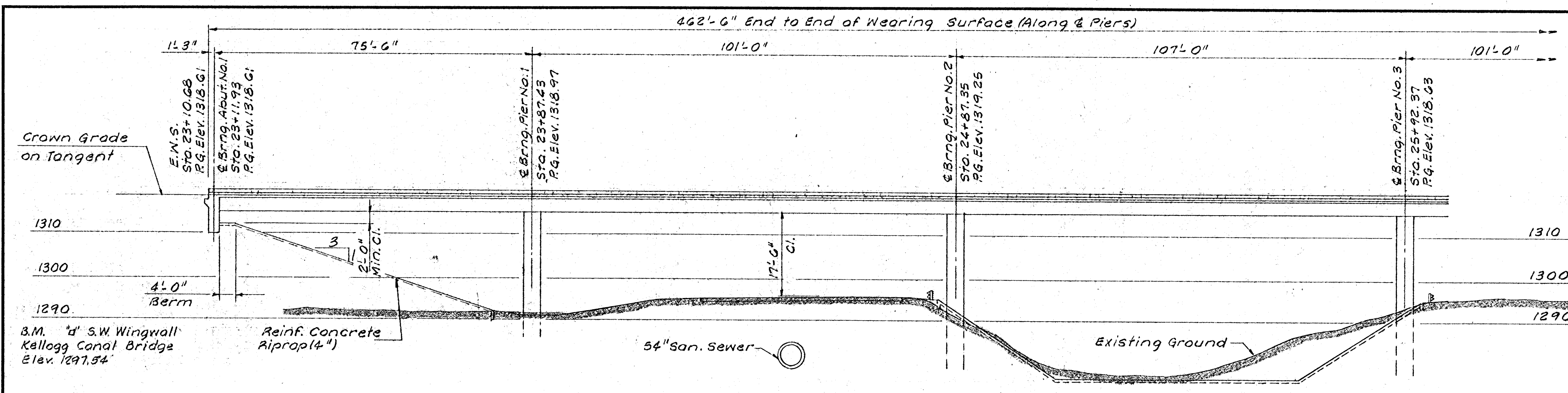

ELEVATION
 Shown Parallel to Piers Ramp ES
 75.5' - 101.0' - 107.0' - 101.0' - 75.5'
 Continuous Reinforced Concrete Box
 Girder Spans, 30'-0" Roadway, Pile
 Bent Abutments, Pedestal Type Piers

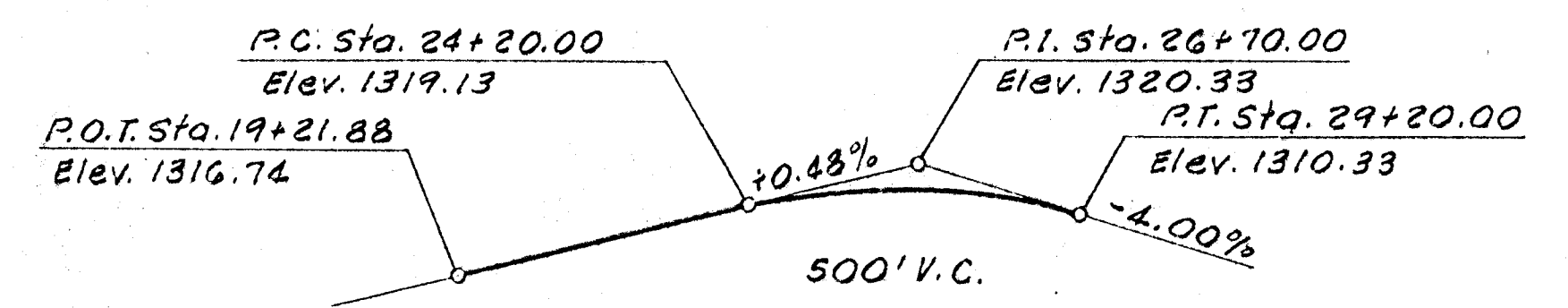

PROFILE RAMPES

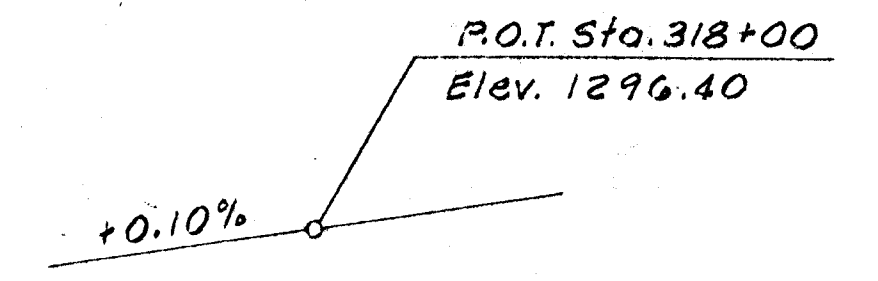

PROFILE 135W

RAMPES CURVE DATA (ARC DEF.)

$\Delta = 147^{\circ}17'17''$
 $D_c = 12^{\circ}0'$
 $PC = 477.46$
 $LC = 1227.40$

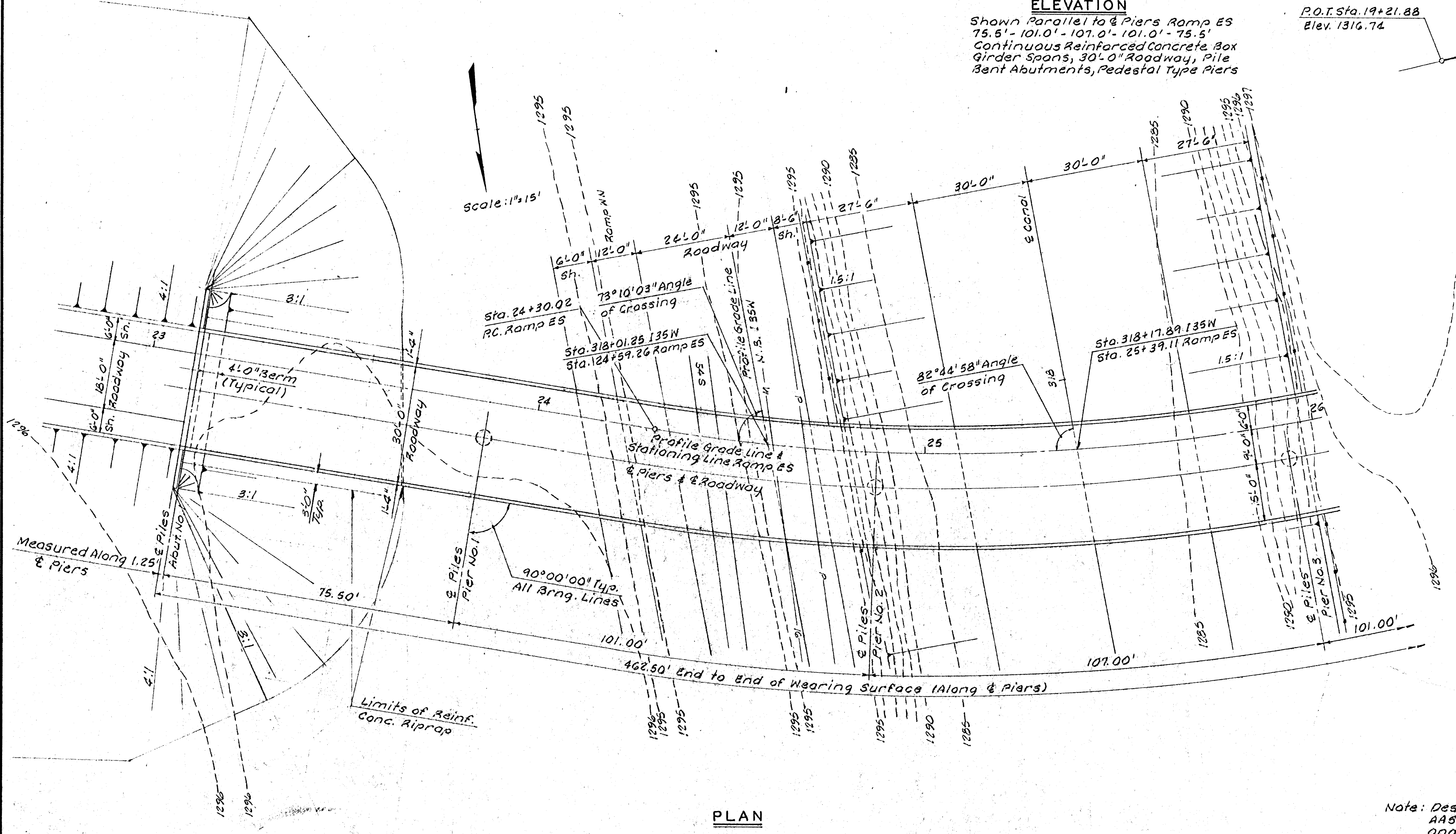

PLAN

Note: Design Loading HS 20-44
 AASHTO Specs. 1969 Edition
 and P.R.M. 20-4

NO.	DATE	REVISIONS	BY	APP'D
3				
2				
1				

STATE HIGHWAY COMMISSION OF KANSAS
 BR. NO. 35W-87-14.56 STA. 25+38.75
CONSTRUCTION LAYOUT
 RAMP ES OVER 135W
 PROJ. NO. 35W-87135W-1(33)46 SEDGWICK CO.
 WILSON & COMPANY
 ENGINEERS & ARCHITECTS
 SALINA, KANSAS
 DESIGNED J.L.M. TRACED J.F.B. CHECKED