

PUB. ROAD DIV. NO.	STATE	PROJECT NO.	FISCAL YEAR	SHEET NO.	TOTAL SHEETS
5	KANSAS	*		165	229

* 35W-871-35W-1(33)46

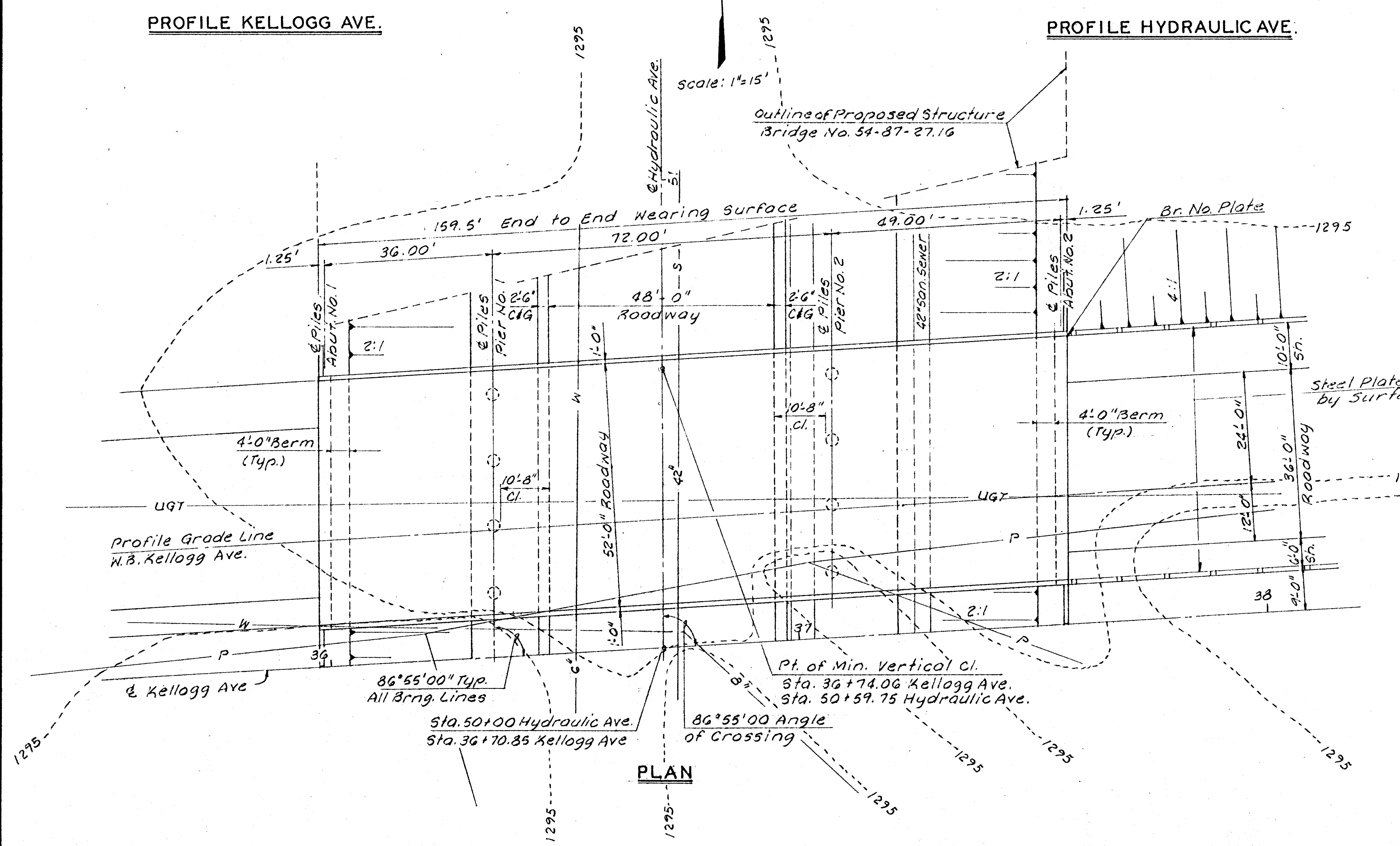
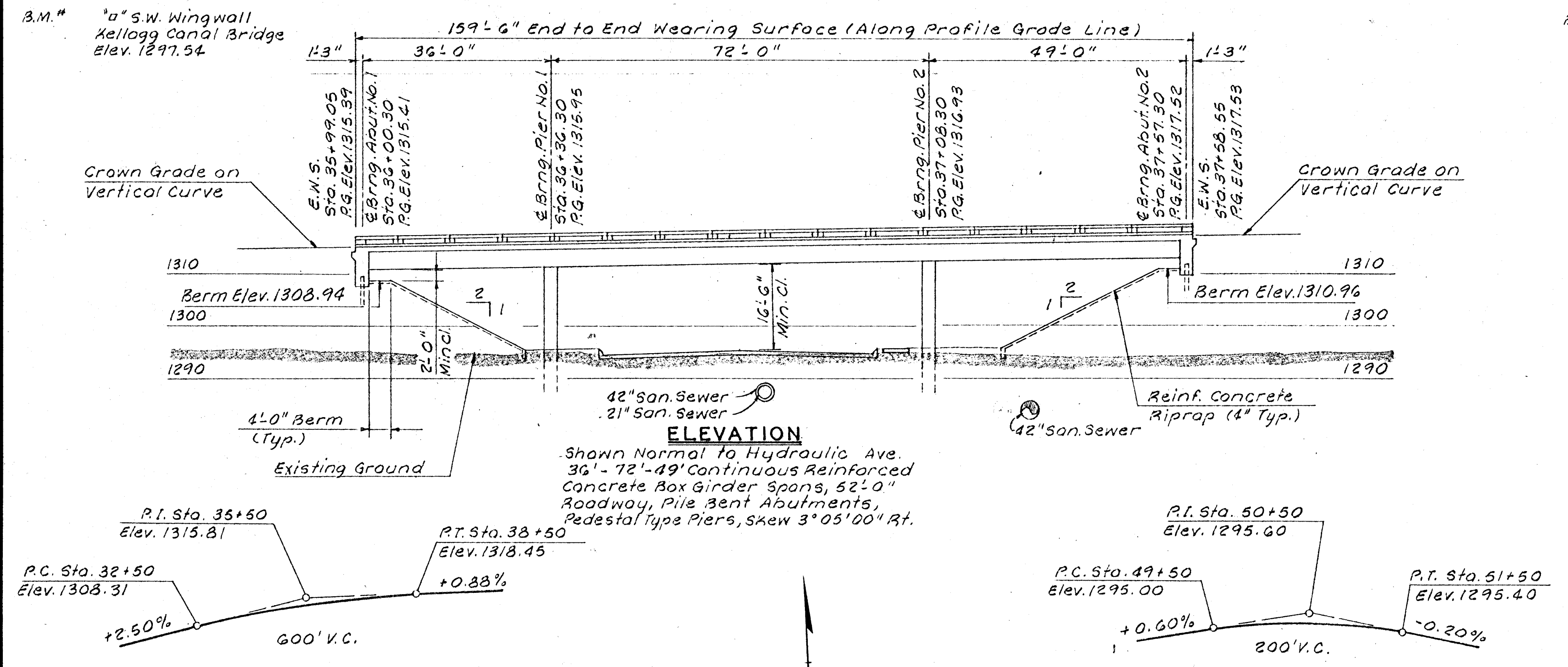

Note: Design Loading HS 20-44
AASHTO Specs. 1960 edition
P.R.M. 20-4.

NO.	DATE	REVISIONS	BY	APP'D
3				
2				
1				

STATE HIGHWAY COMMISSION OF KANSAS
BRIDGE NO. 54-87-27.15 STA. 36+78.80

CONSTRUCTION LAYOUT
W.B. KELLOGG AVE. OVER HYDRAULIC AVE

PROJ. NO. 35W-871-35W-1(33)46 SEDGWICK CO.

WILSON & COMPANY
ENGINEERS & ARCHITECTS
SALINA, KANSAS

DESIGNED L.C.C. TRACED J.F.B. CHECKED G.H.N.