

FHWA REGION NO.	STATE	PROJECT NO.	FISCAL YEAR	SHEET NO.	TOTAL SHEETS
7	KANSAS	87 N-0347-01	2007	25	123

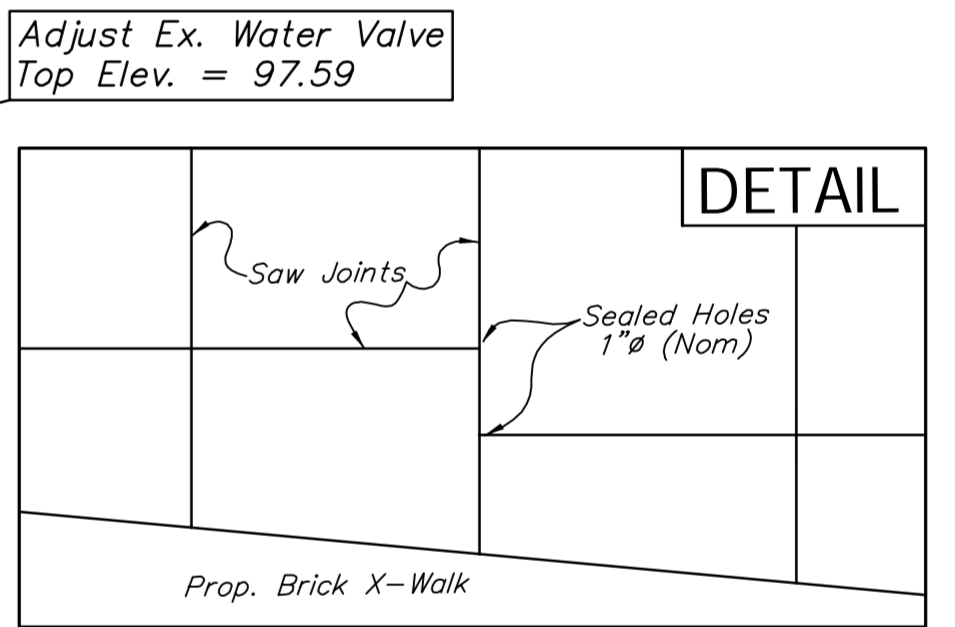
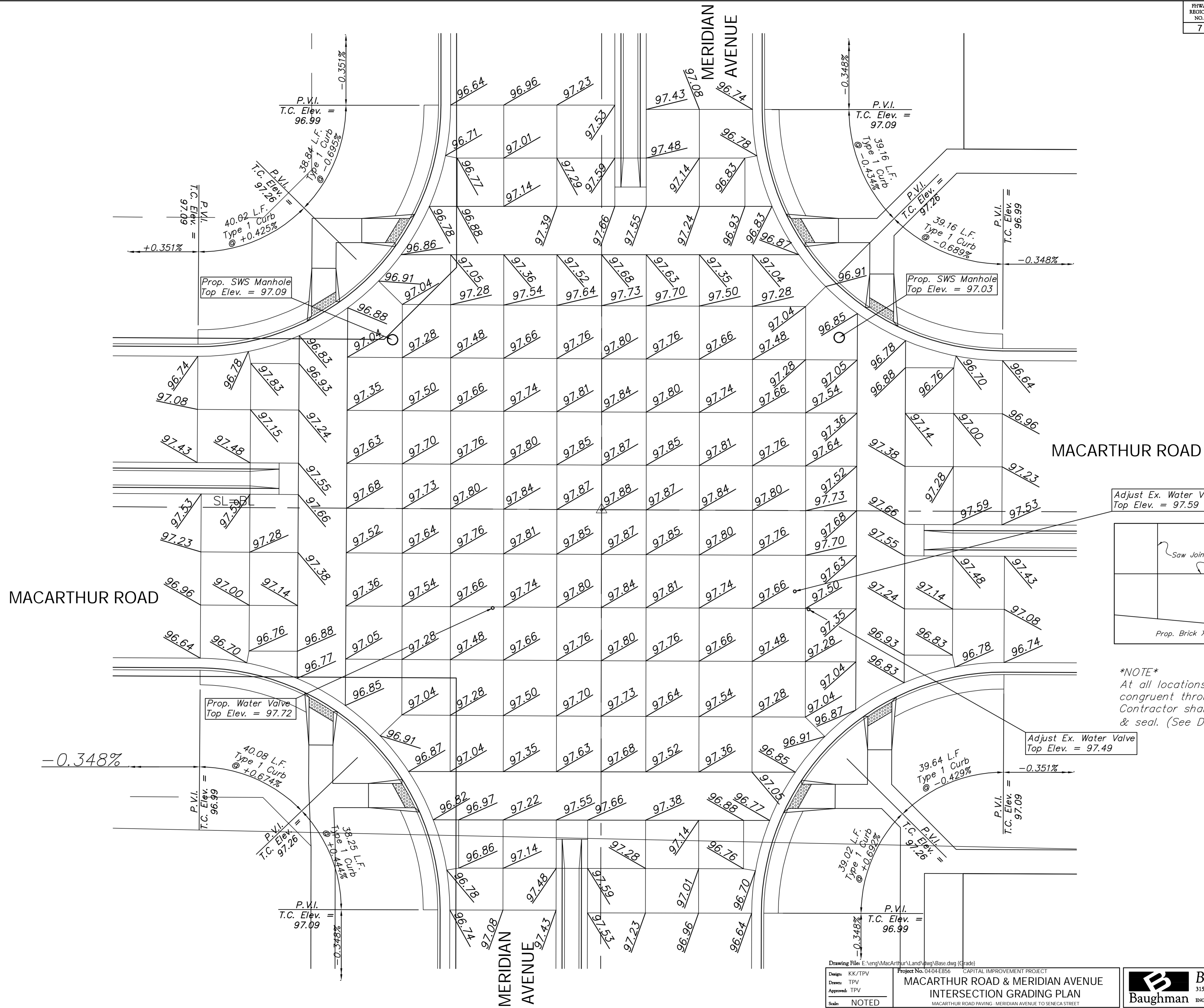
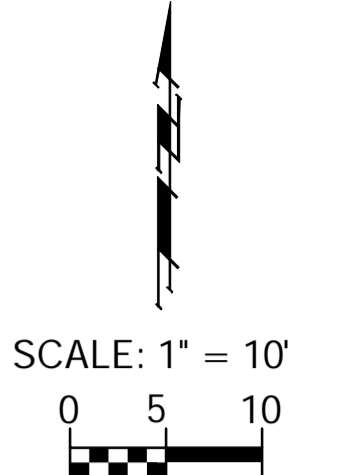

NOTE
 At all locations where joints are not congruent through pavement sections, Contractor shall drill full pavement depth & seal. (See Detail This Sheet)

Adjust Ex. Water Valve
 Top Elev. = 97.49

Drawing File: E:\eng\MacArthur\Land\mg\Bse.dwg (Grade)

Design: KK/TPV
 Drawn: TPV
 Approved: TPV
 Scale: NOTED

Project No. 04-04-E856 CAPITAL IMPROVEMENT PROJECT
MACARTHUR ROAD & MERIDIAN AVENUE
 INTERSECTION GRADING PLAN
 MACARTHUR ROAD PAVING, MERIDIAN AVENUE TO SENECA STREET

Baughman Company, P.A.
 315 Ellis St., Wichita, KS 67211 P 316-262-7171 F 316-262-0149
 Baughman ENGINEERING | SURVEYING | PLANNING | LANDSCAPE ARCHITECTURE

July 2007
 SHEET
25
 OF
123