

BENCHMARK:  
 BM #3 - Railroad Spike in the North Face of the Second High Line Power Pole East of the MacArthur Quik Trip Entrance and South of MacArthur  
 Sta. 17+55, 40' Rt.  
 Elev. = 98.92 City Datum

Sta. 0+00.00, Begin SWS Line 1c =  
 B.L. Sta. 20+75.00, 31.50' Lt.  
 Construct Inlet (Double)(Type 1)  
 (11' 4" X 4' 4")  
 Top Elev. = 95.12

Sta. 0+09.00, SWS Line 1c =  
 Sta. 16+63.10, SWS Line 1 =  
 B.L. Sta. 20+75.00, 22.50' Lt.  
 Connect to Manhole, Grout, and Seal Tight.  
 Top Elev. = 94.94

**CAUTION!**  
 Existing 6" Gas U/G AT&T in Vicinity

Sta. 0+63.00, End SWS Line 1c =  
 B.L. Sta. 20+75.00, 31.50' Rt.  
 Construct Inlet (Double)(Type 1)  
 (11' 4" X 4' 4")  
 Top Elev. = 95.12

**CAUTION!**  
 Existing 4" Pipeline in Vicinity

Install Pavement Underdrain. See Detail, Sheet 8.

SCALE:  
 HORIZONTAL: 1" = 20'  
 VERTICAL: 1" = 5'

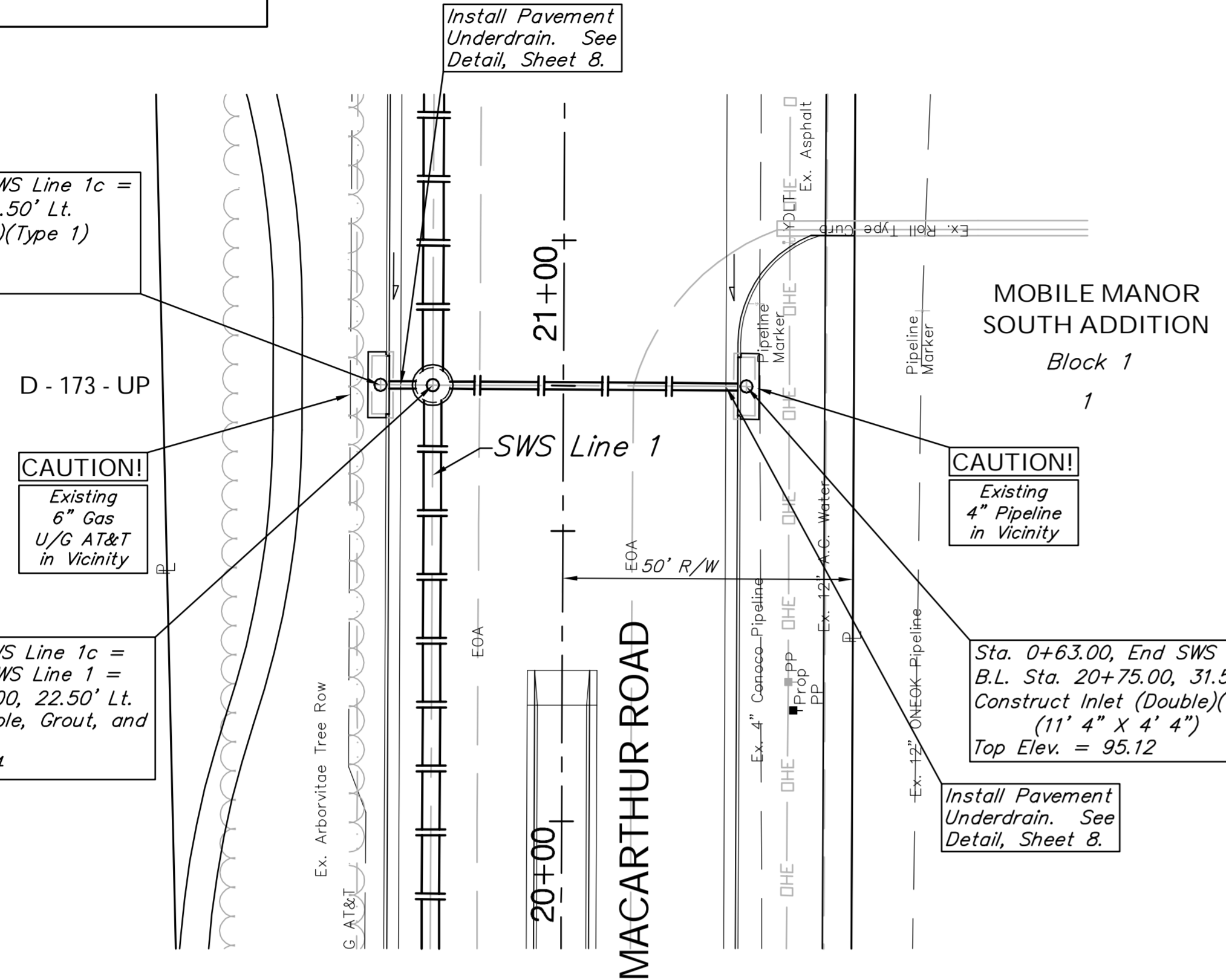

BENCHMARK:  
 BM #4 - Railroad Spike in the First High Line Pole West of the East Mobile Home Park Drive on the South Side of MacArthur  
 Sta. 25+70, 40' Rt.  
 Elev. = 98.59 City Datum

Sta. 0+00.00, Begin SWS Line 1d =  
 B.L. Sta. 22+53.90, 70.00' Lt.  
 Install 1-18" RCP End Section. Remove Ex. Concrete Flume as Necessary and Re-pour Around Proposed 18" End Section. Cost to be SUBSIDIARY to Pipe Installation.

Sta. 0+47.50, End SWS Line 1d =  
 Sta. 18+42.00, SWS Line 1 =  
 B.L. Sta. 22+53.90, 22.50' Lt.  
 Connect to Manhole, Grout, and Seal Tight.  
 Top Elev. = 95.44

**CAUTION!**  
 Existing 6" Gas U/G AT&T Crossings

Sta. 0+25.00, SWS Line 1d =  
 B.L. Sta. 22+53.90, 45.00' Lt.  
 Construct Std. Shallow Type "p" Manhole (4' Dia.)  
 Top Elev. = 96.94

SCALE:  
 HORIZONTAL: 1" = 20'  
 VERTICAL: 1" = 5'

