

BENCHMARK:  
 BM #7 - Railroad Spike in the Third High Line Pole East of Fern on the North Side of MacArthur  
 Sta. 52+09, 43' Lt.  
 Elev. = 94.52 City Datum

BENCHMARK:  
 BM #8 - Railroad Spike in the First Power Pole West of the Car Wash Drive on the North Side of MacArthur  
 Sta. 57+56, 53' Lt.  
 Elev. = 93.11 City Datum

FHW REGION NO.	STATE	PROJECT NO.	FISCAL YEAR	SHEET NO.	TOTAL SHEETS
7	KANSAS	87 N-0347-01	2007	62	123

SCALE:  
 HORIZONTAL: 1" = 20'  
 VERTICAL: 1" = 5'

SCALE:  
 HORIZONTAL: 1" = 20'  
 VERTICAL: 1" = 5'

Prior to Beginning Construction, the Contractor Shall Excavate the Ex. 12" Water Line to Verify Size and Location. The Contractor Shall Report Back the the Engineer So That Any Necessary Modifications Can Be Made. This Work Shall be Considered SUBSIDIARY to the Water Line Installation.

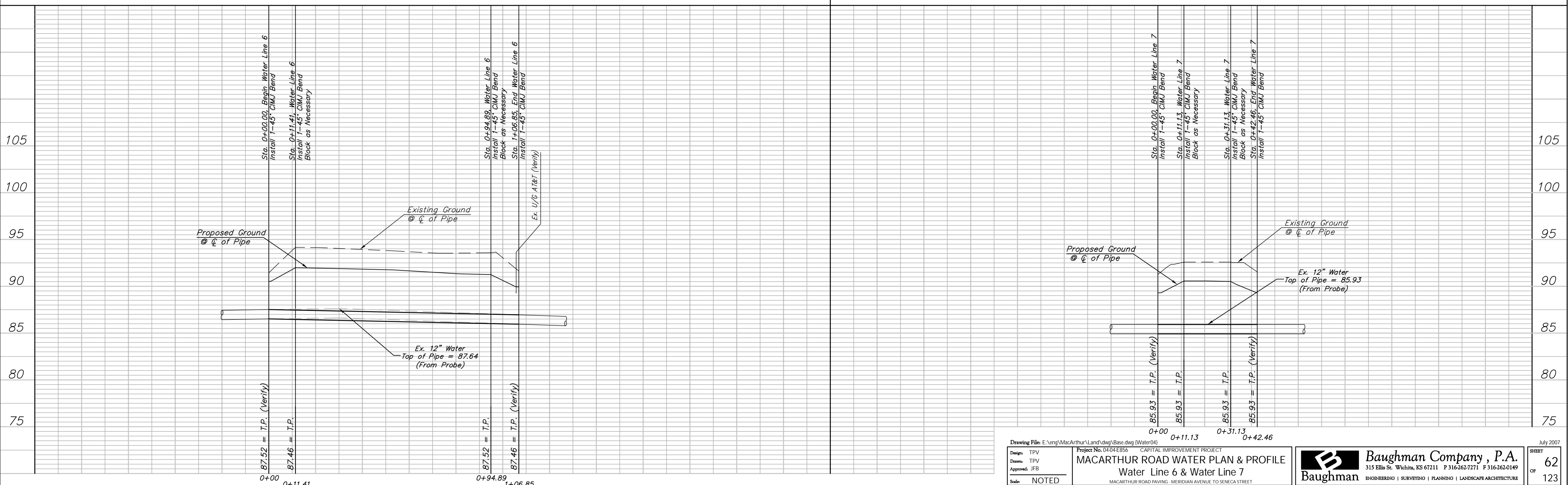
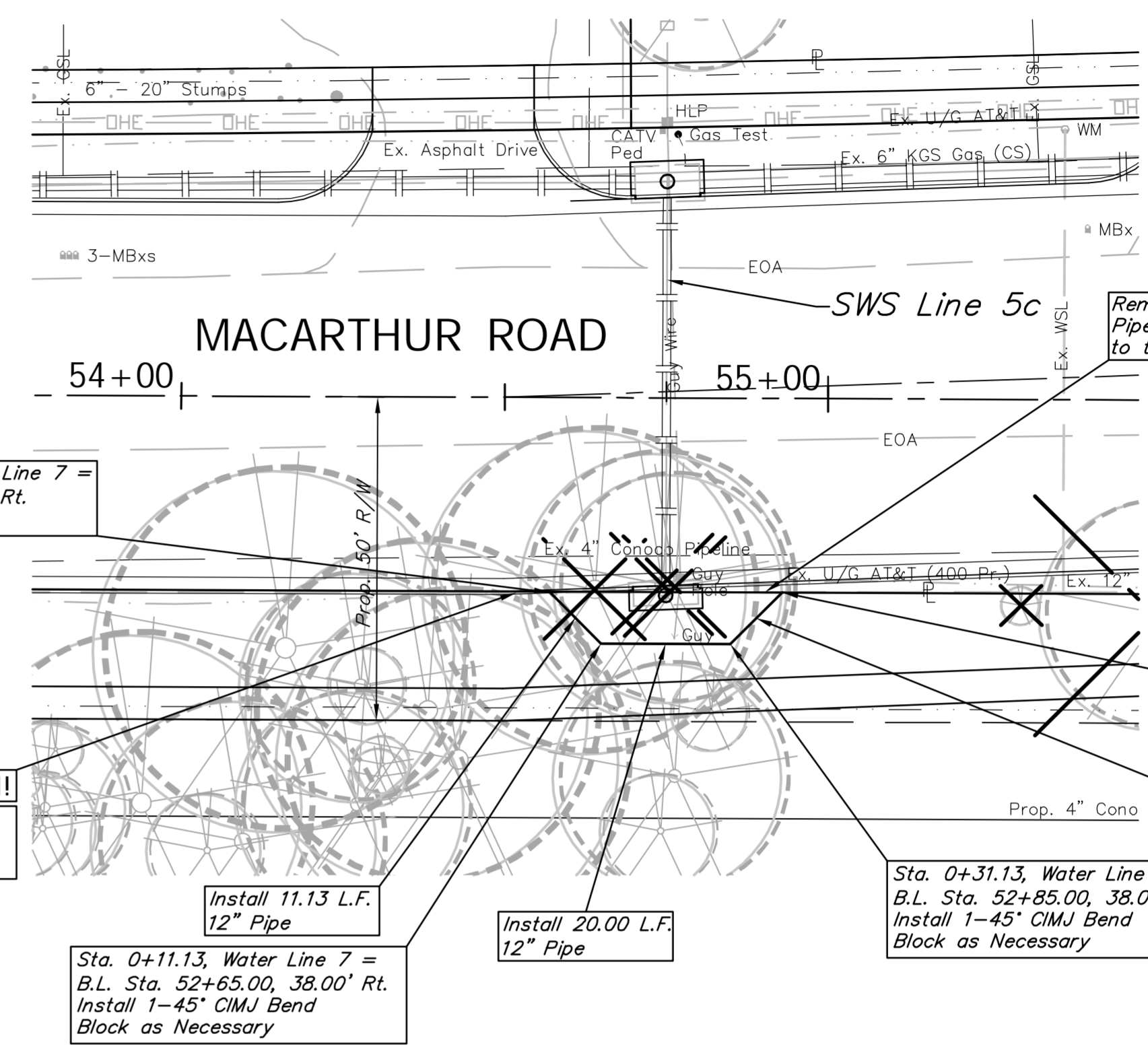
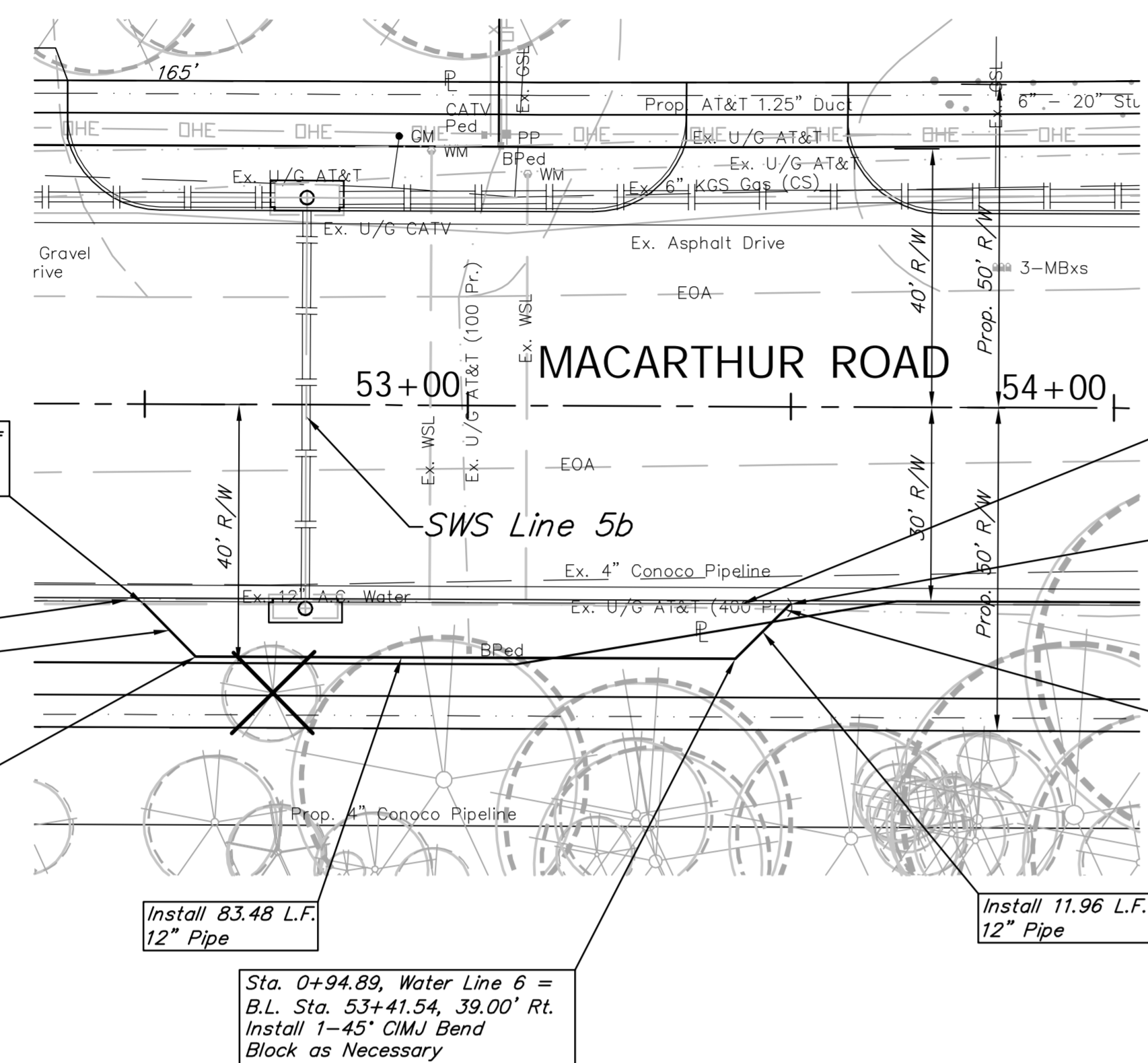

Station	Water Line 6 Elevation	Water Line 7 Elevation
0+00	87.52 = T.P. (Verify)	85.93 = T.P. (Verify)
0+11.41	87.46 = T.P.	85.93 = T.P.
0+94.89	87.52 = T.P.	85.93 = T.P.
1+06.85	87.46 = T.P. (Verify)	85.93 = T.P. (Verify)

Drawing File: E:\eng\MacArthur\Land\dwg\Bases.dwg (Water04)  
 Project No. 04-04-E856 CAPITAL IMPROVEMENT PROJECT  
**MACARTHUR ROAD WATER PLAN & PROFILE**  
 Water Line 6 & Water Line 7  
 MACARTHUR ROAD PAVING - MERIDIAN AVENUE TO SENECA STREET

Design: TPV  
 Drawn: TPV  
 Approved: JFB  
 Scale: NOTED

**Baughman Company, P.A.**  
 315 Ellis St. Wichita, KS 67211 P 316-262-7271 F 316-262-0149  
 ENGINEERING | SURVEYING | PLANNING | LANDSCAPE ARCHITECTURE

July 2007  
 SHEET 62 OF 123