

BENCHMARK:  
 BM #4 - Railroad Spike in the First High Line Pole West of the East Mobile Home Park Drive on the South Side of MacArthur  
 Sta. 25+68, 38' Rt.  
 Elev. = 98.95 City Datum

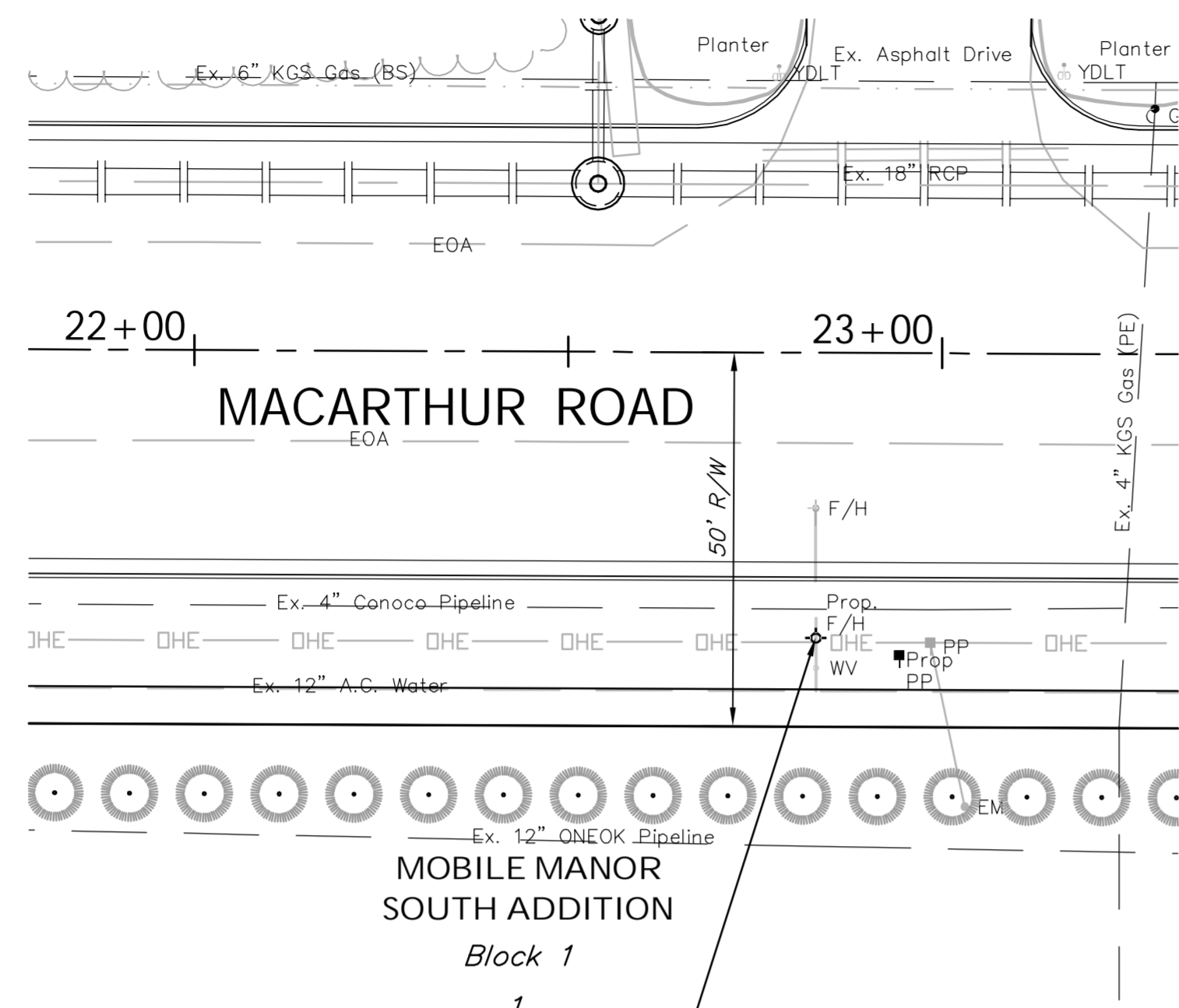

B.L. Sta. 22+83.27, 38.15' Rt.  
 Remove Ex. Fire Hydrant and Approx. 17.4 L.F. 6" DI CL Pipe. Re-Install Ex. Fire Hydrant and Block as Necessary.  
 Prop. L = 7.0'  
 Ex. Bury Line Elev. = 97.27  
 Prop. Bury Line Elev. = 96.55  
 Prop. Valve Box Elev. = 96.66

BENCHMARK:  
 BM #5 - City of Wichita Disc Located 0.5 miles East of Meridian on the North Side of MacArthur  
 Sta. 36+07, 84' Lt.  
 Elev. = 93.61 City Datum

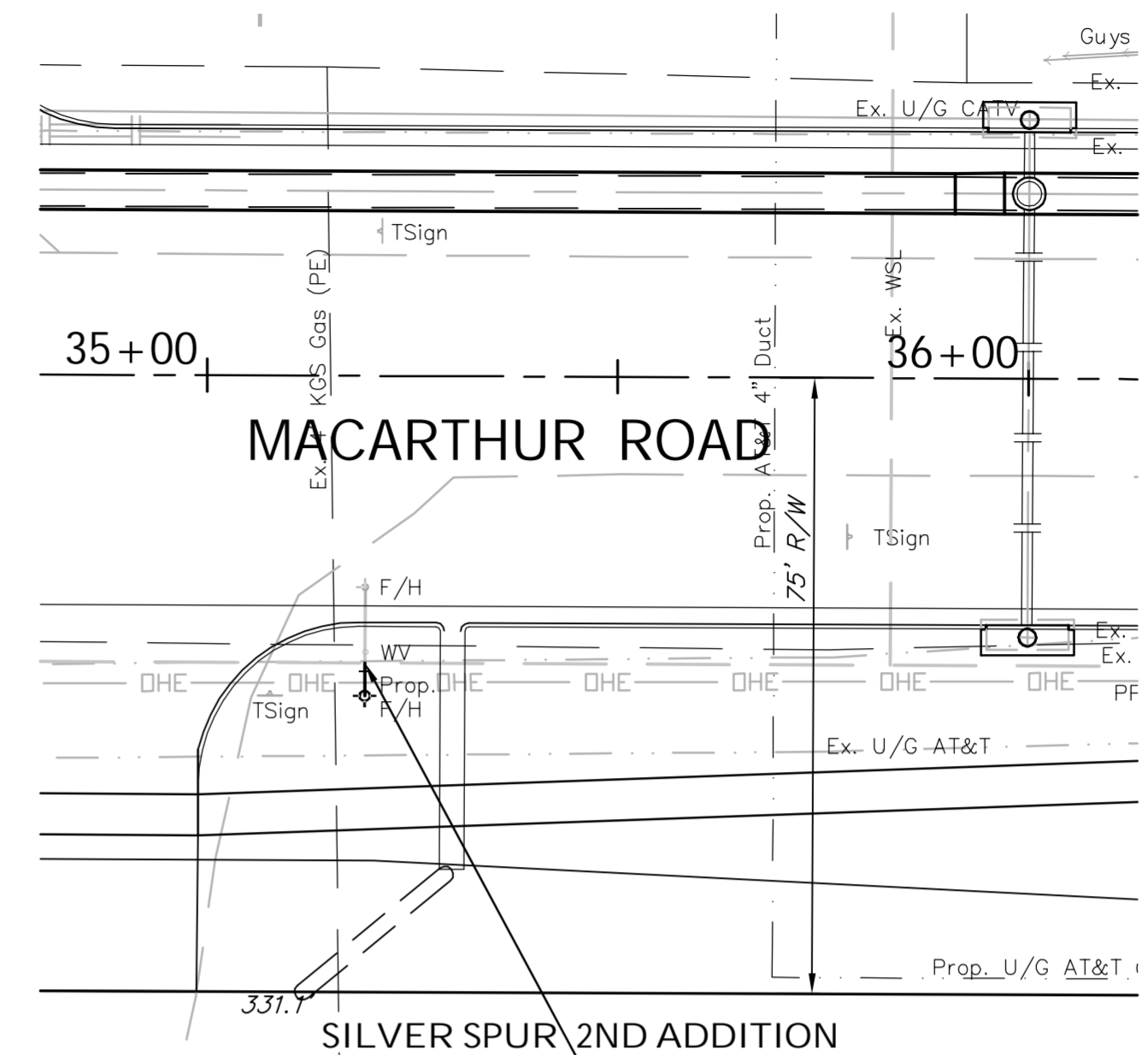

B.L. Sta. 35+19.34, 34.95' Rt.  
 Remove Ex. Fire Hydrant and 6" Valve (N). Rotate Ex. 12" X 6" Tee (180° Vertical). Re-Install Ex. Fire Hydrant and 6" Valve. Block as Necessary.  
 Prop. L = 4.0'  
 Ex. Bury Line Elev. = 94.12  
 Prop. Bury Line Elev. = 93.13  
 Prop. Valve Box Elev. = 93.64

BENCHMARK:  
 BM #6 - Railroad Spike in the First High Line Pole West of Fern on the North Side of MacArthur  
 Sta. 44+49, 42' Lt.  
 Elev. = 94.37 City Datum

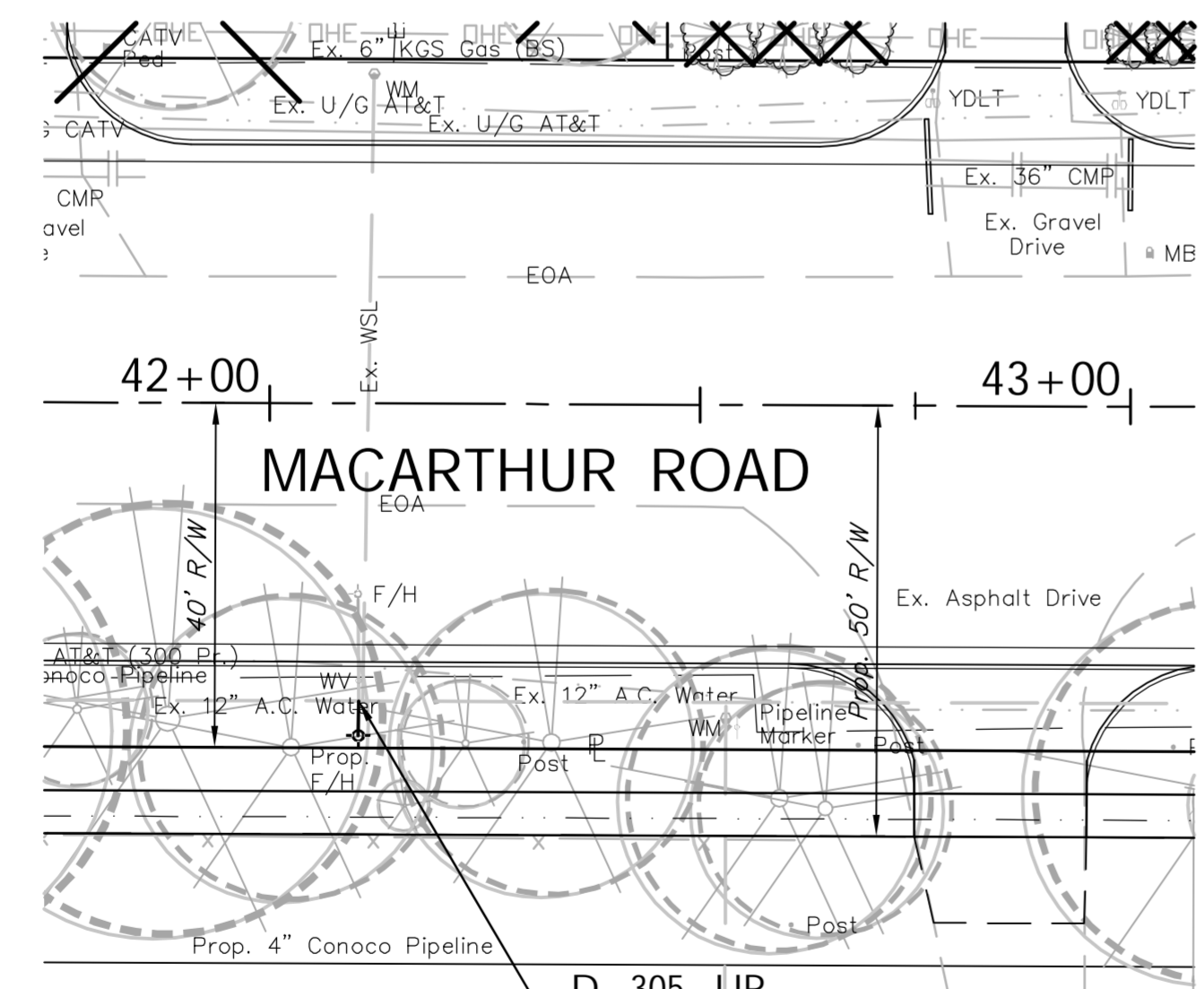

B.L. Sta. 42+10.46, 38.53' Rt.  
 Remove Ex. Fire Hydrant and 6" Valve (N). Rotate Ex. 12" X 6" Tee (180° Vertical). Re-Install Ex. Fire Hydrant and 6" Valve. Block as Necessary.  
 Prop. L = 4.0'  
 Ex. Bury Line Elev. = 93.27  
 Prop. Bury Line Elev. = 93.61  
 Prop. Valve Box Elev. = 93.28

BENCHMARK:  
 BM #8 - Railroad Spike in the First Power Pole West of the Car Wash Drive on the North Side of MacArthur  
 Sta. 57+56, 53' Lt.  
 Elev. = 93.11 City Datum

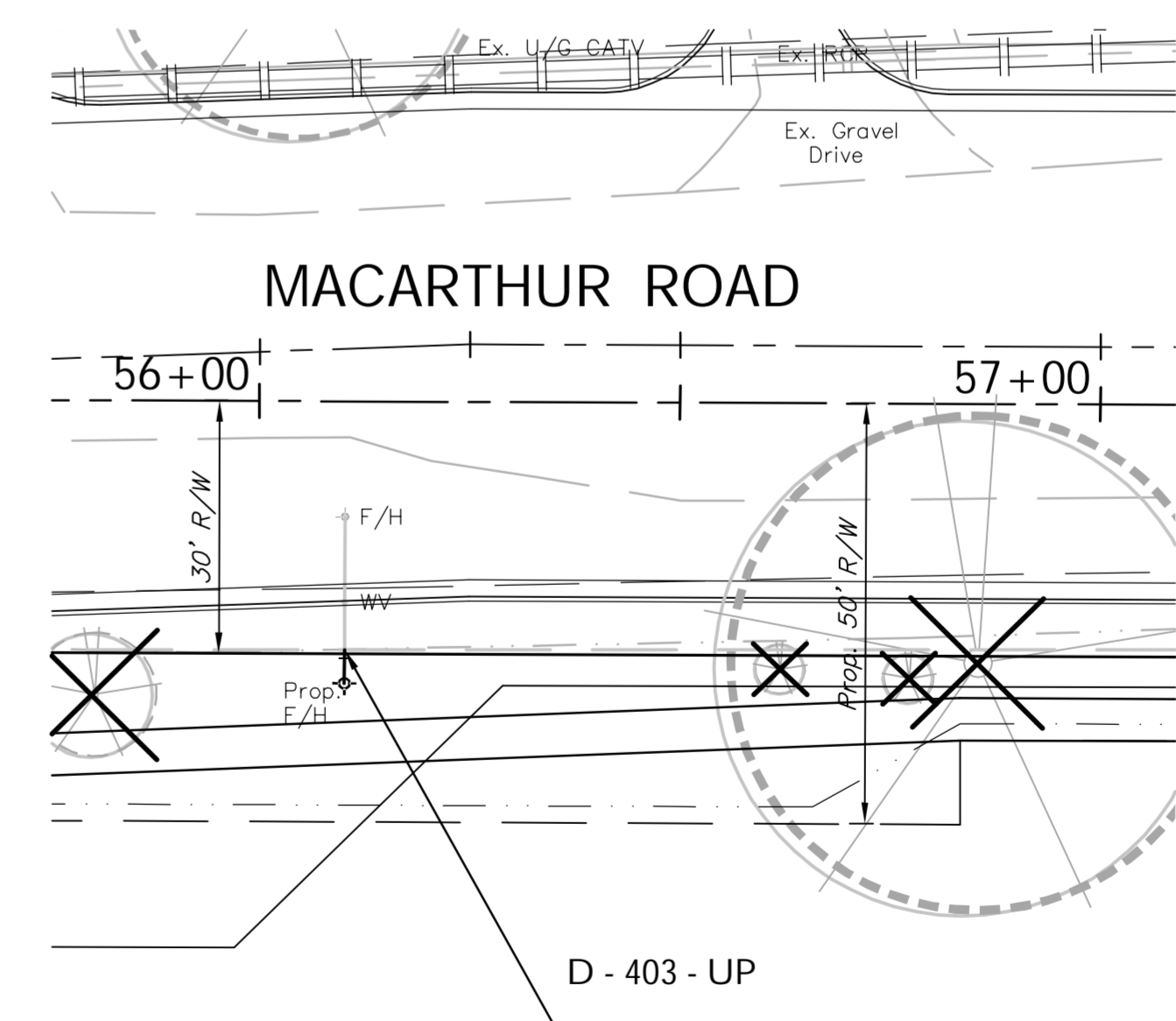

B.L. Sta. 56+10.22, 33.53' Rt.  
 Remove Ex. Fire Hydrant and 6" Valve (N). Rotate Ex. 12" X 6" Tee (180° Vertical). Re-Install Ex. Fire Hydrant and 6" Valve. Block as Necessary.  
 Prop. L = 4.0'  
 Ex. Bury Line Elev. = 91.10  
 Prop. Bury Line Elev. = 90.49  
 Prop. Valve Box Elev. = 90.03

Drawing File: E:\eng\MacArthur\Land\dwg\Bases.dwg (Hydrant)  
 Design: TPV  
 Drawn: TPV  
 Approved: JFB  
 Scale: NOTED

Project No. 04-04-E856 CAPITAL IMPROVEMENT PROJECT  
**FIRE HYDRANT RELOCATIONS**  
 MACARTHUR ROAD PAVING - MERIDIAN AVENUE TO SENECA STREET

**Baughman Company, P.A.**  
 315 Ellis St. Wichita, KS 67211 P 316-262-7271 F 316-262-0149  
 ENGINEERING | SURVEYING | PLANNING | LANDSCAPE ARCHITECTURE