

FHWA REGION NO.	STATE	PROJECT NO.	FISCAL YEAR	SHEET NO.	TOTAL SHEETS
7	KANSAS	87 N-0347-01	2007	66	123

SCALE: 1" = 20'

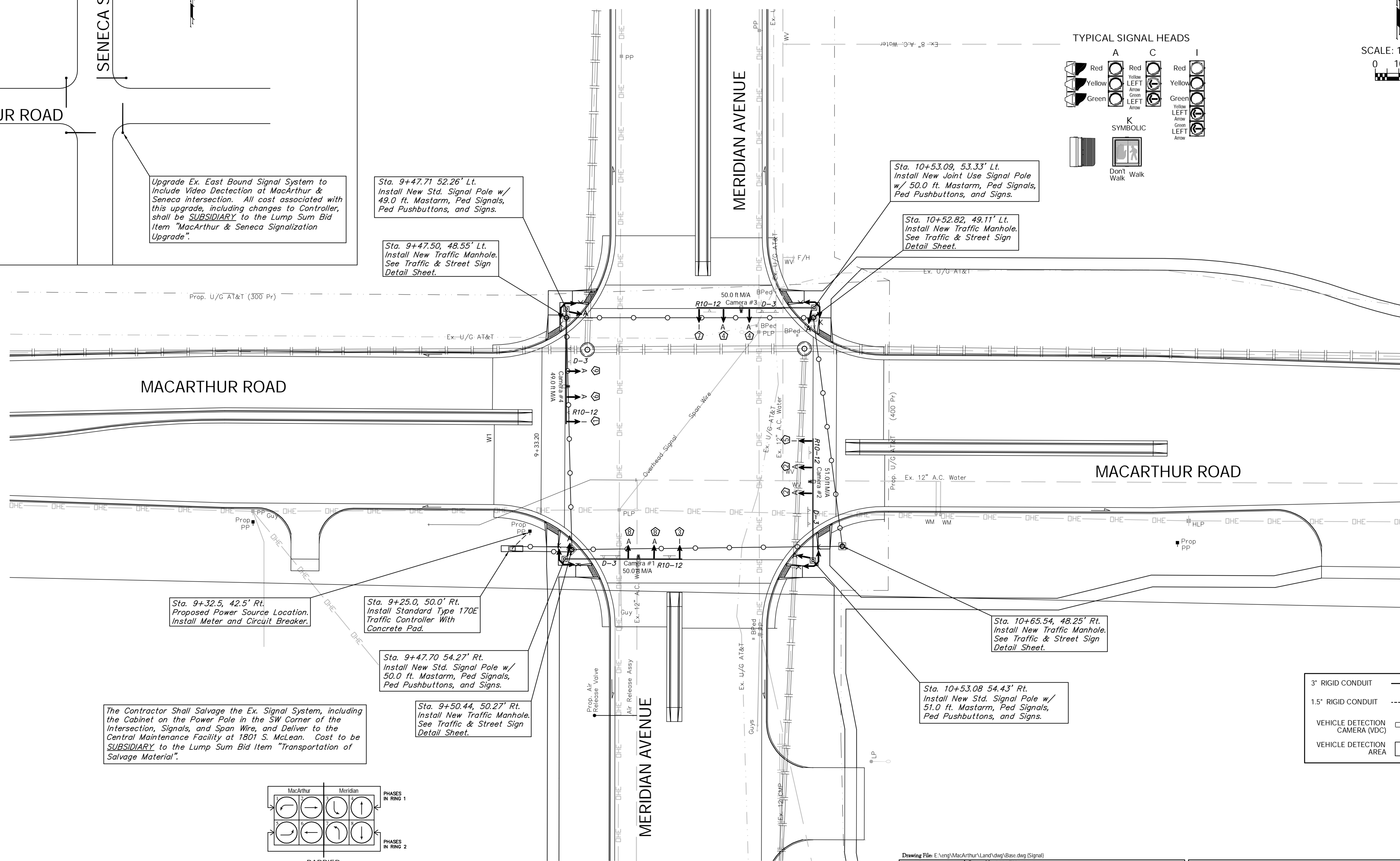
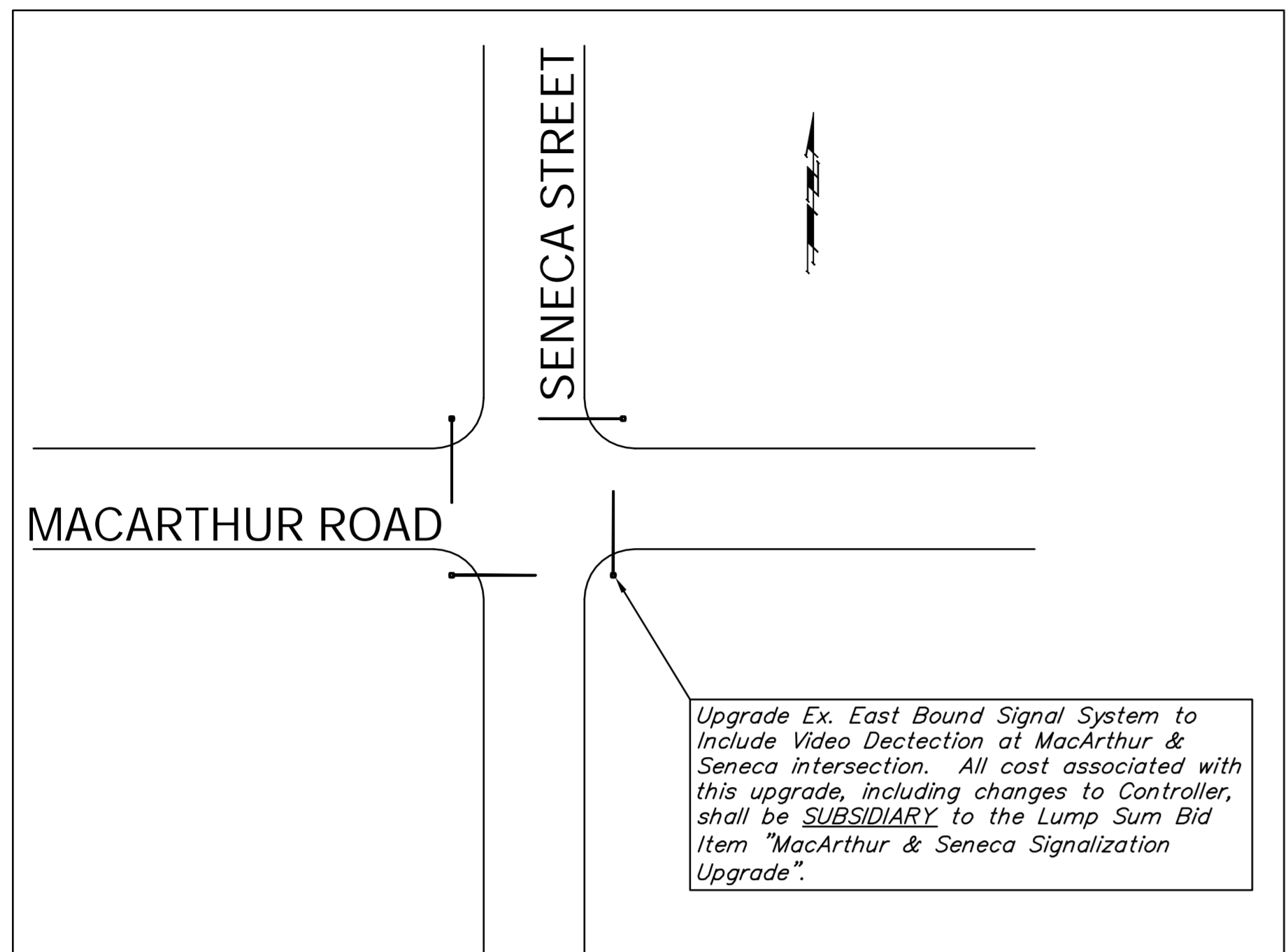
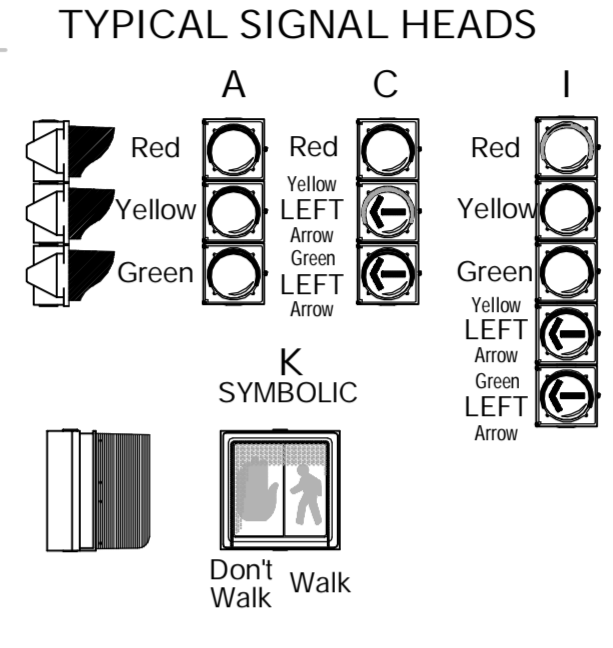

Upgrade Ex. East Bound Signal System to Include Video Detection at MacArthur & Seneca intersection. All cost associated with this upgrade, including changes to Controller, shall be SUBSIDIARY to the Lump Sum Bid Item "MacArthur & Seneca Signalization Upgrade".

Sta. 9+47.71 52.26' Lt.
Install New Std. Signal Pole w/ 49.0 ft. Mastarm, Ped Signals, Ped Pushbuttons, and Signs.

Sta. 9+47.50, 48.55' Lt.
Install New Traffic Manhole. See Traffic & Street Sign Detail Sheet.

Sta. 10+53.09, 53.33' Lt.
Install New Joint Use Signal Pole w/ 50.0 ft. Mastarm, Ped Signals, Ped Pushbuttons, and Signs.

Sta. 10+52.82, 49.11' Lt.
Install New Traffic Manhole. See Traffic & Street Sign Detail Sheet.

Sta. 9+32.5, 42.5' Rt.
Proposed Power Source Location. Install Meter and Circuit Breaker.

Sta. 9+25.0, 50.0' Rt.
Install Standard Type 170E Traffic Controller With Concrete Pad.

Sta. 9+47.70 54.27' Rt.
Install New Std. Signal Pole w/ 50.0 ft. Mastarm, Ped Signals, Ped Pushbuttons, and Signs.

Sta. 9+50.44, 50.27' Rt.
Install New Traffic Manhole. See Traffic & Street Sign Detail Sheet.

Sta. 10+65.54, 48.25' Rt.
Install New Traffic Manhole. See Traffic & Street Sign Detail Sheet.

Sta. 10+53.08 54.43' Rt.
Install New Std. Signal Pole w/ 51.0 ft. Mastarm, Ped Signals, Ped Pushbuttons, and Signs.

The Contractor Shall Salvage the Ex. Signal System, including the Cabinet on the Power Pole in the SW Corner of the Intersection, Signals, and Span Wire, and Deliver to the Central Maintenance Facility at 1801 S. McLean. Cost to be SUBSIDIARY to the Lump Sum Bid Item "Transportation of Salvage Material".

